

SITE PLAN
(SCALE 1:500)

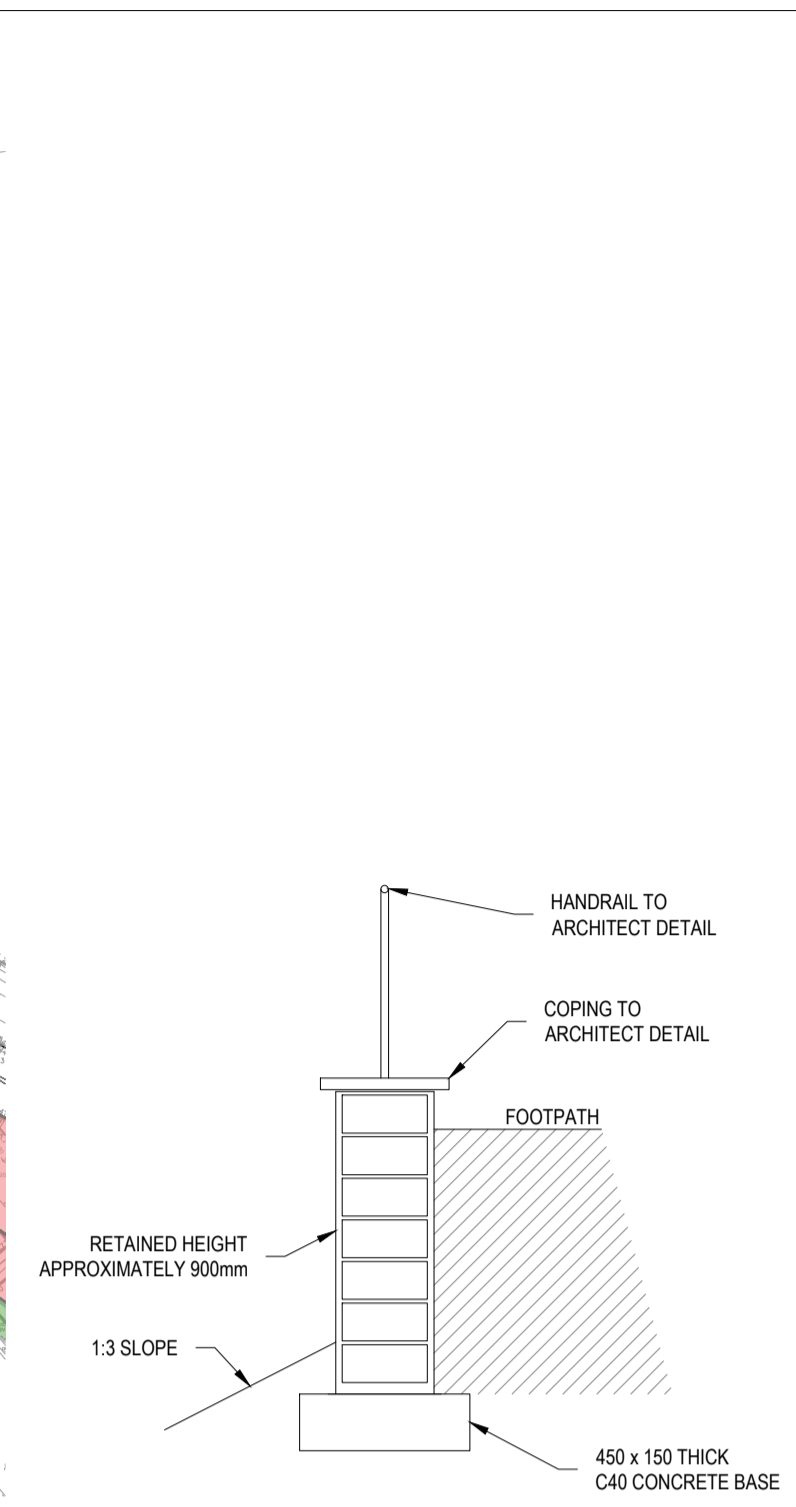

TYPICAL SECTION THROUGH ROAD WIDENING (CONCRETE)

- NOTES:**
- ALL BUILD-UPS SHOWN ON THIS DRAWING ARE BASED ON GROUND HAVING A CBR VALUE OF 5%. ANY VARIATION FROM THIS FIGURE WILL REQUIRE AN AMENDED SUB-BASE SPECIFICATION - SEE TABLE.
 - IN-SITU CBR TESTING WILL BE REQUIRED AT FORMATION LEVEL AND TO BE IN "SOAKED" CONDITION.
 - SUB-BASE TO BE TYPE 1 & TYPE 3 GRANULAR MATERIAL TO DOT SHW SERIES 600.
 - CBM TO BE TO BS7533 REQUIREMENTS.
 - CAPPING TO BE 6F2 (OR 6F1) MATERIAL IN ACCORDANCE WITH SHW SERIES 600.
 - ALL COURSE DEPTHS ARE MINIMUM REQUIRED (AFTER FULL COMPACTION) OVER NON-ORGANIC, NATURAL SUB-SOILS AT FORMATION LEVEL.

CBR	ROADS		FOOTWAYS	
	CAPPING + SUB-BASE	SUB-BASE ONLY	CBR	SUB-BASE
<2.0%	600mm + 150mm		<2%	250mm
2.0%*	450mm + 150mm		2%-5%	200mm
2.5%	400mm + 150mm	350mm	5%*	150mm
3.0%	350mm + 150mm	300mm	PATHS	
4.0%	300mm + 150mm	250mm	CBR	SUB-BASE
5%-15%	NOT REQUIRED	250mm	<2%	200mm
15%*	NOT REQUIRED	150mm	5%*	100mm

*GROUND STABILISATION REQUIRED FOR AREAS WITH CBR <2.5%. CBM LIKELY.

ALTERNATIVE SUB-BASE CONSTRUCTION FOR VARIATIONS OF IN-SITU CBR VALUES

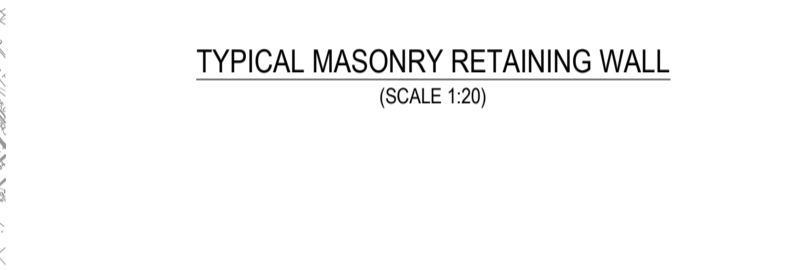

- REFER TO PLAN FOR RELEVANT DIAGRAM NUMBER
- SIGNS FIXED TO 750 X 103 TUBULAR GALVANISED CAPPED STEEL POST WITH STAINLESS STEEL STRAPS (TESPAR BAND TYPE)
- EDGE OF SIGN TO BE 500mm MIN FROM FACE OF KERB

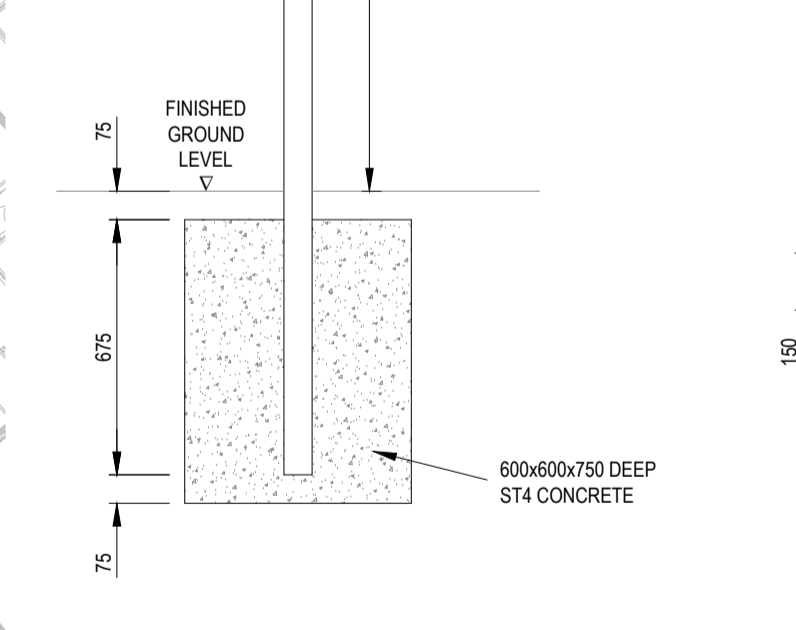
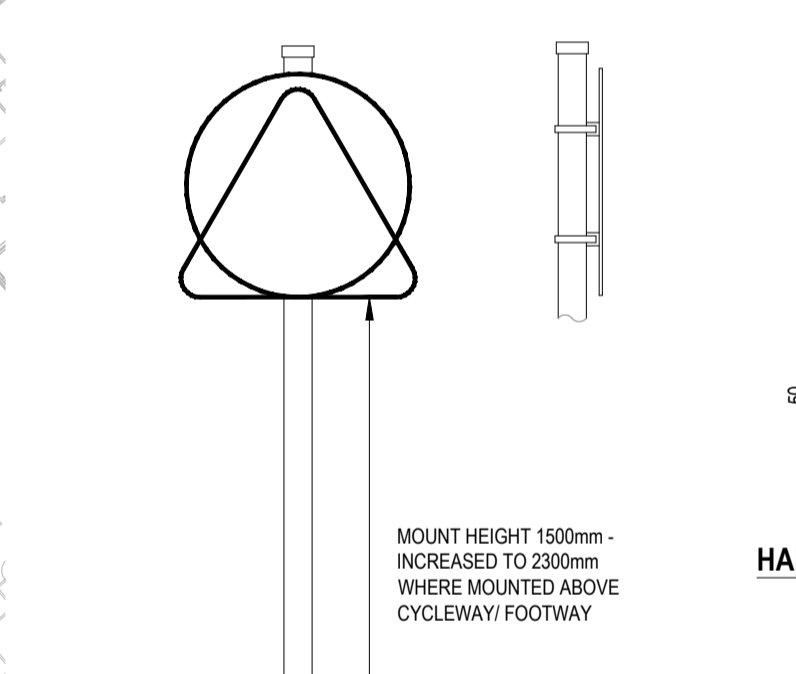

SIGN ON SINGLE POST & FOUNDATION (SCALE 1:20)

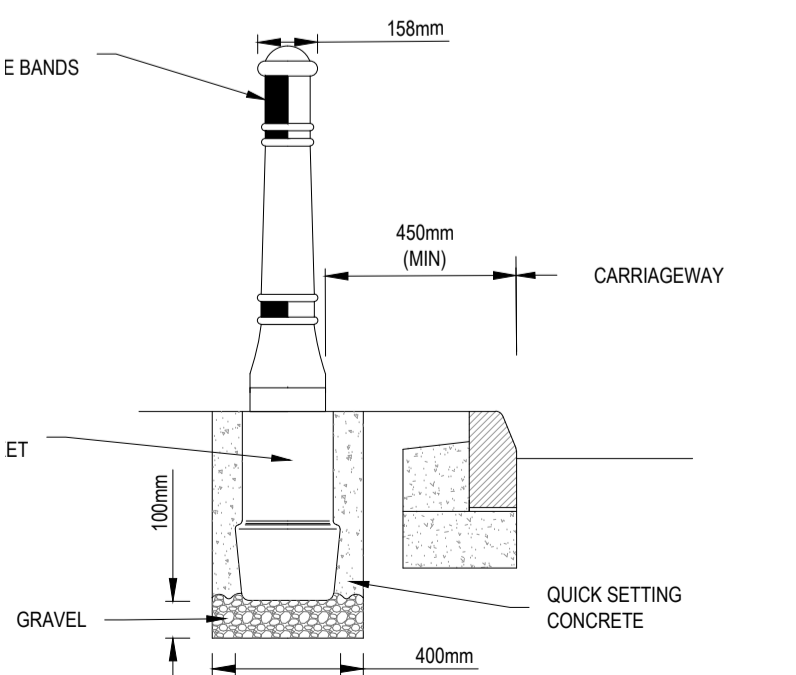

CHANNEL SQUARE (SCALE 1:20)

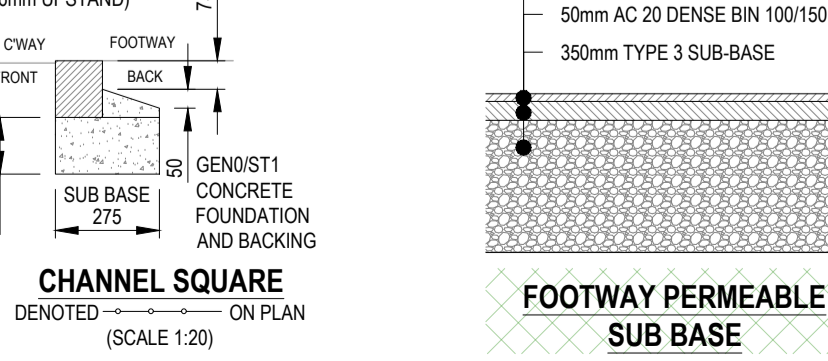
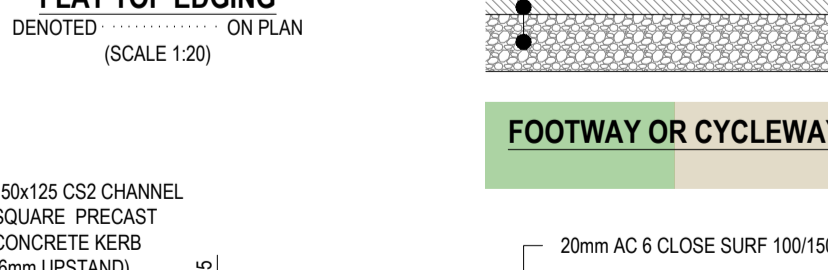
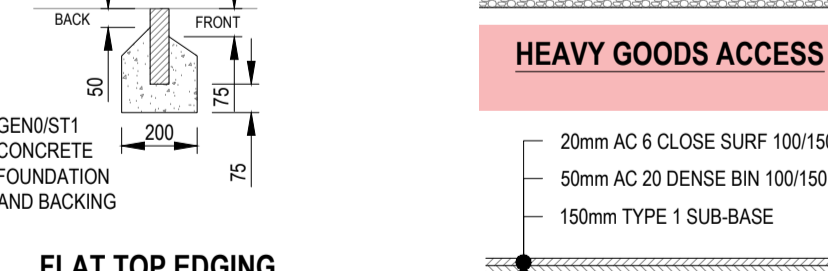
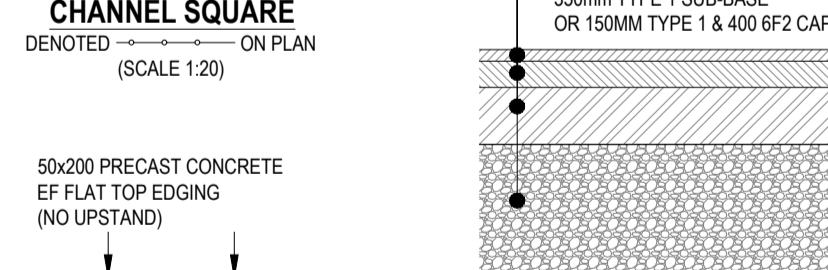
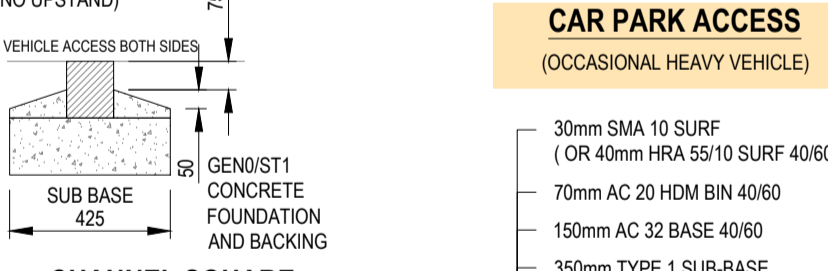
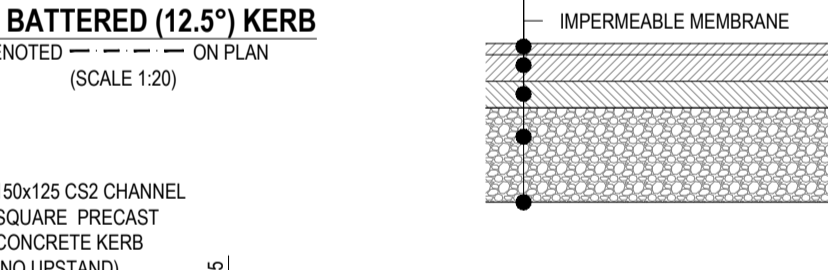
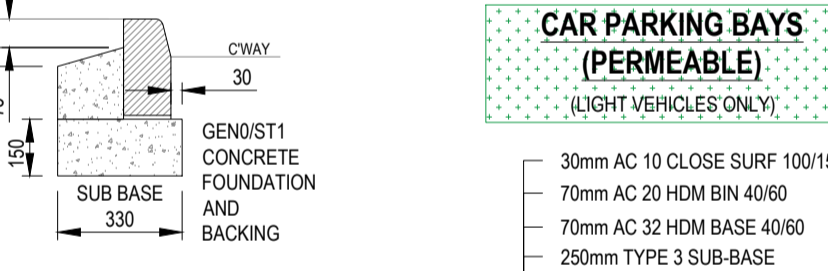
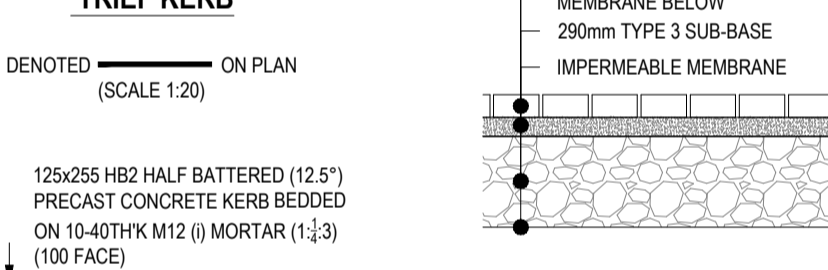
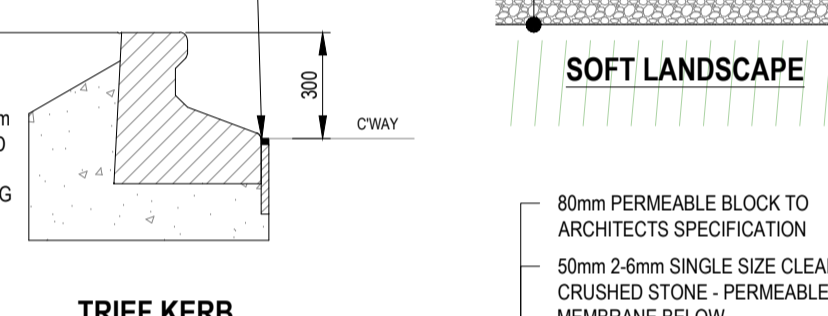
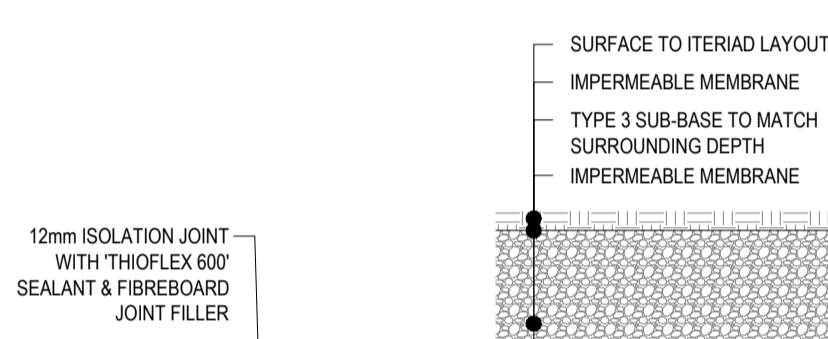

Column Height	Planting Depth
4m	800mm
5m	800mm
6m	1000mm
8m	1200mm
10m	1500mm
12m	1700mm

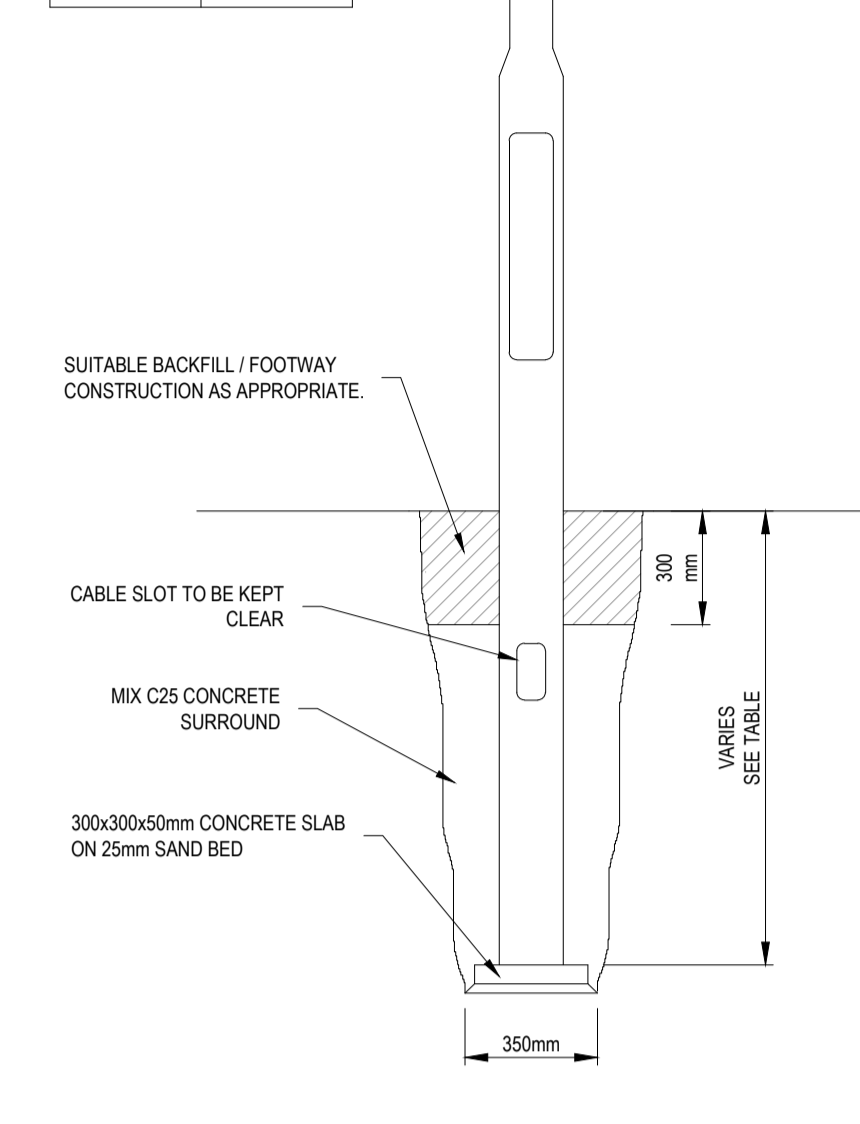

STREET LIGHTING COLUMN PLANTING DETAIL (SCALE 1:20)

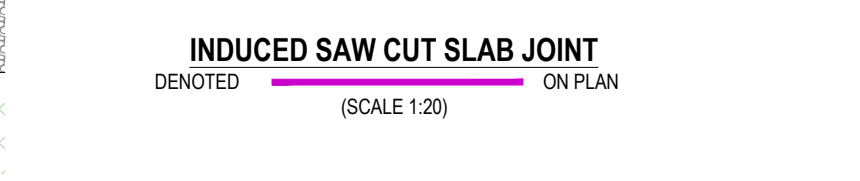
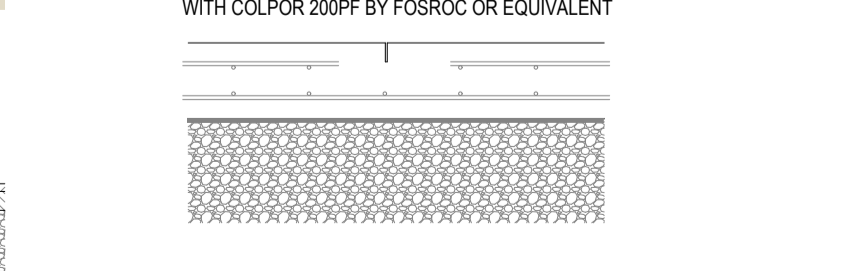
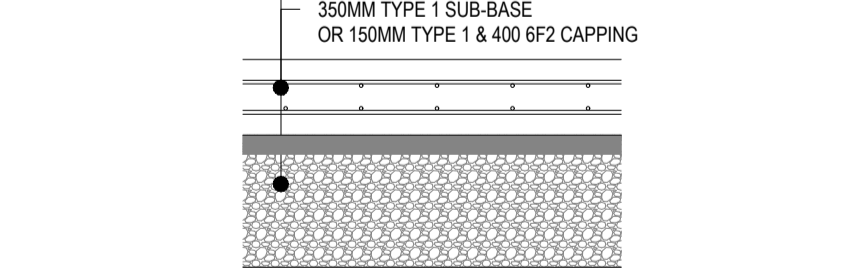
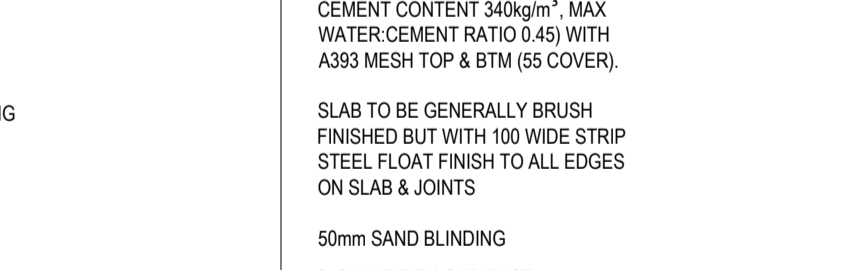
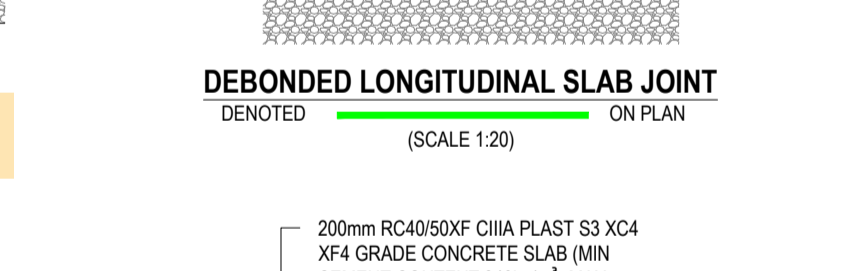
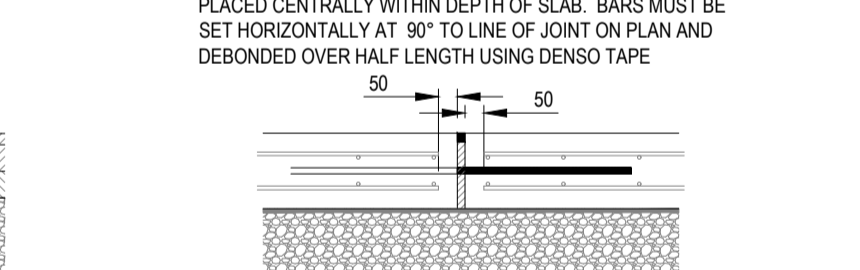
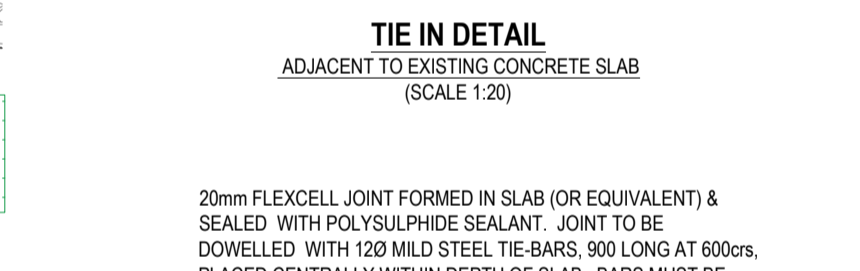
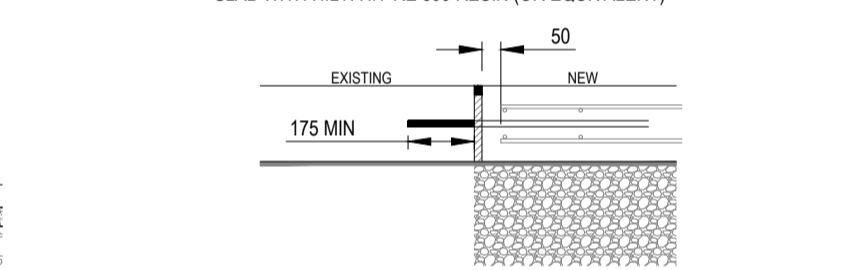
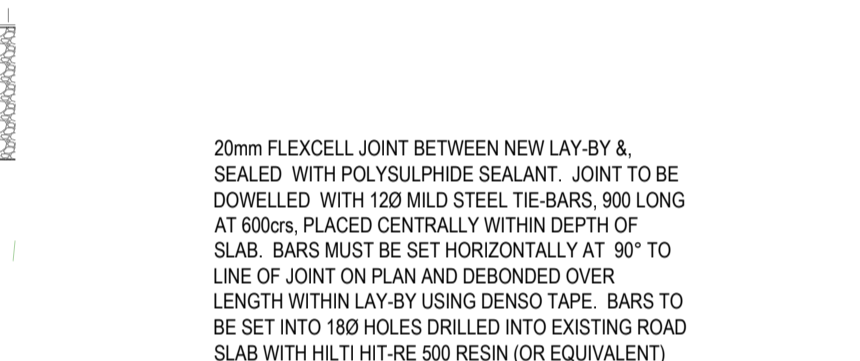

- GENERAL NOTES:**
- THIS DRAWING IS TO BE READ IN CONJUNCTION WITH ALL RELEVANT ARCHITECTS AND ENGINEERS DRAWINGS AND SPECIFICATIONS.
 - DO NOT SCALE THIS DRAWING. ANY AMBIGUITIES, OMISSIONS AND ERRORS ON DRAWINGS SHALL BE BROUGHT TO THE ENGINEERS ATTENTION IMMEDIATELY. ALL DIMENSIONS MUST BE CHECKED / VERIFIED ON SITE.
 - ALL DIMENSIONS ARE IN MILLIMETRES UNLESS NOTED OTHERWISE.
 - FOR GENERAL NOTES REFER TO DRAWING.

- LEGEND:**
- PROPOSED CONCRETE SLAB
 - PROPOSED ASPHALT ACCESS ROAD
 - PROPOSED FOOTWAY - BLACK ASPHALT
 - PERMEABLE SURFACE WITH TYPE 3 SUB BASE BENEATH
 - PROPOSED FOOTWAY - COLOURED ASPHALT
 - PROPOSED ASPHALT FOOTWAY PERMEABLE SUB BASE
 - PROPOSED PERMEABLE PARKING
 - CAR PARKING ACCESS
 - EXISTING CONCRETE ROAD
 - EXISTING PAVED FOOTWAY
 - EXISTING CONCRETE FOOTWAY
 - EXISTING HARD LANDSCAPING TO BE DEMOLISHED (ALONG ACCESS ROAD ONLY)
 - PROPOSED HALF BATTERED KERB
 - PROPOSED EDGING KERB
 - PROPOSED CHANNEL KERB
 - PROPOSED TRIEF KERB

Rev.	Description	Date	By	Chkd
P05	UPDATED LAYOUT	31/03/22	DM	AMB
P04	DRAFT RIBA STAGE 4 ISSUE. REVISED DRG. NO.	11/02/22	AMB	CJS
P03	HATCHES, DETAILS AND RETAINING WALL EXTENT AMENDED	24/06/21	DM	PT
P02	Retaining wall extent and notes amended.	27/05/21	PT	PT
P01	ISSUED FOR STAGE 3	21/05/21	NG	PT

Curtins

Units 24 & 25 Riverside Place, K Village, Loud Road, Kendal, LA9 7FH
01539 724822
kendal@curtins.com
www.curtins.com

Civil & Structures • Transport Planning • Environmental • Infrastructure • Geotechnical • Conservation & Heritage • Principal Designer
Birmingham • Bristol • Cambridge • Cardiff • Chester • Dundee • Edinburgh • Glasgow • Harlow • Leeds • Liverpool • London • Manchester • Nottingham

ISSUED FOR CO-ORDINATION S1

GRAHAM

Project: **PRO-CURE WEST CUMBERLAND HOSPITAL PHASE 2 DEVELOPMENT**

Dig Title:

EXTERNAL WORKS PLAN AND DETAILS

Project No:	Size:	Date:	Drawn By:	Designed By:	Checked By:
072419	A1	21/05/21	N. GILL	P. THOMAS	P. THOMAS
Scale: 1:20 / 500					
Project Code:	Originator:	Zone:	Level:	Type:	Discipline:
WCHPH2-CUR - VV - ZZ - DR - C -					
90001 - P05					

WCHPH2-CUR-VV-ZZ-DR-C-90001-P05 - External Works Plan and Details.dwg