

GENERAL NOTES:

1. THIS DRAWING IS TO BE READ IN CONJUNCTION WITH ALL RELEVANT ARCHITECTS AND ENGINEERS DRAWINGS AND SPECIFICATIONS.
2. DO NOT SCALE THIS DRAWING. ANY AMBIGUITIES, OMISSIONS AND ERRORS ON DRAWINGS SHALL BE BROUGHT TO THE ENGINEERS ATTENTION IMMEDIATELY. ALL DIMENSIONS MUST BE CHECKED / VERIFIED ON SITE.
3. ALL DIMENSIONS ARE IN MILLIMETRES UNLESS NOTED OTHERWISE.

LEGEND



FLOODING WILL OCCUR IN THE WASTE COMPOUND AND ACCESS ROAD DRAINAGE SYSTEM FOR STORAGE EVENTS ABOVE THE 1 IN 100 YR - 40% CLIMATE CHANGE STORM EVENT OR IF THERE IS A BLOCKAGE.

FLOODING WILL FIRST OCCUR AT THE GULLIES, THE LOW POINT OF THE 2 PHASES, AND SURROUNDING AREAS. THIS FLOODING WILL FLOW TO THE WEST OF THE ACCESS, WHERE IT WILL POND UP TO 100mm WHERE THERE IS A KERB FACE TO HOLD THE WATER AND CONTOURS BEFORE THE ROAD FALLS TO THE SOUTH.

THE KERB WILL NOT OVERTOP AS IT HAS A 300mm FACE THE SURFACE WATER WILL INSTEAD RUN TO THE SOUTH ALONG THE RING ROAD AND EVENTUALLY OFF SITE.

FLOODING WILL OCCUR IN THE PHASE 2 DRAINAGE SYSTEM FOR STORAGE EVENTS ABOVE THE 1 IN 100 YR - 40% CLIMATE CHANGE STORM EVENT.

FLOODING WILL FIRST OCCUR AT MANHOLES S7 & RE4 THE LOW POINTS OF THE 2 PHASES, AND SURROUNDING AREAS. THIS FLOODING WILL FLOW TO THE NORTH WEST OF THE CAR PARK, WHERE IT WILL POND UP TO 125mm WHERE THERE IS A KERB FACE TO HOLD THE WATER.

IF THIS OVERTOPS, THE WATER WILL CONTINUE TO FLOW TO THE NORTH WEST AND ONTO THE EXISTING RING ROAD WHERE IT WILL FLOW TO THE SOUTHWEST AND EVENTUALLY OFF OF THE SITE.

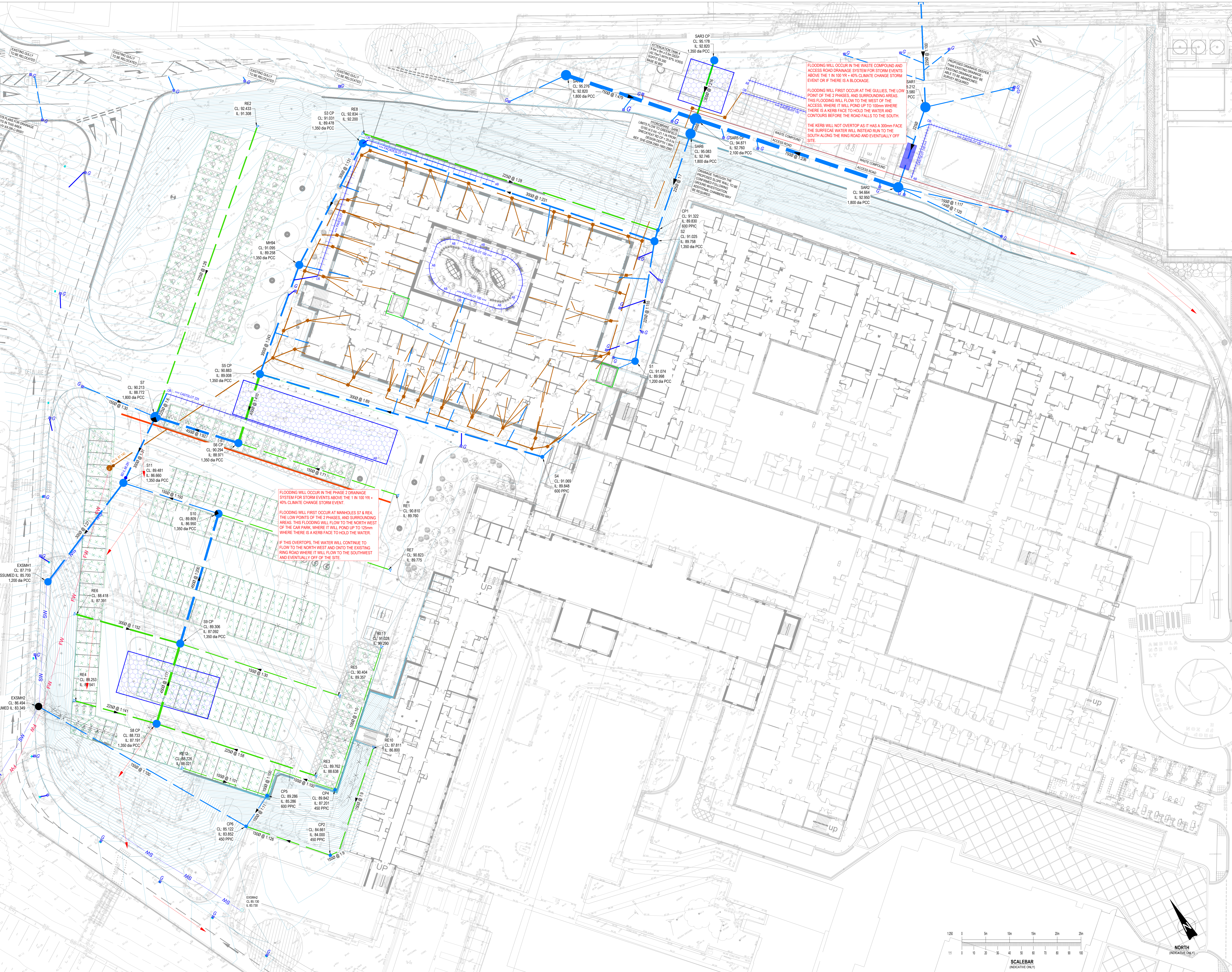

P02	UPDATED TO REFLECT THE DRAINAGE LAYOUT	31/03/22	DM	AMB
P01	FIRST ISSUE	18/09/21	DM	PT

ISSUED FOR INFORMATION **S2**

EXCEEDANCE FLOW ROUTES

Project No:	072419	Size:	A0	Date:	MAY 21	Drawn By:	DM	Designed By:	DM	Checked By:	PT
Project Code:	WCHPH2 CUR - VV - XX - DR - C - 92009 - P02	Zone:		Level:		Type:		Discipline:		Category/Number:	

