

GENERAL NOTES:

- THIS DRAWING IS TO BE READ IN CONJUNCTION WITH ALL RELEVANT ARCHITECTS AND ENGINEERS DRAWINGS AND SPECIFICATIONS.
- DO NOT SCALE THIS DRAWING. ANY AMBIGUITIES, OMISSIONS AND ERRORS ON DRAWINGS SHALL BE BROUGHT TO THE ENGINEERS ATTENTION IMMEDIATELY. ALL DIMENSIONS MUST BE CHECKED / VERIFIED ON SITE.
- ALL DIMENSIONS ARE IN MILLIMETRES UNLESS NOTED OTHERWISE.
- FOR GENERAL NOTES REFER TO DRAWING.

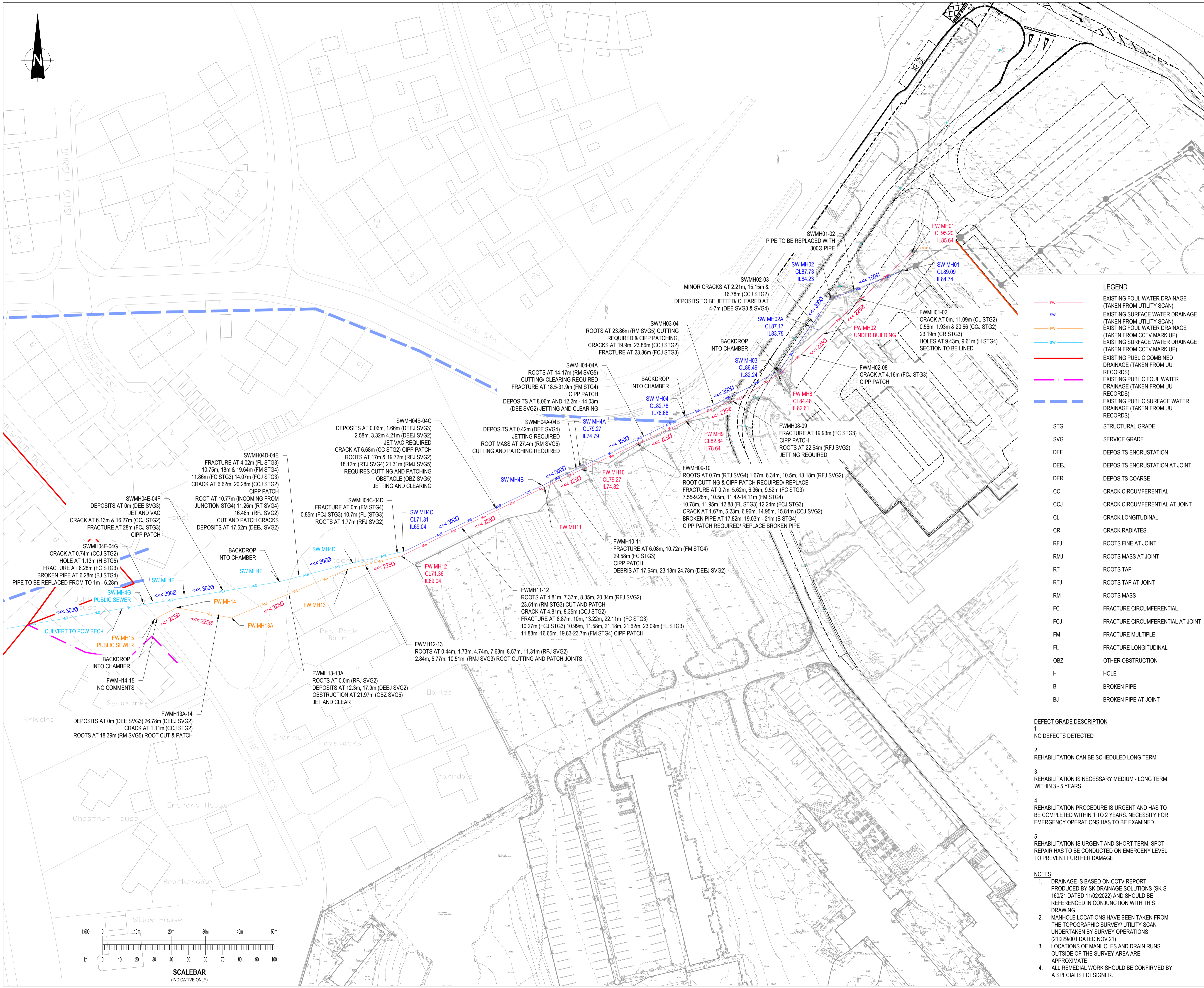

**LEGEND**

- FW EXISTING FOUL WATER DRAINAGE (TAKEN FROM UTILITY SCAN)
- SW EXISTING SURFACE WATER DRAINAGE (TAKEN FROM UTILITY SCAN)
- FW EXISTING FOUL WATER DRAINAGE (TAKEN FROM CCTV MARK UP)
- SW EXISTING SURFACE WATER DRAINAGE (TAKEN FROM CCTV MARK UP)
- EXISTING PUBLIC COMBINED DRAINAGE (TAKEN FROM UU RECORDS)
- EXISTING PUBLIC FOUL WATER DRAINAGE (TAKEN FROM UU RECORDS)
- EXISTING PUBLIC SURFACE WATER DRAINAGE (TAKEN FROM UU RECORDS)
- STG STRUCTURAL GRADE
- SVG SERVICE GRADE
- DEE DEPOSITS ENCRUSTATION
- DEEJ DEPOSITS ENCRUSTATION AT JOINT
- DER DEPOSITS COARSE
- CC CRACK CIRCUMFERENTIAL
- CCJ CRACK CIRCUMFERENTIAL AT JOINT
- CL CRACK LONGITUDINAL
- CR CRACK RADIAL
- RFJ ROOTS FINE AT JOINT
- RMJ ROOTS MASS AT JOINT
- RT ROOTS TAP
- RTJ ROOTS TAP AT JOINT
- RM ROOTS MASS
- FC FRACTURE CIRCUMFERENTIAL
- FCJ FRACTURE CIRCUMFERENTIAL AT JOINT
- FM FRACTURE MULTIPLE
- FL FRACTURE LONGITUDINAL
- OBZ OTHER OBSTRUCTION
- H HOLE
- B BROKEN PIPE
- BJ BROKEN PIPE AT JOINT

**DEFECT GRADE DESCRIPTION**

- NO DEFECTS DETECTED
- REHABILITATION CAN BE SCHEDULED LONG TERM
- REHABILITATION IS NECESSARY MEDIUM - LONG TERM WITHIN 3 - 5 YEARS
- REHABILITATION PROCEDURE IS URGENT AND HAS TO BE COMPLETED WITHIN 1 TO 2 YEARS. NECESSITY FOR EMERGENCY OPERATIONS HAS TO BE EXAMINED
- REHABILITATION IS URGENT AND SHORT TERM. SPOT REPAIR HAS TO BE CONDUCTED ON EMERGENCY LEVEL TO PREVENT FURTHER DAMAGE

**NOTES**

- DRAINAGE IS BASED ON CCTV REPORT PRODUCED BY SK DRAINAGE SOLUTIONS (SK-S 16/21) DATED 11/02/2022 AND SHOULD BE REFERENCED IN CONJUNCTION WITH THIS DRAWING.
- MANHOLE LOCATIONS HAVE BEEN TAKEN FROM THE TOPOGRAPHIC SURVEY/ UTILITY SCAN UNDERTAKEN BY SURVEY OPERATIONS (211229/001 DATED NOV 21)
- LOCATIONS OF MANHOLES AND DRAIN RUNS OUTSIDE OF THE SURVEY AREA ARE APPROXIMATE
- ALL REMEDIAL WORK SHOULD BE CONFIRMED BY A SPECIALIST DESIGNER.

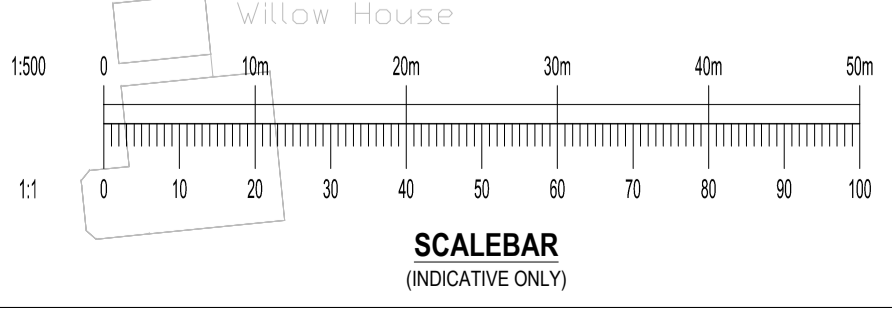

|      |                         |          |     |       |
|------|-------------------------|----------|-----|-------|
| P02  | PROPOSED DRAINAGE ADDED | 31/03/22 | DM  | PT    |
| P01  | FIRST ISSUE             | 04/03/22 | DM  | PT    |
| Rev: | Description:            | Date:    | By: | Chkd: |

Units 24 & 25 Riverside Place, K Village, Round Road, Kendal, LA9 7FH  
01539 724823  
kendal@curtins.com  
www.curtins.com

Civil & Structures • Transport Planning • Environmental • Infrastructure • Geotechnical • Conservation & Heritage • Principal Designer  
Birmingham • Bristol • Cambridge • Cardiff • Douglas • Dublin • Edinburgh • Glasgow • Harlow • Leeds • Liverpool • London • Manchester • Nottingham

Status: **ISSUED FOR INFORMATION** S2

Client: **GRAHAM**

Project: **PRO-CURE WEST CUMBERLAND HOSPITAL PHASE 2 DEVELOPMENT**

Dwg Title:

**EXISTING DRAINAGE REHABILITATION SKETCH**

|                                 |             |        |           |              |             |
|---------------------------------|-------------|--------|-----------|--------------|-------------|
| Project No:                     | Size:       | Date:  | Drawn By: | Designed By: | Checked By: |
| 072419                          | A1          | JUL 21 | DM        | PT           | PT          |
| Project Code:                   | Originator: | Zone:  | Level:    | Type:        | Discipline: |
| WCHPH2-CUR - VV - XX - DR - C - |             |        |           |              |             |

WCHPH2-CUR-VV-XX-DR-C-04008-P02\_Existing Drainage Rehabilitation Sketch.dwg