

11th March 2021

CNC Operational Unit: Visual Impact Assessment

Purpose

The purpose of the document is to illustrate the visual impact of the proposed CNC Operational Unit from several key locations external to the Sellafield site. The study does not consider any existing foliage which may further impede the view of the proposed building. The proposed building is highlighted in red only for illustration only. The proposed building will blend amongst the existing buildings with similar materials and colours (mid- light grey metal cladding). Please refer to drawings 3035271 & 3035272 for full elevation details.



Image 1 Site Aerial View



Image 2 North Gate View

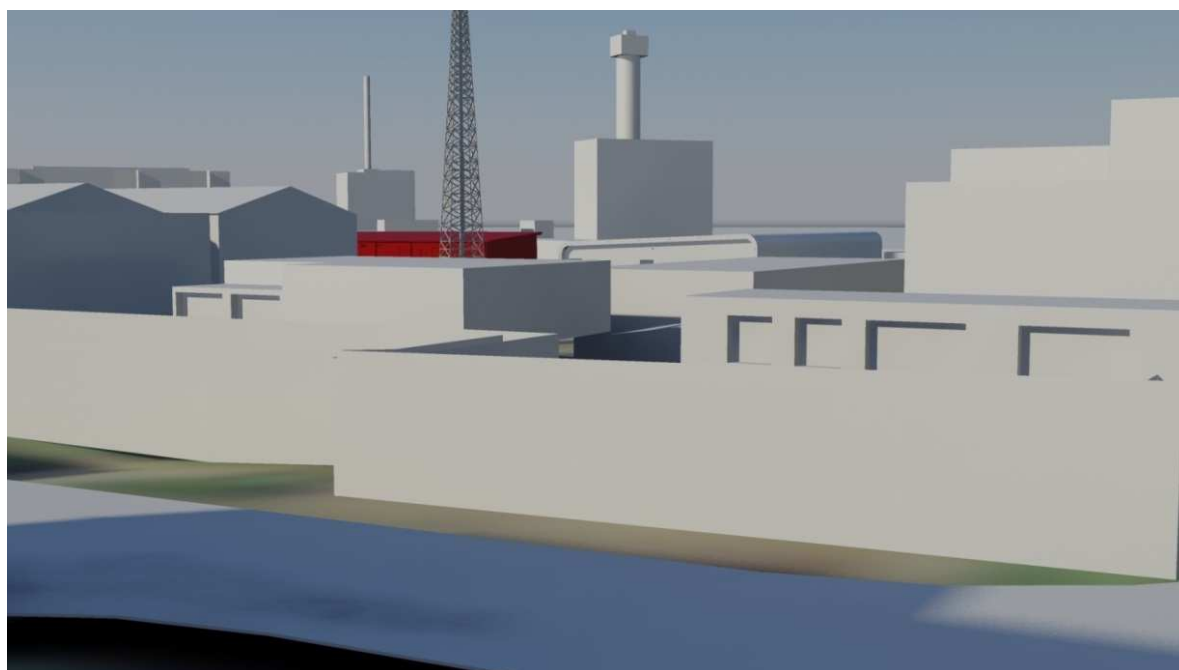

Image 3 Offsite Training Centre View



Image 4 **Fell View**

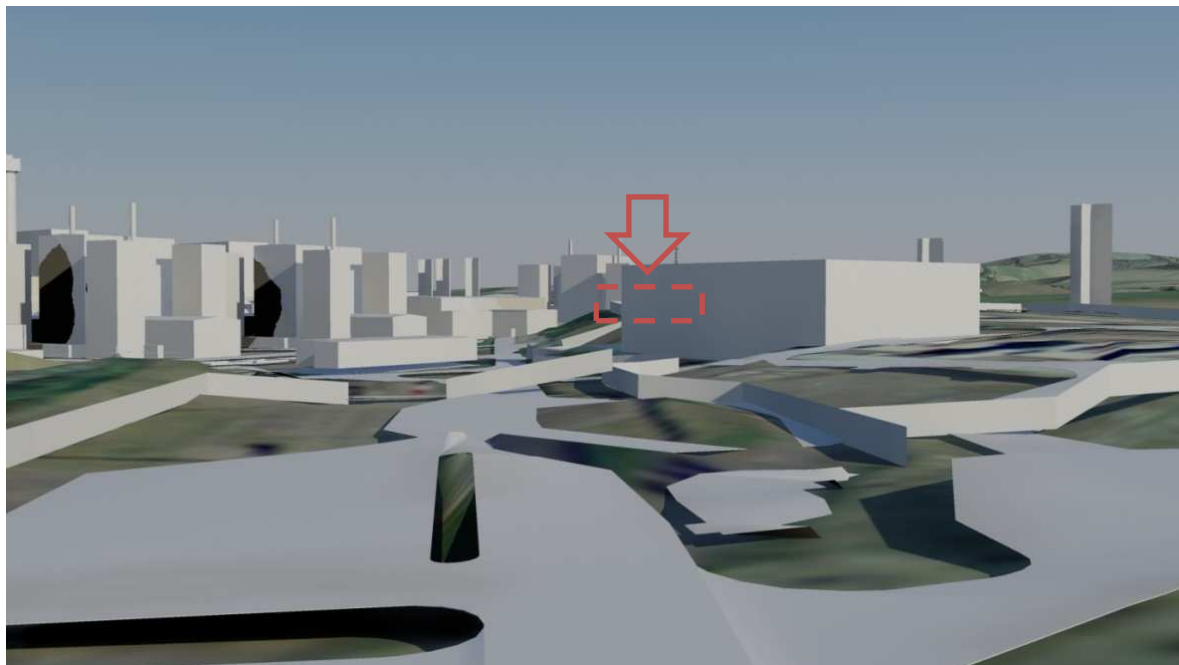

Image 5 **Calder Gate View**

Conclusion

The project has assessed the visual impact from external viewpoints around the Sellafield Site. Due to existing facilities, the proposed building mass is not dominantly visible amongst the existing townscape. The external materials specified will further reduce any visual impact, discretely blending the new building amongst the existing with similar materials and colours.

In conclusion, the visual impact of the proposed CNC Operational Unit is negligible and will not significantly affect the surrounding landscape when viewed from off the Sellafield Site.