

Ground Floor
1 : 100

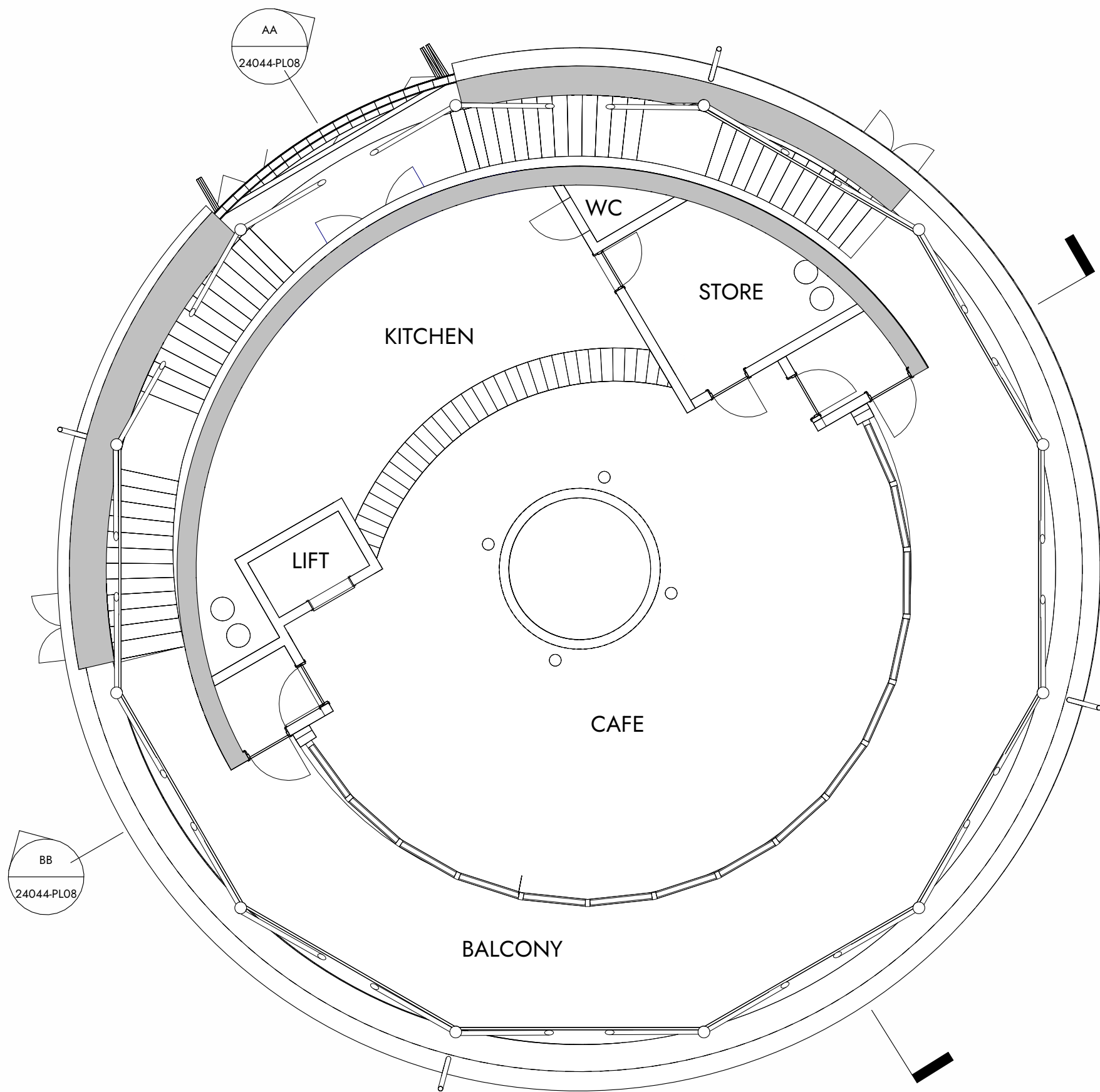

First Floor
1 : 100

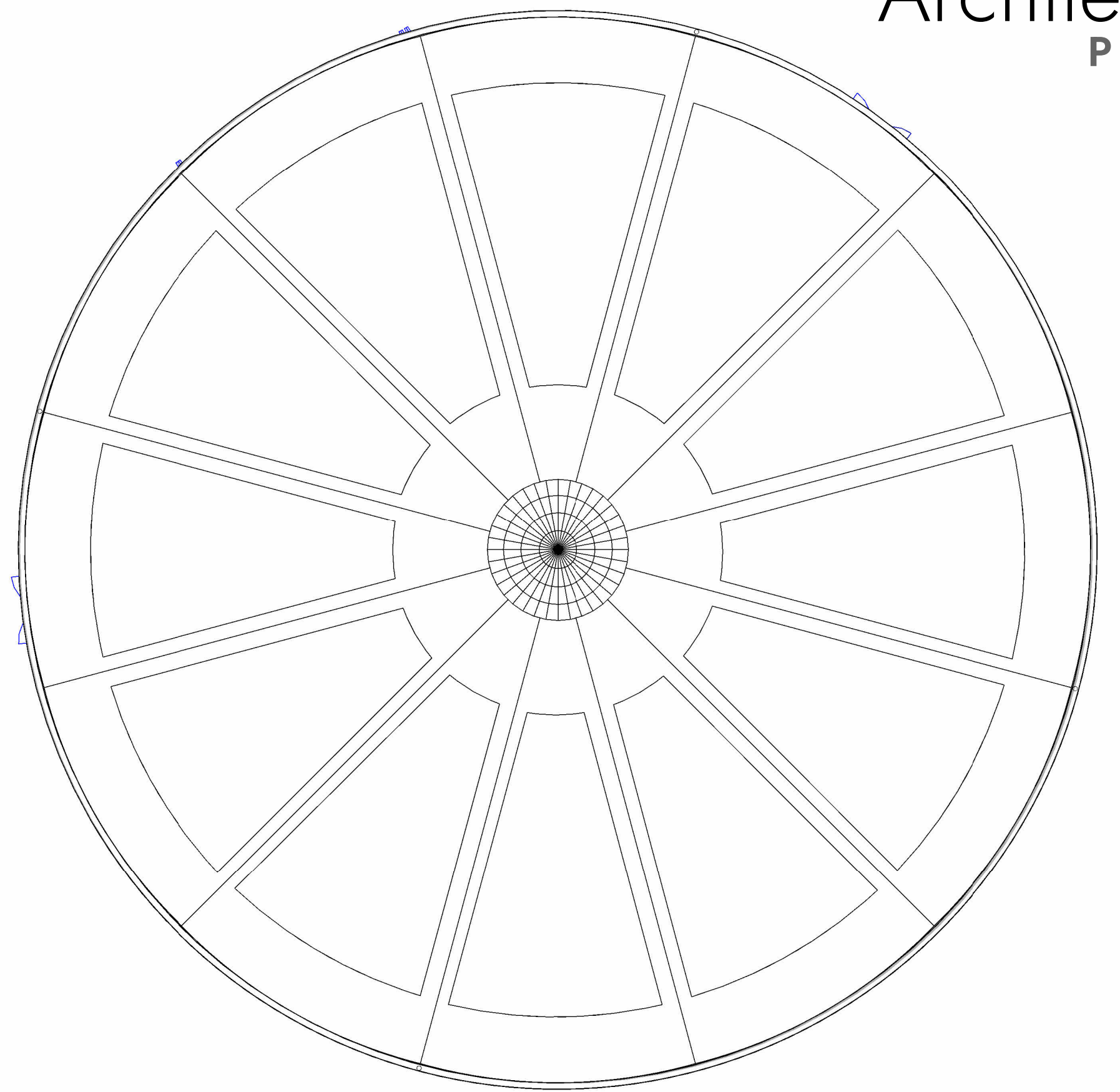

Roof Plan
1 : 100

Notes:

Roof
Metal standing seam roof, Slate grey RAL 7031 with thin film Photovoltaic strips bonded to upper surface.
Gutter and downpipes to be powder coated galvanised steel colour Dark Grey RAL7026

Walls
First Floor Cladding. Rainscreen cladding panels with mottled finish to emulate rusting steel finish in Brown/Orange
Ground floor Local stone in stainless steel Gabion baskets, with rusting steel window surrounds, heads and cills

Windows

First floor Passivhuas Certified Triple glazed wood aluminium composite with aluminium outer face powder coated to match cladding panels Brown /Orange RAL 3009
Ground floor Passivhuas Certified Triple glazed wood aluminium composite with aluminium outer face powder coated to match rusted steel surrounds RAL 3009

Doors

External Plant room and Store doors to be steel louvres/grills powder coated to match cladding panels Brown /Orange RAL 3009
Main entrance door bespoke concertina door made from rusting steel with cut out design and features.
Inner Entrance door clad to match Rainscreen cladding panels.

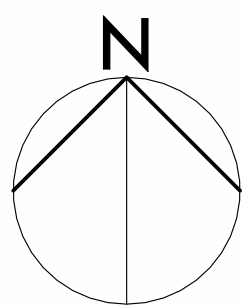

Proposed Floor Plans Ironline Project

0m 2m 4m 6m 8m 10m
VISUAL SCALE 1:100 @ A1

This drawing is to be read in conjunction with all related drawings. Dimensions must be checked and verified on site before commencing work or producing shop drawings. The originator must be notified immediately of any discrepancy. This drawing is copyright and remains the property of Architects Plus, and may not be reproduced in any way without written consent from Architects Plus.

Suite 3, Carlyle's Court, St Mary's Gate, Carlisle, Cumbria, CA3 8RY | ap@architectsplus.co.uk | 01228 515144

WWW.ARCHITECTSPUS.CO.UK

Registered Office
Suite 3, Carlyle's Court, St Mary's Gate,
Carlisle, Cumbria, CA3 8RY

Company Registration
Architects Plus (UK) Limited
Registered in England no. 4221140

| Drawing | | Revision Description | | Drawn | Approved | Date |
|----------------------|------------------|----------------------|---------------------------|------------|--------------------|----------------|
| Proposed Floor Plans | | PL - Planning | | | | |
| Project | Ironline Project | Client name | CUMBERLAND COUNTY COUNCIL | RIBA stage | 3 - SPATIAL DESIGN | |
| Date | 01/04/25 | Drawn by | RP | Scale @ A1 | 1 : 100 | Drawing number |
| | | | | | | 24044-PL07 |
| | | | | | | Revision |