

Plant Schedule							
QTY	UNIT	CODE	PLANT NAME	STOCK	FORM	GIRTH/HEIGHT	
Trees							
26 No.	ALN	GLU hs	Alnus glutinosa	RB	STD	12-14cm	
68 No.	BET	PEN hs12	Betula pendula	RB	STD	12-14cm	
29 No.	BET	JAC ms3	Betula utilis Jacquemontii	C 4SL	MSTEM3	200-250cm	
34 No.	CAR	FRA xhs18	Carpinus betulus "Frans Fontaine"	RB	STD	18-20cm	
11 No.	CER	SIL xhs14	Cercis siliquastrum	RB	STD	14-16cm	
21 No.	CRA	LAE ss	Crataegus laevigata	RB	STD	10-12cm	
20 No.	CRA	MON hs	Crataegus monogyna	RB	STD	12-14cm	
9 No.	GLE	SKY sm	Gleditsia triacanthos 'Skyline'	RB	XHS	25-30cm	
40 No.	Pop	Tre hs	Populus tremula	B	STD	12-14cm	
31 No.	PRU	pad hs	Prunus padus	RB	STD	12-14cm	
29 No.	PRU	TIB ms4	Prunus serotina var. tibetica	C 4SL	MSTEM3	250-300cm	
7 No.	ROB	BES st	Robinia pseudoacacia "Bessoniana "	RB	STD	14-16cm	
4 No.	Rob	Umb g	Robinia pseudoacacia "Umbraculifera"	RB	STD	14-16cm	
28 No.	SAL	CAP hs	Salix caprea	RB	STD	12-14cm	
41 No.	SOR	ARI hs	Sorbus aria	RB	STD	12-14cm	
29 No.	TIL	PLA hs	Tilia platyphyllos	RB	STD	12-14cm	
QTY	UNIT	CODE	PLANT NAME	STOCK	SIZE		
Hedges							
200 m	Beech Hedge		Fagus sylvatica	B Trans		60-80cm	
800 No.	Plants spaced @ 4/m in a Double Staggered Row						
722 m	Gris lit Hedge 5L		Griselinia littoralis	C 5L		60-80cm	
2888 No.	Plants spaced @ 4/m in a Double Staggered Row						
PERCENT	QTY	UNIT	PLANT NAME	STOCK	SIZE		
Hedge Mixes							
66m	NATIVE COASTAL HEDGE MIX	planted @ 6/m in a Double Staggered Row		B Trans			
40%	158 No.		Crataegus monogyna	C 3L		80-100cm	
15%	39 No.		Ulex europaeus	C 3L		30-40cm	
15%	59 No.		Prunus spinosa	B Trans		80-100cm	
10%	40 No.		Rosa canina	B Trans		60-80cm	
10%	40 No.		Sambucus nigra	B Trans		60-80cm	
To be planted in species groups of approximately 3-7.							
PERCENT	QTY	UNIT	PLANT NAME	STOCK	SIZE		
Plant Mixes							
509m2	COASTAL STRUCTURAL MIX	planted @ 6/m2		C 3L		30-40cm	
15%	458 No.		Cistus x corborientis	C 3L		30-40cm	
25%	764 No.		Hebe 'Great Orme'	C 3L		30-40cm	
20%	611 No.		Armeria maritima	C 2L		15-20cm	
15%	458 No.		Lavandula angustifolia	C 2L		30-30cm	
25%	764 No.		Pennisetum villousum	C 3L		30-40cm	
Individual varieties to be planted in groups of 3.							
618m2	COASTAL ROAD MIX	planted @ 6/m2		C 3L		Full pot	
20%	742 No.		Buxus sempervirens	C 3L		30-40cm	
10%	371 No.		Hebe 'Great Orme'	C 3L		Full pot	
10%	371 No.		Achillea millefolium 'Heidi'	C 2L		Full pot	
30%	1112 No.		Stipa tenuissima 'Pony Tails'	C 3L		Full pot	
25%	927 No.		Pennisetum villousum	C 3L		30-40cm	
5%	185 No.		Verbena Bonariensis	C 2L		Full pot	
Individual varieties to be planted in groups of 3.							
6031m2	COASTAL NATIVE SHRUB MIX 1	planted @ 2/m2		B Trans		60-80cm	
30%	3619 No.		Corylus avellana	B Trans		60-80cm	
10%	1206 No.		Crataegus monogyna	B Trans		60-80cm	
20%	2412 No.		Prunus spinosa	B Trans		60-80cm	
10%	1206 No.		Ilex aquifolium	C 3L		60-80cm	
10%	1206 No.		Rosa canina	B Trans		60-80cm	
10%	1206 No.		Rubus fruticosus	B Trans		60-80cm	
10%	1206 No.		Viburnum opulus	B Trans		60-80cm	
Individual varieties to be planted in groups of 5-10.							
1827m2	COASTAL HERBACEOUS & GRASS MIX	planted @ 3/m2		C 2L		Full pot	
10%	548 No.		Bergenia cordifolia	C 2L		Full pot	
10%	548 No.		Bergenia purpurascens	C 2L		Full pot	
10%	548 No.		Centranthus ruber 'Albus'	C 2L		Full pot	
10%	548 No.		Centranthus ruber coccineus	C 2L		Full pot	
5%	274 No.		Eryngium agavifolium	C 2L		Full pot	
5%	274 No.		Eryngium alpinum	C 2L		Full pot	
20%	1096 No.		Arnehenatherum elatius	C 1L		Full pot	
10%	548 No.		Leymus arenarius	C 3L		Full pot	
10%	548 No.		Stipa tenuissima	C 3L		Full pot	
10%	548 No.		Stipa tenuissima 'Pony Tails'	C 3L		Full pot	
Individual varieties to be planted in groups of 3 or 5.							
Eryngium to be planted away from paths.							
529m2	COASTAL ORNAMENTAL MIX 2	planted @ 6/m2		C 2L		Full pot	
25%	794 No.		Anthemis punctata	C 2L		Full pot	
15%	476 No.		Verbena Bonariensis	C 2L		Full pot	
25%	794 No.		Pennisetum villousum	C 3L		Full pot	
5%	159 No.		Hebe 'Great Orme'	C 3L		30-40cm	
10%	317 No.		Hebe 'White Gem'	C 3L		30-40cm	
10%	317 No.		Stipa tenuissima 'Pony Tails'	C 3L		Full pot	
Individual varieties to be planted in groups of 3 or 5.							
Eryngium to be planted away from paths.							
209m2	COASTAL RAIN GARDEN MIX	planted @ 3/m2		C 2L		Full pot	
20%	125 No.		Carex otrubae	C 3L		Full pot	
20%	125 No.		Filipendula ulmaria	C 3L		Full pot	
20%	125 No.		Anthoxanthum odoratum	C 1L		Full pot	
10%	63 No.		Spiraea japonica 'Candlelight'	C 3L		30-40cm	
10%	63 No.		Spiraea japonica 'Firelight'	C 3L		30-40cm	
10%	63 No.		Salix purpurea 'Nana'	C 3L		40-60cm	
10%	63 No.		Symphoricarpos x chenaultii 'Hancock'	C 3L		40-60cm	
Individual varieties to be planted in groups of 3 or 5.							
4191m2	NATIVE TREE & SHRUB MIX	planted @ 1m centres		B Trans		60-80cm	
25%	1048 No.		Crataegus monogyna	B Trans		60-80cm	
5%	210 No.		Betula pendula	B Trans		60-80cm	
10%	419 No.		Ilex aquifolium	C 3L		40-60cm	
10%	419 No.		Viburnum opulus	B Trans		60-80cm	
10%	419 No.		Corylus avellana	B Trans		60-80cm	
10%	419 No.		Sambucus nigra	B Trans		60-80cm	
25%	1048 No.		Prunus spinosa	B Trans		60-80cm	
5%	210 No.		Alnus glutinosa	B Trans		60-80cm	
Individual varieties to be planted in groups of approximately 3-5.							
1076m2	BULB MIX 4	planted @ 20/m2					
33%	7102 No.		Galanthus nivalis		5-6cm		
33%	7102 No.		Crocus vernus		5/4 cm		
34%	7317 No.		Narcissus pseudonarcissus		10-12cm		
Individual varieties to be planted in groups of approximately 7.							
4929m2	GENERAL WILDFLOWER MEADOW MIX	planted @ 1/m2					
100%	4929 No.		No. EM2 Standard General Purpose Meadow Mixture		Seed		
Seeded at 4g m2 over prepared ground							
1004m2	WET MEADOW MIX	planted @ 1/m2					
100%	1004 No.		No. Wet Wildflower Meadow Seed Mix		Seed		
Seeded at 4g m2 over prepared ground from Habitat Aid							
1501m2	MARGINALS MIX	planted @ 4/m2					
10%	600 No.		Carex riparia	C 0.5L			
15%	901 No.		Caltha palustris	C 0.5L			
25%	1501 No.		Juncus effusus	C 0.5L			
15%	901 No.		Lythrum salicaria	C 0.5L			
20%	1201 No.		Iris pseudocorus	C 0.5L			
15%	901 No.		Alisma plantago-aquatica	C 0.5L			
Individual varieties to be planted in groups of 7.							
Notes and Abbreviations							
B	= Bare root (bagged).						
C	= Container (or pot) grown, followed by size of the container (or pot).						
FORM	= Shape of tree as supplied by the nursery.						
QTY	= Quantity						
RB	= Rootballed (balled and wrapped).						
SIZE	= Height or Spread of juvenile plant.						
Std	= (clear stem) Standard.						
STOCK	= Root condition/protection method eg Bare root.						
Trans	= Transplant (or undercut seedling).						
- Refer to specification for further information.							
- All plants to be completely handened off							
- Substitutions to be agreed with Landscape Architect.							
Plant Schedule generated by "Gscape" software 18/05/2022							

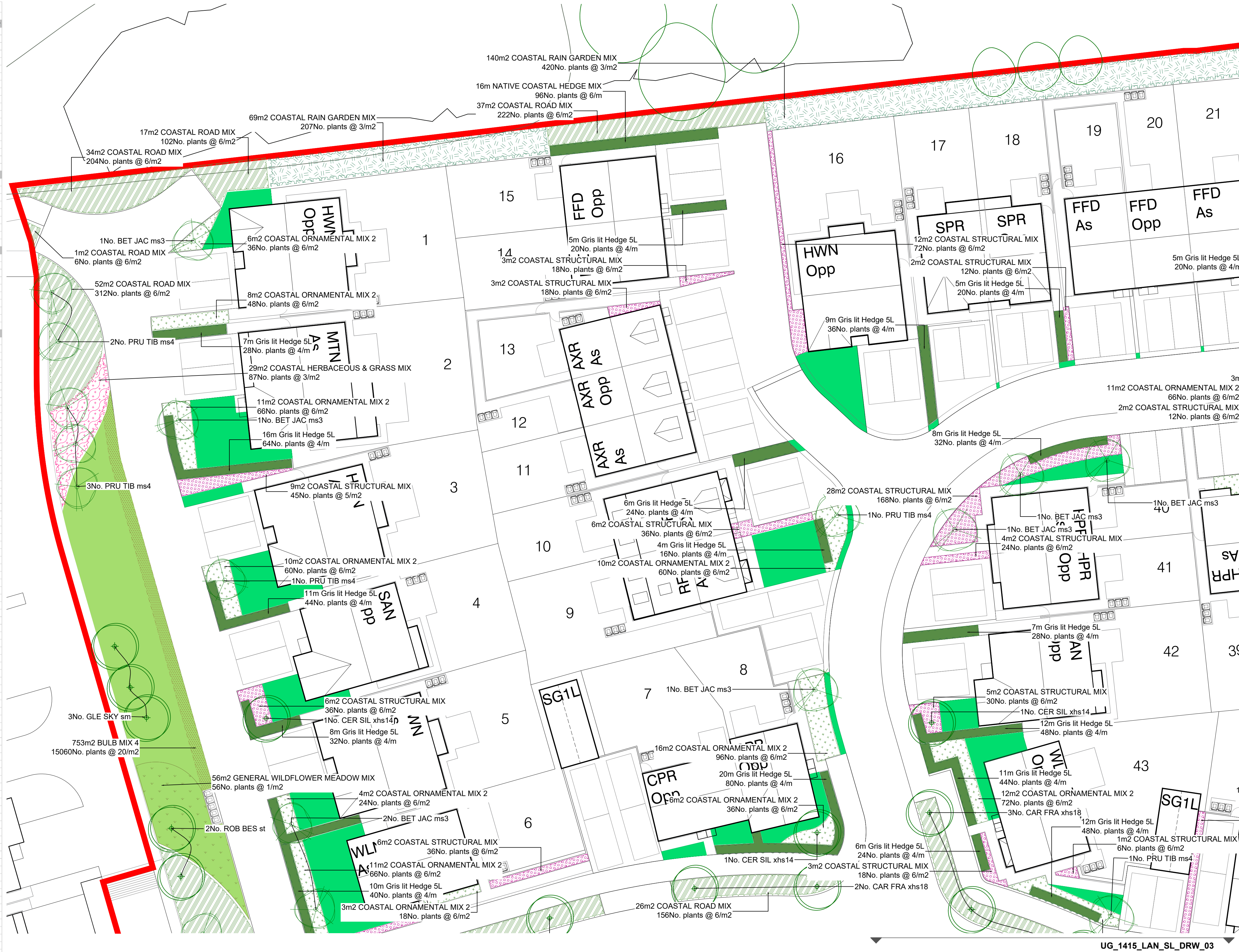

## KEY

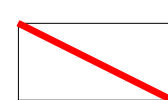

RED LINE  
BOUNDARY

## Soft Works



EXISTING TREES  
To be retained

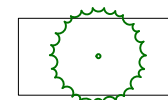

TREE PLANTING TO OPEN PUBLIC SPACES  
Refer to planting schedule for further information

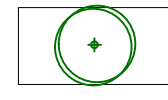

TREE PLANTING TO RESIDENTIAL PROPERTIES  
Refer to planting schedule for further information



MULTISTEM TREE PLANTING TO RESIDENTIAL PROPERTIES AND LINEAR PARK  
Refer to planting schedule for further information



HEDGEROW PLANTING  
Refer to planting schedule for further information

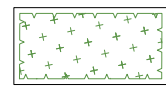

PLANTING MIX TO RESIDENTIAL PROPERTIES - TYPE 1  
Refer to planting schedule for further information, section *Coastal Ornamental Mix*



PLANTING MIX TO RESIDENTIAL PROPERTIES - TYPE 2  
Refer to planting schedule for further information, section *Coastal Structural Mix*

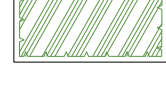

STREET PLANTING MIX  
Refer to planting schedule for further information, section *Coastal Road Mix*

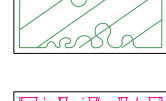

WOODLAND PLANTING MIX  
Refer to planting schedule for further information, section *Coastal Native Shrub Mix*

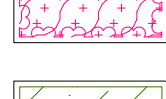

HERBACEOUS PERENNIAL & GRASS PLANTING MIX  
Refer to planting schedule for further information, section *Coastal Herbaceous & Grass Mix*



NATIVE TREE AND SHRUB PLANTING MIX  
Refer to planting schedule for further information, section *Native Tree and Shrub Planting Mix*



SUDS PLANTING MIX  
Refer to planting schedule for further information, section *Coastal Rain Garden Planting Mix*

TURF GRASS

AMENITY GRASS

MEADOW PLANTING

WET MEADOW  
Refer to planting schedule for further information, section *Wet Meadow Mix*

BULB MIX PLANTING

MARGINAL PLANTING  
Refer to planting schedule for further information, section *Marginals Mix*

SUDS POND

Do not scale this drawing (printed or electronic version).

Contractors must check all dimensions from site.

This drawing is copyright and is for use on this site only. This drawing should be read in conjunction with all relevant consultants drawings and specialist subcontractors / supply chain drawings and specifications.

All works to be carried out in accordance with the latest British Standards / Codes of Practice unless specifically directed otherwise in the specification.

Responsibility for the reproduction of this drawing in paper form, or issued in electronic format, lies with the recipient to check that all information has been replicated in full and is correct when compared to the original paper or electronic image.

Graphical representations of equipment on this drawing have been co-ordinated, but are approximations only. Please refer to the specifications and / or details for actual sizes and / or specific contractor construction information.

## Notes:-

P04	03/08/22	Issue for planning	KT	MT
P03	03/08/22	Issue for planning	KT	MT
P02	01/08/22	Second issue for planning	KT	MT
P01	13/06/22	First issue for planning	KT	MT
REV.	DATE	DESCRIPTION	DRAWN	CHK'D

URBANGREEN

A: Ground Floor, The Tower,  
Deva City Office Park, Trinity Way,  
Manchester M3 7BF

T: +44 (0) 161 312 3131

[weareurbangreen.co.uk](http://weareurbangreen.co.uk)

Client: **Story Homes**

Project: **Edgehill Park, Phase 4**

Title: **Soft Landscape Plan Sheet 1 of 7**

Issue: **Planning**

Drawn: <b>KT</b>	Checked: <b>MT</b>	Approved: <b>ME</b>
Project: <b>UG1415</b>	Scale @ A1: <b>1:200</b>	Date: <b>07/03/2022</b>
Dwg No: <b>UG_1415_LAN_SL_DRW_01</b>	Revision:	<b>P03</b>