

- Key**
- Standard scaffold poles
 - Heavy gauge 2 m tall galvanized tube and welded mesh infill panels
 - Panels secured to uprights and cross-members with wire ties
 - Ground level
 - Uprights driven into the ground until secure (minimum depth 0.6 m)
 - Standard scaffold clamps



- Key**
- Root Protection Area
 - Group of Trees
 - Tree to be removed
 - Protective Fencing
 - T1 Individual Tree
 - H1 Hedge

- LEGEND**
- Blm of Batter
 - Top of Batter
 - Fence (General)
 - Fence (Palisade)
 - Fence (Metal)
 - Fence (Close Board)
 - Hedge/line
 - Wall
 - Building (Structure)
 - Road (Channel)
 - Track
 - Kerbing
 - Footpath
 - Vegetation
 - Crash Barrier
 - Concrete
 - Tarmac / Asphalt
 - Drop Kerbing
 - Centreline
 - Verge
 - Edging Kerbs
 - Watercourse / Ditch
 - Contour (Major)
 - Contour (Minor)
 - Overhead Electric Cable
 - Overhead Telecom Cable

- Ground Level
- Lampost
- Electricity Pole
- Telegraph Pole
- Gas Valve
- Cables / Conduits
- British Telecom
- Bollard
- Survey Station
- Sign Post
- Tree
- Bush / Shrub
- Hedges / Overgrowth
- Waste Bin
- Filter Drain
- Manhole (Square)
- Manhole (Circular)
- Stop Valve
- Air Valve
- Fire Hydrant
- Stop Cock
- Invert Level
- Wash Out
- Road Gully
- Gully
- Metal Pole
- Lighting Column
- Wooden Post

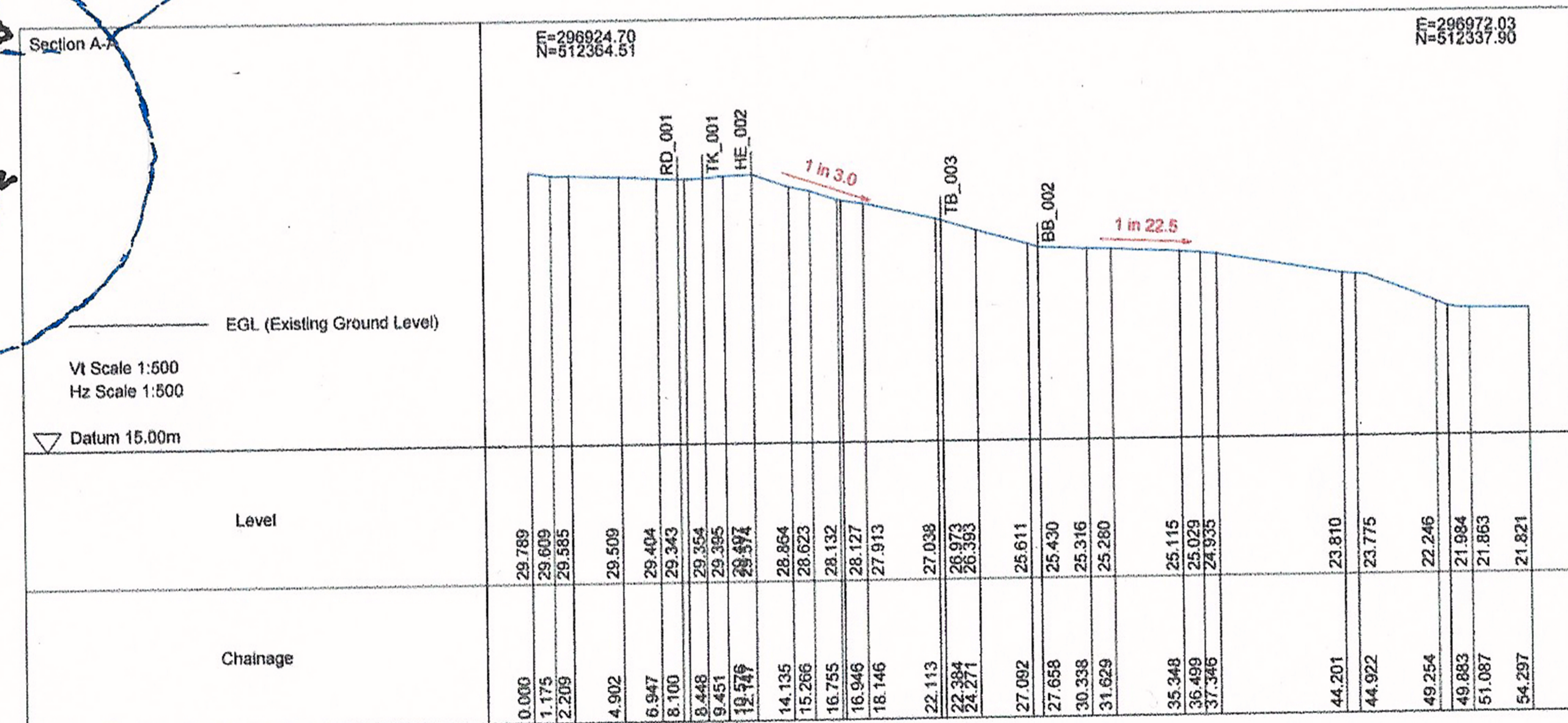
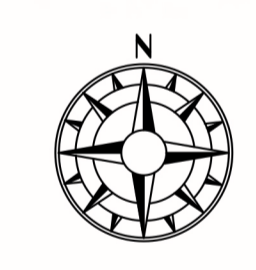

ASHWOOD
DESIGN ASSOCIATES LTD

Solway House Business Centre, t 01228 510616
Parkhouse Road, e admin@ashwooddesign.co.uk
Carlisle, w www.ashwooddesign.co.uk
CA6 4BY

Purpose: **Planning**

Client: -

Project: **Land Adjacent to St Bees School**

Title: **Tree Protection Plan**