

- 1) CONCRETING OF YARD IS TO REDUCE DIRTY WATER RUN-OFF, + REPLACE WITH CLEAN WATER RUN-OFF INTO EXISTING "OPEN" + "PIPED" DRAINS.
- 2) AREA 'A' = 356.3 m², AREA 'B' = 244.2 m², TOTAL 600.5 m².
- 3) VOLUME OF WATER EFFECTED PER YEAR, USING MET. OFFICE DATA FOR ST. BEES, 2022 (1109 mm RAINFALL PER YEAR) IS CALCULATED AT 600.5 m² x 1.109 m RAINFALL = 666.95 cu.m. /YEAR [WALNEY DATA OF 1026 mm /YEAR = 616.11 cu.m. /YEAR]
- 4) ALL YARD FALLS TO SUIT NEAREST DISCHARGE POINT INTO EXISTING DRAIN SYSTEMS.
- 5) RETAIN EXISTING BUILDING RAINWATER DOWNPIPES + GULLIES /DRAINS /SOAKAWAYS AS REQ'D.
- 6) HARDCORE, WHERE POSSIBLE TO BE RECYCLED CRUSHED CONCRETE ETC FROM OTHER AREAS WITHIN THE FARM.
- 7) VOLUME OF CONCRETE AT 150mm THICKNESS = 90.075 cu.m.

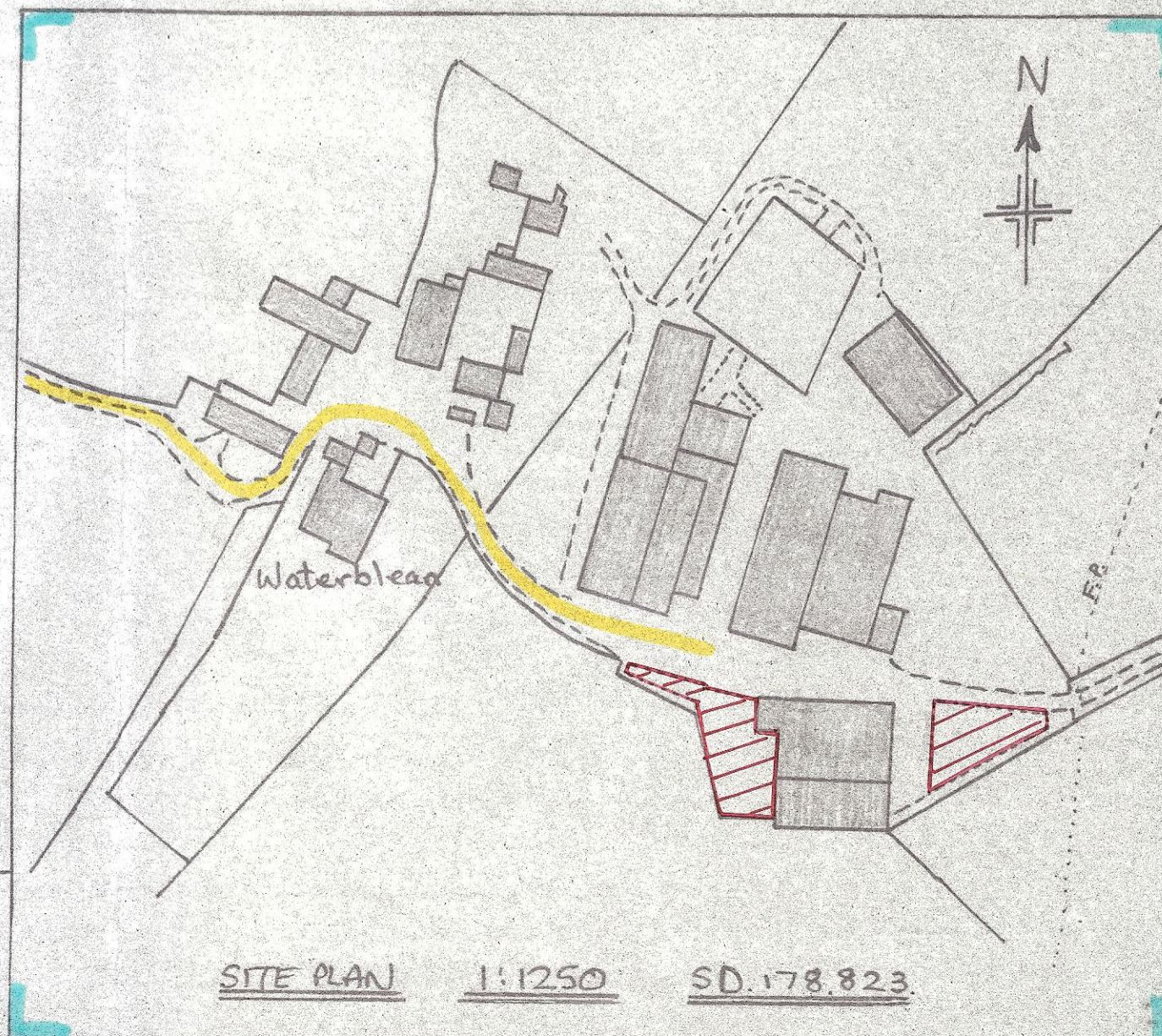
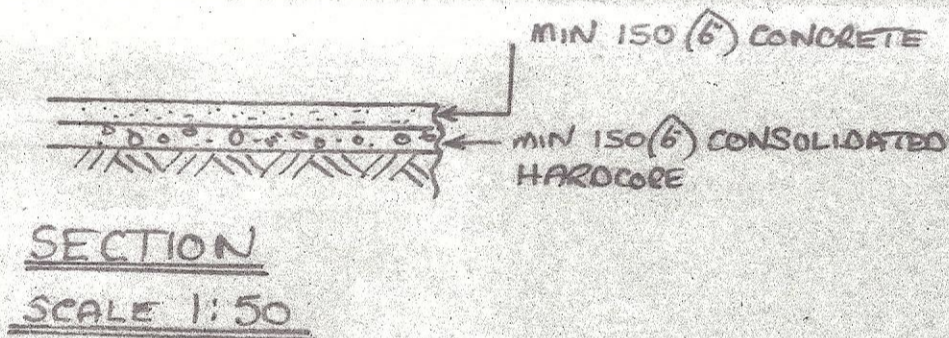

PROPOSED CONCRETING OF YARDS AT WATERBLEAN FARM, THE HILL, MILLOM, CUMBRIA, FOR R. FALCONER & SON.

SITE PLAN 1:1250 SD.178.823

11-12-23

R.A. WALKER
LADYHALL-MILLOM

1792