

- 1) ALL TIMBER WORK TO BE TREATED WITH A PRESERVATIVE.
- 2) CAVITIES AROUND OPENINGS INCLUDING LINTELS TO BE INSULATED TO PREVENT 'COLD BRIDGING' + CLOSED WITH 1/2 HOUR FIRE RESISTANT MATERIAL.
- 3) ALL ELECTRICAL WORK TO BE DESIGNED, INSTALLED, INSPECTED + TESTED IN ACCORDANCE WITH BS 7671 (SEE WIRING REGS - LATEST EDITION) + WORK UNDERTAKEN BY AN INSTALLER REGISTERED UNDER SUITABLE ELECTRICAL SELF CERTIFICATION SCHEME, OR QUALIFIED PERSON SUPPLYING A CERTIFICATE OF COMPLIANCE TO BUILDING CONTROL ON COMPLETION.
- 4) ALL ELECTRICAL SOCKETS + SWITCHES TO BE LOCATED BETWEEN 450 + 1200 (1'4" - 3'11") ABOVE FLOOR.
- 5) PROVIDE INTERNAL LIGHT FITTINGS CAPABLE OF TAKING EFFICIENT LAMPS. MIN 75 LUMENS PER CIRCUIT WATT. EXTERNAL LIGHTS TO BE EITHER EFFICIENT AS ABOVE, OR ON A TIMER + AUTOMATICALLY EXTINGUISHED IN DAYLIGHT.
- 6) GLASS PANELS IN DOORS + ADJACENT TO, TO BE TOUGHENED / LAMINATED TO BS 6206 (P9)
- 7) EXTERNAL DOORS TO BE MIN 838 (2'9") TO GIVE MIN CLEAR OPENING WIDTH OF 800(2'6")
- 8) KITCHEN/DINER TO HAVE OPENING DOORS / WINDOWS / REELECTS EQUAL TO AT LEAST 1/20 TOTAL FLOOR AREA. 3 OFF 8000mm<sup>2</sup> (13 1/2") TRUCKLE VENTS, + 60 LITRE/SEC CAPACITY EXTRACTION FAN (30 LITRE/SEC IF COOKER HOOD), MAX 45 dB(A) AT NORMAL WORKINGS. [ALL NEW / REPLACEMENT WINDOWS TO INCLUDE TRICKLE VENTS]
- 9) HOME OWNER TO BE PROVIDED WITH AN 'EXISTING HOME' VENTILATION GUIDE, EXPLAINING HOW TO USE + VENTILATE EFFICIENTLY BY BUILDER PRIOR TO COMPLETION.
- 10) ALL DRYLINING BOARDS TO HAVE JOINTS + EDGES TAPE SEALED, + ALL ELECTRICAL BACK BOXES, CONDUITS ETC. TO BE SEALED WITH MASTIC / FOAM TO MAINTAIN AIRTIGHTNESS. INSULATION TO BE CONTINUOUS AT JUNCTIONS OF ROOF, WALL + FLOOR.
- 11) ALL DRAINAGE TO BE TO THE SATISFACTION OF LOCAL AUTHORITY. EXISTING PUBLIC MAINS COMBINED SEWER SEWERS.
- 12) A MAINS OPERATED FIRE DETECTION / ALARM SYSTEM TO BE INSTALLED TO BS 5839 - 4, 2004, GRADE D, CATEGORY L03, WITH SMOKE ALARMS TO BS EN 5404, SHOWN (S), + HEAT ALARM TO BS 5446-2, SHOWN (H), LOCATED ON CEILING, MIN 300(12") FROM WALLS + LIGHT FITTINGS, ALL INTERCONNECTED SO ALL SOUND WITH DETECTION BY ANY ONE UNIT. MAINS SUPPLY TO BE A SINGLE INDEPENDANT CIRCUIT. + DETECTORS TO HAVE A STANDBY BATTERY SUPPLY, I.E. BATTERY
- 13) A CARBON MONOXIDE (CO) ALARM TO BE FITTED IN KITCHEN, TO BS EN 50291-1: 2018. + HAVE A BATTERY DESIGNED TO OPERATE FOR THE WORKING LIFE OF ALARM, + ALSO INCORPORATE A WARNING DEVICE TO ALERT USERS WHEN WORKING LIFE OF ALARM IS DUE TO PASS, LOCATED ON CEILING, BETWEEN 1 + 3m (3 1/4" - 9'10") HORIZONTALLY FROM GAS BOILER, + MIN 300(12") FROM WALLS

- 14) CONSERVATION OF ENERGY DETAILS (PORCH EXEMPT)  
 U VALUE OF GROUND FLOOR - 0.18, U VALUE OF WALLS - 0.18, U VALUE OF CEILING - 0.15  
 FLOOR AREA OF EXTENSION = 18.64 M<sup>2</sup>, 25% = 4.66 M<sup>2</sup>, 12.23 M<sup>2</sup> (MAX NEW OPENINGS AREA OF OPENINGS LOST DUE TO EXTENSION) 7.57 M<sup>2</sup> AT BASIC U VALUES  
 AREA OF BI-FOLD DOORS ALUM. FRAME, MIN 20mm GAP D/G/T/G, U VALUE 1.4 = 6.5 M<sup>2</sup>  
 AREA OF WINDOW UPVC FRAME, MIN 20mm GAP D/G, U VALUE 1.4 = 0.825 M<sup>2</sup> 8.965 M<sup>2</sup>  
 AREA OF ROOF LIGHTS, TIMBER FRAME, VELUX 562, 001 0520, U VALUE 1.3 = 1.84 M<sup>2</sup> (6)
- 15) RELOCATED / NEW MAINS GAS COMBINATION, CONDENSING BOILER TO BE LOCATED IN KITCHEN, WITH FAN ASSISTED FUE + WIRE MESH TERMINAL GUARD, MIN 300(12") FROM OPENING WINDOW, MIN 90 SEEBUK (EFFICIENCY) BY CORG APPROVED INSTALLER.
- 16) OWNER/OCCUPIER TO BE SUPPLIED WITH HEATING + HOT WATER SYSTEM OPERATING MANUAL + SAME SYSTEM COMMISSIONED ON COMPLETION OF INSTALLATION. SPACE HEATING TO BE VIA EXISTING RADIATOR SYSTEM EXTENDED.

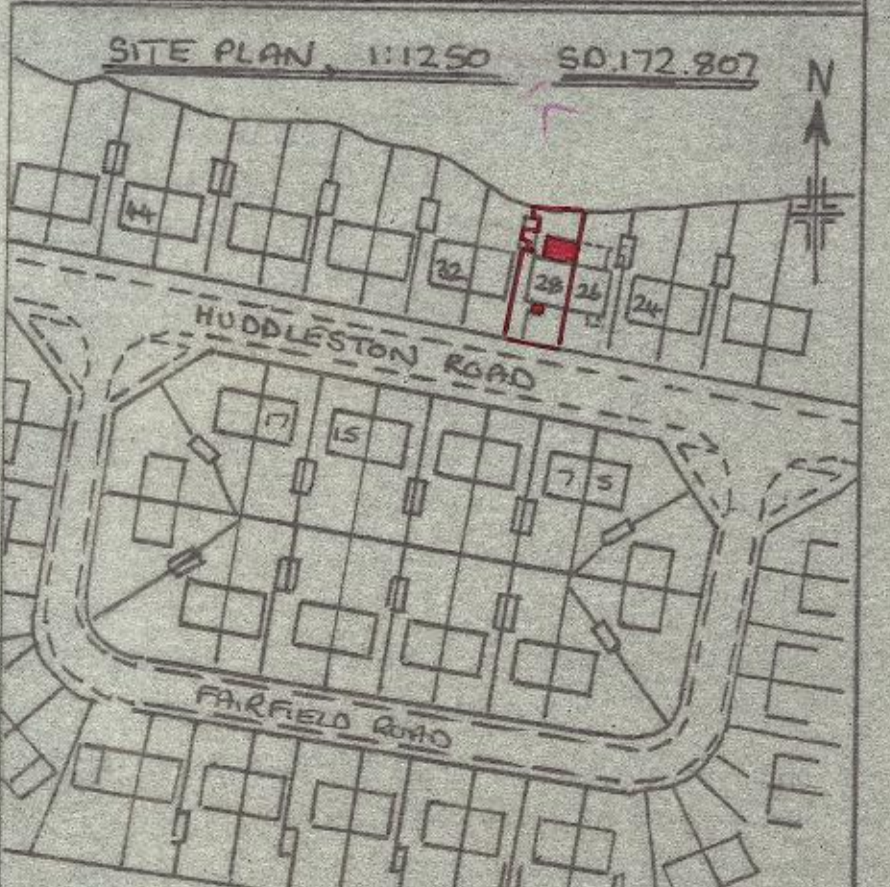
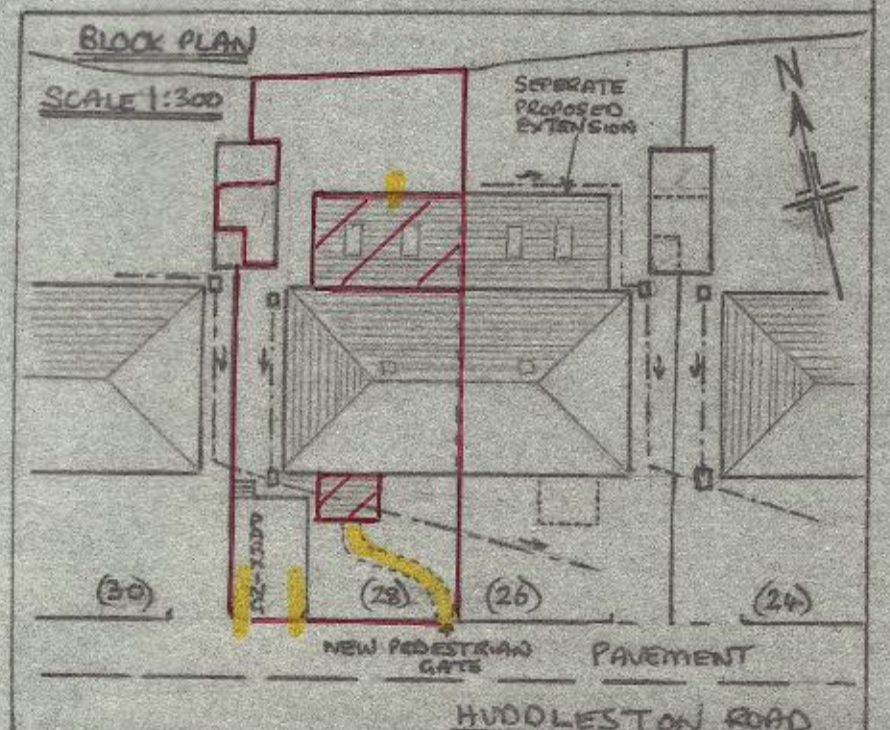

PROPOSED EXTENSIONS AT 28 HUDDLESTON RD, MILLOM, CUMBRIA FOR Mr J BARKER