

Existing Ground Floor Layout

Edge of pavement

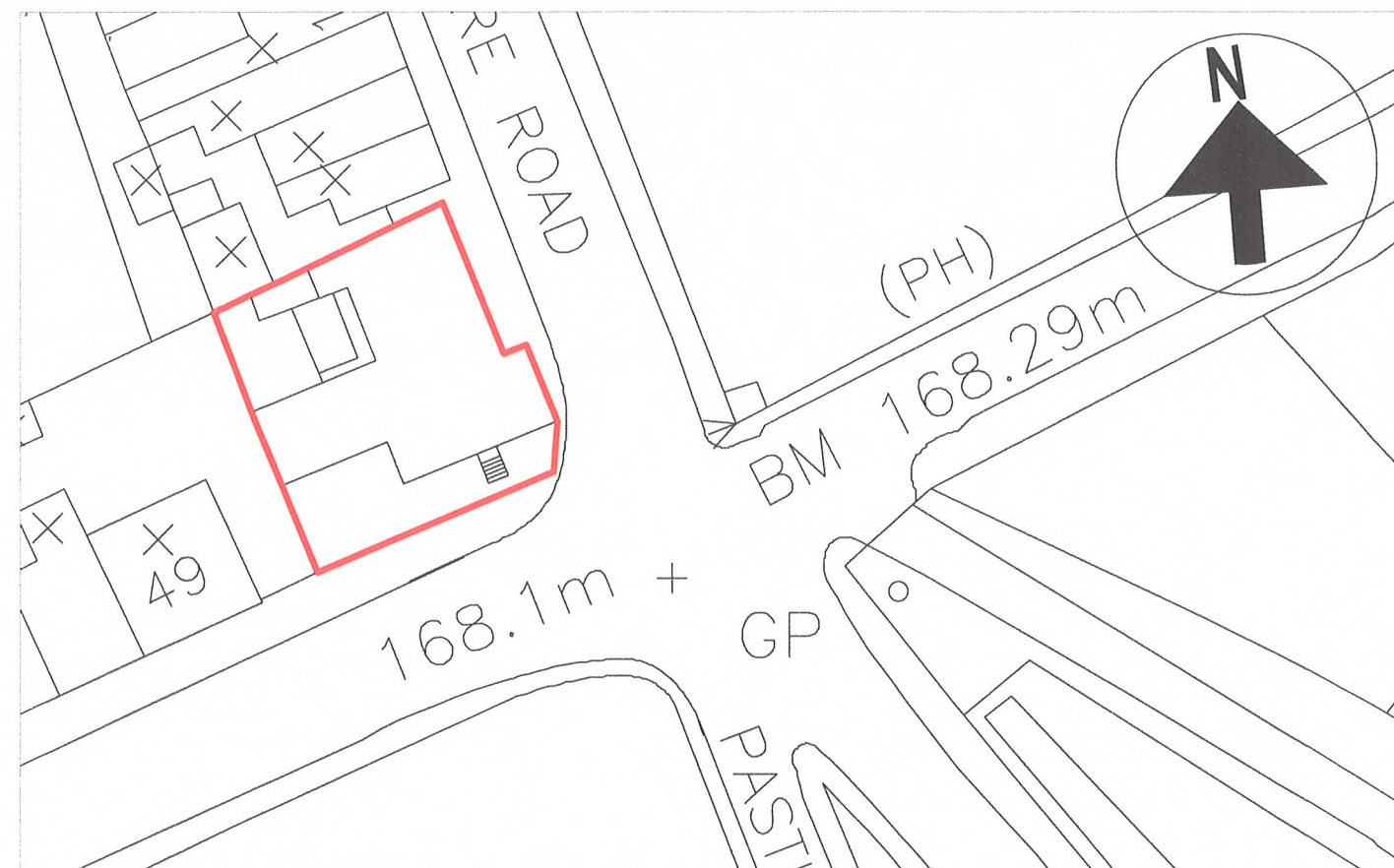

Location plan
scale 1/500

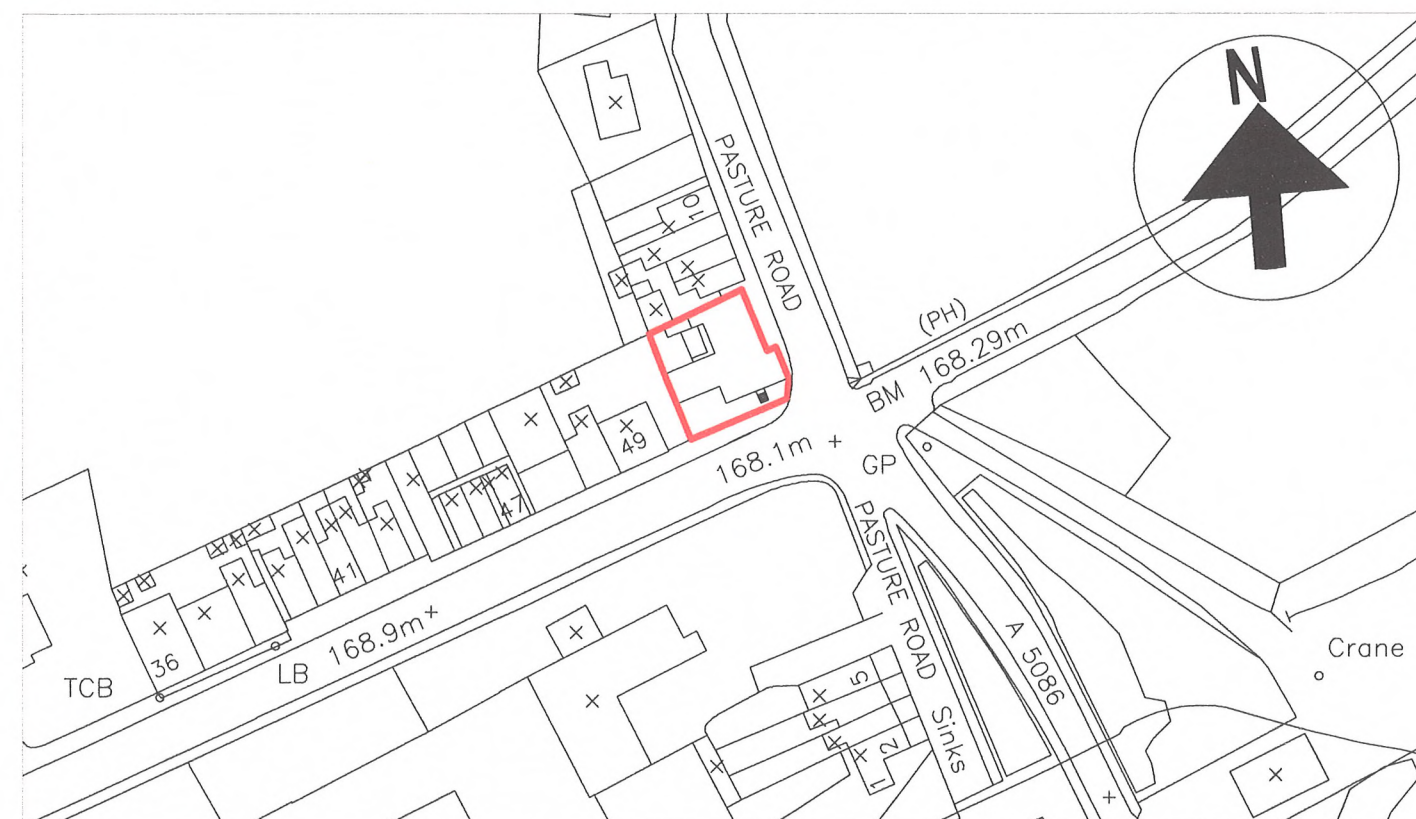

Location plan
scale 1/1250

The drawing is the property of JTS Architectural services, and is not to be copied, used or shown to any third party without written consent.



Address	Stork Hotel, Rowrah Road, Rowrah, Frizington, Cumbria
Title	Existing Ground Floor Plan & Location Plans- DWG01
Project	Replacement Entrance steps Planning Application Drawing
Job Number	1701
Scale	1/100, 1/500 & 1/1250