

MEMORANDUM - Amendment

1. This memorandum refers to the Pre-development Arboricultural Report of 12/01/20 (plus amendments dated 28/05/20) for Plot 8 Rheda Park, Frizington prepared by Treescapes Consultancy Ltd. That report was written in accordance with the current British Standard BS5837:2012 Trees in relation to design, demolition, and construction – Recommendations.
2. I believe Daniel Lock now to be the owner of Plot 8 and he has told me that consent has been granted to construct a dwelling and outbuilding/workshop.
3. I understand that the above Pre-development Arboricultural Report plus amendments supported the application but was written using a layout that was subsequently amended by the architect, Stuart Woodall of Green Swallow Ltd.
4. On behalf of Mr Lock, I was provided by Craig Wallace of CJW Surveys Ltd on 02/12/22 with a digital drawing of the layout that I understand to be that for which permission has been granted. Accompanying this memorandum is an amended Plan 2 – Tree Constraints Plan based on that drawing.

I consider that there will be three trees, further to those identified in Table 1 of the report, that are also with root protection areas (RPAs) and canopies that encroach into the footprint of proposed structures or within 2m of them. I consider it likely that these three trees will now also to be adversely impacted by the development as granted. They are trees 1.16, 1.17, and 2.08. NB I am advised by Mr Lock that tree 2.08 has already fallen.

5. In addition to those trees now impacted by development (as above) I recommend that tree 1.19 also be removed before the building works are undertaken. It will be sufficiently close to one of the structures so that an application to remove it in the future may be foreseen. I believe that to do so now as part of the planning consent would be both expedient and wise.
6. In Section 6 of my report, I made recommendations for various tree works to facilitate the proposed development in Plot 8, how they should be implemented and how any retained trees should be protected. In addition to those recommendations, and further to tree 2.08 having fallen, I now recommend that trees 1.16, 1.17, and 1.19 in Plot 8 should also be felled.
7. As page 3 of this memorandum is an amended Plan 3 - Tree Protection Plan showing all the trees I now recommend be felled in Plot 8 (including tree 2.08 for completeness) and my recommendations for protecting those trees to be retained. Appendix 7 of the original report shows suitable tree protection barriers and temporary ground protection measures.
8. I note that the current British Standard (i.e. BS5837:2012 Trees in relation to design, demolition and construction – Recommendations) in Section 6 – Technical Design such provisions are also recommended.

Eddie Cruickshank – Treescapes Consultancy Ltd.

Rheda Park, Plot 8

Plan 2
Tree Constraints Plan showing the approximate proposed site layout and the approximate locations of the trees.

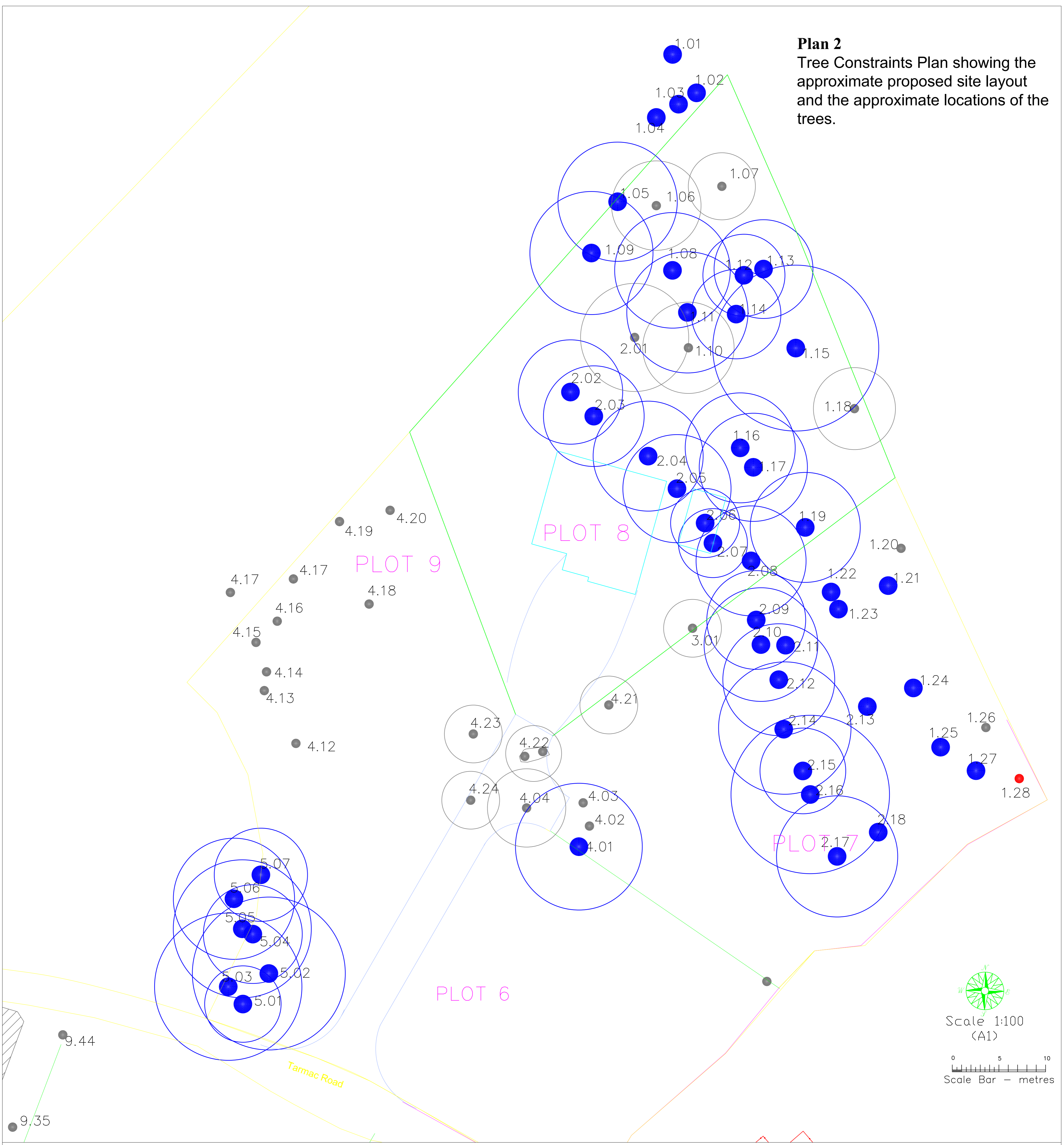

Key to Plan 2

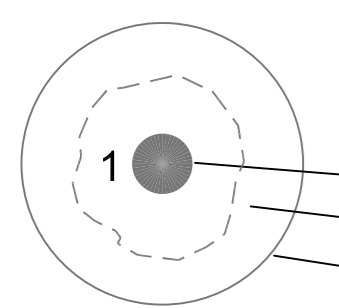

The approximate location of a tree and its respective number.

- Trunk
- Crown Spread
- Root Protection Area (RPA)

Green Retention Category A
 Blue Retention Category B
 Grey Retention Category C
 Red Retention Category U



The approximate extents of Plot 8.

The approximate outline of a proposed new driveway and other hard surfaces

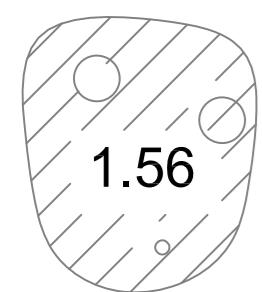

The approximate location of a tree group and its respective number.

Green Retention Category A
 Blue Retention Category B
 Grey Retention Category C
 Red Retention Category U

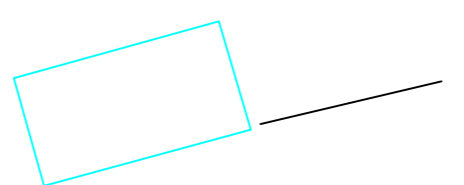

The approximate outline of a proposed new building

The approximate extent of the proposed new roadway

Rheda Park, Plot 8

Plan 3
Tree Protection Plan showing the approximate proposed site layout and the tree protection measures.

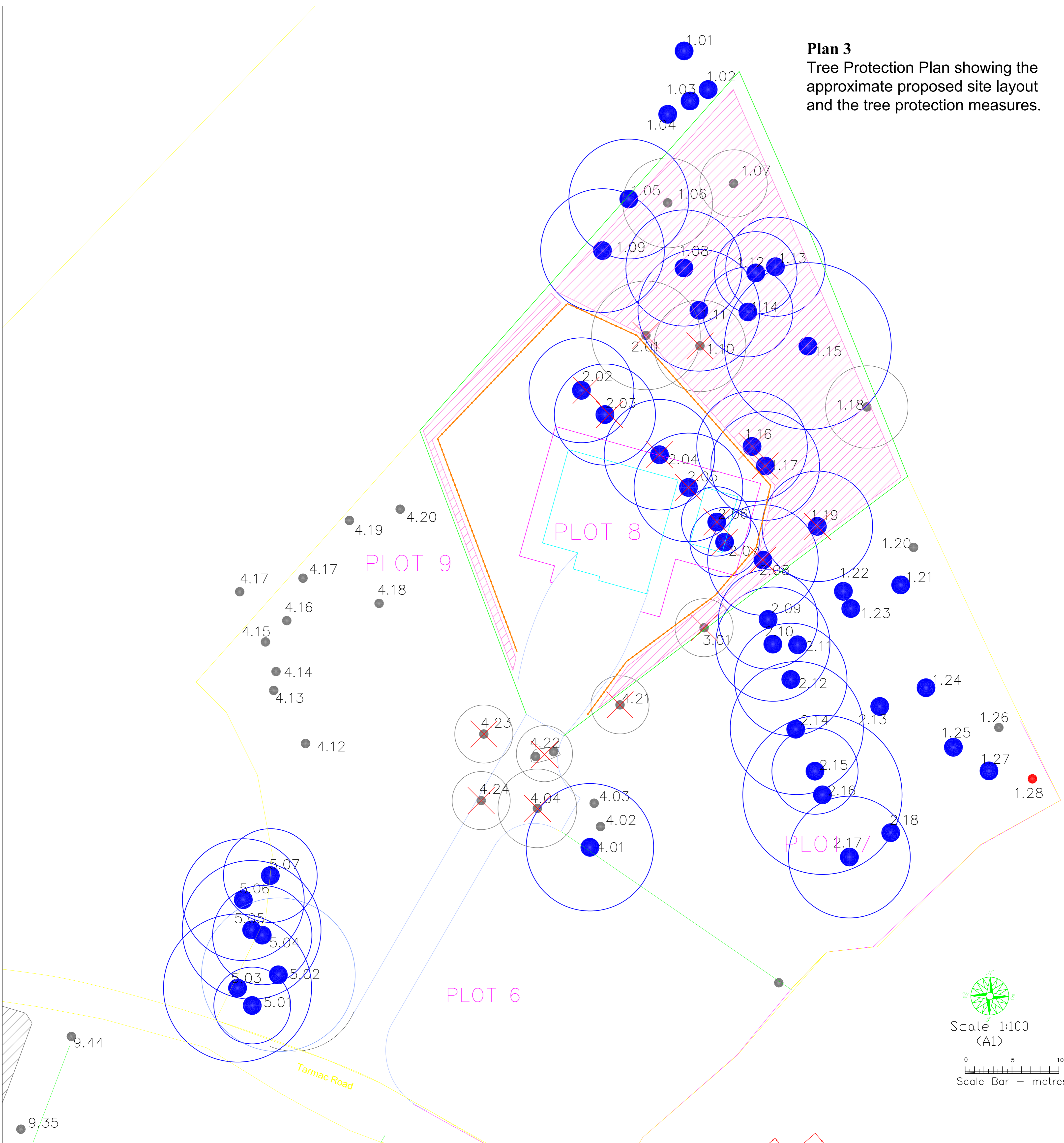

Key to Plan 3

<p>The approximate location of a tree and its respective number.</p> <ul style="list-style-type: none"> ● Trunk ● Crown Spread ● Root Protection Area (RPA) <p>Green Retention Category A Blue Retention Category B Grey Retention Category C Red Retention Category U</p>	<p>Plot 8</p> <p>The approximate extents of Plot 8.</p>	<p>The approximate outline of a proposed new building</p> <p>2m buffer zone</p>	<p>Tree Protection Fence</p>
<p>The approximate location of a tree group and its respective number.</p> <p>Green Retention Category A Blue Retention Category B Grey Retention Category C Red Retention Category U</p>	<p>1</p> <p>Tree or group of trees to fall</p>	<p>The approximate outline of a proposed new driveway</p>	<p>Tree Protection Surface</p>
			<p>Construction Exclusion Zone</p>