

MANNINGELLIOTT
 PARTNERSHIP

Chartered Architects &
 Designers

Mansell House, Suite 1
 Grindal House, St Bees
 Cumbria CA11 9BW
 t: 01768 868 800
 e: post@manning-elliott.co.uk
 w: manning-elliott.co.uk

project title:

Grindal House
 St Bees, Cumbria
 CA27 0DG

drawing title:

Block Layout Plan
 as Proposed

issue stage:

Planning Application

date: Apr 2022 LS

drawn: LS

scale @ A3:

1:250

drawing number:

2131-200-PL H

revision:

H

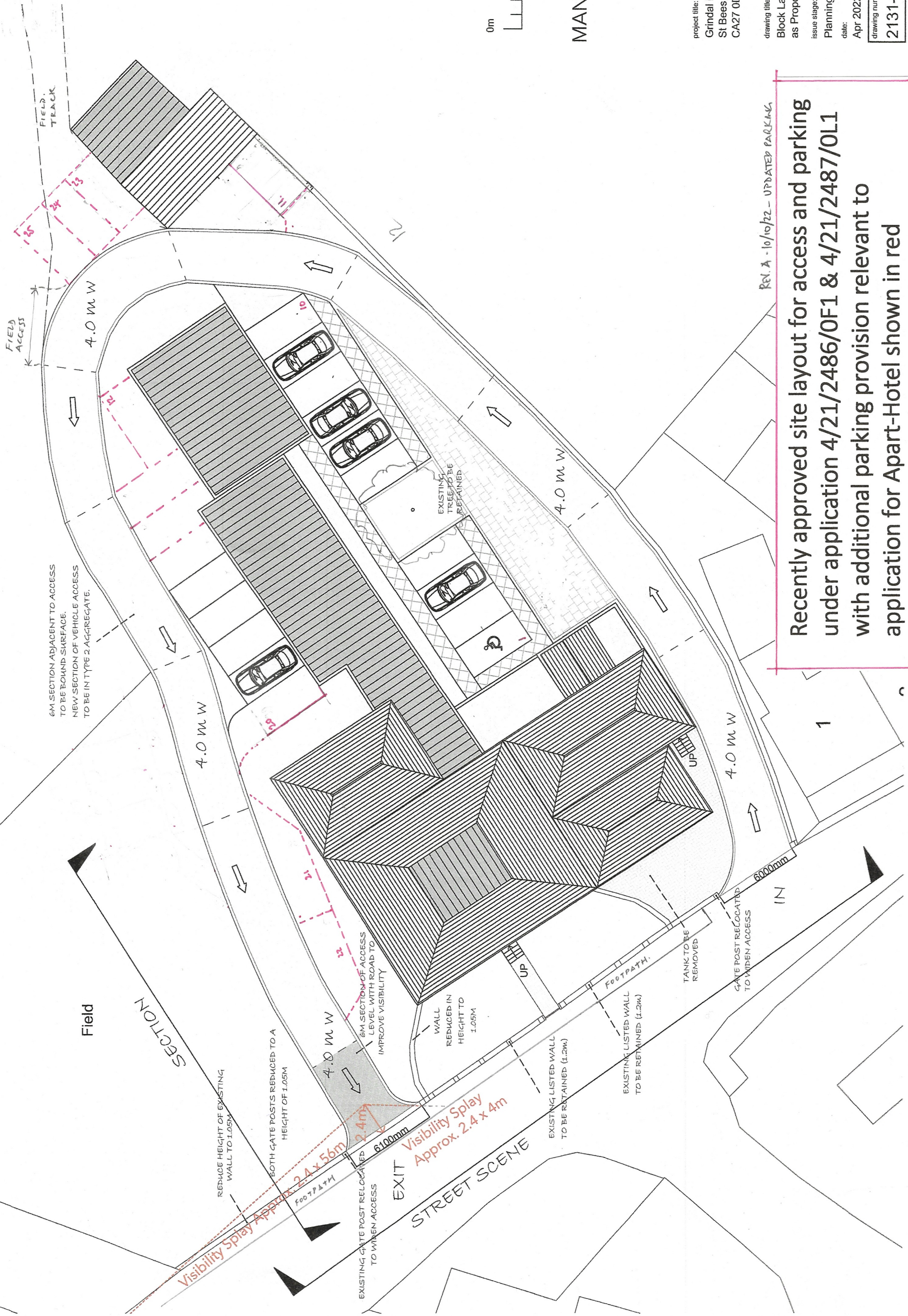

REV. A - 10/10/22 - UPDATED PARKING

Recently approved site layout for access and parking
 under application 4/21/2486/0F1 & 4/21/2487/0L1
 with additional parking provision relevant to
 application for Apart-Hotel shown in red