

THIS DRAWING AND DESIGN IS THE SOLE PROPERTY OF PREMIER MODULAR LIMITED AND MUST NOT BE COPIED, LOANED OR COMMUNICATED, IN WHOLE OR PART TO ANY THIRD PARTY WITHOUT CONSENT FROM THE COMPANY.

This document/drawing has been inspected for compliance with general arrangement and requirements specified under this contract. Dimensions, coordination with associated plant and all other services and site conditions. Compliance with statutory regulations and compliance with specified requirements remain the responsibility of the contractor. Status as follows:

- ☐ A Fabrication, manufacture or construction may proceed in accordance with this document/drawing.
- ☐ B Fabrication, manufacture or construction may proceed subject to incorporation of the amendments noted hereon.
- ☒ C This document/drawing shall be modified in accordance with amendments noted hereon and RESUBMITTED for further inspection prior to manufacture and construction.

Notes

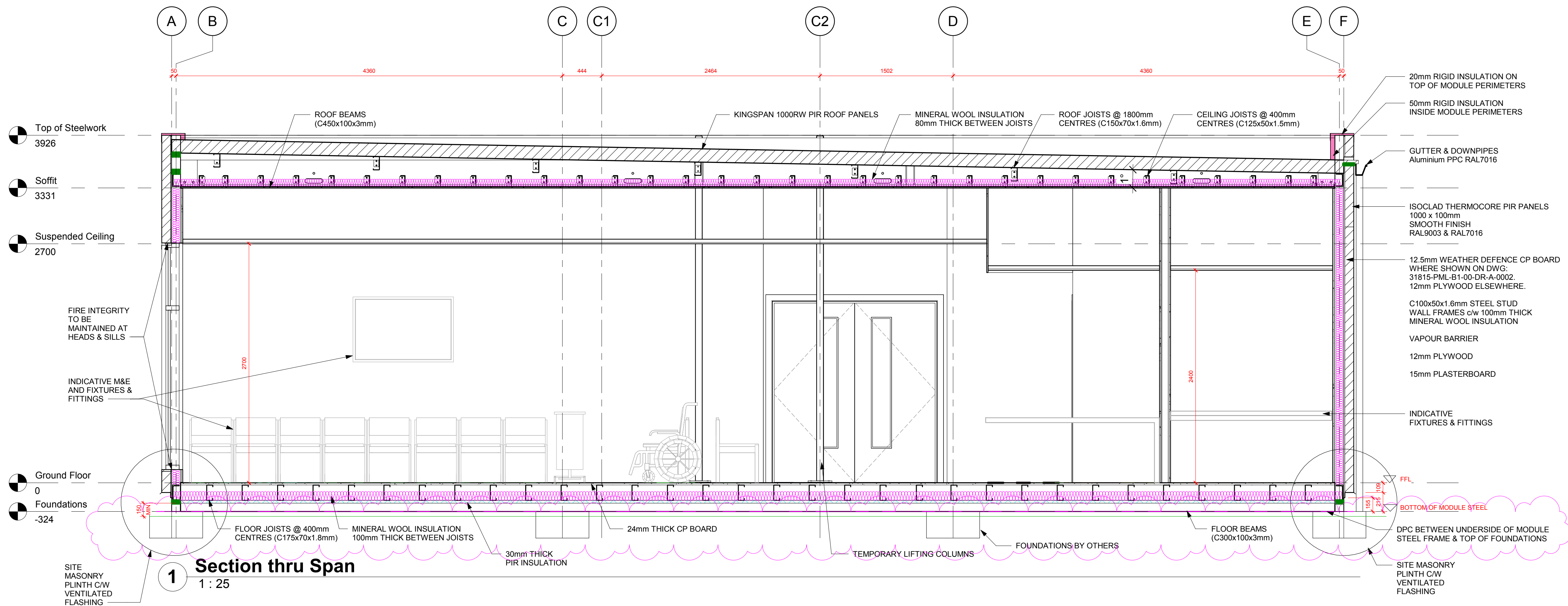

Rev	By	Description	Date
C9	AMW	DPC ADDED TO SECTIONS	23.02.21
C8	AMW	EXTERNAL FINISH SETTING-OUT DIMS ADDED	17.02.21
C7	AMW	INSULATION ANNOTATION UPDATED	04.02.21
C6	AMW	SWITCH ROOM ENLARGED & DOORSET D408 WIDENED	02.02.21
C5	AMW	BEAM INSULATION ANNOTATION ADDED	28.01.21
G4	AMW	SUSPENDED CEILING HEIGHTS REVISED TO CLIENT'S COMMENTS	18.01.21
C3	AMW	ALL WHITE COLOUR REFS MARKED AS RAL9003	13.01.21
C2	AMW	ALL GREY COLOUR REFS MARKED AS RAL7016	11.01.21
C1	AMW	CONSTRUCTION ISSUE	05.01.21
P3	AMW	EXTERNAL DOORS & WINDOWS REVISED AS CLIENT REQUEST	23.11.20
P2	AMW	REVISED TO CLIENT COMMENTS	05.11.20
P1	AMW	PROVISIONAL ISSUE	28.10.20

Premier
MODULAR EXCELLENCE

HEAD OFFICE
PREMIER MODULAR LIMITED, CATFOSS LANE,
BRANDESBURTON, DRIFFIELD
EAST YORKSHIRE YO25 8EJ
Telephone: (01964) 545000 Fax: (01964) 545001
email: sales@premiermodular.co.uk
internet: www.premiermodular.co.uk

We are
WACO
MEMBER

Status
CONSTRUCTION

Client
WEST CUMBRIA NHS TRUST

Project
WEST CUMBRIA HOSPITAL E.D.

Title
Basic Building Sections

Scale As Indicated	Drawn AMW	Date: 29.10.2020.	Checked TC
Drawing No. 31815- PML-B1-ZZ-DR-A-0030		Rev C9	