

PROPOSED BOUNDARY TREATMENTS PLAN
(1:1000)

Note: Sketch scheme may be based on plan information of unknown origin and is subject to verification. The drawing is not to be used for any other purpose. The drawing is not to be used for any other purpose. The drawing is not to be used for any other purpose.

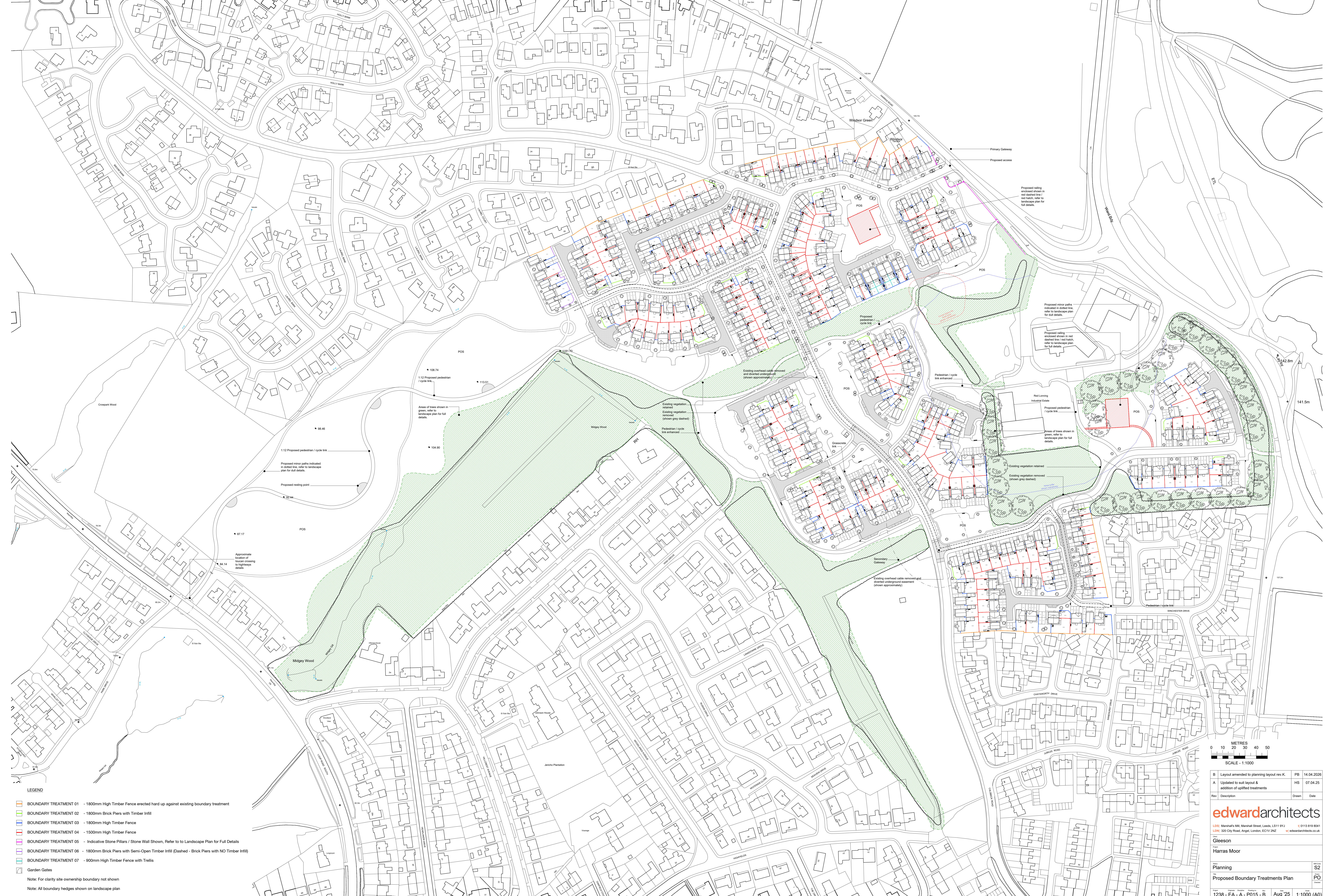

- LEGEND**
- BOUNDARY TREATMENT 01 - 1800mm High Timber Fence erected hard up against existing boundary treatment
 - BOUNDARY TREATMENT 02 - 1800mm Brick Piers with Timber Infill
 - BOUNDARY TREATMENT 03 - 1800mm High Timber Fence
 - BOUNDARY TREATMENT 04 - 1500mm High Timber Fence
 - BOUNDARY TREATMENT 05 - Indicative Stone Pillars / Stone Wall Shown, Refer to to Landscape Plan for Full Details
 - BOUNDARY TREATMENT 06 - 1800mm Brick Piers with Semi-Open Timber Infill (Dashed - Brick Piers with NO Timber Infill)
 - BOUNDARY TREATMENT 07 - 900mm High Timber Fence with Trellis
 - Garden Gates
- Note: For clarity site ownership boundary not shown
Note: All boundary hedges shown on landscape plan

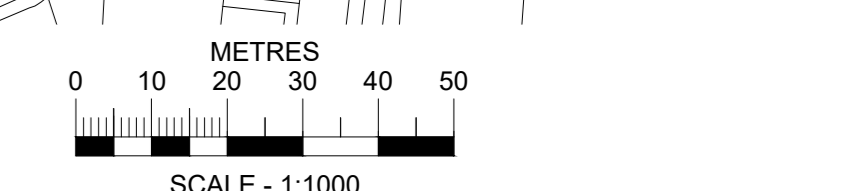

B	Layout amended to planning layout rev.K.	PB	14.04.2020
A	Updated to suit layout & addition of qualified treatments	HS	07.04.20
Rev	Description	Drawn	Date
<p>edwardarchitects</p> <p>005: Marshalls Mill, Marshall Street, Leeds, LS11 9YJ 0113 819 8061 100: 120 City Road, Angel, London, EC1Y 2NE edwardarchitects.co.uk</p> <p>Gleeson Harras Moor</p> <p>Planning Proposed Boundary Treatments Plan</p> <p>1238 - EA - A - P015 - B Aug '25 1:1000 (A0)</p>			