

SCALE 1:100

SECTION OF 203x102(8'x4") x 23kg U.B WELDED OR BOLTED TO EXIST STANCHIONS TO SPACE NEW 178x102(7'x4") x 19kg U.B. FRAMES OUTSIDE R.W. CUTTERING.

150(6) CUTTERING 100(4) DOWN PIPES IN UPVC (EXIST CUTTERING EXTENDED) TO EXISTING SOAKAWAYS

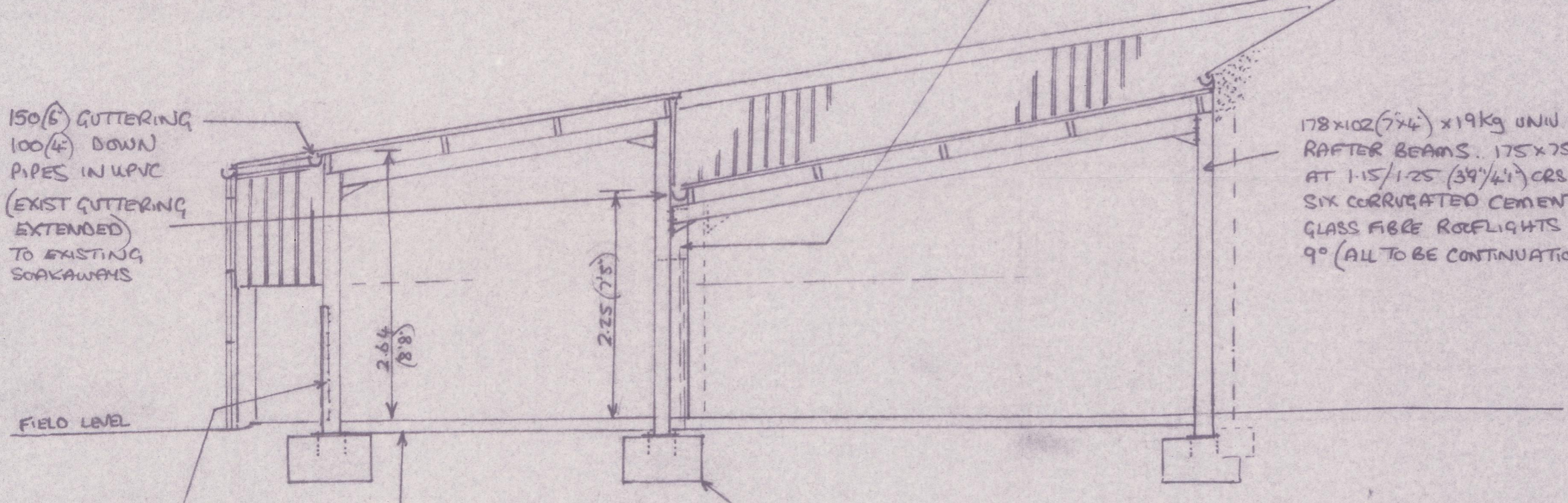

178x102(7'x4") x 19kg UNI-BEAM STANCHIONS + RAFTER BEAMS. 175x75(7'x3") TIMBER ARLINS AT 1.15/1.25 (39'x41") CRS + COVERED WITH BIG SIX CORRUGATED CEMENT FIBRE SHEET, WITH GLASS FIBRE ROFLIGHTS. ROOF PITCHES APPROX 9° (ALL TO BE CONTINUATION OF EXIST ROOFS)

SECTION A.A.
SCALE 1:50

800x800x400 (28"x28"x1 1/4") CONE FOUNDATIONS FOR NEW STANCHIONS, SECURED BY 4 OFF M20 RAWLBOLTS THROUGH 15(3/8) THICK BASE PLATES

- 1) ROOF COVERING TO BE 'BIG SIX' CORRUGATED CEMENT FIBRE SHEET, GREY TO MATCH EXISTING.
- 2) STEELWORK TO BE EITHER GALVANISED, OR COATED WITH 2 LAYERS NON-TOXIC PAINT.
- 3) ALL TIMBERWORK TO BE TREATED WITH A PRESERVATIVE
- 4) BUILDING TO BE MANUFACTURED TO BS. 5502, CLASS 2.
- 5) FLOOR AREA OF BUILDING = 88.9 m²
- 6) WITH AN AVERAGE 0.27m m³/m²/YEAR RAINFALL, THE REDUCTION IN DIRTY WATER BY COVERING THE CONCRETE FLOORED PENS = 24.0 m³/YEAR.

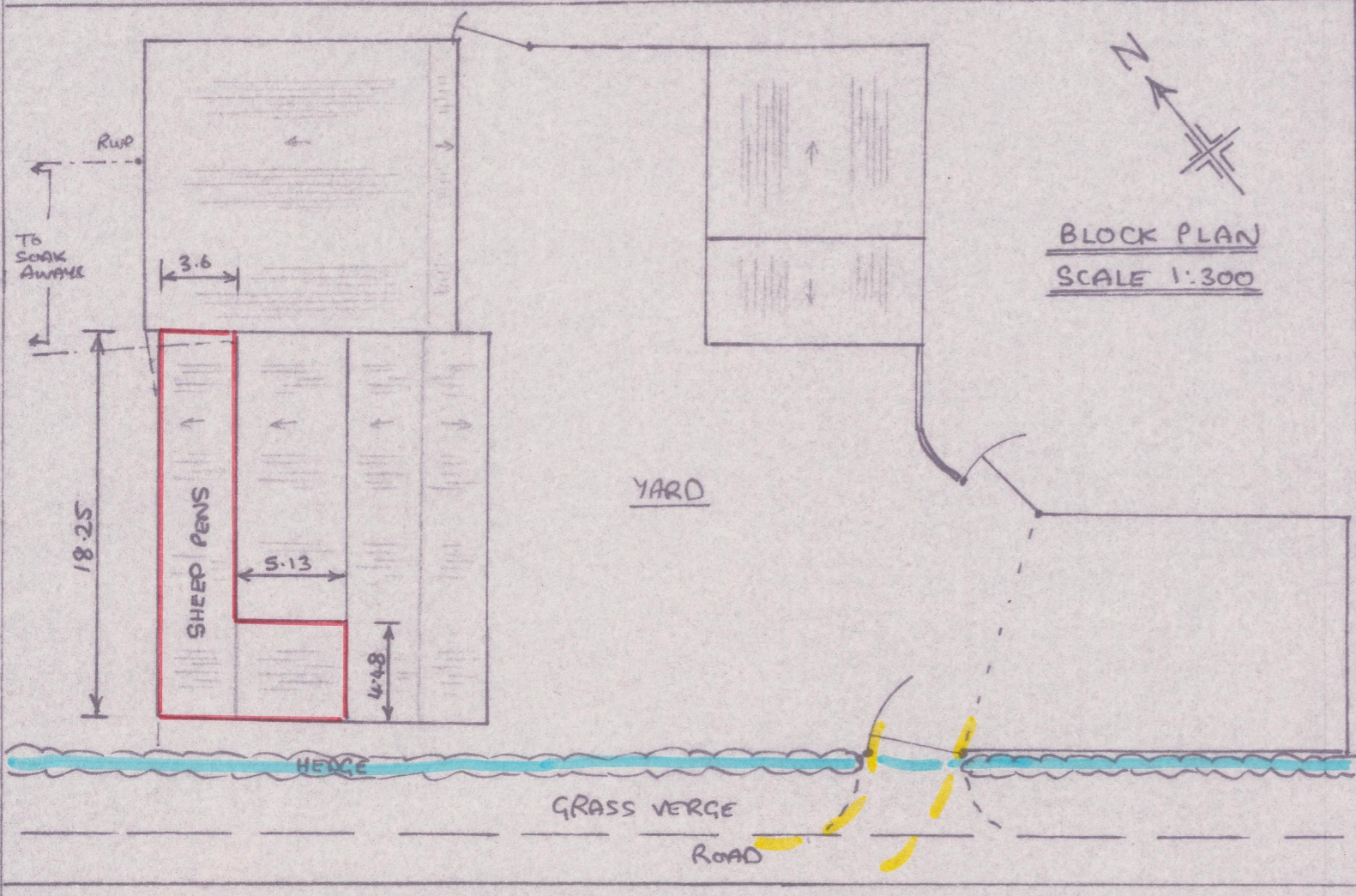

BLOCK PLAN
SCALE 1:300

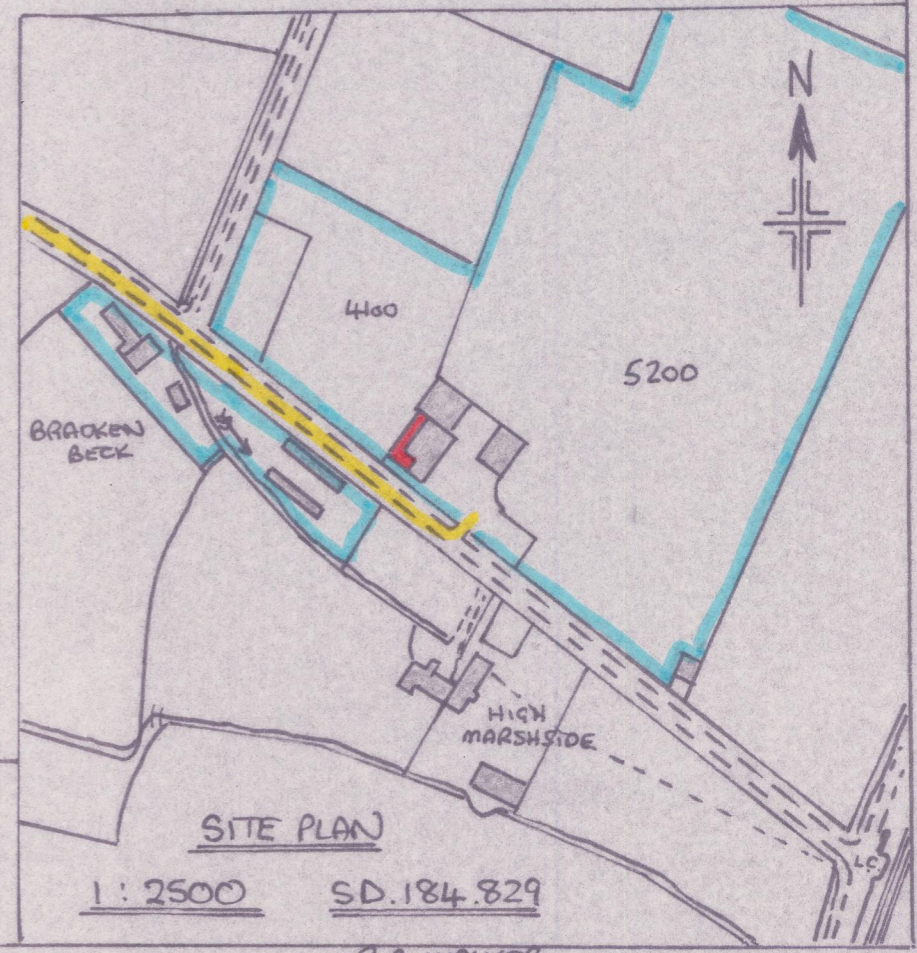

SITE PLAN
1:2500 SD.184.829

PROPOSED ROOF OVER SHEEP PENS AT BRACKEN BECK UNDERHILL, MILLOM, CUMBRIA FOR MR P. ASHBURNER