









Key to Surface Finishes

-  Entrance and Junction tie-in with public highway (S278 Works):
45mm hot rolled asphalt (HRA) concrete surface course, 5mm Binder course, 90mm Base course, 300mm DFT Type 1 Sub-base
-  Adopted Footway (S278 Works):
30mm Dense graded macadam surface course, 50mm Binder course, 150mm DFT Type 1 Sub-base
-  Private Access Road:
45mm hot rolled asphalt (HRA) concrete surface course, 5mm Binder course, 90mm Base course, 300mm DFT Type 1 Sub-base
-  Private Footway:
30mm Dense graded macadam surface course, 50mm Binder course, 150mm DFT Type 1 Sub-base
-  Private rumble strip:
100mm sq x 100mm thick setts to architects specification, 30mm sand laying course, 125mm base course, 300mm DFT Type 1 sub-base
-  Private Shared Surface Access Road:
80mm block paving to architects specification, 30mm sand laying course, 125mm base course, 300mm DFT Type 1 sub-base
-  Private Driveways:
60mm block paving to architects specification, 30mm sand laying course, 300mm DFT Type 1 sub-base
-  Private Footpaths & Patios:
To Architects specification

Key to Kerbing Types

- HB2 - 125x255mm PC Half batter kerb
- DL1 - 125x255/150 PC Drop kerb (Left hand drop)
- DR1 - 125x255/150 PC Drop kerb (Right hand drop)
- EF - 50x200mm PC Flat top edging, flush with surfacing
- CS1 - 125x255mm Square channel
- CS2 - 125x150mm Square channel
- BN - 125x150mm PC Bullnosed kerb flush with max. 6mm upstand
- BN(25) - 125x150mm PC Bullnosed kerb with 25mm upstand

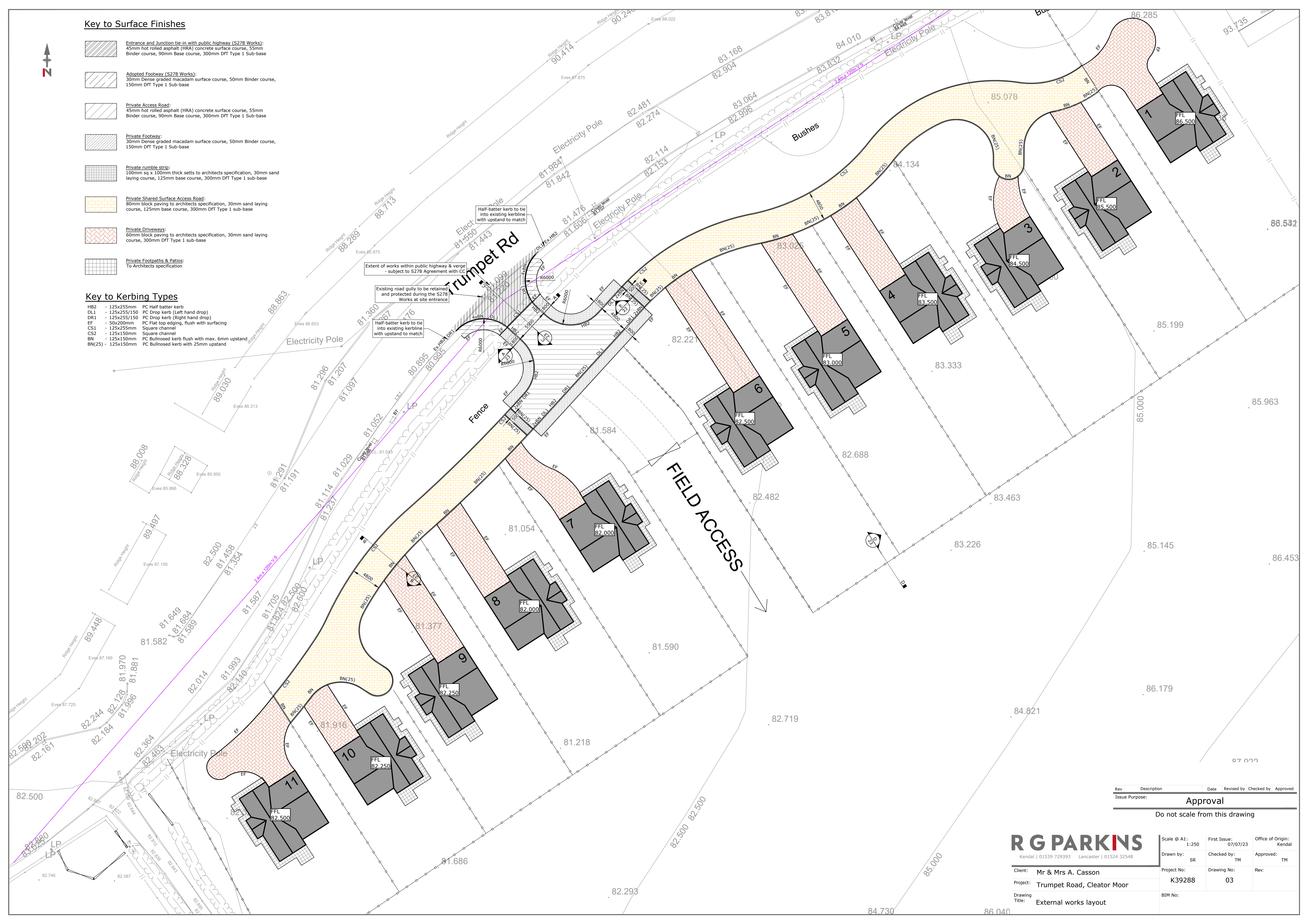

Rev	Description	Date	Revised by	Checked by	Approved
Issue Purpose: Approval					

Do not scale from this drawing



Kendal | 01539 729393 Lancaster | 01524 32548

Client: **Mr & Mrs A. Casson**
 Project: **Trumpet Road, Cleator Moor**
 Drawing Title: **External works layout**

Scale @ A1: 1:250	First Issue: 07/07/23	Office of Origin: Kendal
Drawn by: SR	Checked by: TM	Approved: TM
Project No: K39288	Drawing No: 03	Rev:
BIM No:		