

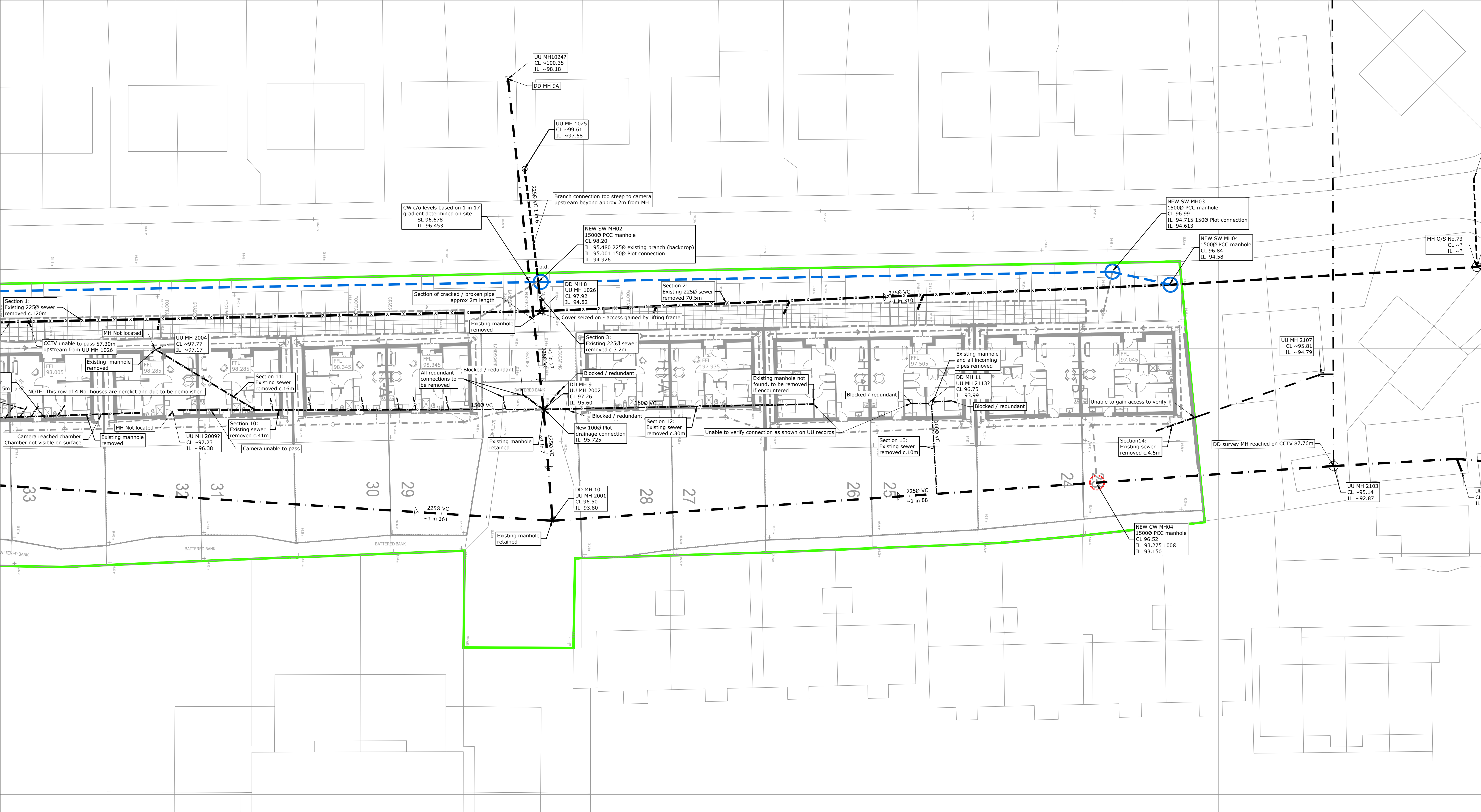

516050

516100

516150











Rev	Description	Date	Revised by	Checked by	Approved

## APPROVAL

Do not scale from this drawing

**DRAINAGE KEY - SEWER DIVERSIONS & ABANDONMENTS**

	EXISTING PUBLIC COMBINED SEWER
	PROPOSED DIVERSION OF EXISTING PUBLIC COMBINED SEWER
	PROPOSED ABANDONMENT OF EXISTING PUBLIC COMBINED SEWER
	EXISTING PUBLIC SURFACE WATER SEWER
	PROPOSED DIVERSION OF EXISTING PUBLIC SURFACE WATER SEWER
	PROPOSED ABANDONMENT OF EXISTING PUBLIC SURFACE WATER SEWER
	PROPOSED HIGHWAYS DRAINAGE DIVERSION
	SITE BOUNDARY

**R G PARKINS**

Kendal | 01539 729393    Lancaster | 01524 32548

Client: Thomas Armstrong Ltd

Project: Windermere Rd & Fell View Ave

Drawing Title: S116 Abandonment Plan  
Windermere Road 2 of 2