

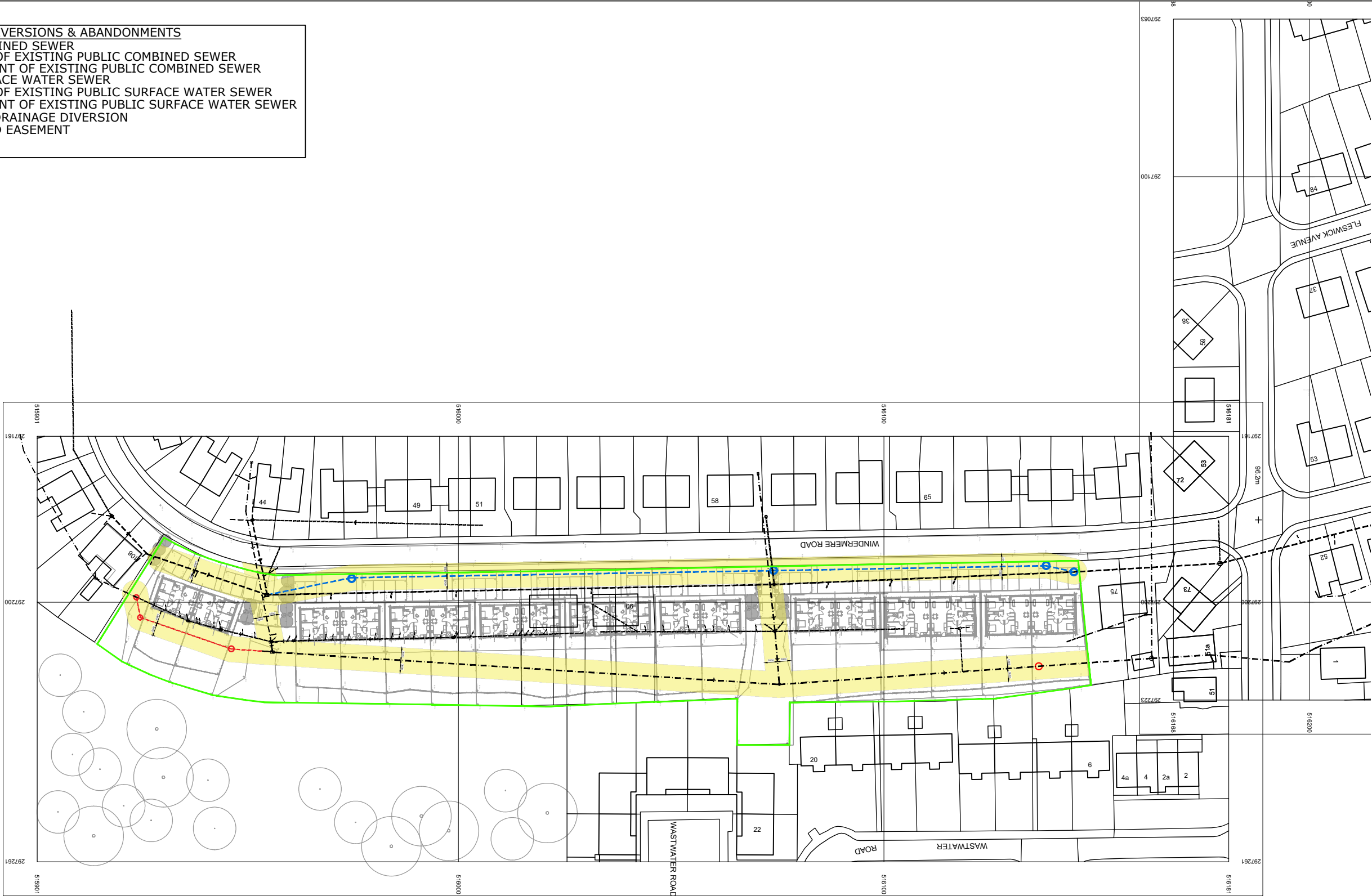

- DRAINAGE KEY - SEWER DIVERSIONS & ABANDONMENTS**
- EXISTING PUBLIC COMBINED SEWER
 - - - PROPOSED DIVERSION OF EXISTING PUBLIC COMBINED SEWER
 - PROPOSED ABANDONMENT OF EXISTING PUBLIC COMBINED SEWER
 - EXISTING PUBLIC SURFACE WATER SEWER
 - - - PROPOSED DIVERSION OF EXISTING PUBLIC SURFACE WATER SEWER
 - PROPOSED ABANDONMENT OF EXISTING PUBLIC SURFACE WATER SEWER
 - PROPOSED HIGHWAYS DRAINAGE DIVERSION
 - 6m MIN. WIDE ADOPTED EASEMENT
 - SITE BOUNDARY



R G PARKINS

Kendal | 01539 729393 Lancaster | 01524 32548

Client: **Thomas Armstrong**

Project: **Windermere Rd & Fell View Avenue**

Drawing Title: **Land Registry Plan
Windermere Road**

Scale @ A3:
1:1000

Drawn by:
CA

Project No:
K39225

BIM No:

First Issue:
23/02/2023

Checked by:
TM

Drawing No:
200

Office of Origin:
Kendal

Approved:
TM

Rev: