

floor plan

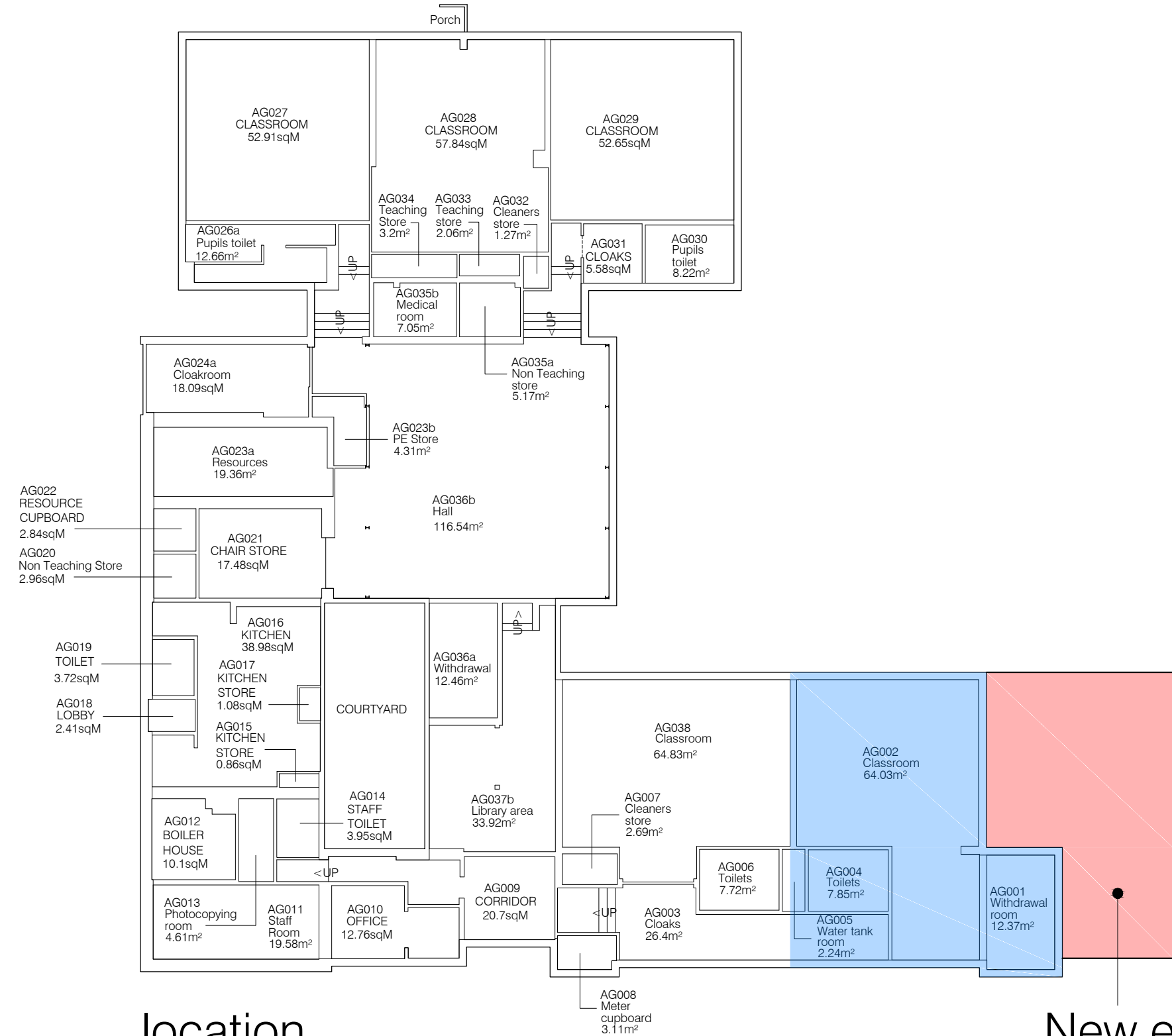

location

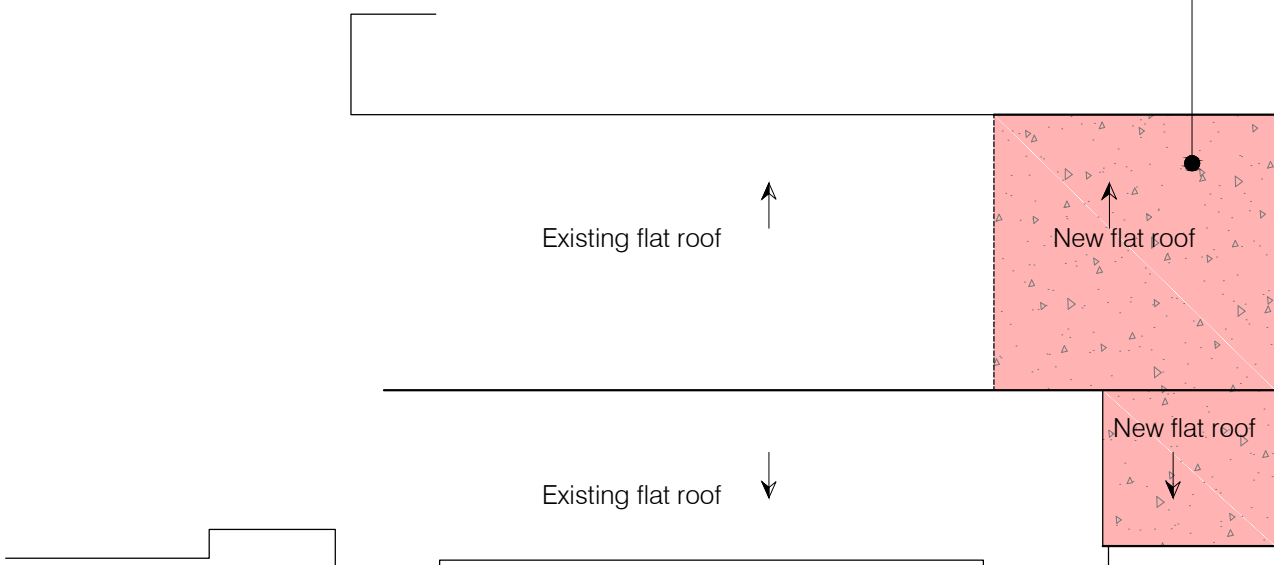

Roof Plan

UNDERWOOD Associates
CHARTERED BUILDING SURVEYORS

AS PROPOSED
ST JAMES INFANT SCHOOL
PROPOSED EXTENSION
FLOOR PLANS
High Street, Whitehaven.
CA28 7PZ.
PLANNING DWG

Warwick Mill Business Centre
Warwick Bridge
Carlisle
CA4 8RR
TEL UK: 01697741123
Date 18-01-21
e-mail: info@underwoodsurveying.co.uk
WWW.underwoodsurveying.co.uk
Dwg No: 1441 : 04
Scale: 1:50 @ A1 / 1:100 @ A3

REV: A. Floor area increased. 14/06/2021
REV: B. Canopy removed. 16/06/2021
REV: C. Planning issue 30/11/2021

DIAGRAMMATIC NOT TO BE SCALED FROM. ALL CRITICAL DIMENSIONS TO BE CONFIRMED ON SITE

