

floor plan

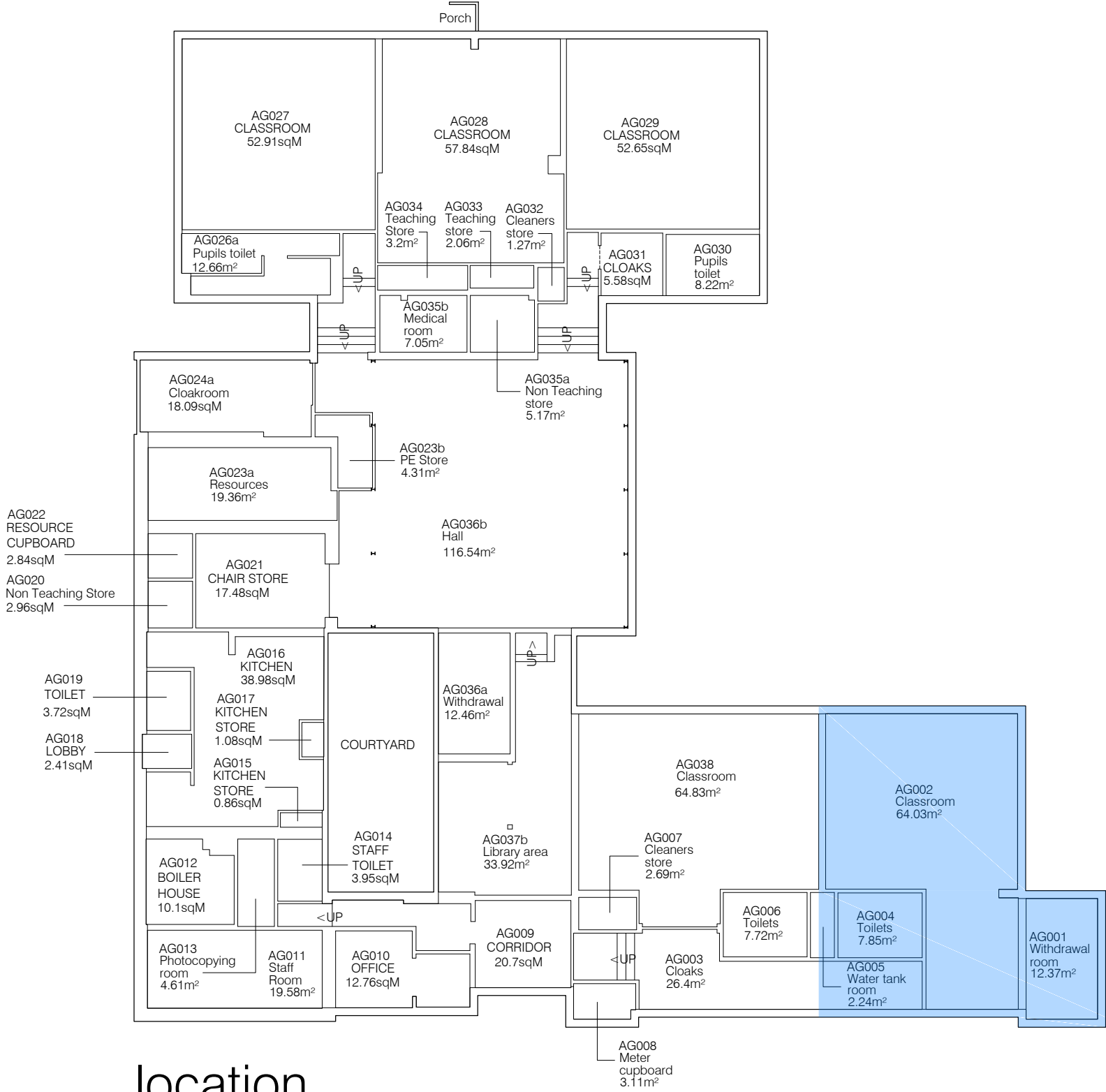

location

UNDERWOOD Associates
CHARTERED BUILDING SURVEYORS

AS EXISTING
ST JAMES INFANT SCHOOL
PROPOSED EXTENSION
FLOOR PLANS
High Street, Whitehaven.
CA28 7PZ.
PLANNING DWG

Warwick Mill Business Centre Warwick Bridge Carlisle CA4 8RR TEL UK: 01697741123	e-mail: info@underwoodsurveying.co.uk WWW.underwoodsurveying.co.uk
File:JUA ST James 1441 Date 18-01-21	Dwg No: 1441 : 02 Scale: 1:50 @ A1 / 1:100 @ A3
REV:	

DIAGRAMMATIC NOT TO BE SCALED FROM. ALL CRITICAL DIMENSIONS TO BE CONFIRMED ON SITE

