

CAR PARK ENTRANCE CONSTRUCTION DETAIL

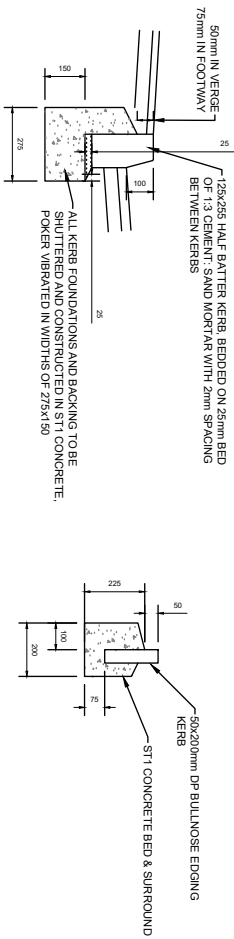

125x255mm HALF BATTERED KERB - TYPE HB2

FLUSH 50x200mm EDGING FLAT KERB

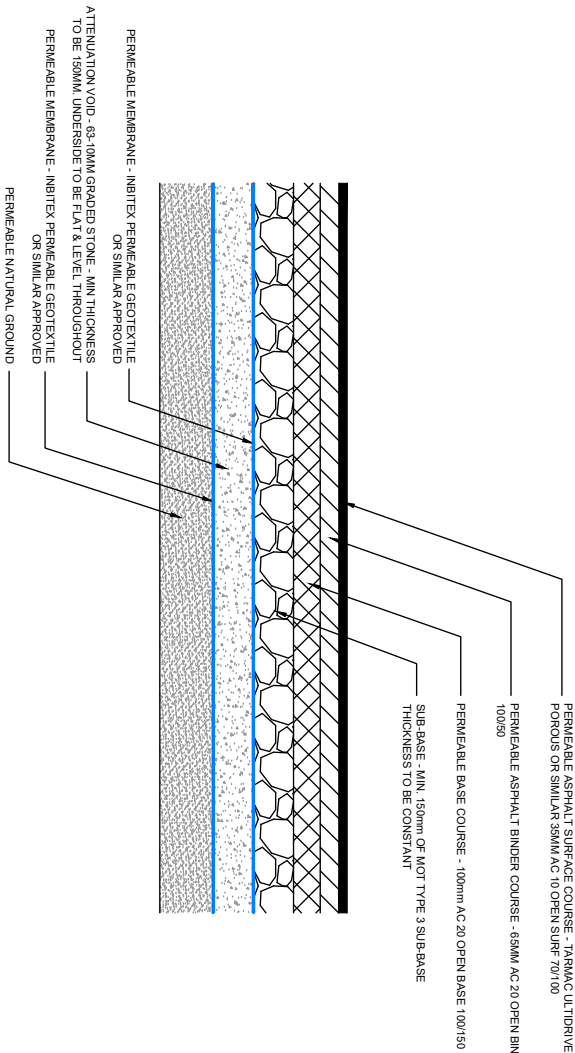
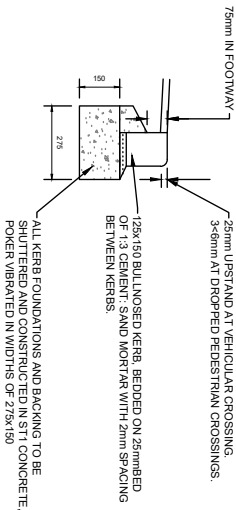

DROPPED KERB TYPE BN

ALL PRECAST CONCRETE KERBS, CHANNELS AND EDGINGS SHALL BE TO BS EN 1339 IN PRESSED CONCRETE WITH FINE GRADE AGGREGATE HAVING A 10% FINES VALUE NOT LESS THAN 125MM

M & P Gadsden
Consulting Engineers Ltd

Unit 20
Meetings Industrial Estate
Park Road
Barnstaple-Furness
Cornwall
LA14 4TL



Tel: 01229 813333
Web: www.mandpgadsdenconsulting.co.uk
E-mail: mkg@mpg-consulting.co.uk
man@mpg-consulting.co.uk

NOTES

Rev	Date	Notes	Int.
A	16/03/21	Preliminary Issue	RB
B	22/09/21	Additional details included	RB

Client: As if By Magic,
Project: Drainage Design for Proposed Development @
Old Ironworks Site,
Devonshire Road, Milcom.

Notes:
This drawing is protected by copyright and must not be copied or reproduced without the written consent of M&P Gadsden Consulting Engineers Ltd. No dimensions are to be scaled from this drawing. All dimensions and sizes to be checked on site. ©

Drawing Title			
TYPICAL HIGHWAY CONSTRUCTION DETAILS			
Status			
STAGE 3			
Date	Drawn	Scale	Revision
16/03/2021	RB	1:10 - A3	
Drawing No.			
20404_STG3_06.1			
			B