

This drawing is for the sole purpose of obtaining Local Authority Planning & Building Regulation approval only. The building contractor shall be responsible for the checking of all dimensions on site. The building contractor shall be responsible for the stability of the existing structures during the demolition & construction works. The building contractor shall be responsible for the correct setting out of all works on site.

Existing drain running beneath dining area to be grubbed up & removed.

Existing internal walls & doors forming lounge, dining room & cup'd shown dotted together with staircase to be broken out & removed.

Existing internal walls within store shown dotted together with all electrical items to be broken out & removed.

Existing floor within utility, store, hall & WC rooms to be excavated down to formation level to allow for casting on new ground floor.

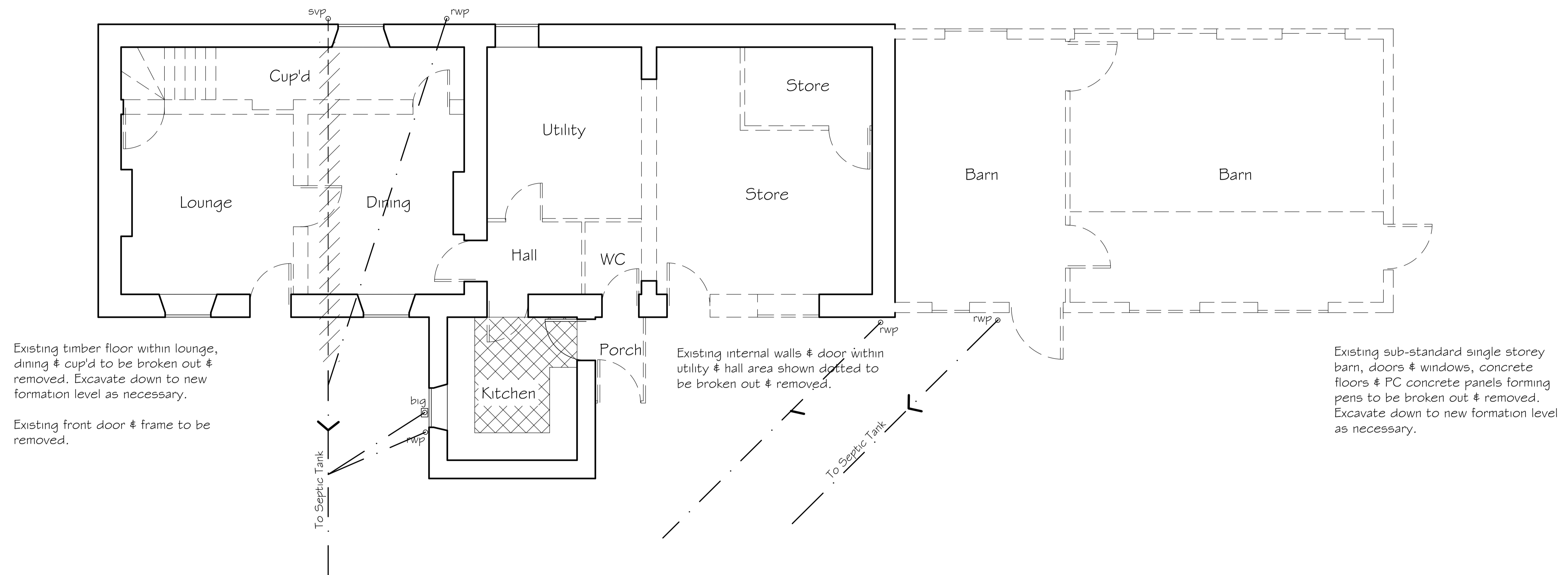

Existing timber floor within lounge, dining & cup'd to be broken out & removed. Excavate down to new formation level as necessary.

Existing front door & frame to be removed.

Existing internal walls & door within utility & hall area shown dotted to be broken out & removed.

Existing sub-standard single storey barn, doors & windows, concrete floors & PC concrete panels forming pens to be broken out & removed. Excavate down to new formation level as necessary.

GROUND FLOOR PLAN AS EXISTING SHOWING PROPOSED DEMOLITION WORKS
 Scale 1:50 @ A1
 Scale 1:100 @ A3

PROPOSED INTERNAL ALTERATIONS & SINGLE STOREY EXTENSION TO GILL HOUSE FARM, EGREMONT, CUMBRIA, CA22 2UB FOR SAMANTHA CLARKE
 DRG No 3