

NOTES

All demolition work, temporary propping and load transfer to be carried out in a safe manner by a competent demolition contractor.

The main contractor must ensure that satisfactory method statements are prepared , checked and adhered to during all phases of work.

The integrity of the existing structures during the works is the responsibility of the main contractor.

All services shall be accurately located and temporarily moved, relocated or made safe prior to excavation, breaking out or demolition works.

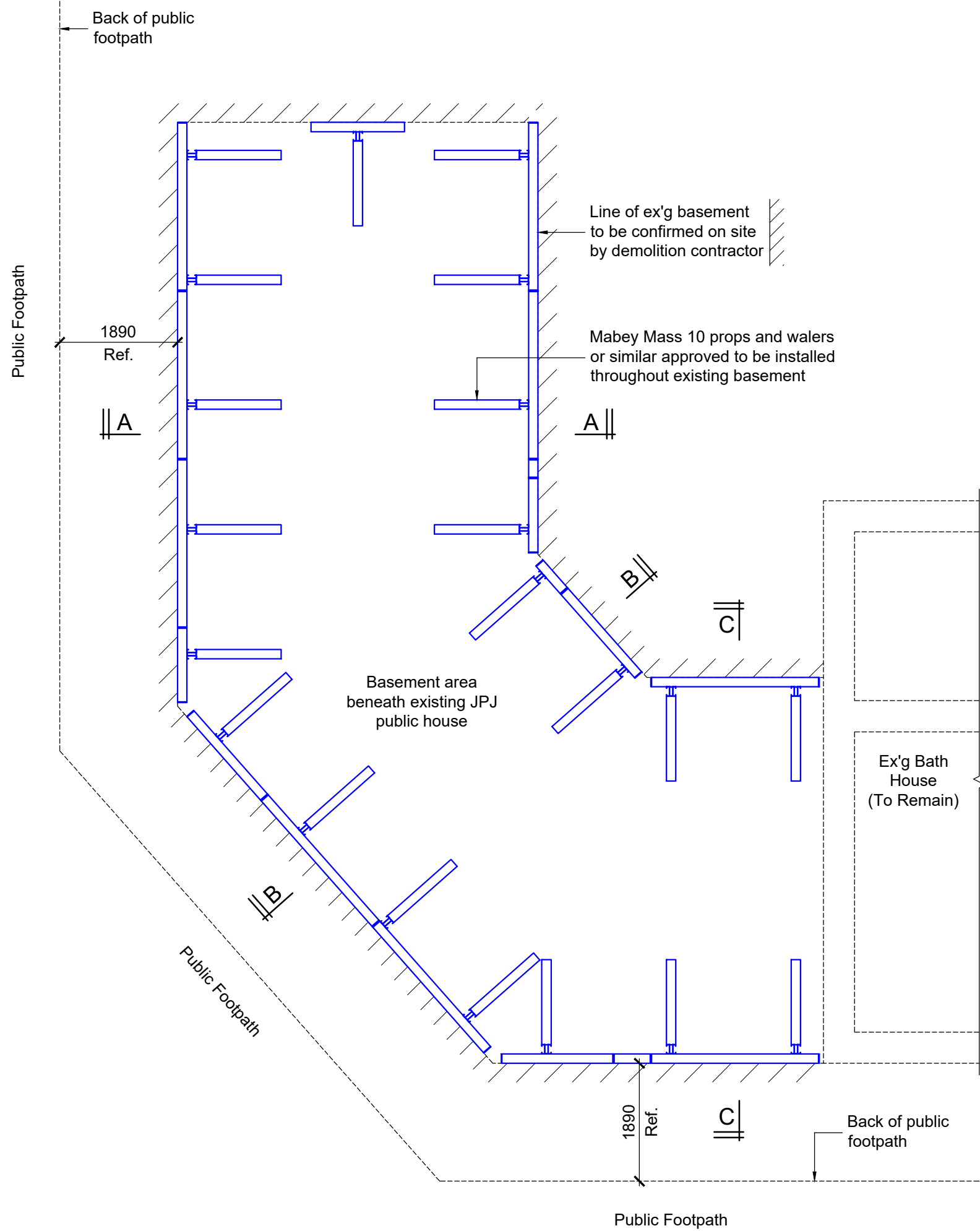

Proposed Propping Plan To Existing Basement

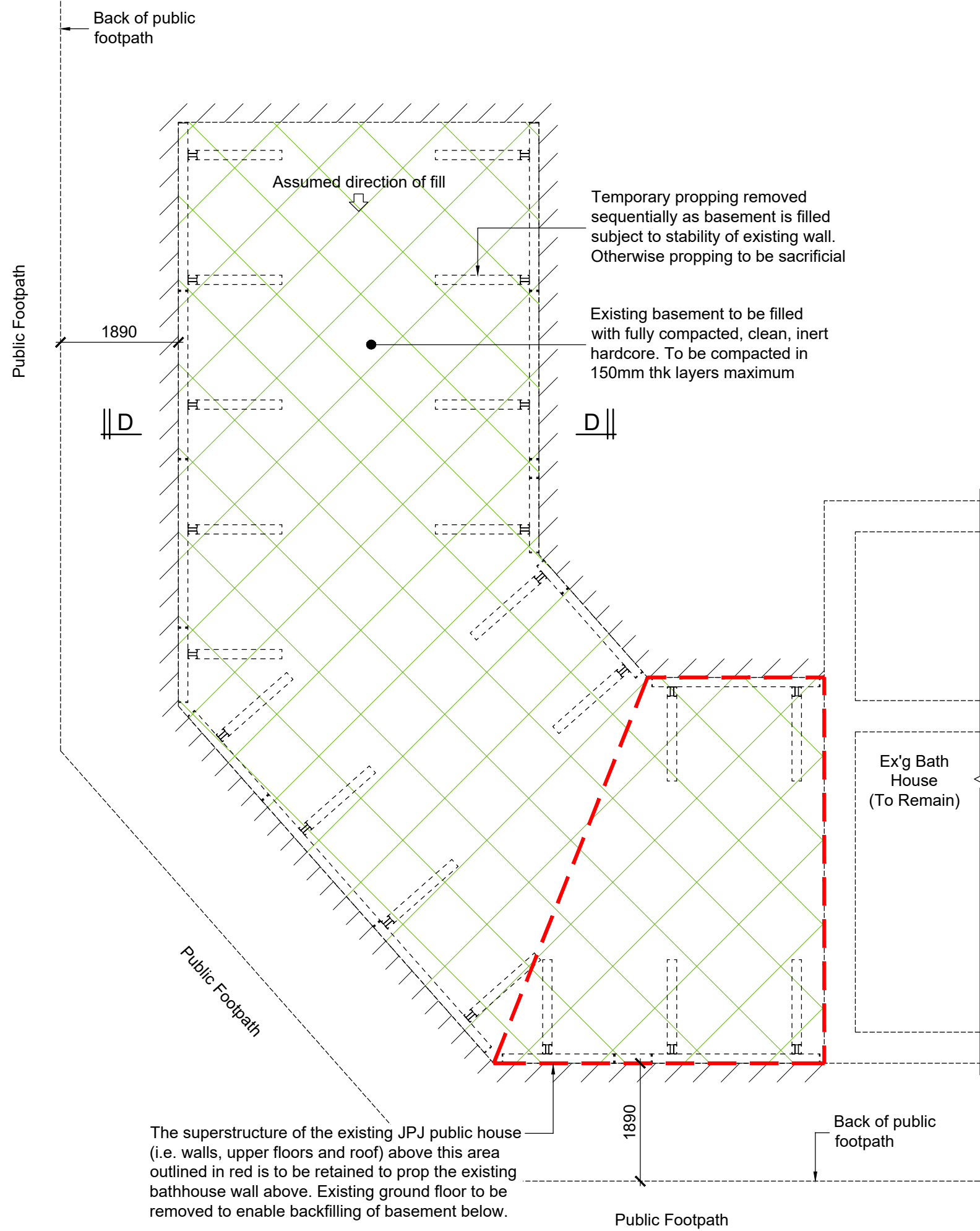

Proposed Infill Plan To Existing Basement

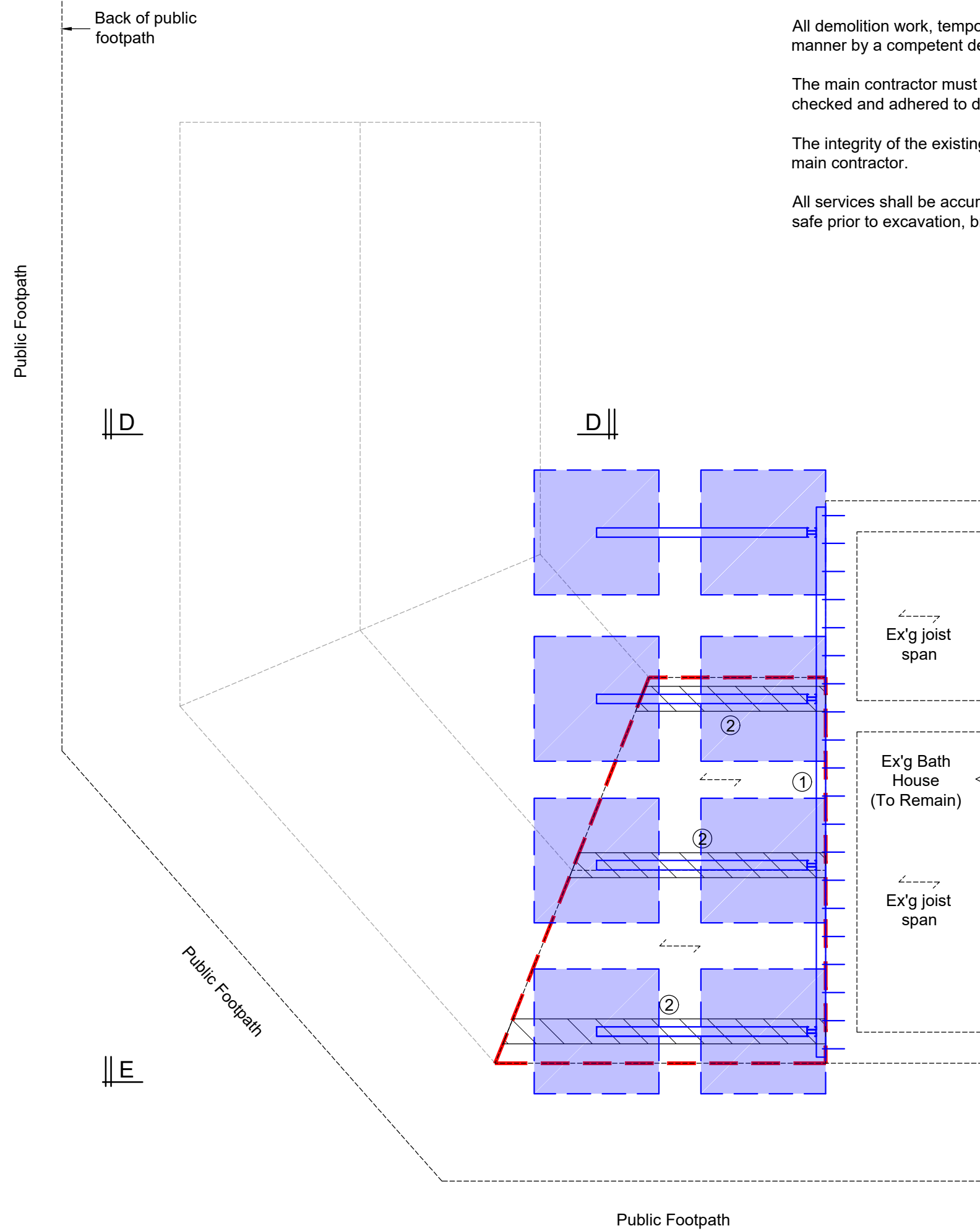

Proposed Propping Plan To Existing Bath House Wall

KEY

Mabey Mass 10 walers to be fixed to gable wall (remaining) with M12 resin anchors at 450mm horizontal centres. Walers to be fixed at roof level and floor levels of existing bath house

Sections of existing floors within JPJ public house to be removed to allow installation of new Mabey Mass 10 shore props or similar approved

Mabey Mass 10 shore props installed

Note:  
Once the new proprietary propping system to the existing bath house wall has been installed the final section of the existing JPJ public house to be carefully removed.

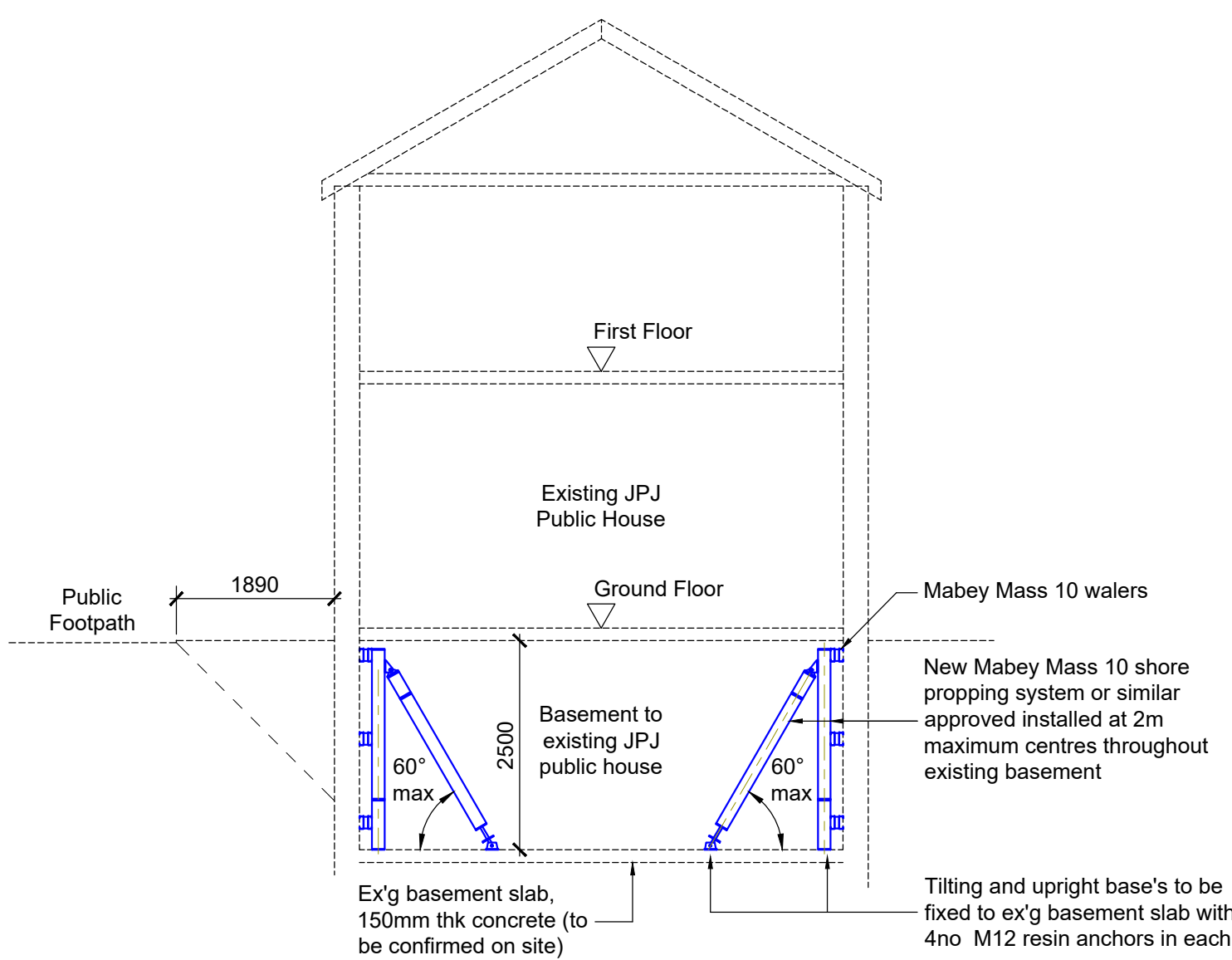

Section A-A  
B-B & C-C Similar

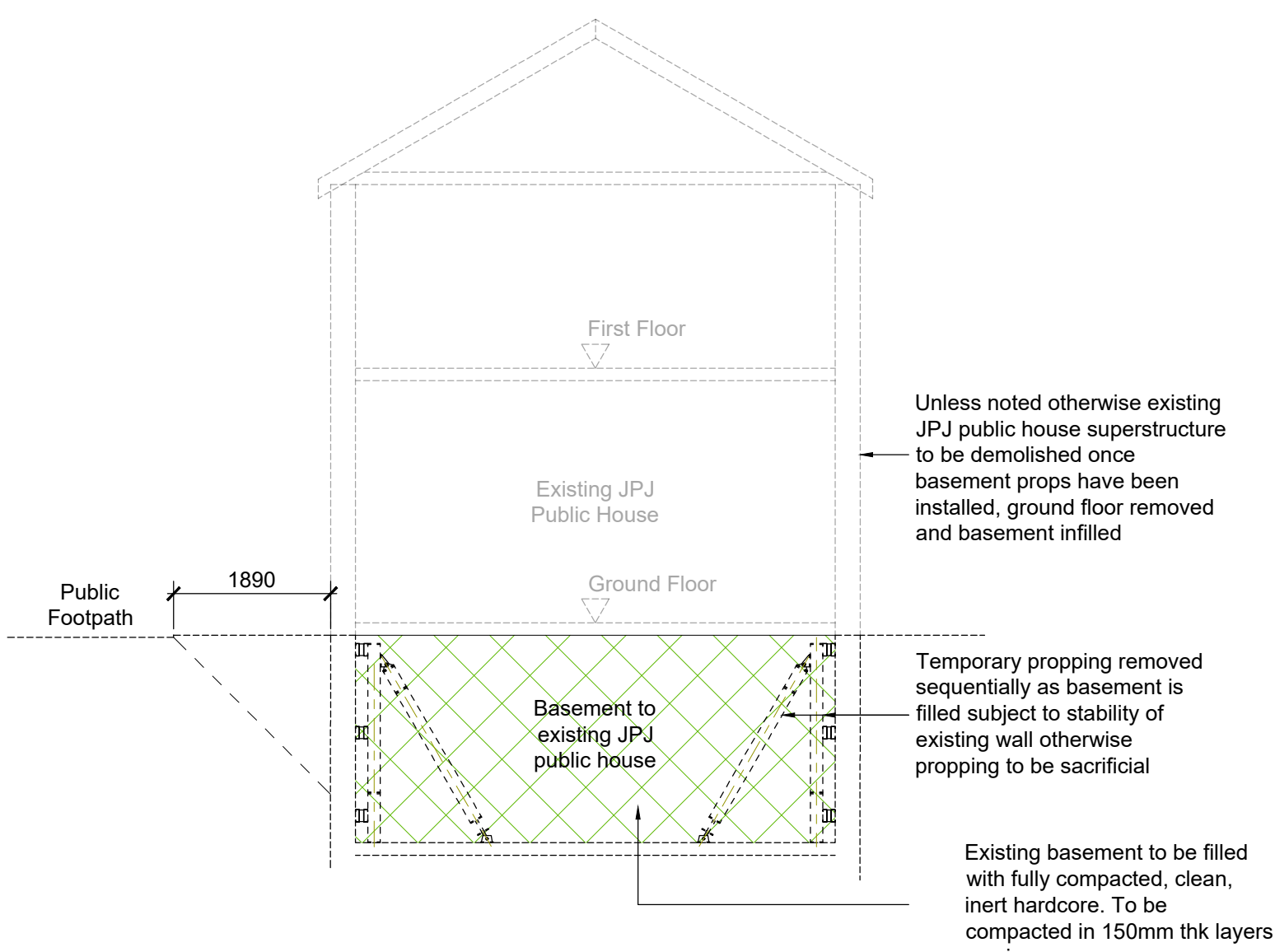

Section D-D

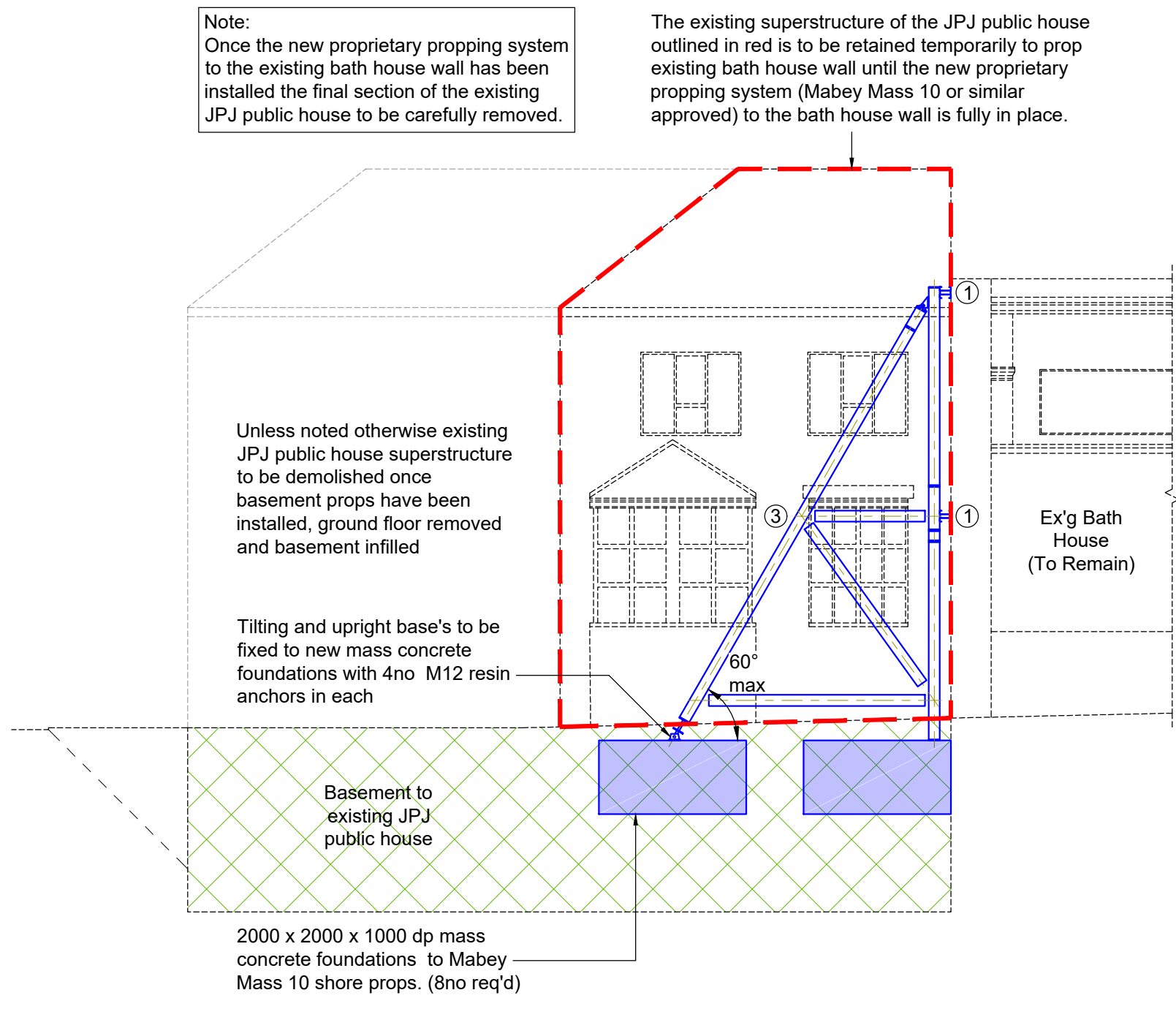

Section E-E

NOT FOR PRICING

NOT FOR CONSTRUCTION

Issued for Information IM P01 JFC 01/10/2024  
AMENDMENT BY REV CHK DATE



Billingham George & Partners  
CIVIL & STRUCTURAL ENGINEERS | BUILDING SURVEYORS

@BGPconsulting www.bgp-consulting.co.uk  
Teesside 01642 876470 Tyneside 0191 495 4100

Client Norr  
Project Modification Works To Whitehaven Levels  
BGP Project No. 226014  
Drawing Title Proposed Propping Details To Basement & Bath House Wall  
Drawn Date Checked Date Size Scale Rev.  
IM Oct. 24 JFC Oct.24 A1 1:75 P01  
Location Originator Volume Level Form Role Unique No.  
DGHW BGP 02 ZZ D S 01600  
File Reference

DGHW-BGP-02-ZZ-D-S-01600

In instances where this drawing completes or partly completes a contract, Billingham George & Partners will consider that it's product has been validated, unless in a period not exceeding 90 working days, the client advises to the contrary.