

- Structural Works Notes:
- Reinforced Concrete shall be a minimum of RC35 to BS8500 Part 1 and BS EN 206-1.7
 - Mesh reinforcement shall be deformed Type 2 high yield steel to BS4483. Minimum lap = 450mm.
 - All concrete to be cured and protected from frost for a minimum of 7 days after casting.
 - The ground is to be stripped of topsoil, vegetation and unsuitable fill before the raft construction begins.
 - Where ground levels are being considered to be raised with site arising fill material placed below the raft foundations, site material is to be tested to determine the material classification in accordance with Table 6/1 of Specification of Highway Works (Vol 1) by suitably qualified person.

Notes:
Sketch schemes may be based on plan information of unknown origin and is subject to verification and survey.
Contractors must verify all dimensions on site before commencing any work or shop drawings. This drawing is not to be scaled. Use figured dimensions only.
Building areas are liable to adjustment over the course of the design process due to ongoing construction detailing developments.
Subject to statutory approvals and survey.

50 40 30 20 10mm

ELEVATIONS @1:100

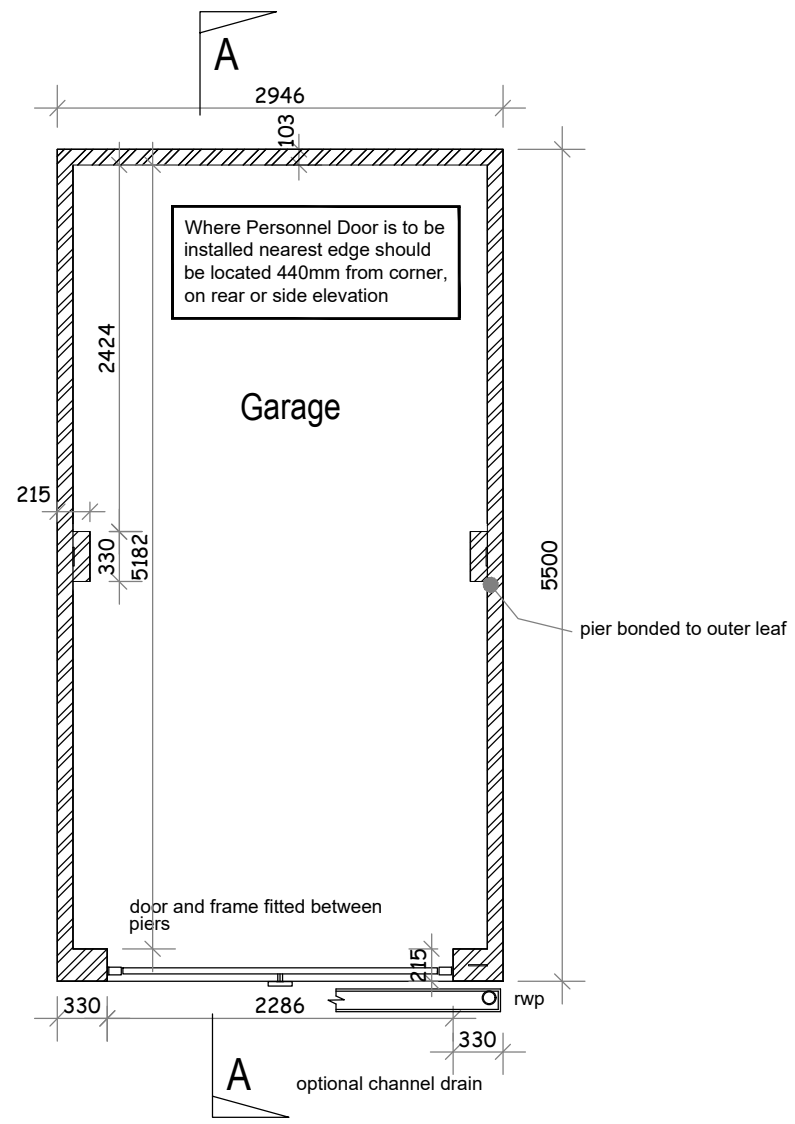

Roof construction to be designed, fixed & braced in accordance with B.S 5268 pt 3 . Refer to truss manufacturers drawings for details

Blockwork taken up to underside of felt and firestopped using 50mm Rockwool blanket above, and below felt

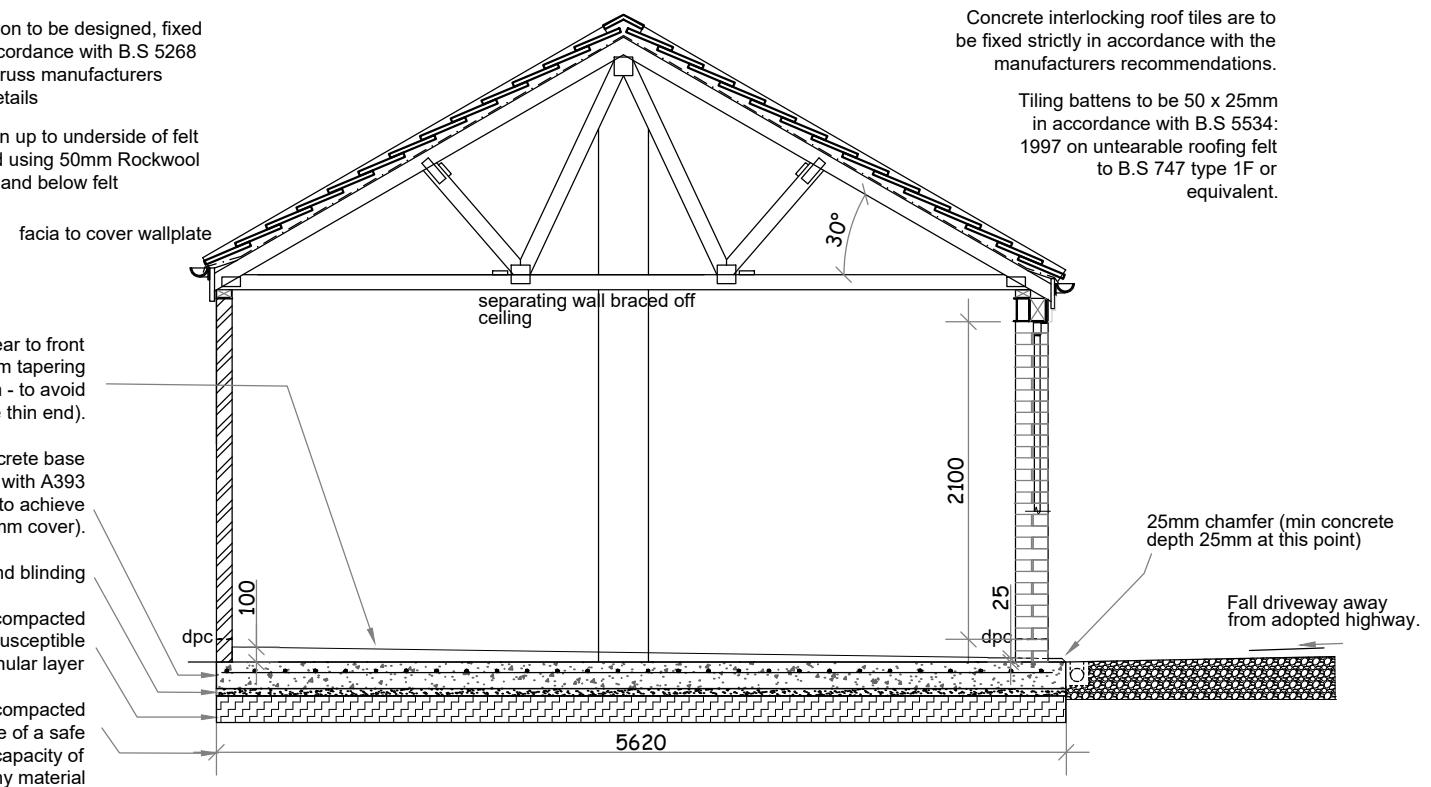

Concrete interlocking roof tiles are to be fixed strictly in accordance with the manufacturers recommendations.

Tiling battens to be 50 x 25mm in accordance with B.S 5534: 1997 on untearable roofing felt to B.S 747 type 1F or equivalent.

SECTION A-A @1:50

PLAN @1:50

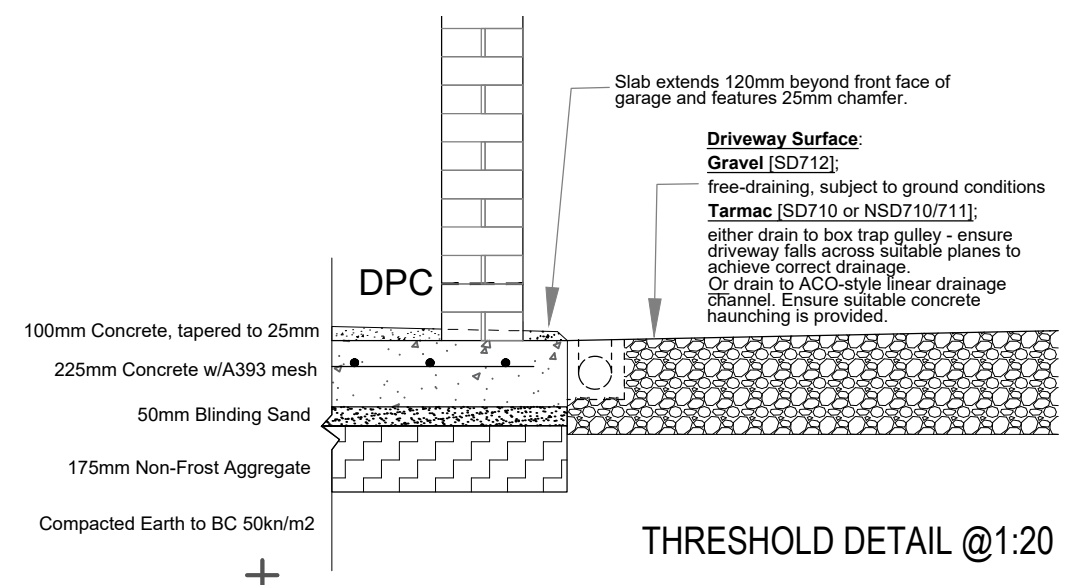

THRESHOLD DETAIL @1:20

E	Slab and threshold details added	11.03.21	AB
D	Mesh reference corrected.	02.09.19	DJR
C	Drawing Re-Titled.	14.05.19	DJR
B	Personnel door note added. Raft Details added.	04.04.19	djr
A	Detail added following client comments	04.07.13	wc
revisions			
status	-		
project	Standard Details		
client	Gleeson Homes & Regeneration		
title	Detached Single Garage Details		
drawn	djb	checked	.
date	22.08.12	scale	As Indc.@A3
job no	0282	drawing no	SD700
rev	E		

