

## Design and Access Statement (listed building consent)

### 1. Features on the existing site to include:

- Buildings – size, age, style, condition (further detailed information should be provided in the historic environment section if appropriate).
- Gardens, landscaping and other open areas.
- Boundaries – walls, railings, fences or other means of enclosure
- Immediately adjoining buildings and sites.

The old water tower is a grade II listed structure located in a grassed area to north of Seascale Sports Hall (formerly listed as in railway goods yard). A prominent landmark near the seashore this 3-stage water tower is in a former railway goods yard from the late C19 (For Furness Railway Co). It is made of rock-faced stone with ashlar bands and dressings with a conical slate roof. Its top is corbelled out and it has 2-light single-chamfered mullioned window to 1<sup>st</sup> and 3rd levels. There is an entrance with shouldered lintel to south. The Conical roof has finial. No boundary walls adjoining it sits within a grassed space and you can walk around the entire structure.

### 2. How access issues have been addressed

The 'access' component should deal with both interior design and management issues to demonstrate not just compliance with the design details in the Access Design Guide SPD, but also how the applicant intends to meet their duties under the Equality Act 2010 (which incorporates the Disability Discrimination Act 1995).

The interior is not being used, only the exterior. It is our belief that access to interior is not permitted to the public at present. Access to the artwork is permitted visually, as it will be visible to publics around and passing. The artwork will be accompanied by a sign with information about the artwork. An example of signage design is attached with information about the artwork, title, name and artist, giving full info about it.

#### **Approaches to and around the site, including transport links:**

The water tower is across the road from the local train station at Seascale, and a 2 min walk to the water tower.

#### **Car-parking, setting down points, location of dropped kerbs (if required):**

There is car parking on road in Seascale and easy to park, a large car park is located about 3 minutes away facing the sea. There is also some parking at the sports hall site with drop kerbs.

#### **All entrances, including visibility:**

The artwork is located outdoors, and will be easily visible.

#### **General horizontal/vertical circulation and layout arrangements:**

N/A

**Appropriate use of surface materials:**

N/A

**Facilities within the building including WC provision, circulation within units and explanation of accessibility standards through all public parts of the building:**

The artwork is located outdoors. There are public conveniences in Seascale and at the Sports Hall which can be found on the internet.

**Way-finding and signage:**

Signage will be provided on site see example in the LBC application documents.

**An assessment of means of escape:**

N/A outdoor artwork.



**3. Details of the layout of proposed development**

- Relationship of buildings, routes and spaces.

- Safety and security.

See layout plan and drawings for further info on the artwork which will be fixed to an existing building and accessible visually to all. Safety and security have been considered the artwork will be some 3 metres above ground, and installed by a contractor for the National Park and with experience of installing artworks and works in public space.

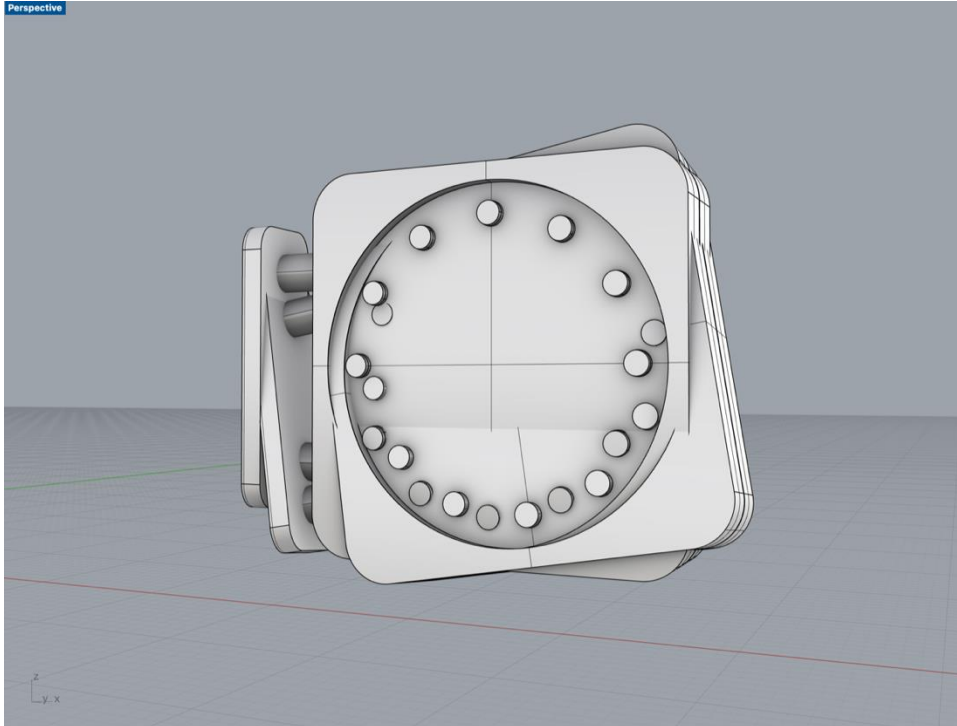

#### 4. Please provide details of the scale/appearance of the proposed development

- Height, width, length, materials, detailed design.
- Relationship to surrounding development.
- Relevant local and national policies and guidance.

The artwork is a stainless-steel clock form, it is roughly 440(w) x 315(h) x 88(d)mm. It will weight some 55kg.

The clock is a generic design however it will not have moving parts or function.

Cumberland Council has a cultural strategy and other planning policies.

The artwork was commissioned by the Council as part of [www.deeptime.uk](http://www.deeptime.uk) as part of a Government funded project funded by HM Coastal Communities Fund.

#### 5. details of the landscaping in the proposed development to consider:

- Suitability – is the ultimate size appropriate for the space the plant will have, it is important to avoid conflict with buildings. Large vigorous trees too close to structures will require expensive and regular pruning. Will the species choice be tough enough to survive the site conditions?

- Interest – Does the plant for example display any of the following features – attractive bark, flowers, interesting foliage and autumn colour? Sometimes trees which bear fruit are not suitable for heavily used areas.
- Sustainability – is there sufficient soil depth available and has irrigation and drainage been supplied where planters have been specified? Trees and plants grown in the ground will live longer and need less maintenance than those grown in planters. Where there is subterranean development a metre depth of soil must be provided over the structure.

No landscape works are proposed. The artwork would be fixed to the building with a single sign at ground level attached to a ground floor window which has been boarded up, fixed to the wood, which is not an original feature. We suggest the council advises on a suitable condition for this element.

## 6. Details of how Heritage Assets issues have been addressed:

### **Describe the assets affected – listed buildings, conservation area, archaeology etc.**

No assets are affected, the artwork is a small element that would be fixed to the structure for 12 months as part of a public art project and removed after.

### **Define their significance (in the case of buildings in conservation areas, their contribution to the character or appearance of the area).**

The water tower building adds to the character of Seascale. It is a local landmark, however it is not used, or accessed by publics as not publicly accessible, rather it is a landmark that can be observed on the landscape, and from the nearby train station or road. Christmas lights are currently attached to it, which would be removed and reinstalled during the festive period.

### **Assess the impact of the proposals on the heritage asset, including reference to national and local policies and guidance.**

We feel the installation of the artwork would draw attention to this local landmark as part of a temporary art work / art programme. Cultural programmes often make use of public buildings, parks and heritage assets, such as the national trust and others organisations, which site works of art in their grounds or on buildings. Such uses can animate and draw attention to overlooked landmarks and heritage assets and enrich the publics knowledge of and understanding of our shared heritage.

### **If the impact is harmful to the significance of the historic asset, set out the public benefits which justify the proposal.**

This is a temporary artwork we do not see this has having a harm long term. The public benefits are great, especially in Seacale which is in a priority area for the Arts Council and with limited cultural offers.

Ends.

Aldo Rinaldi, July 2023.