

## Condition 10: School Car Parking

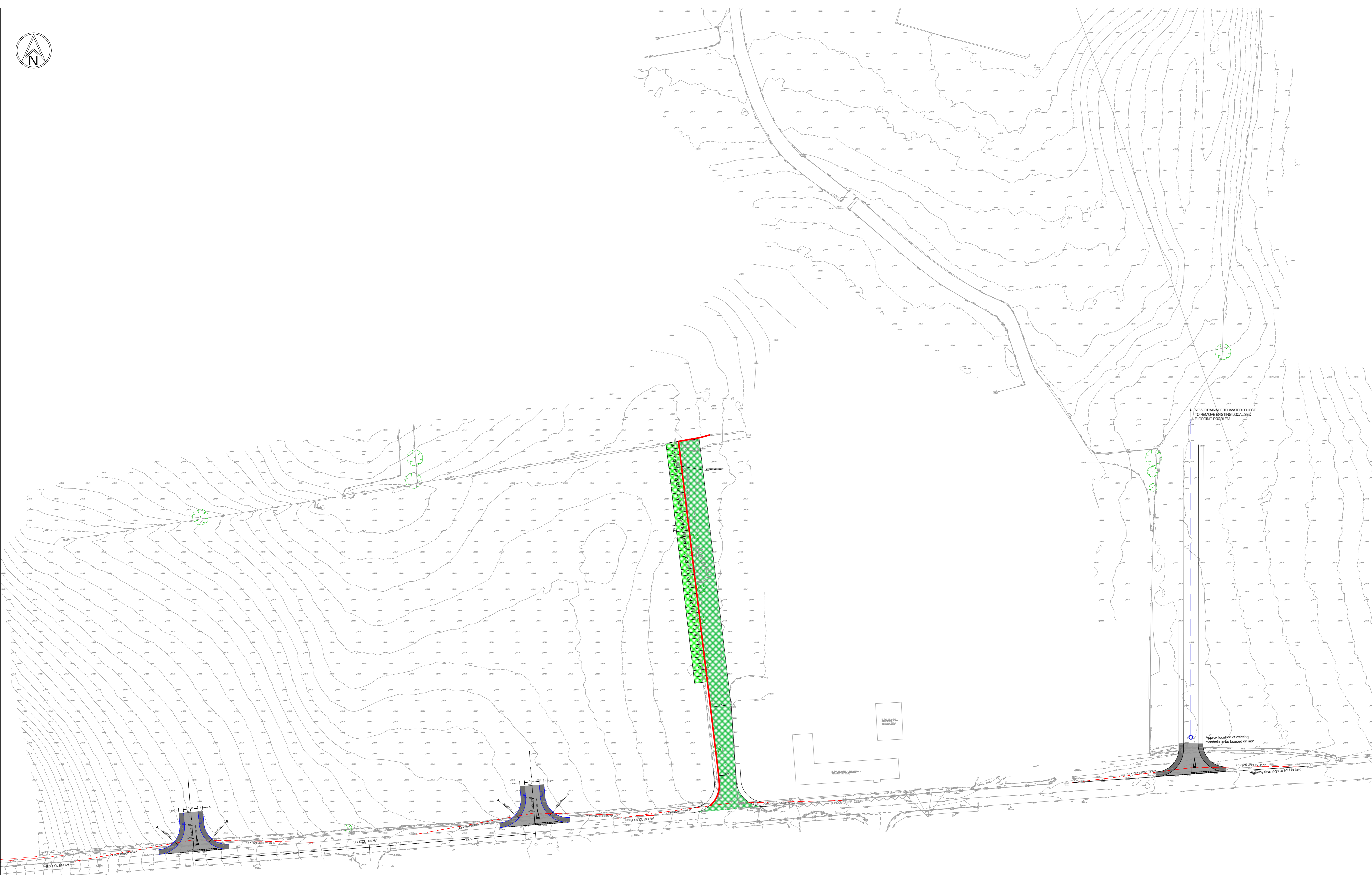
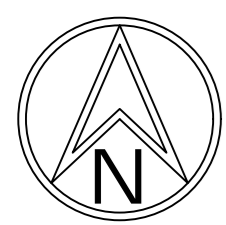

- DESIGNERS RISK NOTES**
- IN ACCORDANCE WITH THE CONSTRUCTION (DESIGN & MANAGEMENT) REGULATIONS 2015, IT IS THE POLICY OF THIS PRACTICE TO DESIGN OUT AS MANY IDENTIFIABLE RISKS AS POSSIBLE FOR THE CONSTRUCTION, OPERATION AND MAINTENANCE OF THE PROJECT.
  - ALL DRAWINGS ARE TO BE READ IN CONJUNCTION WITH THE PRE-CONSTRUCTION INFORMATION WHICH IS DEFINED IN THE CONSTRUCTION (DESIGN & MANAGEMENT) REGULATIONS 2015.
  - A COMPETENT CONTRACTOR SHOULD BE AWARE OF NORMAL RISKS INVOLVED WITH THE CONSTRUCTION PROCESS, HOWEVER ADDITIONAL PRECAUTIONS WILL NEED TO BE CONSIDERED FOR THE FOLLOWING ITEMS:
    - NONE IDENTIFIED.
  - SAFE METHODS AND SYSTEMS OF WORK REMAIN THE RESPONSIBILITY OF THE CONTRACTOR AND MUST BE IDENTIFIED IN THE CONSTRUCTION PHASE PLAN. THE CONSTRUCTION PHASE PLAN MUST BE IN PLACE PRIOR TO THE START OF ANY MOBILIZATION OR SITE WORKS.
    - NONE IDENTIFIED.
  - RESIDUAL RISKS THAT HAVE BEEN IDENTIFIED AND CANNOT BE DESIGNED OUT ARE AS FOLLOWS:
    - NONE IDENTIFIED.
  - IF ANY PARTY USING THIS DRAWING CONSIDERS THAT THERE ARE ABNORMAL RISKS THAT HAVE NOT BEEN IDENTIFIED ABOVE, THEN THE ENGINEER SHOULD BE NOTIFIED.

- KEY:**
- 4.5 X 4.5M VISIBILITY SPLAY
  - EXTENT OF SCHOOL BOUNDARY
  - PROPOSED GRANAGE TO EXISTING WATERCOURSE
  - 1.8M FOOTPATH
  - CARRIWAY CONSTRUCTION MAJOR ACCESS ROAD
  - ACCESS ROAD TO SCHOOL PARKING WITHIN SCHOOL OWNERSHIP
  - PARKING BAYS FOR SCHOOL WITHIN DEVELOPERS OWNERSHIP
  - EXISTING MANHOLE - LOCATION TO BE CONFIRMED ON SITE

**NOTES**

WHITE LINING:-  
 DIAGRAM REFERENCES RELATE TO THE TRAFFIC SIGNS MANUAL - CHAPTER 5: ROAD MARKINGS.

ALL WHITE LINING AND ROAD MARKINGS ARE TO BE IN ACCORDANCE WITH THE CURRENT EDITION OF THE TRAFFIC SIGNS MANUAL.

SUBJECT TO LOCAL AUTHORITY APPROVAL

201115	School parking area and proposed site entrance added	RF	RWD	A
Date	Revisions	Drawn	CHKD	Rev

**INFORMATION**

RWO ASSOCIATES  
 CONSULTING ENGINEERS

RWO Associates LTD  
 6A Union Quay  
 North Shields  
 Tyne & Wear  
 NE30 1HJ  
 www.rwoassociatesuk.com

Client: TAYLOR & HARDY

Project: LAND AT MORESBY CUMBRIA

Title: PROPOSED DEVELOPMENT ACCESS PLAN

Scale	1:500	Drawn	AE	Checked	RWD	Date	27.10.2015
Job No.	15020	Drawing No.	800	Revision			A