

10 April 2025



Cumberland Council
Cumbria House
101-117 Botchergate
Carlisle
CA1 1RD

Dear Sir/ Madam,

MILLOM LIBRARY, ST GEORGES ROAD, MILLOM – DISCHARGE OF PLANNING CONDITION 3 ON APPLICATION REF. 4/24/2172/0F1

On behalf of our client, NDA Properties Ltd please find enclosed an application for approval of details reserved by Condition 3 of planning application ref. 4/24/2172/0F1 for the repair and improvement works to Millom Library, St George's Road, Millom.

This letter sets out the information submitted and the condition wording to which they relate.

Condition 3

Prior to their installation within the development hereby approved full details of the replacement windows must be submitted to and approved in writing by the Local Planning Authority. The development must be carried out in accordance with the approved details and must be maintained at all times thereafter.

In accordance with this condition and in line with the planning application all the windows to the front and side elevations to the main library building are timber frame and exactly the same fenestration and type as existing. These are detailed on the following plans:

- Energy Efficient Window Specification Document Sheet 1 of 3
- Energy Efficient Window Specification Document Sheet 2 of 3
- Energy Efficient Window Specification Document Sheet 3 of 3

For ease of reference, the window numbering on the specification sheet 1 of 3, align with the approved plans from the main application. These are submitted for informative purposes and ease of reference:

- d02_-_ground_floor_demolition_plan
- p03_-_proposed_upper_floors_layout_plan

Example as follows:

Window 11 noted on the Ground Floor Plan:

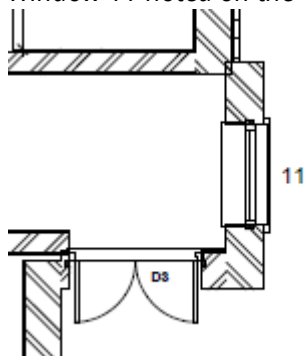

Window 11 specification included in the Specification Sheet 1 of 3:

1		W11
Chamf IG S706 Casement		Specification
O/A Sizes 1150mm x 1800mm (Style 14)		
		Frame (Head)
		546185 72mm IG O/F
		Frame (Cill)
		546185 72mm IG O/F
		Frame (Left jamb)
		546185 72mm IG O/F
		Frame (Right jamb)
		546185 72mm IG O/F
		Transom
		546085/95 69mm IG T/Z
		Sash
		546106/66 IG T/Z Sash
		Cill
		150mm Deep Nose Cill
		Ventilator (Sash)
		4000mm Vent
		Colour
		White
		Sash colour
		White
		Cill colour
		White
		Drainage
		Concealed/Base
		Handle
		Trinity White Handle
		Friction stay
		Restrictor Stay
		Viewed from
		Viewed from Inside
		Open in/out
		Open out
		Glazed in/out
		Glazed in
		Reinforcing rule
		Fully Reinforced

Glazing Details & Apertures			
4-20-4 Planitherm Total+ T/Float Tuff : 20mm Black Warm Edge Georgian			
Bar	18mm Bar White	Std Joints	Argon Gas Filled
A1 -	(1039 x 811)	A6 -	(941 x 713)

Notes :

All other windows are PVCu Double Glazed units as the information submitted on the following documents:

- T40954 - Jan25 - Keyframe Total Hardware A4 Technical Sheet_Apex Cranked Window Handle_V1
- T40954 - Jan25 - Keyframe Total Hardware A4 Technical Sheet_Apex QuadLock_V8

Summary

I trust that the enclosed information will enable you to approve the proposals in line with the condition requirements. If you have any queries or require any further details, please do not hesitate to contact me.



Yours faithfully,

Joseph Smith
Associate Planner

For and on behalf of Avison Young (UK) Limited