

C1
ACCESS ROAD - RESURFACING
Scale 1:10

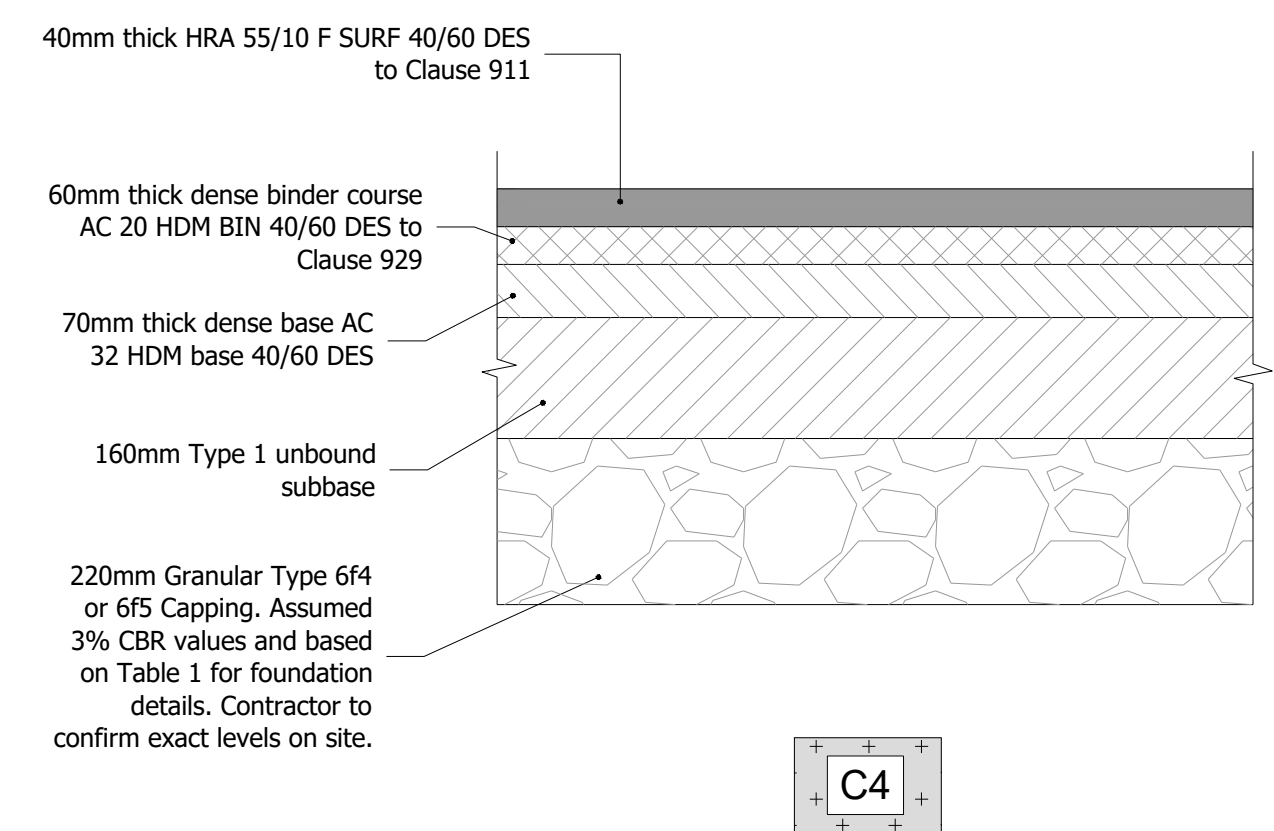

C4
CAR PARK ROAD - FULL CONSTRUCTION
Scale 1:10

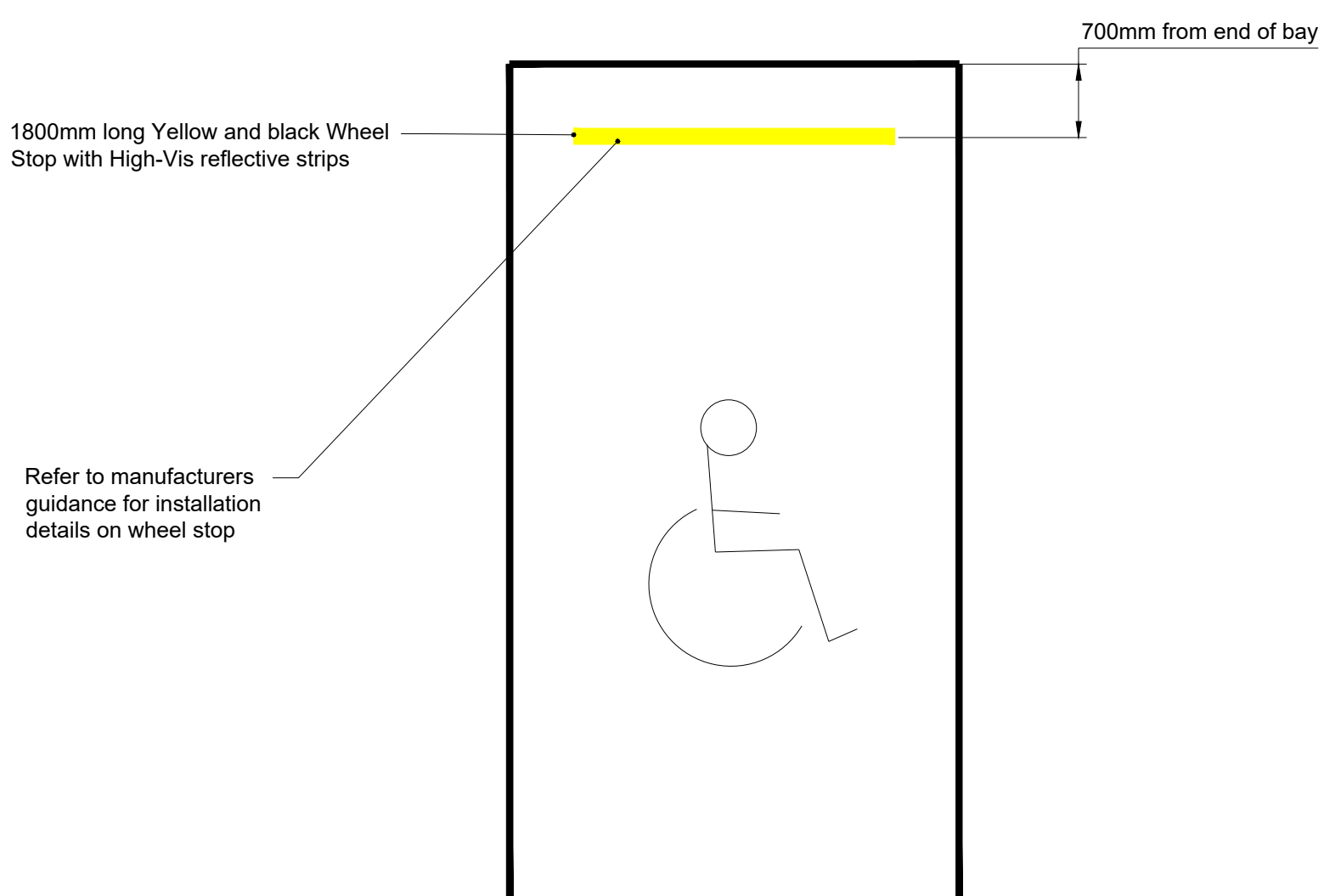

TYPICAL PLAN- WHEEL STOPS
Scale NTS

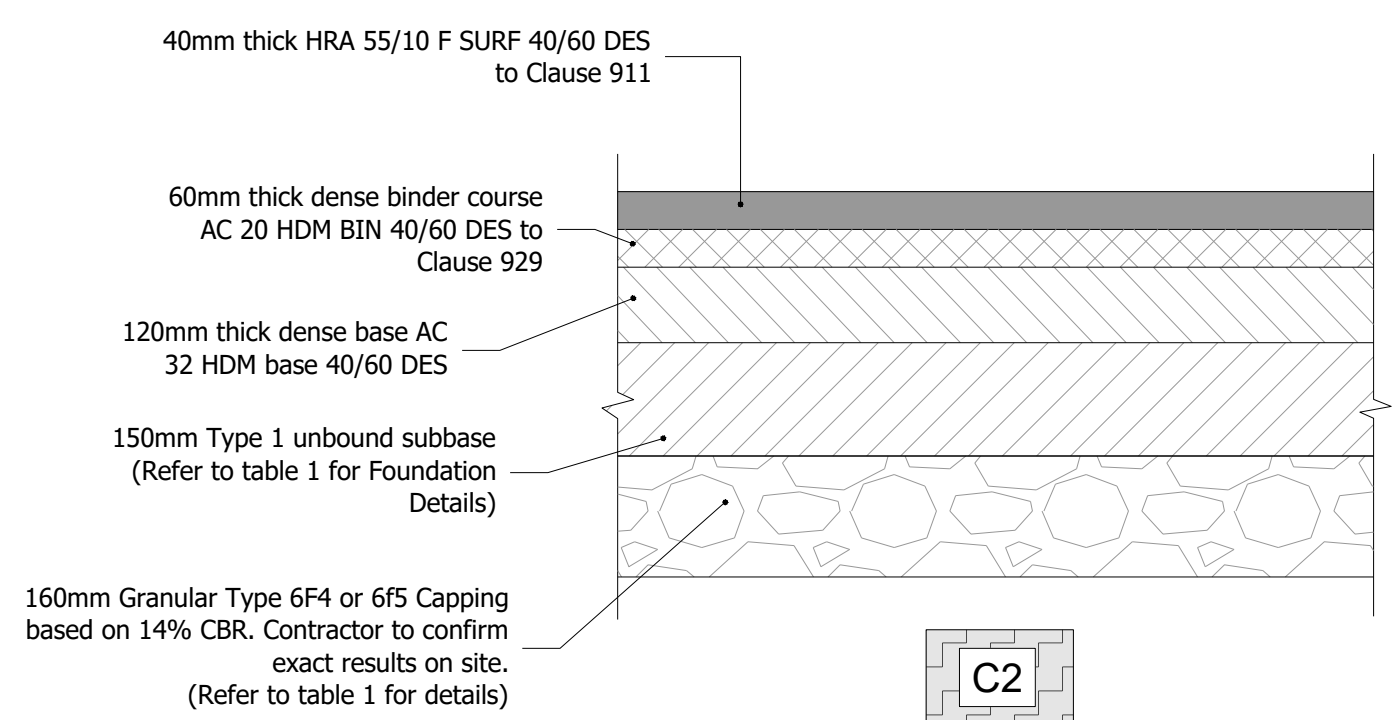

C2
ACCESS ROADS - FULL CONSTRUCTION
Scale 1:10

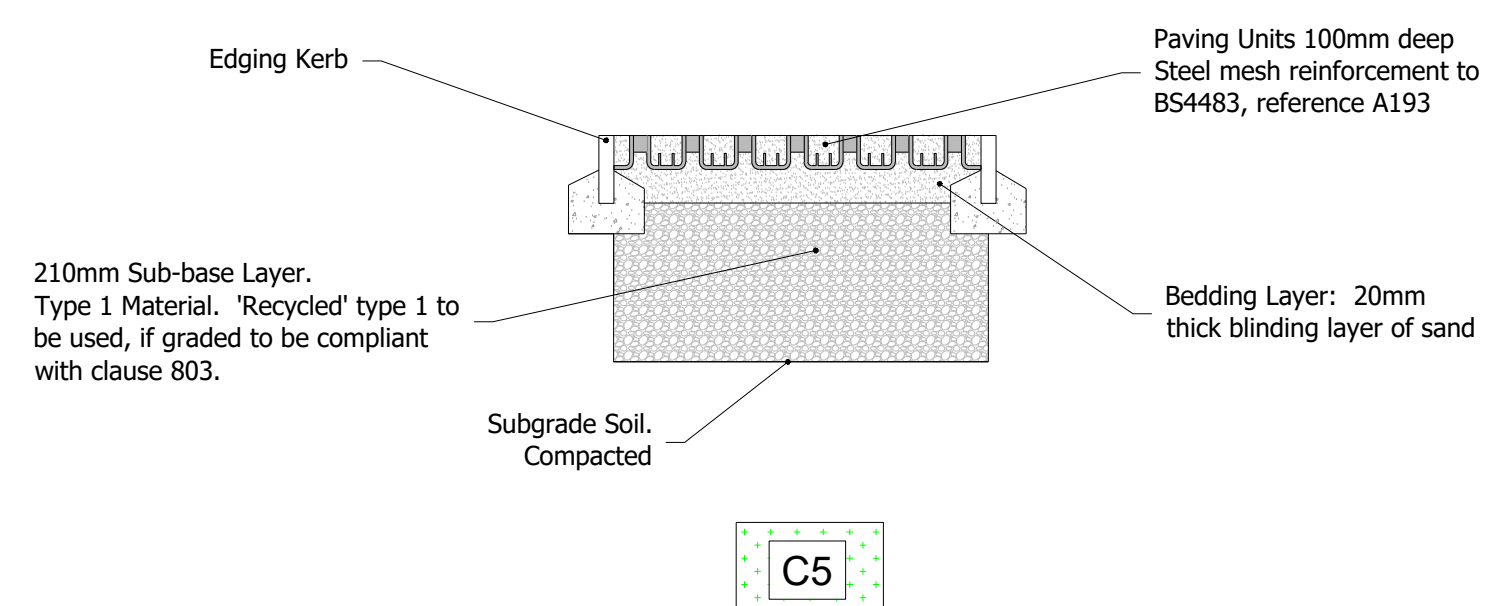

C5
MARSHALL'S GRASSGUARD (Or Similar Approved)
N.T.S.

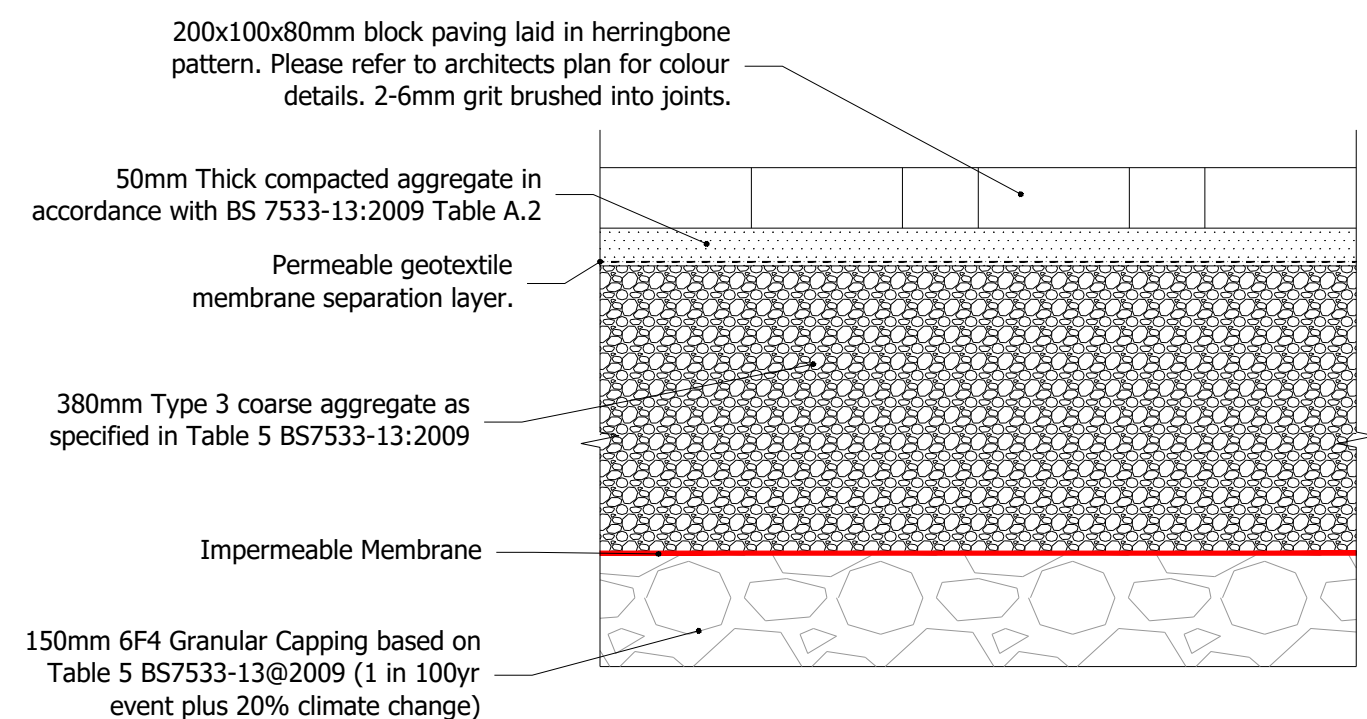

C3
CAR PARK BAY CONSTRUCTION - PERMEABLE PAVING
Scale 1:10

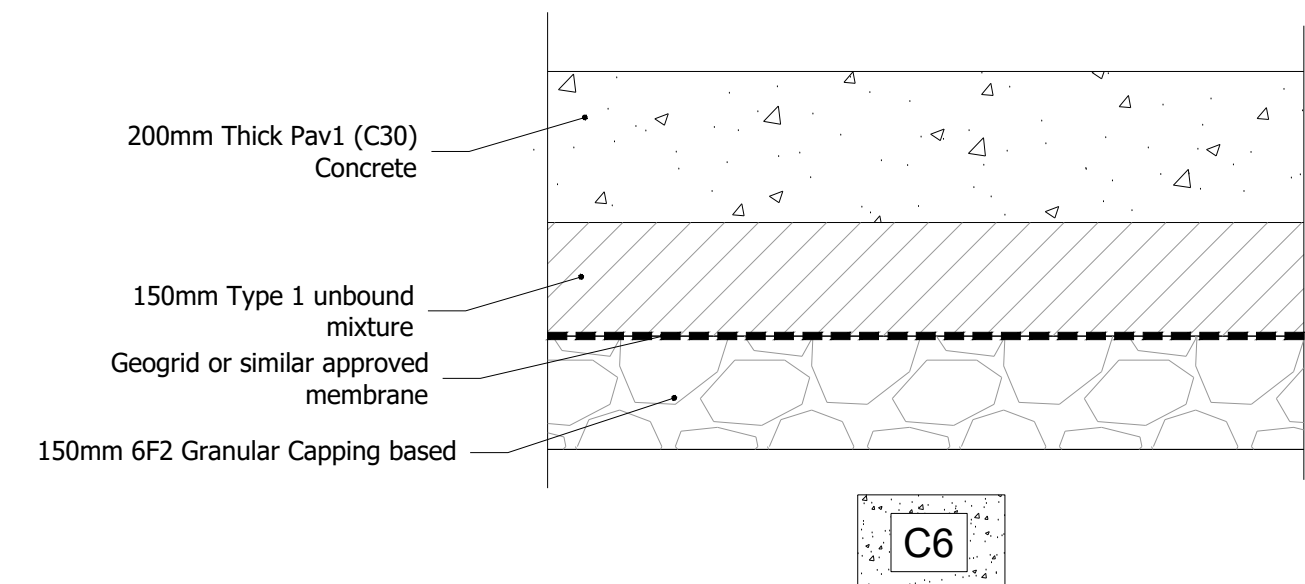

C6
CONCRETE SLAB - BIN STORE
Scale 1:10

| TABLE 1 - PAVEMENT FOUNDATION | | | |
|-------------------------------|---|---|----------------------------------|
| CBR(%) | SUBBASE ONLY (mm) | SUBBASE ON CAPPING (mm) | |
| | Class 2 Foundation from Fig 3.18 CD 225 | Class 2 Foundation from Fig 3.20 CD 225 | |
| | SUBBASE | SUBBASE | CAPPING |
| 15 or more | 200 | 150 | 150 |
| 14 | 210 | 150 | 160 |
| 13 | 210 | 150 | 170 |
| 12 | 220 | 150 | 180 |
| 11 | 220 | 150 | 190 |
| 10 | 230 | 150 | 200 |
| 9 | 230 | 150 | 210 |
| 8 | 240 | 160 | 220 |
| 7 | 250 | 170 | 230 |
| 6 | 260 | 190 | 240 |
| 5 | 270 | 200 | 250 |
| 4 | 310 | 220 | 320 |
| 3 | 370 | 230 | 380 |
| 2.5 | 420 | 250 | 430 |
| less than 2.5 | not covered by fig 3.18 of CD 225 | not covered by fig 3.2 of CD 225 | not covered by fig 3.2 of CD 225 |

- A. Sub-base to be to Cl.803 of the Specification for Highway Works (SHW) Type 1 Limestone. Sub-base shall never be less than 150mm thick.
- B. Capping layers 300mm thick or more shall be 6F1 to Cl.613
- C. Capping layers less than 300mm shall be Type 2 Sub-base or similar approved.
- D. No material within 450mm of finished surface levels shall be frost-susceptible.

NOTES

- This drawing is to be read in conjunction with all relevant architects, engineers and specialists drawings and specifications.
- All works shall be in accordance with the Highway Authority's approved documents and satisfaction. Any reference to the specification shall mean the general specification for roadworks.

FOR APPROVAL

| | | | | | |
|------|---|------------|------|------|------|
| P03 | RIBA STAGE 4 - ISSUE FOR STAGE APPROVAL | 20.09.2024 | LJB | MB | LB |
| P02 | MS AND RSA COMMENTS INCORPORATED | 28.07.2023 | LJB | MB | LB |
| P01 | PRELIMINARY FIRST ISSUE | 16.06.2023 | LJB | MB | LB |
| Rev. | Description | Date | Rev. | Rev. | Rev. |

Document Control

Issuing Office
Tetra Tech Manchester
2nd Floor,
11 York Street,
Manchester, M2 2AW
Tel: +44 (0)161 872 3223
www.tetratecheurope.com

Client



CUMBERLAND COUNCIL

Project Name
CLEATOR MOOR INNOVATION QUARTER (CMIQ) HUB

Sheet Title
**STAGE 4
STANDARD DETAILS
SHEET 1**

| | | | | | | | | |
|--------------------|----------|---------|------------|---------|-------------|---------|------------|-------------|
| TTE Project Number | Drawn By | Date | Checked By | Date | Approved By | Date | Scale @ A1 | Suitability |
| 784-B034942 | LJB | May '23 | MB | May '23 | LB | May '23 | AS | S4 |

| | | | | | | |
|-----------------------|------------|------------------------------|-----------|------|--------|------------|
| Client Project Number | Originator | Volume/System Level/Location | Type/Code | Role | Number | Revision |
| CMIQ | - TTE | - HUB | - ZZ | - DR | - H | - 2600 P03 |