

## Notes

- |  |
|--|
| <p><u>Manhole S5 Flow Control Details</u></p> <p>Hydro-Brake® Optimum Flow Control - Surface/Storm Drainage System</p> <p>1Nr 157mm Type SH (MD5) Hydro-Brake® Flow Control (Horizontal Discharge)</p> <p>Technical Criteria: Design / Duty Point Flow = 15,000 l/s</p> <p>Head = 2.250m</p> <p>Flush-Flo™ Point Flow = 15,000 l/s Head = 0.658m</p> <p>Kick-Flow Point Flow = 11,800 l/s Head = 1.353m</p> <p>Reference: MD-SHE-0157-1500-2250-1500</p> |
|--|

Rev P = Preliminary T = Tender C = Construction LCI = Last Construction Issue

---

In instances where this drawing completes or partly completes a contract, Billinghurst George & Partners will consider that its product has been validated, unless in a period not exceeding 90 working days, the client advises to the contrary.



CIVIL &amp; STRUCTURAL ENGINEERS | BUILDING SURVEYORS

1st Floor, Wellington House, Wellington Court, Stockton-on-Tees, TS18 3TA  
T 01642 876 470 @BGPconsulting E consulting@bgp-teeside.co.uk - W www.bgp-consulting.co.uk

**Client**  
Copeland Borough Council

<b>Project</b>	<b>Project No.</b>
Cleator Moor Innovation Quarter	21T2034

<b>Drawing Title</b>	BOC - Flow Control Manhole
----------------------	----------------------------

Drawn	Date	Checked	Date	Size	Scale	Class.	Rev.
JJH	Aug 2022	JC	Aug 2022	A1	As Noted	52	P02

Location	Originator	Volume	Level	Type	Role	Unique No.
CMIQ	BGP	04	XX	DR	C	04136

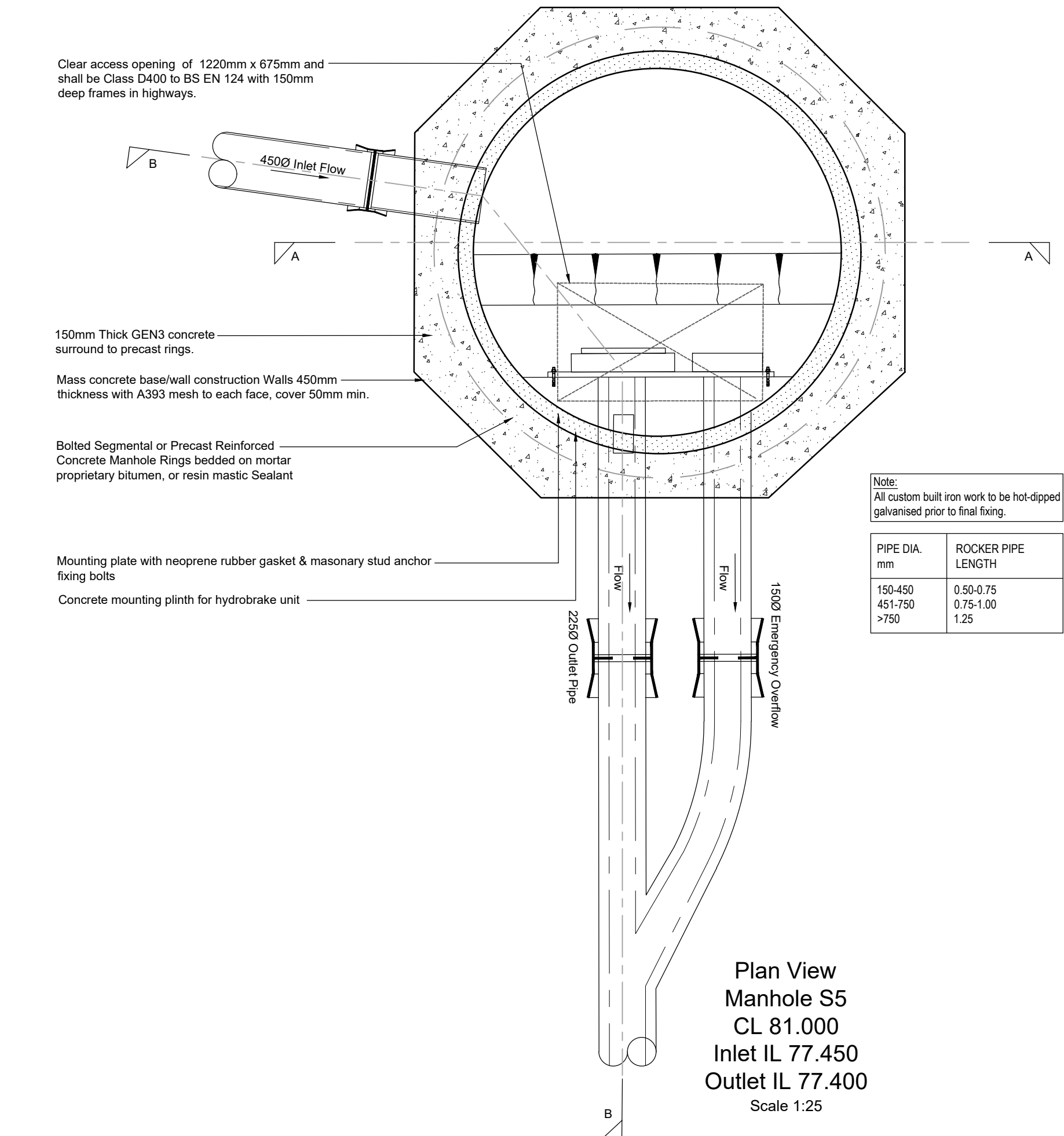

Pipe size	Bar size
1050 - 1200mm	T12
1350 - 1500mm	T16
< 1500mm	T20

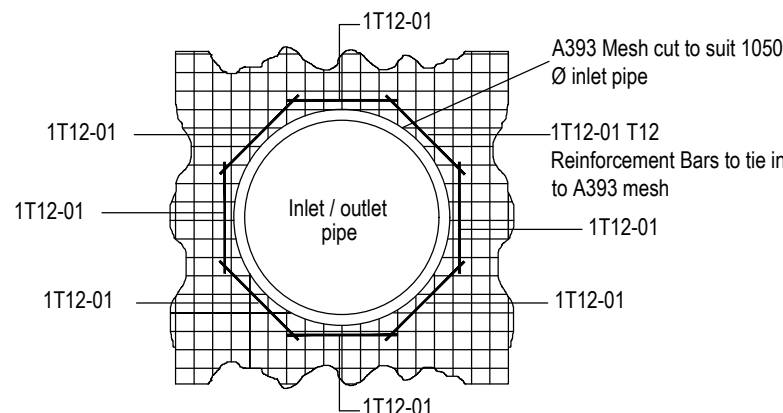

## Section Thro' Reinforcement To Inlet / Outlet Pipe (Scale 1:10)

See Table 1 For Bar Sizes Required  
(Scale 1:10)