

© COPYRIGHT MANNING ELLIOTT PARTNERSHIP 2022.

THIS DRAWING IS THE PROPERTY OF MANNING ELLIOTT PARTNERSHIP. IT MUST NOT BE COPIED OR REPRODUCED OR DIVULGED TO ANYONE WITHOUT PERMISSION.

DO NOT SCALE OFF THIS DRAWING. ANY DISCREPANCIES TO BE REPORTED TO MANNING ELLIOTT PARTNERSHIP.

REVISIONS:		
Revision C	LS	OCT 22
Revision D	LS	FEB 22
Revision E	LS	FEB 22
Revision F	LS	APR 22
Revision G	PT	MAY 22
GATE POSTS AMENDED		
REVISION H	PT	JUL 22
PARKING ALTERATIONS		

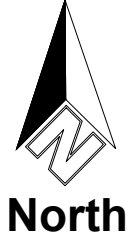
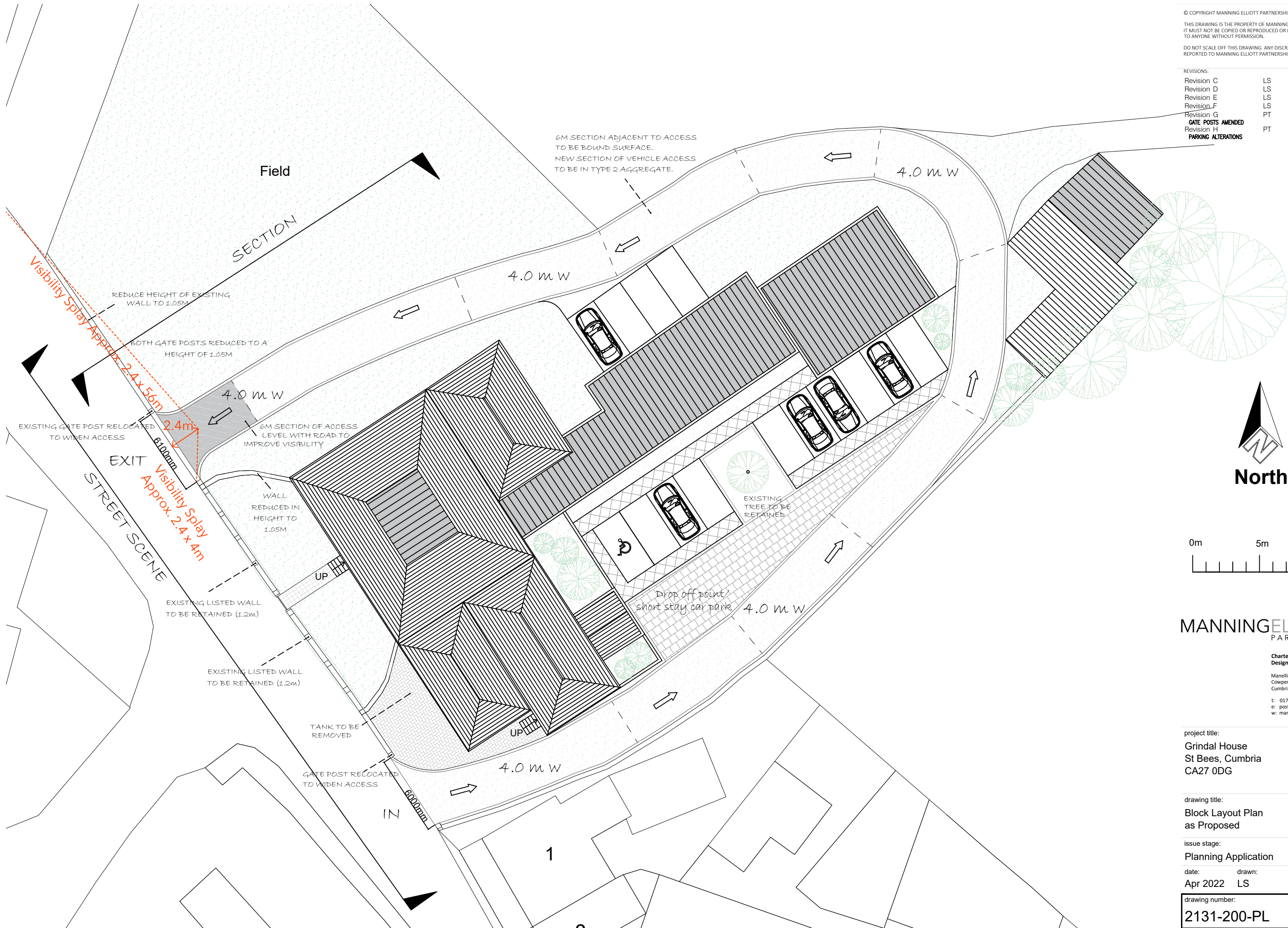

MANNINGELLIOTT
PARTNERSHIP

Chartered Architects & Designers

Manelli House, Suite 1
Cowper Road, Penrith
Cumbria CA11 9BN

t: 01768 868 800
e: post@manning-elliott.co.uk
w: manning-elliott.co.uk

project title:
Grindal House
St Bees, Cumbria
CA27 0DG

drawing title:
Block Layout Plan
as Proposed

issue stage:
Planning Application

date: Apr 2022 drawn: LS scale @ A3: 1:250

drawing number:	revision:
2131-200-PL	H