

- NOTES:**
- THIS DRAWING IS COPYRIGHTED AND MUST NOT BE REPRODUCED WITHOUT THE WRITTEN PERMISSION OF PETTIT SINGLETON ASSOCIATES.
 - THIS DRAWING SHALL BE READ IN CONJUNCTION WITH ALL LATEST ARCHITECT'S DRAWINGS. BEFORE COMMENCING WORK ANY DISCREPANCY BETWEEN THE DRAWINGS AND THE SPECIFICATION SHALL BE BROUGHT TO THE ATTENTION OF THE ENGINEER, PETTIT SINGLETON ASSOCIATES.
 - DO NOT SCALE. THE POSITION OF ANY ITEM OF EQUIPMENT OR OUTLET ON THIS DRAWING.
 - THERE SHALL BE NO CHANGES TO THE PROPOSALS WITHOUT THE AGREEMENT OF THE ENGINEER.
 - ALLOW A DOUBLE PIPE SET WHEREVER PIPES PASS THROUGH WALLS, FLOORS AND CEILINGS TO ALLOW FOR POSSIBLE STRUCTURAL OBSTRUCTIONS.
 - DRAIN COCKS TO BE INSTALLED AT LOW POINTS AND AIR VENTS AT ALL HIGH POINTS.
 - ALL WORKS TO BE FULLY IN ACCORDANCE WITH LOCAL AND MODEL BYELAWS AND GAS SAFETY REQUIREMENTS.
 - ALL STEEL WORK FOR THE SUPPORT OF PLANT AND PIPEWORK SHALL BE PROVIDED BY THE MECHANICAL CONTRACTOR.
 - ALL PIPEWORK PASSING THROUGH WALLS AND FLOORS SHALL BE SLEEVED.
 - ALL NEW PIPEWORK TO BE PAINTED PRIOR TO INSULATION.
 - CONTRACTOR TO INCLUDE FOR COORDINATING HIS WORK WITH ALL OTHER TRADES THROUGH FIRE SLEEVES.
 - ALL PIPEWORK PASSING THROUGH FIRE BARRIERS AND WALLS SHALL PASS THROUGH FIRE SLEEVES.
 - CONTRACTOR TO INCLUDE IN HIS TENDER FOR ALL DRAINING DOWN AND REFILLING OF THE SYSTEM IN ORDER TO COMPLETE THE WORKS.
 - CONTRACTOR SHALL ALLOW FOR ALL ADDITIONAL FITTINGS AND BONDS NECESSARY TO AVOID EXISTING PIPEWORK ETC.
 - CONTRACTOR TO INCLUDE FOR ALL EXPOSED PIPEWORK TO BE INSULATED AND SPOCCED IN ALL ROOMS TO BE PAINTED OUT TO MATCH SURROUNDINGS.

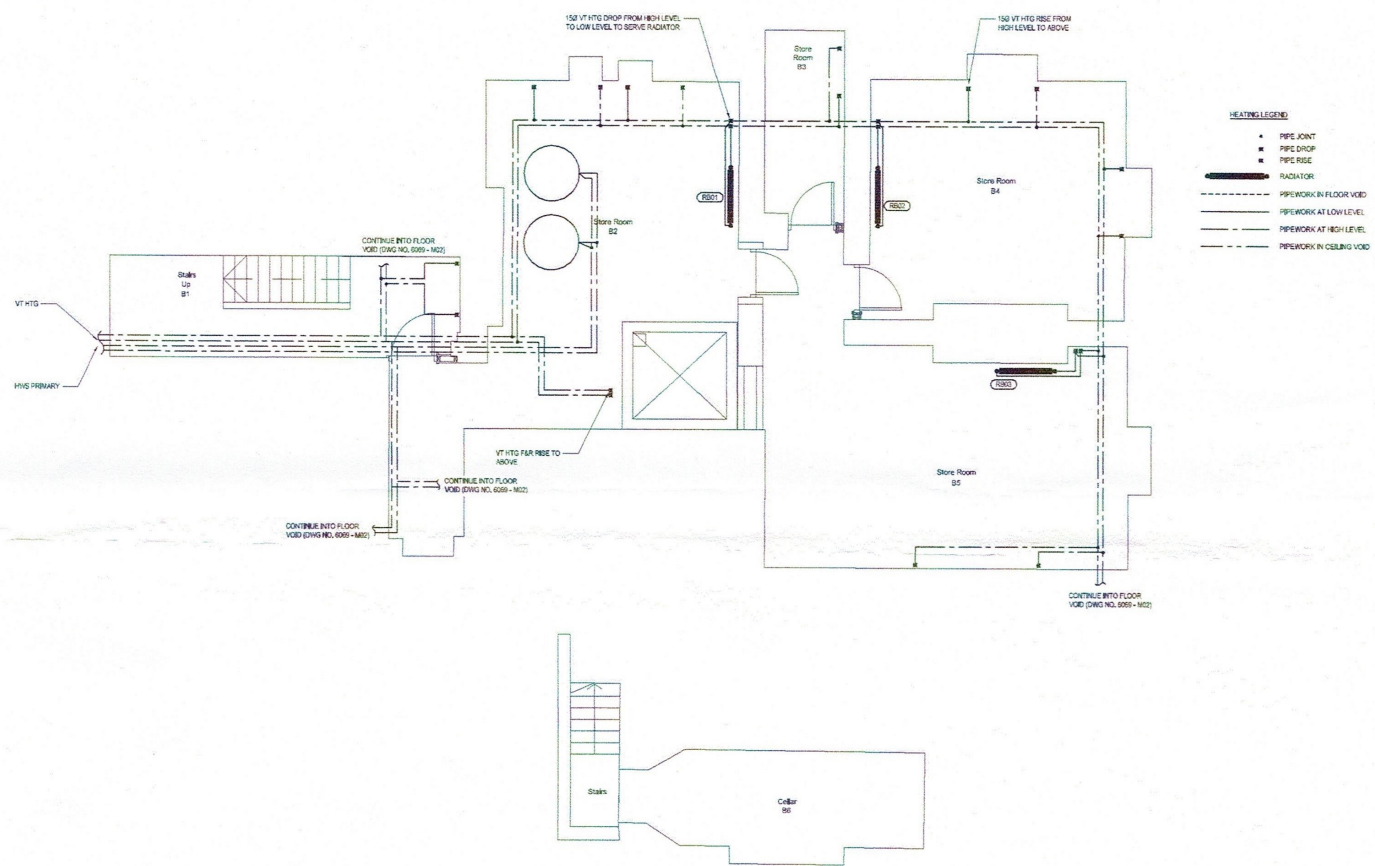

Rev.	Date	Details	Iss.
01	05/07/18	PRELIMINARY ISSUE	01

GENERAL NOTES

This drawing is copyright and may not be altered, reproduced or used other than for the contract work for which it is intended without the written consent of Pettit Singleton.

The purpose of this drawing when issued as a tender drawing is to enable tenderers to interpret accurately the design and to submit competitive tenders for the works.

This drawing shall be read in conjunction with the tender specifications.

Do not scale this drawing. If in doubt, ask before work.

15-11 Navigation Business Village
 Navigation Way, Preston, PR2 2YF
 T: 01772 720752
 E: info@psa.co.uk

15th Floor, 15-11 Navigation Business Village
 Navigation Way, Preston, PR2 2YF
 T: 01772 720752
 E: info@psa.co.uk

PSA
 PETTIT SINGLETON ASSOCIATES

<input checked="" type="checkbox"/> PRELIMINARY <input type="checkbox"/> APPROVAL COMMENT <input type="checkbox"/> TENDER <input type="checkbox"/> CONSTRUCTION	DUNNINGWELL LTD DUNNINGWELL HOUSE Existing and Proposed Basement (no alterations proposed)
JUL 18 1:50 @ A1	