

COPELAND BOROUGH COUNCIL

Catherine Street, Whitehaven, Cumbria CA28 7NY

EDWIN THOMPSON
42 ST JOHNS STREET
KESWICK
CA12 5AF.

Please Contact Julie Ward
My Ref 4/04/2726/0
Date 25 Oct 04

Dear Sir/Madam,

Application No. 4/04/2726/0

NOTICE OF INTENTION TO CONSTRUCT AN IMPLEMENT
SHED
WINDER BROW FARM, WINDER, FRIZINGTON, CUMBRIA.

Notice of Intention

Your Notice of Intention for the above has been received and in accordance with the Town and Country Planning (Agricultural and Forestry in National Parks etc) Special Development Order 1986, I am writing to inform you that there is no objection from a planning point of view as indicated in the document submitted.

I would point out that this agreement refers only to the planning aspect, and it may be that you will require permission under the Building Regulations or from a statutory undertaker, and you should check this before commencing work.

Yours faithfully,

Principal Planning Officer

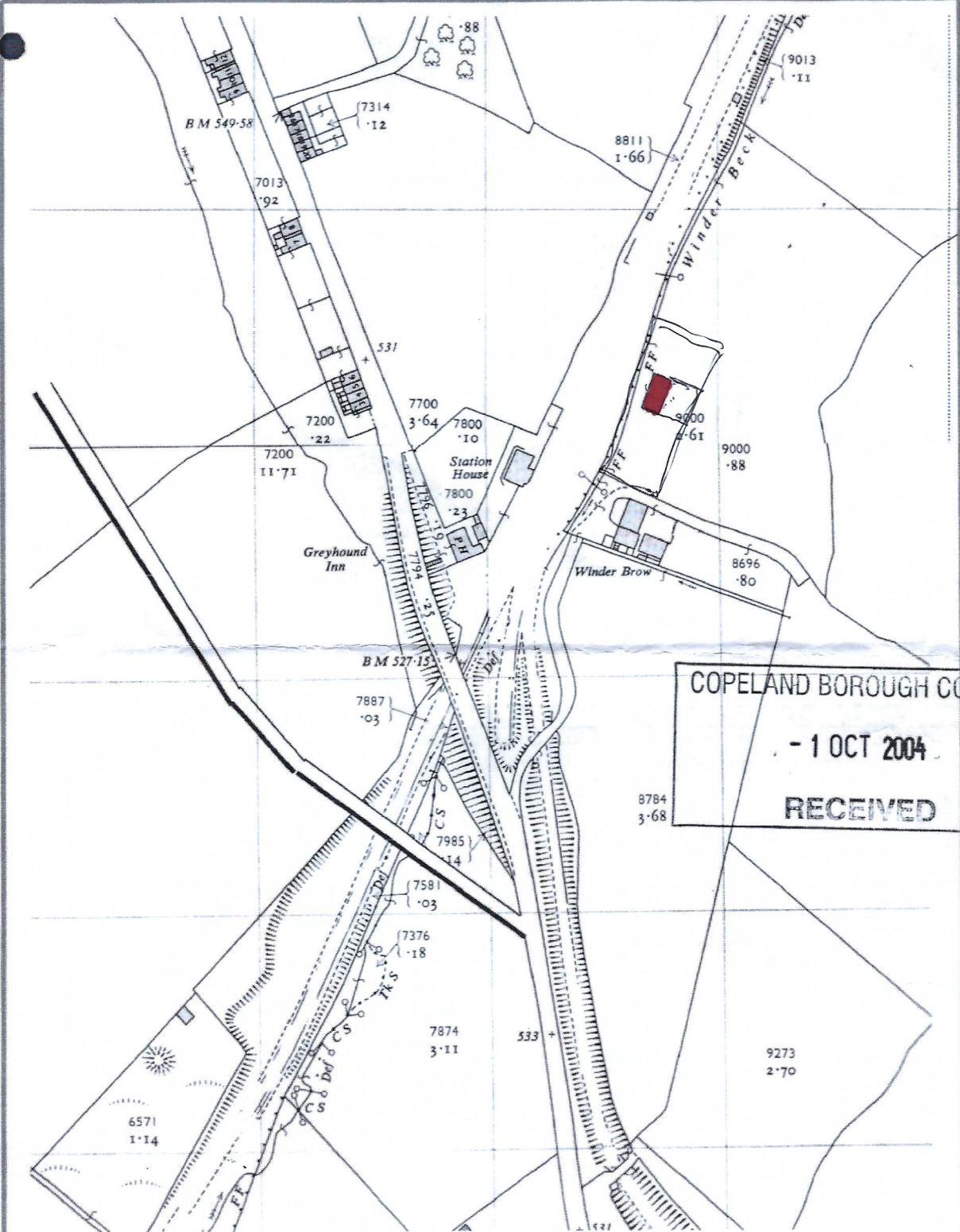

COPELAND BOROUGH COUNCIL
- 1 OCT 2004
RECEIVED

Proposed Implement Shed
at Winder Brow Farm

Scale 1:2500

Green or Brown plastic coated profile sheeting.

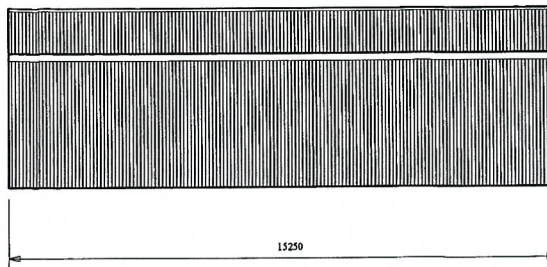
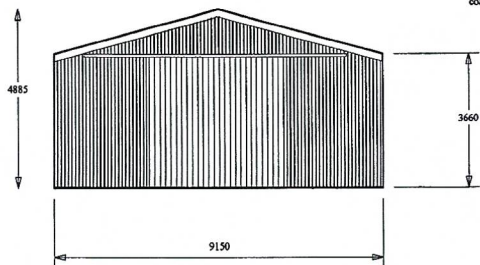

COPELAND BOROUGH COUNCIL
- 1 OCT 2004 -
RECEIVED

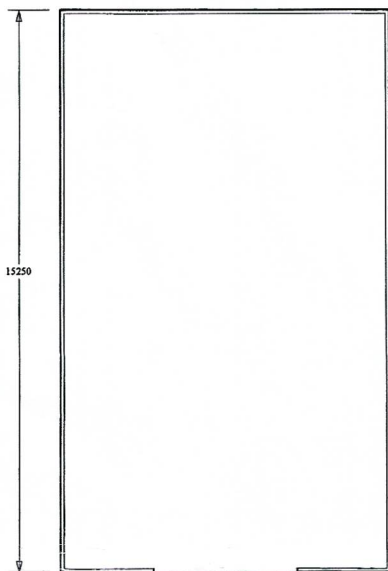

Plan

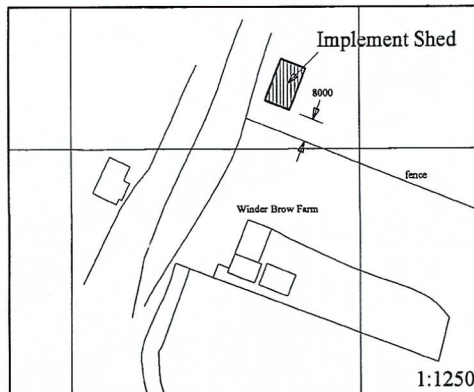

Location Plan

Edwin Thompson

CHARTERED SURVEYORS

Edwin Thompson is the trading name of Edwin Thompson LLP
a Limited Liability Partnership registered in England & Wales No00266412
Registered office 42 St. John's Street, Keswick, Cumbria CA12 5AF

KESWICK

42 St. John's Street, Keswick
Cumbria CA12 5AF
Tel :017687 72988
Fax :017687 74699
E-mail :design@edwin-thompson.co.uk

Project & Client

**New Implement Shed
Winder Brow Farm
Winder**

Frizington

Date: 27/9/04

Scale: 1:100

Drawn by: cjr

Rev. Drawing no.