

VIEW 1 – ACCESS LOCATION (1:500)

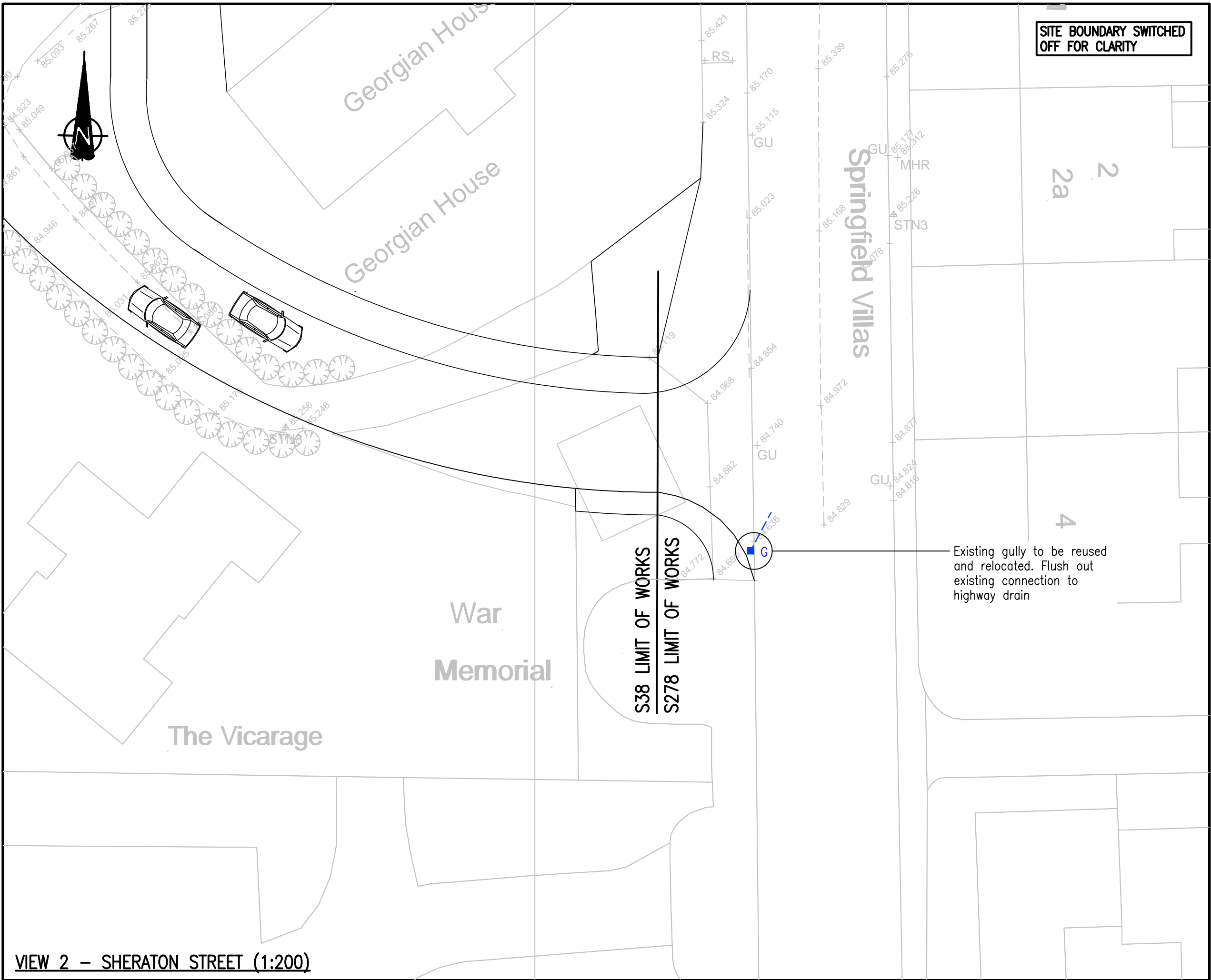

VIEW 2 – SHERATON STREET (1:200)

Do not scale from this drawing.
SAFETY HEALTH AND ENVIRONMENTAL INFORMATION
IN ADDITION TO THE HAZARD/RISKS NORMALLY ASSOCIATED WITH THE TYPES OF WORK DETAILED ON THIS DRAWING, NOTE THE FOLLOWING RISKS AND INFORMATION.
RISKS LISTED HERE ARE NOT EXHAUSTIVE. REFER TO DESIGN ASSESSMENT FORM.
CONSTRUCTION EXISTING LIVE SERVICES. EXISTING SEWERS. WORKING ADJACENT TO A LIVE HIGHWAY.
DEMOLITION
FOR INFORMATION RELATING TO USE, CLEANING AND MAINTENANCE SEE THE HEALTH AND SAFETY FILE.
IT IS ASSUMED THAT ALL WORKS WILL BE CARRIED OUT BY A COMPETENT CONTRACTOR WORKING, WHERE APPROPRIATE, TO AN APPROVED METHOD STATEMENT.

NOTES

- This drawing is based on the following received information:
CDL Architecture Proposed Site Plan – DS/TMS/0/1/21 REV A,
Ordinance Survey Data and Topographical Survey.
- This drawing is to be read in conjunction with the following FAIRHURST drawings:
138443/1031 – S278 Works, General Arrangement,
138443/1032 – S278 Works, Site Clearance,
138443/1033 – S278 Works, Surface Finishes and Kerbs,
138443/1034 – S278 Works, External Works, Construction Details,
138443/1035 – S278 Works, Setting Out and Spot Levels,
138443/1037 – S278 Works, Drainage, Construction Details and Notes,
138443/1038 – S278 Works, Swept Path Analysis,
138443/1039 – S278 Works, Agreement Plan.
- All works to be in accordance with the Specification for Highway Works (SHW).
- All road markings to be in accordance with the Traffic Signs Regulations and General Directions.

KEY

- Site boundary
- Road gully
- Gully drain

Rev.	Date	Description	Drawn	Chkd.	Appd.
<div>FAIRHURST</div> <div>1 Arngrove Court Barrack Road, Newcastle-upon-Tyne NE4 6DB Tel: 0191 221 0505 Fax: 0844 381 4412</div>			Client: THOMAS MILBURN PROPERTY LTD.		
Project Title: HENSINGHAM AND STAINBURN CUMBRIA SEACOTE					
Drawing Title: S278 WORKS DRAINAGE					
Scale at A1: AS SHOWN		Status: For Approval			
Drawn: SNK		Checked: RH		Approved: NB	
Date: 23/06/22		Date: 23/06/22		Date: 23/06/22	
Drawing No.: 138443/1036				Revision: —	