

R2 TH	
CHAINAGE	0+000 2+007 10+000
EXISTING GROUND LEVEL	87.799 87.798 87.801 87.792 87.792
ALIGNMENT LEVEL	87.798 87.801 87.792 87.792
VERTICAL ALIGNMENT	G=-1.250% 1:80.0
HORIZONTAL ALIGNMENT	R=18.000

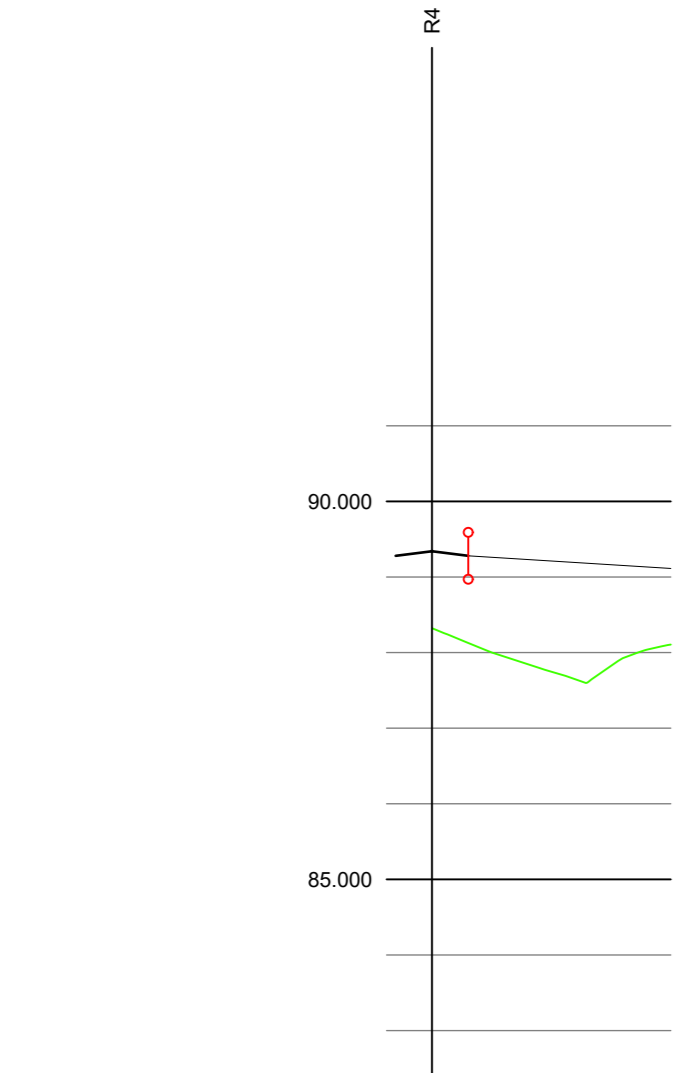

R4 TH	
CHAINAGE	0+000 2+007 7+102 10+000 15+292
EXISTING GROUND LEVEL	88.323 87.812 88.107 88.107
ALIGNMENT LEVEL	88.323 87.812 88.107 88.107
VERTICAL ALIGNMENT	G=-1.250% 1:80.0
HORIZONTAL ALIGNMENT	R=17.000

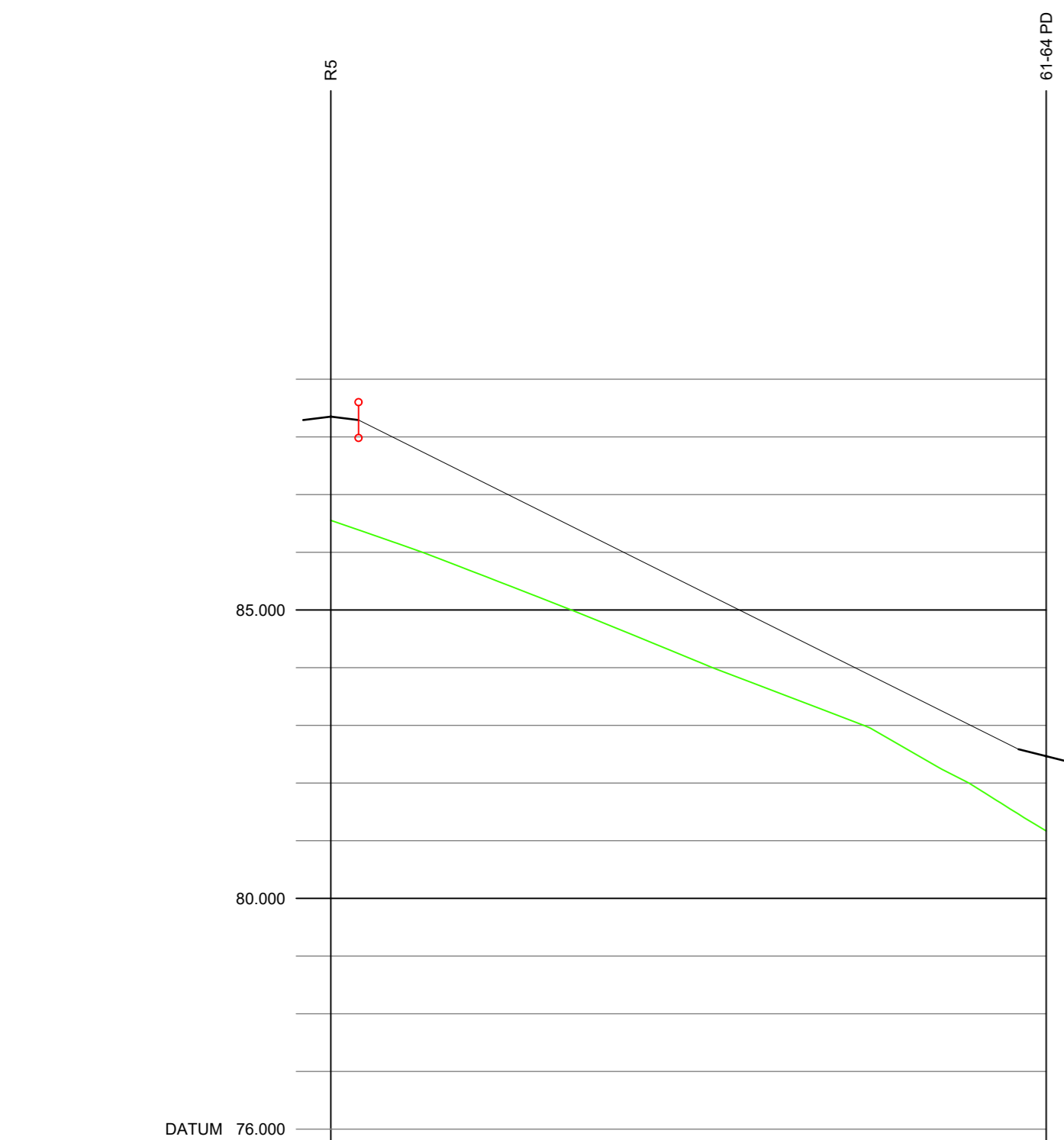

60-65 PD	
CHAINAGE	0+000 2+007 10+000 20+000 30+000 40+000 50+000 6+647
EXISTING GROUND LEVEL	86.553 86.542 86.535 86.535 86.535 86.535 86.535 86.535
ALIGNMENT LEVEL	86.535 86.535 86.535 86.535 86.535 86.535 86.535 86.535
VERTICAL ALIGNMENT	G=-9.979% 1:10.0
HORIZONTAL ALIGNMENT	

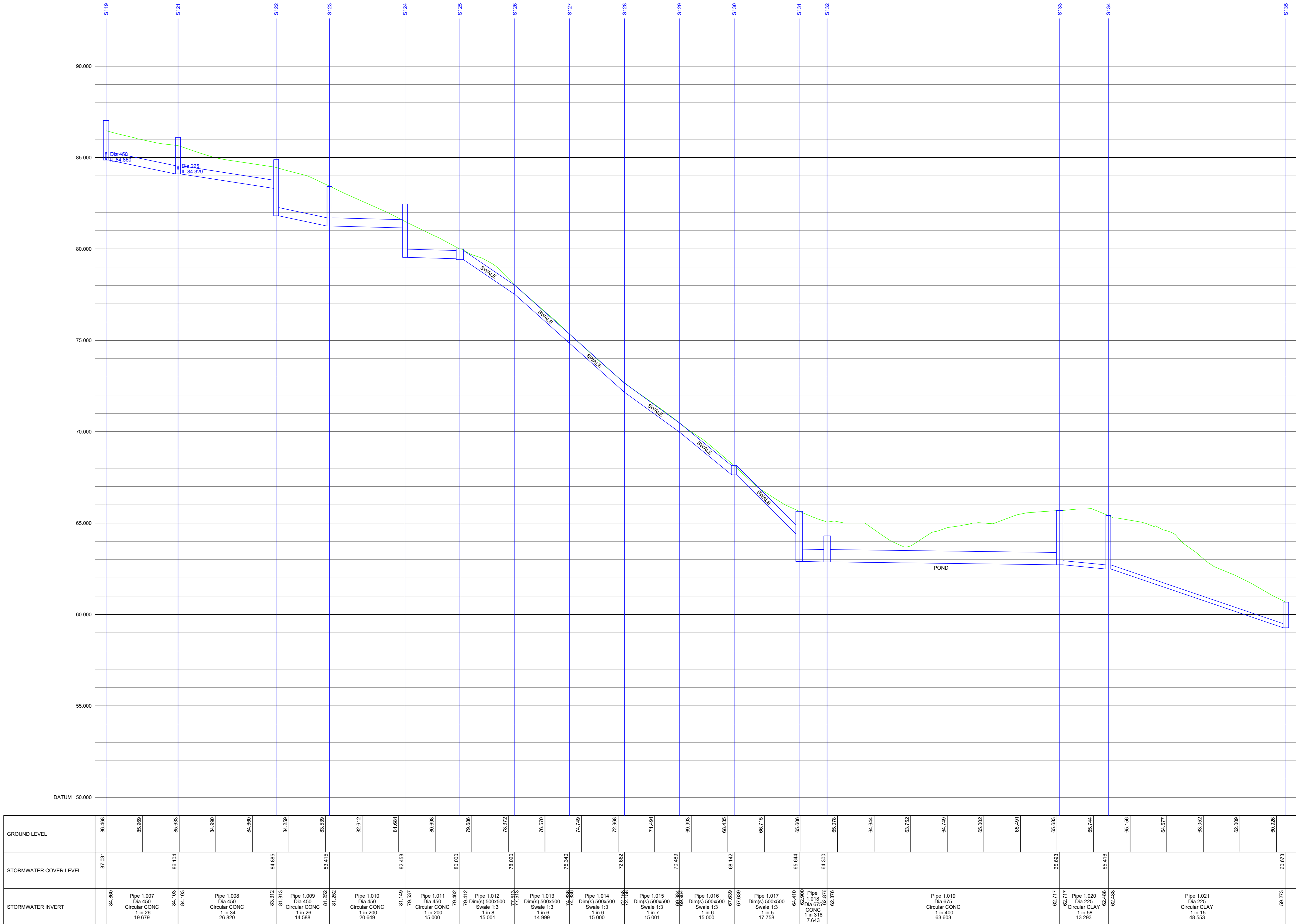

- Notes
- Setting out shall be undertaken using only the information given. Distances should not be scaled from this drawing.
 - All sewers shall be constructed in accordance with Design and Construction Guidance (DCG) Standards and United Utilities Details & Guidelines.
 - The minimum gravity pipe diameter under adoptable highways shall be 150mm.
 - It is the responsibility of the Contractor to verify all information given with regards to existing services and drainage connections etc. prior to commencing the works. The rates shall include for hand dig around services where necessary. The Contractor shall adhere to the CDM Regulations at all times.
 - The outsidess of all sewers shall be a minimum of 1.0m from kerb lines and the outside of manholes shall be a minimum of 0.5m from kerb lines.
 - Existing flows in watercourses, sewers and land drains shall be maintained at all times.
 - Only trained personnel shall be permitted to enter confined spaces.
 - All materials to bear the relevant B.S. Kitemark and comply fully with the specifications. All concrete & concrete products must use Sulphate resistant cement to withstand Class 3 condition (unless the site investigation report proves that sulphate attack from soils and groundwater will not occur).
 - All opening notices etc. as required under Highways Acts etc. are to be obtained prior to commencement of works. All works are to be inspected by L.A., NHBC or the Network Operator as applicable.
 - Where "Ultra Rib" UPVC pipes (or similar approved) are used in adoptable drainage they shall be handled and laid in accordance with the manufacturers instructions and will be subject to post installation deformation testing prior to adoption. A Class S Bed and Surround must be used for "Ultra Rib" pipes.
 - Trench backfill in highways to within 1m of Highway shall, as directed by the Highway Authority be a suitable granular material all in accordance with Design and Construction Guidance (DCG) Standards.
 - Slab levels shall not be varied without reference to the Engineer for guidance.
 - Pipes have not been designed to accommodate construction traffic loading. The contractor is responsible for providing adequate protection to the pipes during construction.
 - All works to be in accordance with Cumbria Council's Specification and Standard Details, and as agreed with Cumbria Council's representative.
 - Manhole pipe connections to be soffit to soffit.

Class 'S' bed and surround to all pipes unless stated otherwise.
Class 'Z' bed and surround to pipes where cover < 1.2m as indicated on longsections.

All connections are soffit to soffit

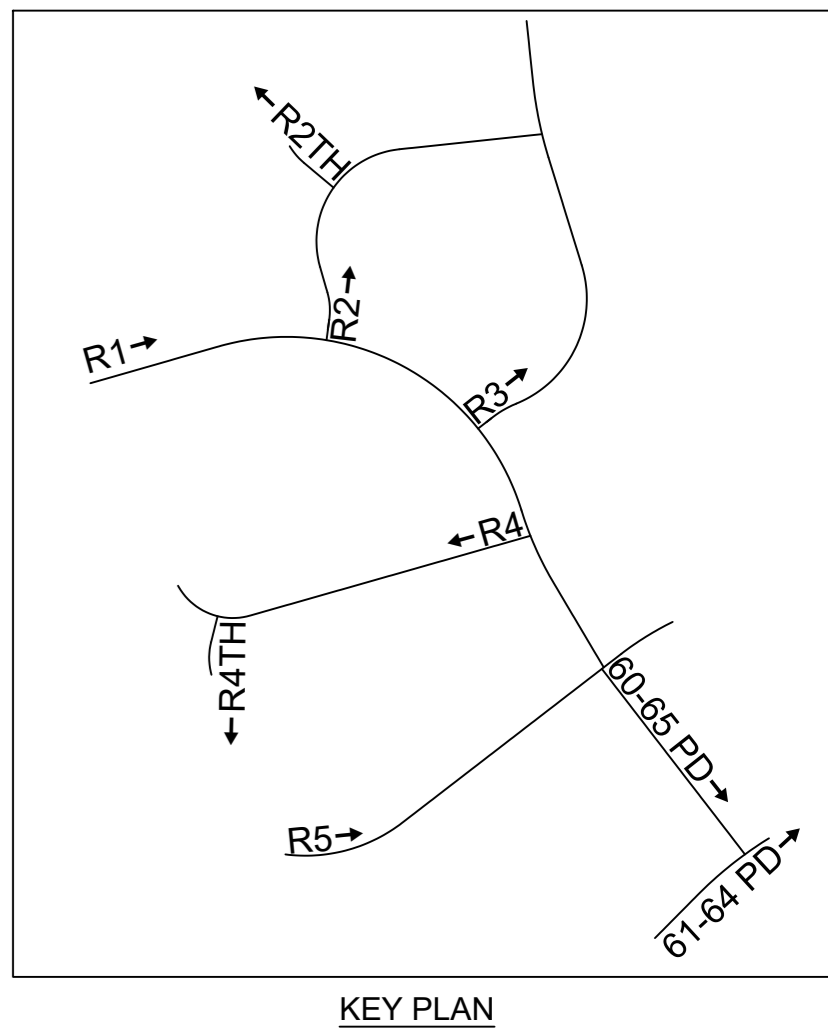

KEY PLAN

STRATEGY

C	08.07.22	Updated to suit revised Planning Layout	PW	AJ
B	16.06.22	Updated to suit revised Planning Layout	JAR	AJ
A	12.05.22	Updated to suit revised Planning Layout	JAR	AJ
Rev.	Date	Revision	By	Appd.



Tel: 01244 684910
Email: admin@coopers.co.uk
Web: http://coopers.co.uk



Project
**EDGEHILL PARK, CUMBRIA
PHASE 4**

Title
**Proposed Highway Longsections
Sheet 2 of 2**

DRAWING NUMBER	7843 / SK03-2	SCALE at A0	1:500H 1:100V
DATE	27.04.22	REVISION	C
DRAWN	PW	CHECKED	AJ