

DO NOT SCALE

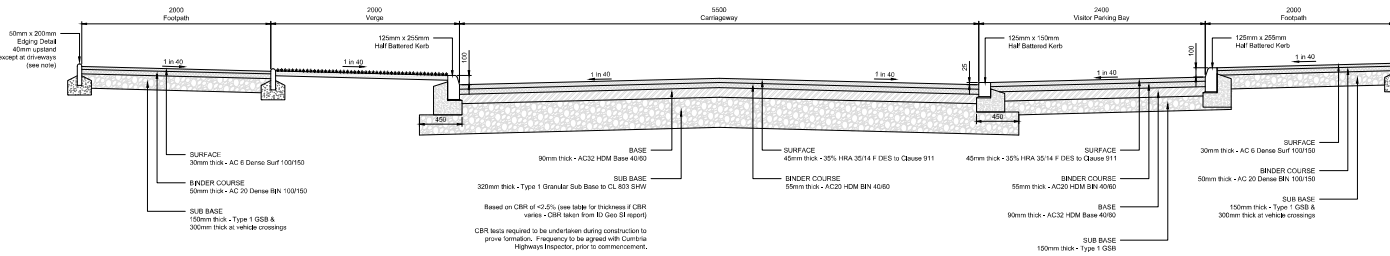

SECTION A-A - PUBLIC CARRIAGEWAY FLEXIBLE CONSTRUCTION  
SCALE 1:20

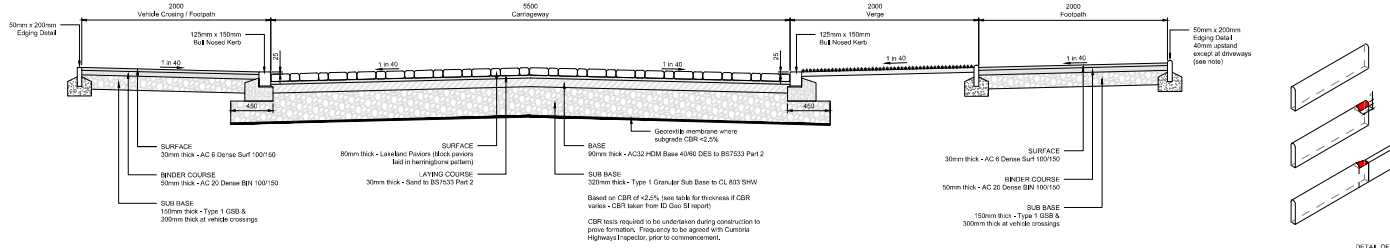

SECTION B-B - PUBLIC CARRIAGEWAY BLOCKWORK CONSTRUCTION  
SCALE 1:20

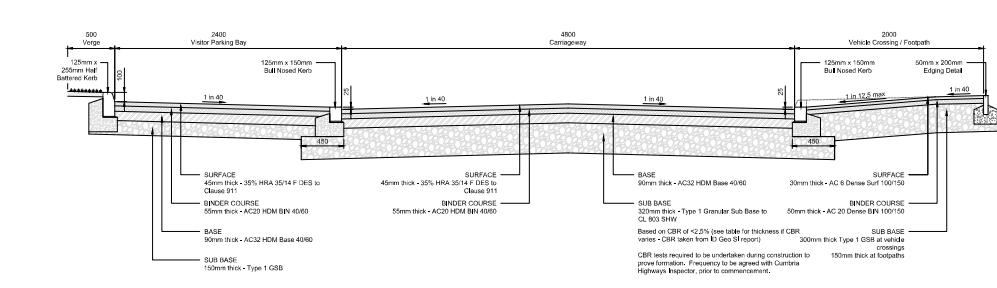

SECTION C-C - PUBLIC CARRIAGEWAY FLEXIBLE CONSTRUCTION  
SCALE 1:20

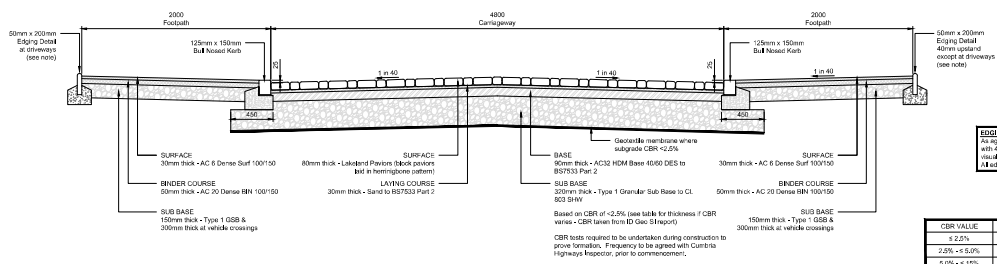

SECTION D-D - PUBLIC CARRIAGEWAY BLOCKWORK CONSTRUCTION  
SCALE 1:20

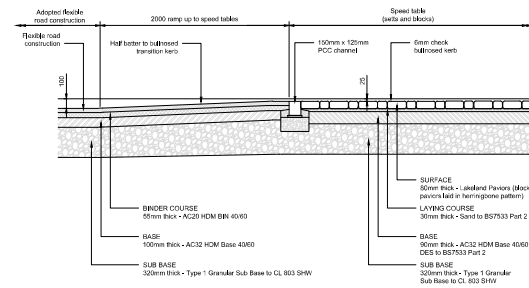

SECTION THROUGH RAMP (HRA TO KEY BLOCK)  
SCALE 1:20

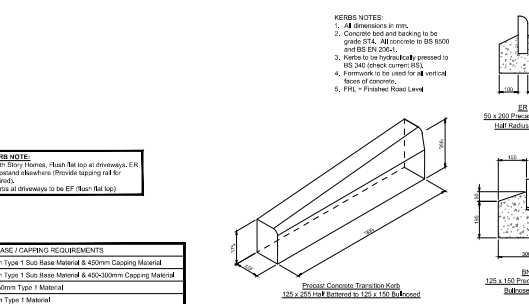

KERBS AND EDGING DETAILS  
SCALE 1:20 (VERTICAL)

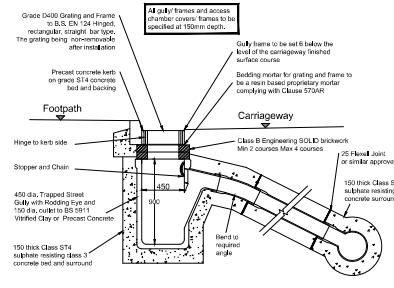

HIGHWAY GULLY  
SCALE 1:20

- GULLY NOTES:
- Kerb face normally 125mm.
  - All dimensions in mm.
  - Gully grate and frame to be set 6mm below adjacent carriageway.
  - Overbreak in excavation for gully to be backfilled with concrete grade ST2 to underside of base course. A minimum of 100mm bituminous surfacing must be provided over concrete bed/surround.
  - All concrete to comply with BS 5500 and BS EN206-1.

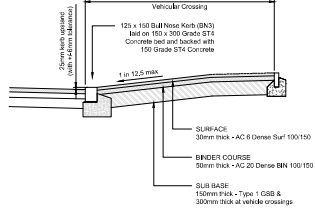

TYPICAL VEHICLE CROSSING DETAIL  
SCALE 1:20

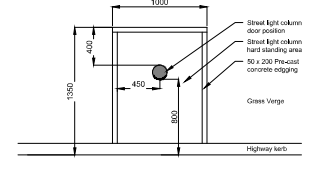

STREET LIGHT HARD STANDING AREAS  
SCALE 1:20

Notes:

- All dimensions are in mm unless otherwise shown.
- All highway works shall be in accordance with Cumbria County Council Specification for Roadwork Road Construction.
- The total thickness of subgrade materials required shall be determined by the tests to the approval of the Engineer. Soil types before formation and construction subgrade materials shall be examined and replaced with suitable fill if necessary to form to BS 1350-1.
- Minimum Materials shall comply with BS EN 12594-1.
- Refer to drawing 7843 for position of cross sections.
- Kerb face for Vehicle Crossing - 20 Kerb face for Pedestrian Crossing - 45 (minimum)
- Tack coat between all layers: GSB & Bituminous surf (3kg/m<sup>2</sup>)
- All highway drainage including manholes, gully, pipe, frame, bedding and curbside to be constructed in accordance with latest BS code of specification and latest CPD details.
- All highway drainage and manholes above the subgrade bedding to be constructed in accordance with latest BS code of specification and latest CPD details.

Design based on Layout:  
Edgehill Park Phase 4, Block Plan,  
Dwg No. GED-STO-005  
Rev: 1  
Grid Level datum based on Topo:  
Edgehill Park, Whitehaven,  
Topographical Survey, Dwg No.  
250720-EH-SH-TOPC-001  
Rev: 1

Specimen Details

Specimen No.	Proposed Drainage Layout
7843/01	Proposed Highway Draining Detail
7843/02	Proposed Highway Draining Detail
7843/03	Proposed Highway Draining Detail
7843/04	Proposed Highway and Drainage Long Section
7843/05	Proposed Concrete Detail
7843/06	Sub Base Material
7843/07	Sub Base Material
7843/08	Proposed Drainage Layout
7843/09	Drainage Construction Detail
7843/10	Sub Base Material
7843/11	Sub Base Material
7843/12	Sub Base Material
7843/13	Sub Base Material
7843/14	Sub Base Material
7843/15	Sub Base Material
7843/16	Proposed Drainage Layout
7843/17	Proposed Drainage Layout
7843/18	Sub Base Material

TENDER

No.	Date	Sheet Lighting Hard Standing Area added	Reason	By	Appr.
A	26/07/23				

coopers

14 C124 66810  
14 C124 66810  
14 C124 66810

Story HOMES

EDGEHILL PARK, CUMBRIA,  
PHASE 4

Highway Construction Details  
Sheet 1 of 2

DRAWING NUMBER	SCALE	NO	1:20 A1
7843 / 05-1	DATE	24/04/23	REVISION
	DRAWN	RJN	
	CHECKED	AT	A