

FOOTWAY AND KERBING DETAIL

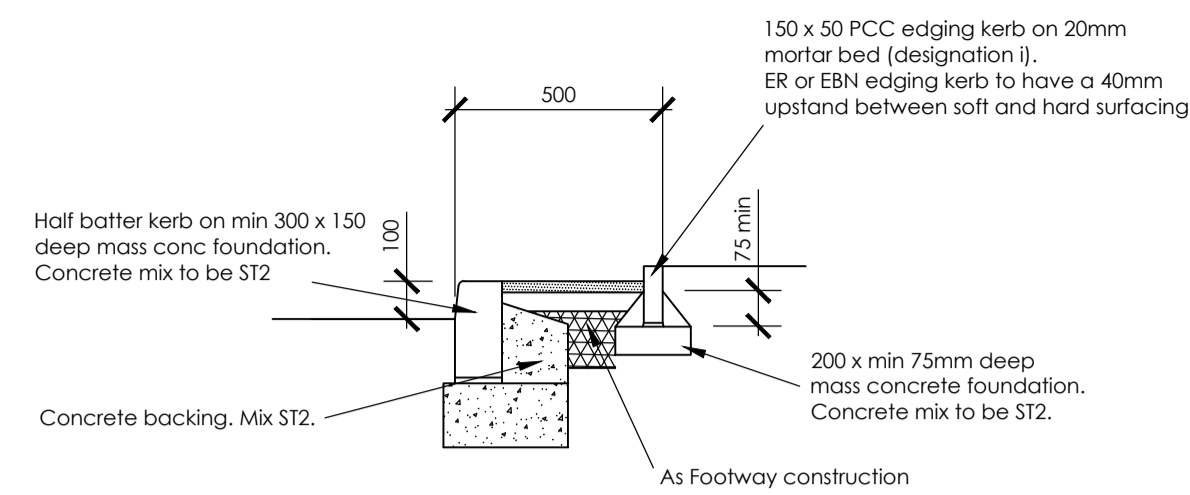

TARMACED HARD MARGIN DETAIL

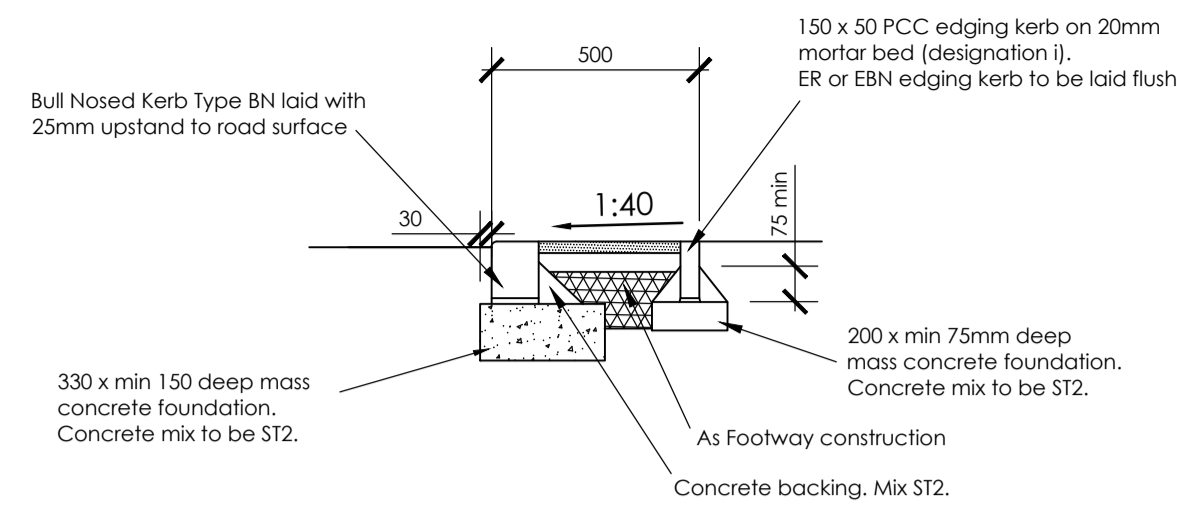

TARMACED HARD MARGIN DETAIL AT DRIVEWAY ACCESS

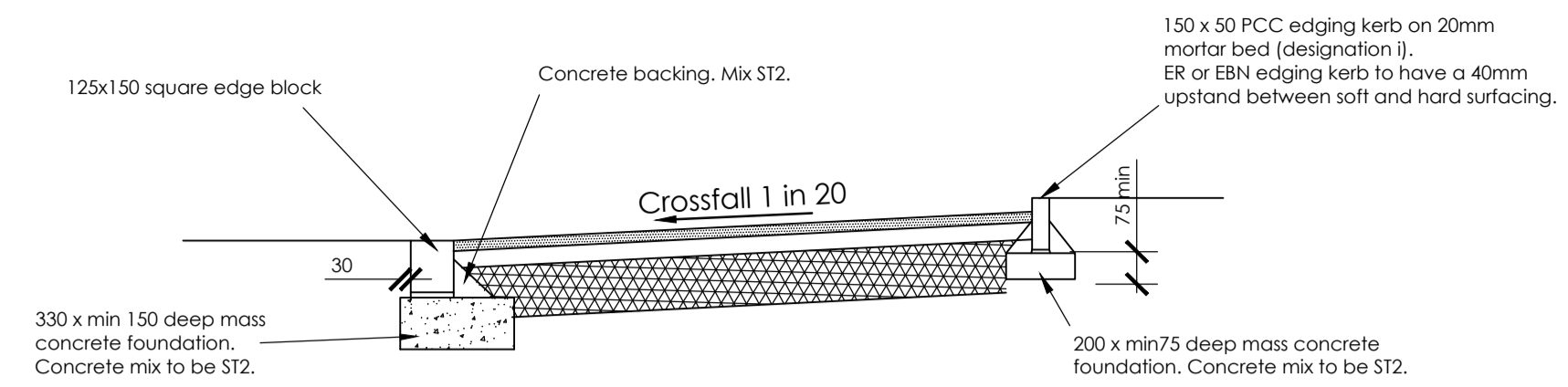

DROP KERB DETAIL AT PEDESTRIAN CROSSING

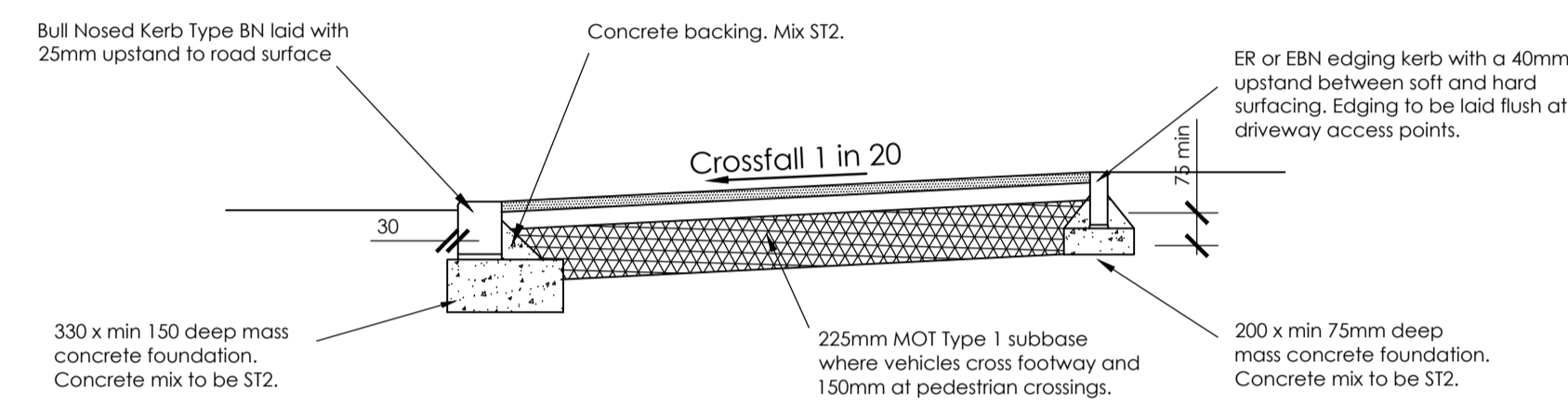

DROP KERB DETAIL AT DRIVEWAY ACCESS

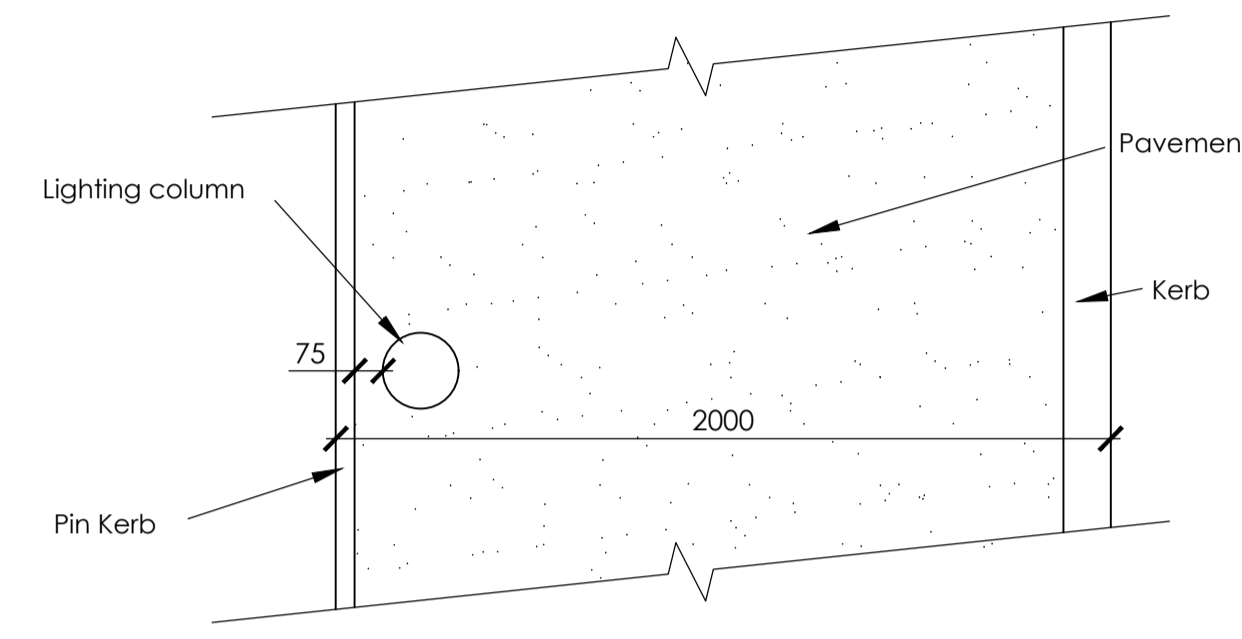

TYPICAL LOCATION DETAIL OF LIGHTING COLUMN IN PAVEMENT

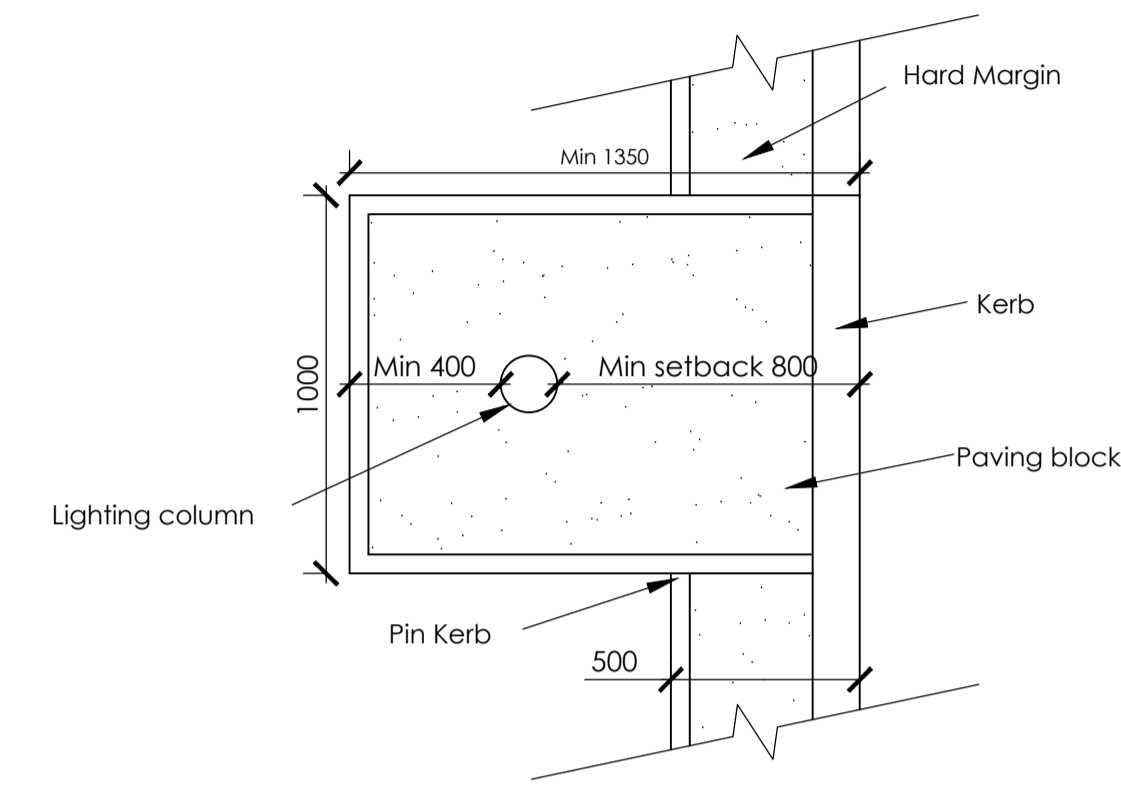

TYPICAL LOCATION DETAIL OF LIGHTING COLUMN IN HARD MARGIN

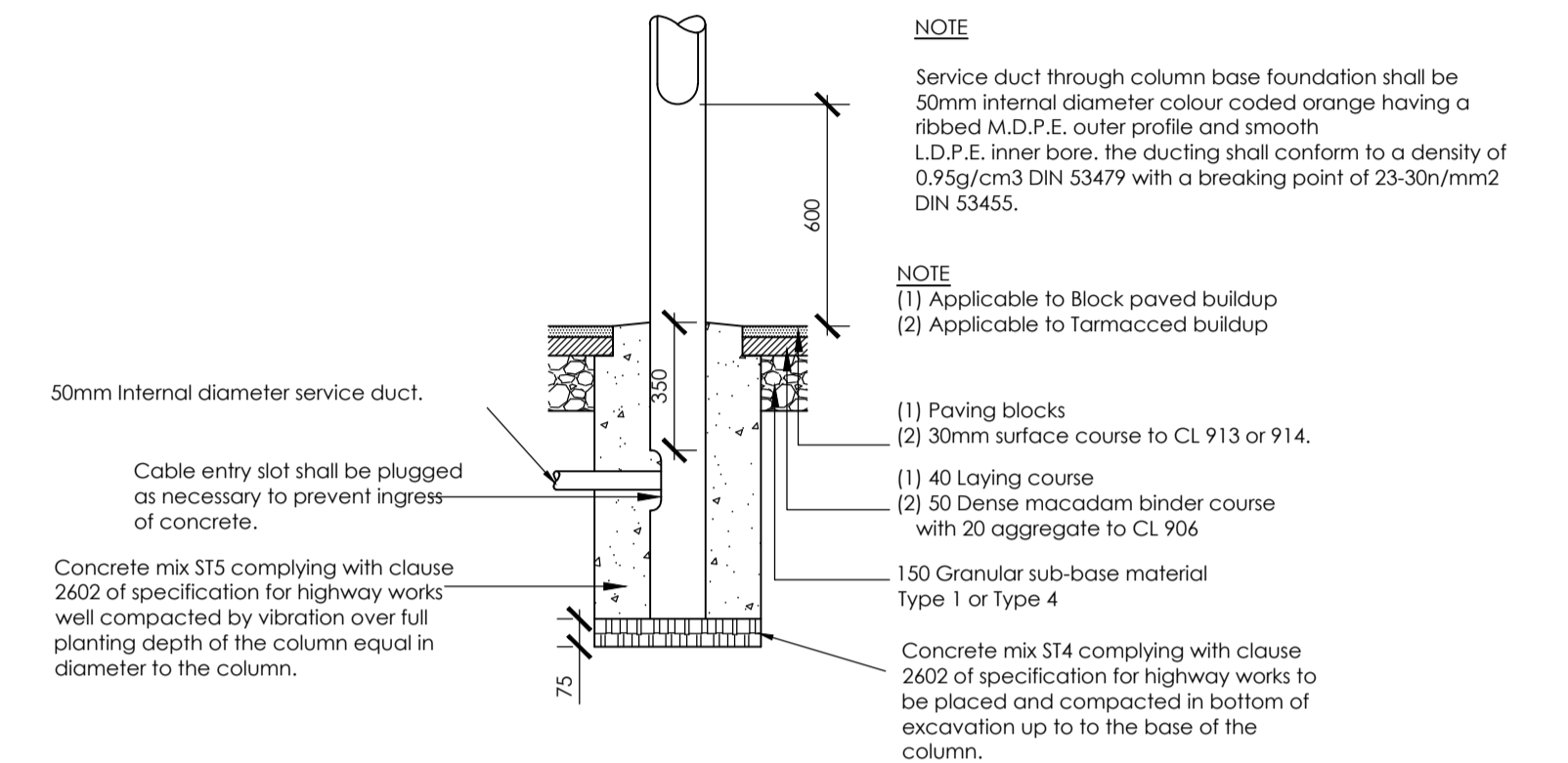

TYPICAL LIGHTING COLUMN FOUNDATION DETAIL

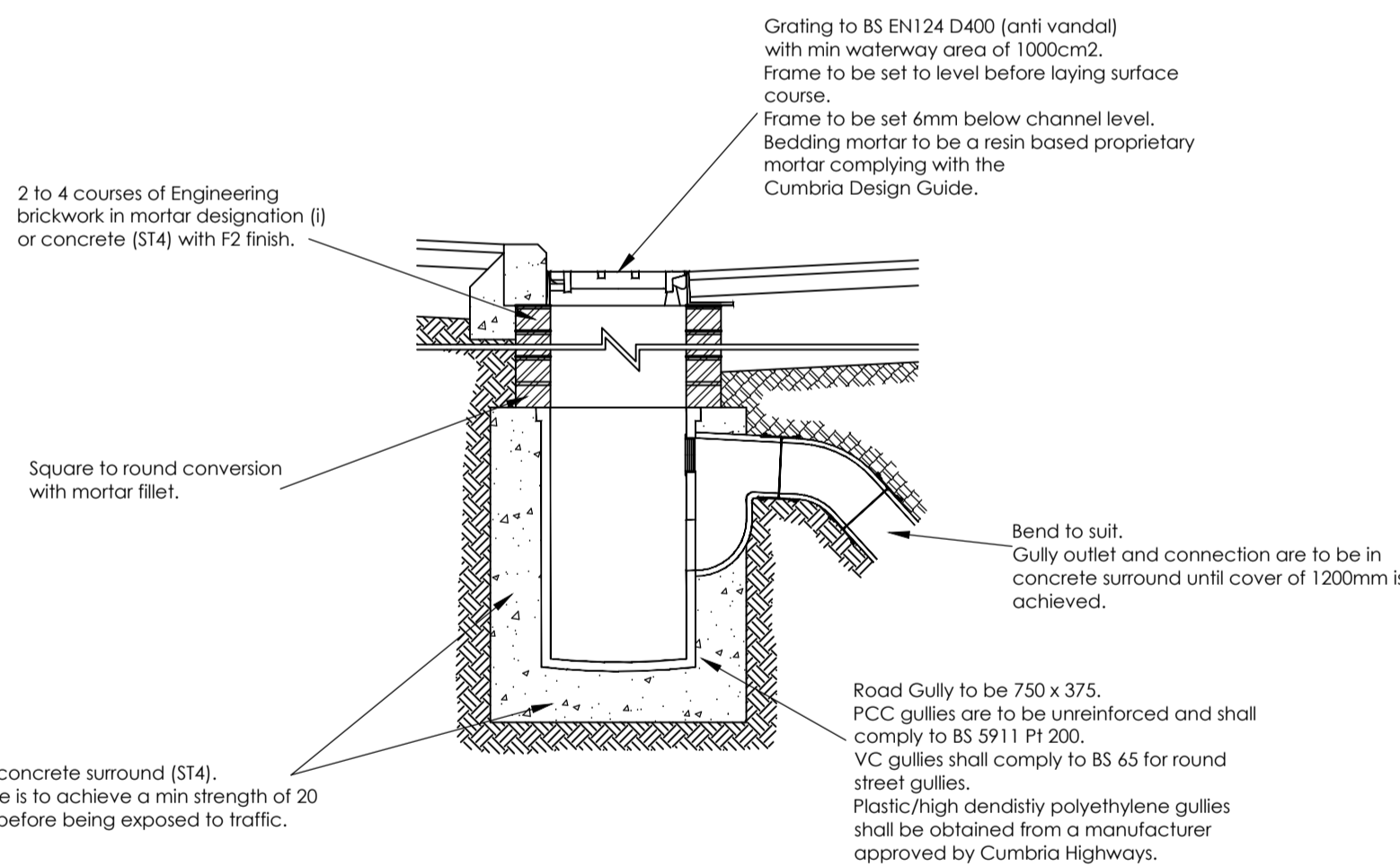

ROAD GULLY DETAIL

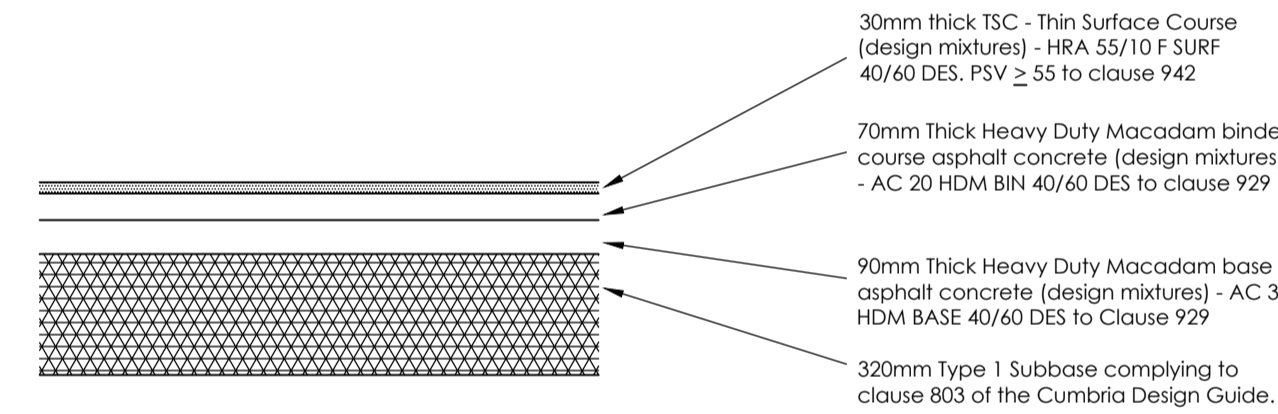

ADOPTABLE TARMAC ROAD CONSTRUCTION

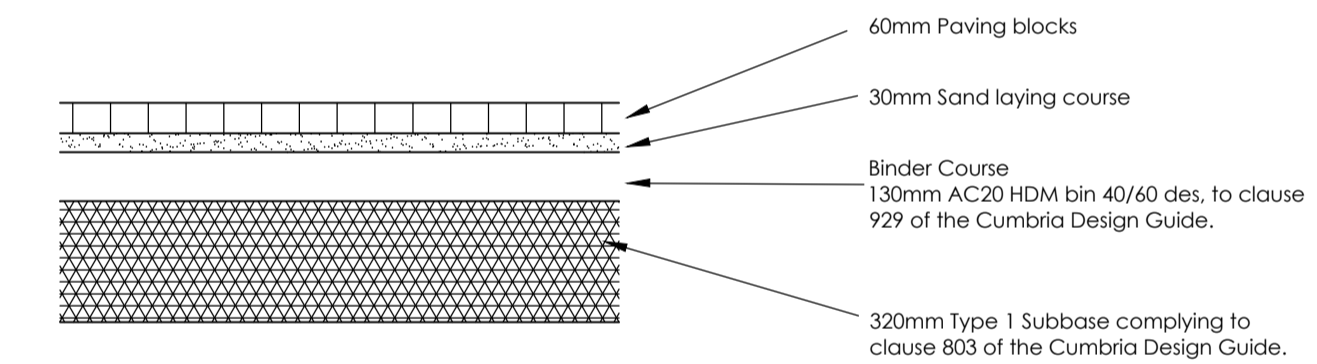

BLOCK PAVED VISITOR PARKING CONSTRUCTION

NB: Road buildups are designed on a CBR value of 5%. Actual CBR values are to be proven on site and buildups reviewed before construction commences.

Specification for road gully gratings:-

- Material - Ductile iron
- Surface Coatings - Non Coated
- Depth of Insertion - Min 80mm
- Seating - One piece, permanent non rock design. If slot is wider than 16mm and the orientation to the direction of traffic is between 0 and 45 deg or 135 and 180, the maximum length of the slot is to be 150mm.
- Slots - The frame bedding width is to be 75mm solid metal. 150mm min.
- Frame Bearing - If vertical webs or gusset plates are provided, the top of such plates are to be a min of 15mm below the top of the frame for triangular plates or 25mm for rectangular plates.
- Frame depth - 150mm min.
- Frame gusset plate - If the weight of the frame is greater than 15kg, suitable hooks or hooking points are to be provided. These are to be located to give a balanced lift.
- Frame lifting holes -

PRELIMINARY

Project
Residential Development at School Brow
Moresby Park

Client

Drawing
PROPOSED ROAD DETAILS

Drawing no	Rev	Date	Drawn by	Scale	Sheet
6972-103		JUN 21	AKP	1:20	A1

TWEDDELL & SLATER
CONSULTING
CIVIL & STRUCTURAL
ENGINEERS

Unit 2, Mereside
Eden Business Park
Penrith, Cumbria, CA11 9FB

Tel 01768 865400
Fax 01768 865002
Email mail@tsce-uk.com
Web www.tsceid.com