

**VISIBILITY SPLAY REQUIREMENTS**  
 As the speed limit is set at 30mph the SSD is based on M5 data.  
 The visibility splay requirements are as set out in the Cumbria Design Guide, except below:

Speed Limit of Major Road (mph)	SSD (m)
20	27
30	60
<b>Point at which it is recommended to change between using M5 and DMRB derived data</b>	
40	120
50	160
60	215
(mph) Speed Limit of Major Road	(m) SSD

**Figure V4: SSD values to be applied using the road's posted speed limit**

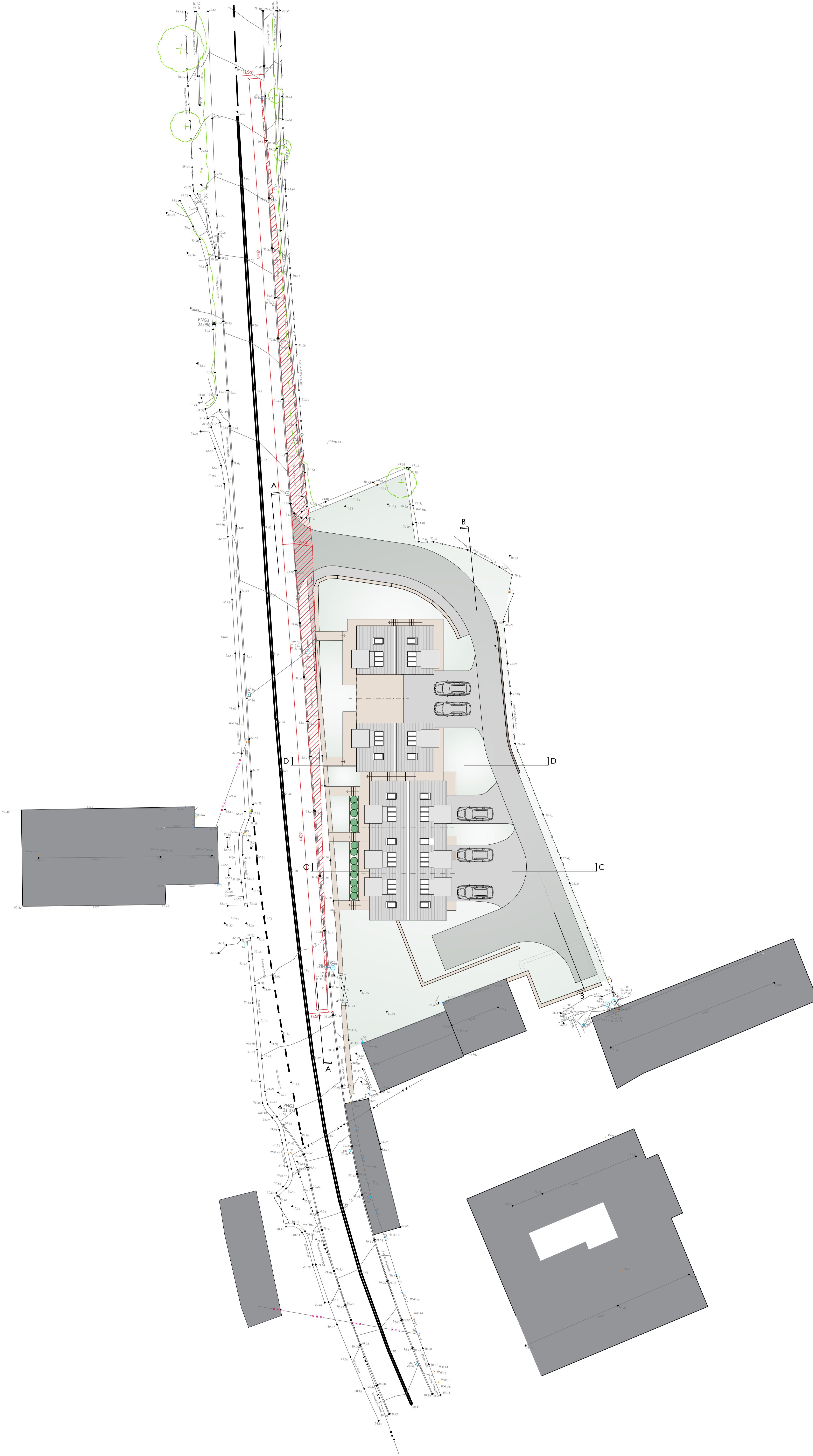

A: Apr 26 Drawing file updated to 'Illustrative'. GC

Revisions - Mar 26 Drawing set up ahead of planning application. JC/GC

Client Moresby Hall Hotel Limited

Project Proposed Residential Development  
 Moresby Hall  
 Moresby  
 Whitehaven  
 CA28 6PJ

Drawing Illustrative Site Plan

As Proposed

Drawing No. 2511 - 06 Rev. A

Scale 1:200 @ A1 Drawn JC/GC Date Mar 26

Do not scale from the drawing. Drawing to be read in conjunction with all other relevant drawing and files from all other consultants. Any discrepancies identified between drawing and site to be reported to HG. As immediately, HG Associates accepts no liability for any omission or inconsistency. All rights reserved this drawing is copyright of Moresby Group Associates Limited trading as HG Associates.