

PROPOSED SECTION AA

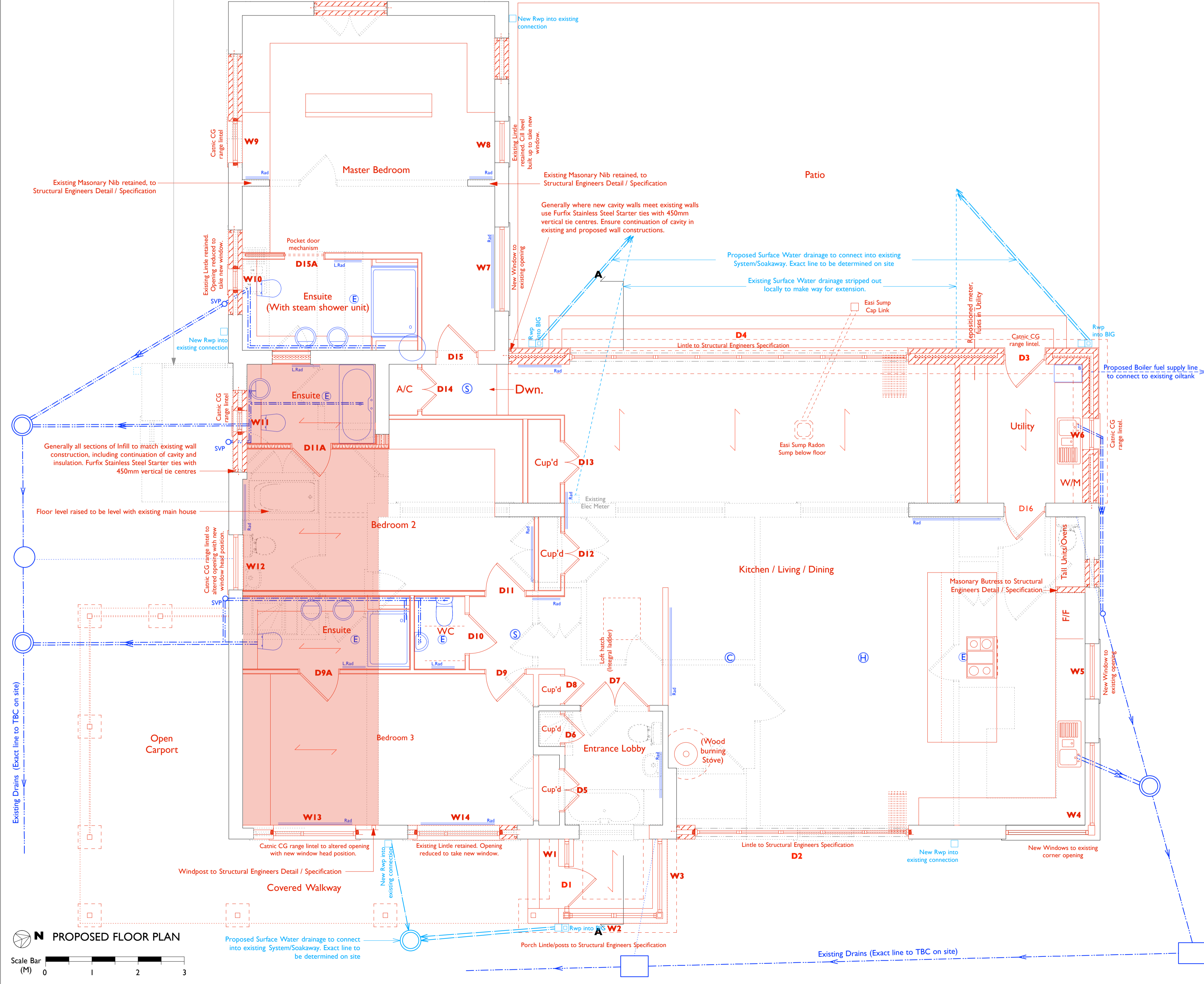

**Drainage**  
Further inspection of the existing drainage system to be undertaken by the contractor in advance of the works commencing on site. The Contractor to include for any necessary works to alter existing drainage affected by the proposed extensions/works. All altered drainage to connect to existing system. Drainage to be in accordance with Part H.  
Care must be taken to prevent damage to any existing drainage uncovered on site. All new drainage to be carried out with OSMA Wavin (Hepworth) pipework including all necessary fittings, couplings etc. All drainage to be 100mm diameter (unless otherwise stated) laid to minimum 1:80 fall and standard polypropylene flexible connectors. All in accordance with manufacturers instructions for specific soil conditions. Laid in clean square trenches, excavated to a minimum 150mm below proposed invert level to receive specific base fill, at a gradient of not less than 1:60 fall. Carefully back fill trenches with layered back fill strictly in accordance with the manufacturers instructions and in accordance with the recommendations of BS 5955: Part 6:1980 Appendix A, having a max. particle size not exceeding 20mm. All drainage installations are to be in accordance with manufacturers instructions for specific soil conditions. On completion of laying and thorough testing of drainage system the installation must be to the complete satisfaction of the Local Authority Building Control Officer. All fittings including manholes, inspection chambers, back inlet gullies etc. to be from the same range and supplier. Set all pre formed gullies and chambers on 150mm concrete bases and surround with 150mm sleeves. Fit gullies with galvanised steel grills. Fit manholes and inspection chambers with steel rims and covers, as supplied by the manufacturer, set in mortar surrounds. Where manholes exceed 900mm deep, form manholes in Class A engineering brick off 150mm solid concrete base and form haunching to pipes and channels with smoothed concrete.  
Set manhole covers onto pre formed r.c covers where manholes internal size is greater than 450mm x 600mm which is the minimum acceptable internal dimension for a 900mm deep manhole.  
Where existing sewer passes under and / or in close proximity to the new extension Refer to United Utilities details D and E. Where new drains pass under the new extension / Patio build up, protect with a min.150mm thick C20P concrete bed and surround in accordance with manufacturers instructions including provision of movement joints consisting of impregnated fibre board divisions at coupling and maximum 4500mm centres. Either take foundations under drains and bridge blockwork over with r.c lintels or reinforce foundations over drains with min 3no. 12mm twisted stainless steel bars.  
The following areas of drainage should be protected (exposed areas of existing drainage should also be included):-  
A. Where drains pass under building.  
B. Where drains have less than 450mm cover of crown of pipe.  
C. Where drains pass bearing area of foundations or within 1000mm of the building which ever is greater.  
D. Where drains pass under walls - for 600mm each side of the wall foundation where A & C are not applicable.  
Provide OSMA Wavin (Hepworth) polypropylene inspection chambers including concrete surround in accordance with manufacturers instructions. Include for grade B2 manhole covers and frames. Appropriate for depths.  
OSMA Wavin (Hepworth) access gullies with integral rodding access gullies set in concrete.

On completion of laying and thorough testing of any drainage system the installation must be to complete satisfaction of the Building Control Officer.

**Plumbing:**  
All above ground drainage is to be BS5572 & BS830 1. Upvc pipe-work is to be BS4541.  
**Trap sizes:-** (All with air admittance valves)  
Wash hand basin 32mm dia.  
Bath 40mm dia.  
Shower 40mm dia.  
Sinks 40mm dia.  
WC 100mm dia. with 75mm  
**All** with anti-siphonic deep seal traps.  
Connection into the soil vent stack will be via an anti siphon collar boss. Marley durgo air inlet valve at the head of internal stack lines, fitted in strict accordance with the manufacturers details and instructions regarding height in relation to overflows, air intake through boxing etc. Where SVPs and wastes are in vertical ducts internally the ducts to be filled with mineral fibre sound insulation.  
Pipe Rodding access to be provided at the base of all internal stacks.

**Rainwater Goods:**  
Gutters and Downpipes - Supply and fix powdercoated aluminium grey square gutters and downpipes with brackets to suit roof/fascia details. Sized to suit rainwater runoff and fitted in accordance with the manufacturers details and installation instructions.  
Gullies - Where any new gullies are needed the contractor is to allow for the installation of a suitable new back inlet trapped gully, selected from the Hepworth range. All to be installed in strict accordance with manufacturer's instructions. New gullies to be linked via new pipework, into the surface water drainage system. Surface water drains to follow the hierarchy set out in Approved Document H3 and link to soakaway system first.

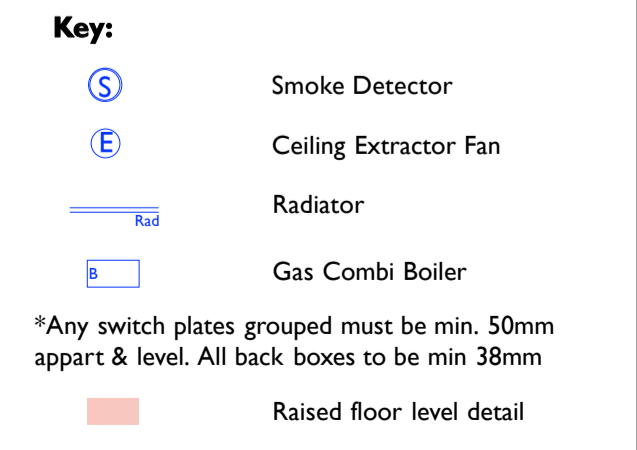
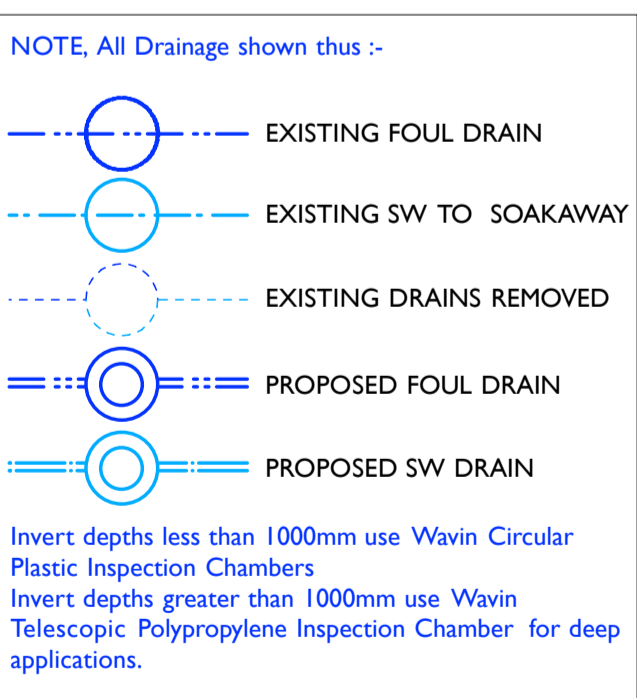

NOTE:  
All dimensions to be checked on site.  
All dimensions in millimetres unless stated otherwise.  
Measured survey to rear mainly carried out, front to be surveyed fully if required.

Rev: Date: Comments: By:

Client: Mr & Mrs Kitching

**DAY CUMMINS**

**DAY CUMMINS LIMITED**  
Architects & Surveyors  
Lakeland Business Park  
Cockermouth Cumbria CA13 0QT  
Tel: 01900 820700  
Fax: 01900 820701  
email: dc@day-cummins.co.uk  
[www.day-cummins.co.uk](http://www.day-cummins.co.uk)

Project:	Works to Middle Fell Croft Cottage, Lamplugh		
Drawing Title:	Proposed Plan and Section (Building Regulations I)		
Drawn:	LCSC	Checked:	-
Scale:	1:50	Date:	29.01.20
		Paper Size:	A1
ALL DIMENSIONS TO BE CHECKED ON SITE FIGURED DIMENSIONS TO BE TAKEN IN PREFERENCE TO SCALED DIMENSIONS THIS DRAWING IS COPYRIGHT			
Project No:	5383	Drawing No:	03
		Rev:	-