

A3 A B C D E F

THIRD ANGLE PROJECTION  
DIMENSIONS IN MILLIMETRES

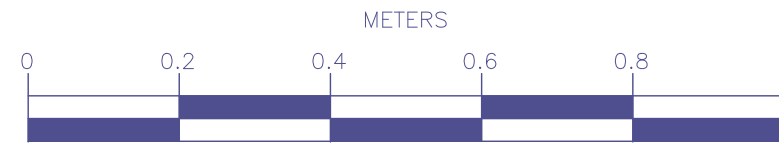

SCALE 1:10

DRAWING APPROVAL STATUS		
STATUS A	BY	
THIS DRAWING HAS BEEN CHECKED AND CONFORMS TO DESIGN INTENT		
STATUS B	BY	
APPROVAL NOT REQUIRED		
STATUS C	BY	
UNCHECKED, NOT TO BE USED FOR MANUFACTURE		

CLIENT  
FURNESS BUILDING SOCIETY

DETAIL  
PLANNING DETAILS -  
PROJECTING SIGN

ASSEMBLY / SITE  
N/A

MATERIAL  
SEE DRG

SCALE	DRAWN BY	DATE
1 : 10 @ A3	M.J.S	14/09/2023

DESIGN COPYRIGHT ©

Wood & Wood International Signs Ltd  
Heron Road  
Sowton Estate  
Exeter EX2 7LX  
Tel: 01392 444501  
Fax: 01392 252358

No part of this drawing & the design contained herein may be reproduced without the written consent of Wood & Wood International Signs Ltd

DRAWING NO.	REV
25447	A

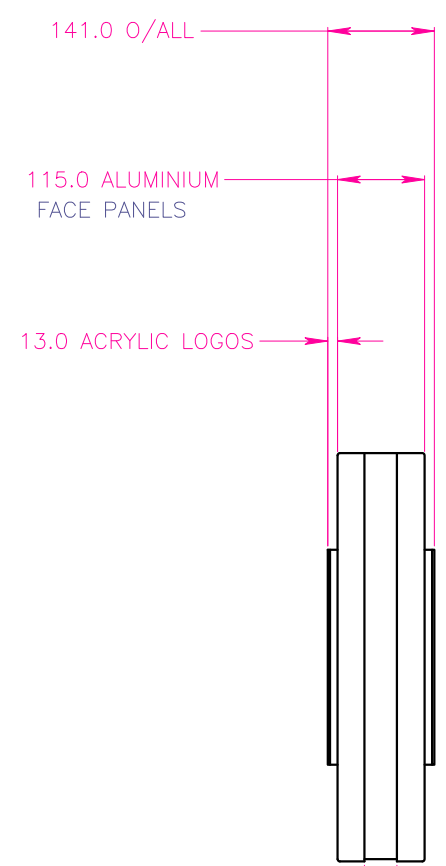
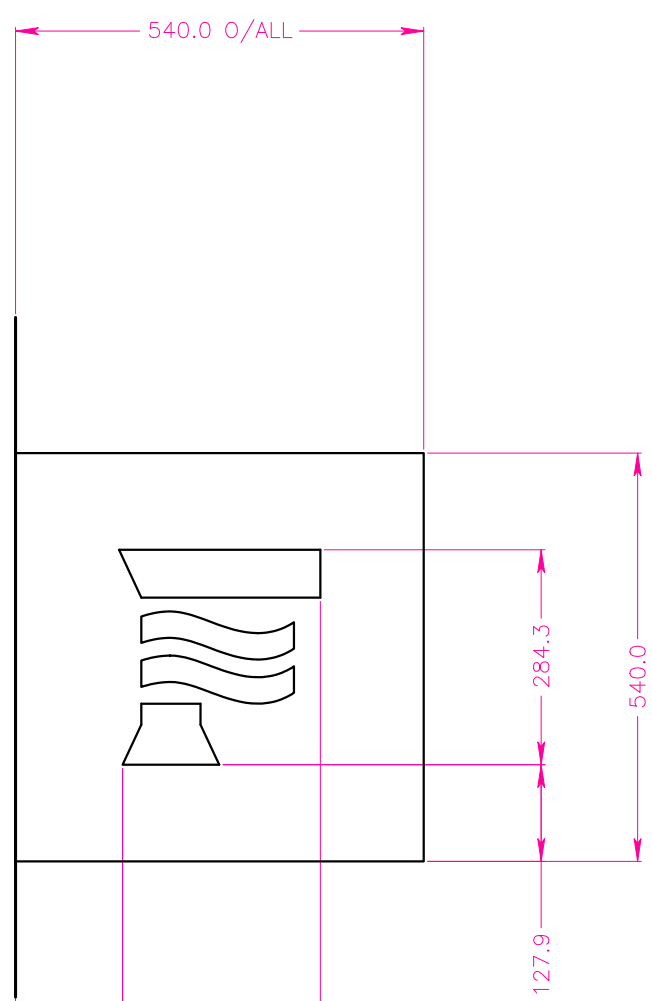
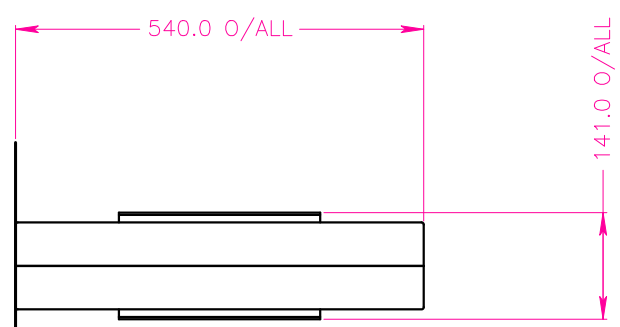

3mm THK BACK TO BACK ALUMINIUM PANELS WITH WOOD EFFECT VINYL APPLIED TO FACE, VINYL REF 3M-WG-695.

FACE PANELS SECURED TO INTERNAL ALUMINIUM FRAME

PUSH THROUGH BUILT UP OPAL ACRYLIC LOGO WITH PINK FACE & HALO ILLUMINATED RETURNS, ILLUMINATION PROVIDED BY INTERNALLY MOUNTED WHITE LED'S

INTERNALLY ILLUMINATED 050 OPAL ACRYLIC STRIP TO FRONT & UNDERSIDE RETURN EDGES.

43.0 ILLUMINATED STRIP TO FRONT AND UNDERSIDE

141.6 261.5

1  
2  
3  
4  
5