

Existing Roof Plan (scale 1:100@A3)

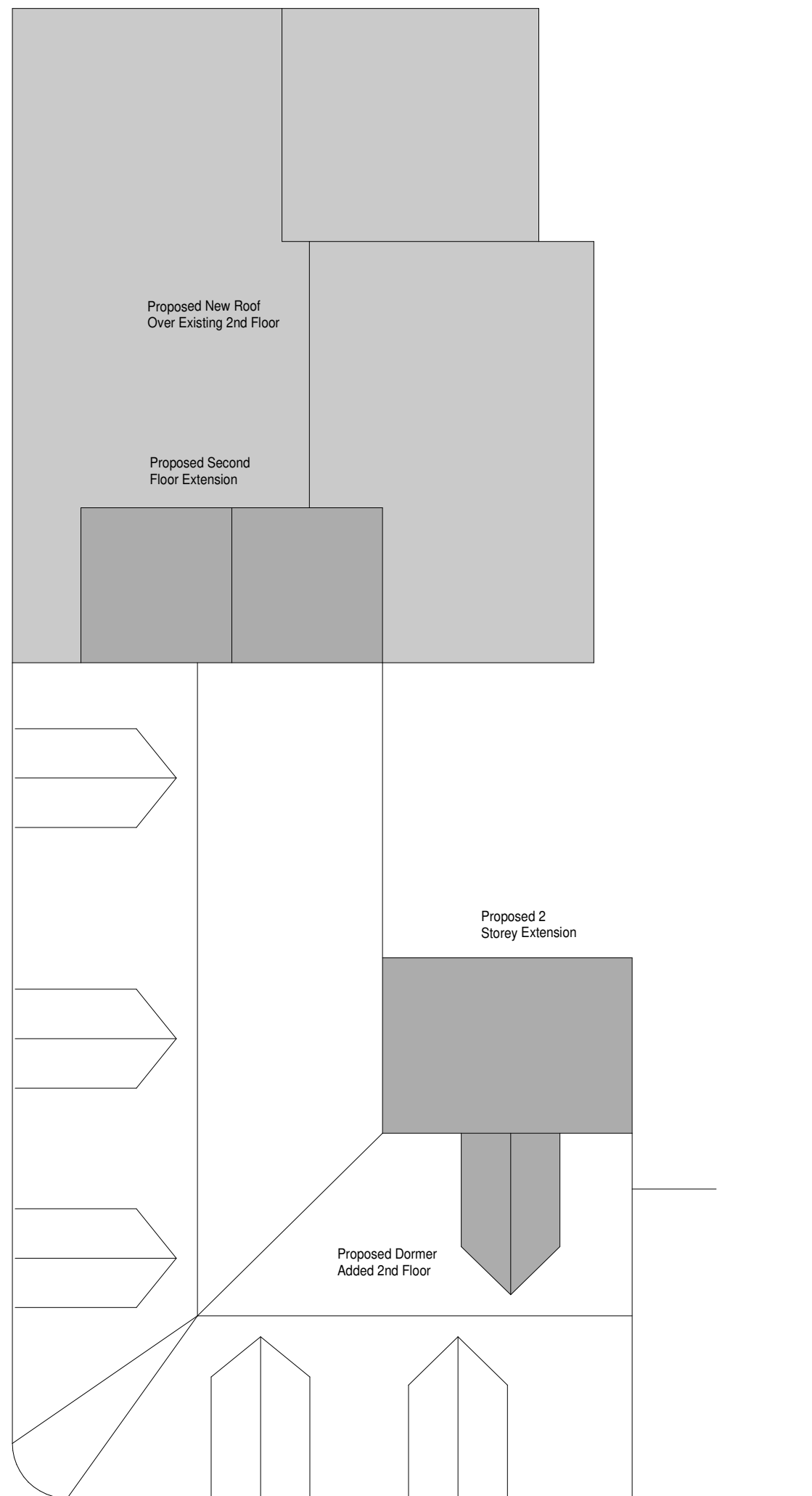

Proposed Roof Plan (scale 1:100@A3)

REV 'A' REVISED TO SUIT LPA COMMENTS 06-02-24

Sean McLean Design

22 Portrack Grange Road, Stockton-on-Tees, TS18 2PH
Tel : 07711127641 E-mail smdesign@tiscali.co.uk

PROPOSED DEVELOPMENTS AT
5-6 HIGH STREET, CLEATOR MOOR
CA25 5BQ FOR HARRY BHAKER

EXISTING AND PROPOSED
ROOF PLANS

Drg. No. 2367/10 'A' Date NOV 23