

HIGHWAY TIE IN DETAILS
SCALE 1:10

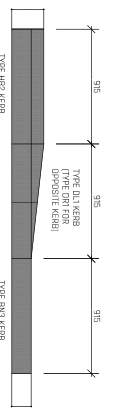

KERB TRANSITION DETAIL
SCALE 1:20

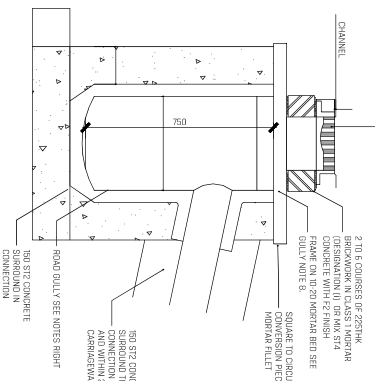

ADAPTABLE GULLY DETAILS
SCALE 1:10

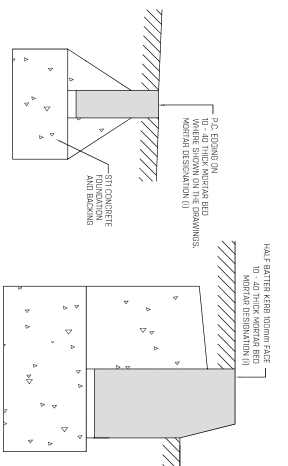

KERB DETAILS
SCALE 1:5

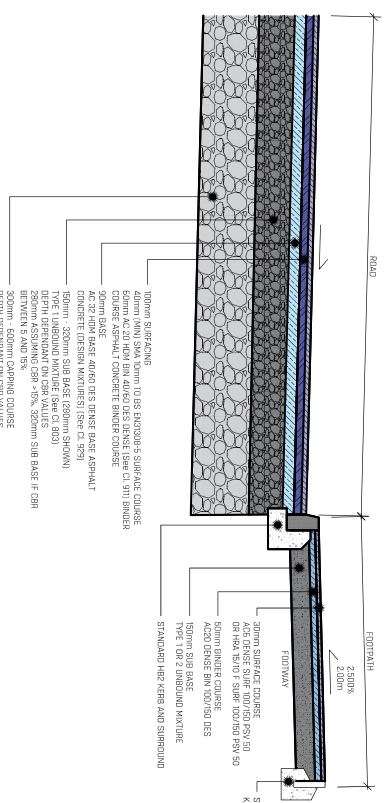
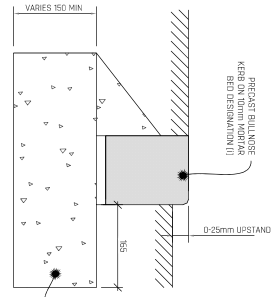

CARRAGEWAY AND FOOT PATH CONSTRUCTION
SCALE 1:20

- GULLY NOTES:**
1. PRECAST CONCRETE GULLIES SHALL BE 600mm DEPTH AND 200mm WIDTH WITH 20mm FINISH CONCRETE WITH F2 FINISH.
 2. VITRIFIED CLAY GULLIES SHALL COMPLY WITH THEIR MANUFACTURER'S SPECIFICATIONS.
 3. PLASTIC AND HIGH DENSITY POLYETHYLENE GULLIES SHALL COMPLY WITH THEIR MANUFACTURER'S SPECIFICATIONS.
 4. GULLIES AND FRAMES SHALL COMPLY WITH THE MANUFACTURER'S SPECIFICATIONS.
 5. WHERE GULLIES ARE USED IN CONNECTION WITH A GULLY, THE GULLY SHALL BE SET TO THE SAME LEVEL AS THE GULLY AND THE GULLY SHALL BE SET TO THE SAME LEVEL AS THE GULLY.
 6. OVER BARRIERS, GULLIES SHALL BE SET TO THE SAME LEVEL AS THE GULLY AND THE GULLY SHALL BE SET TO THE SAME LEVEL AS THE GULLY.
 7. GULLIES SHALL BE SET TO THE SAME LEVEL AS THE GULLY AND THE GULLY SHALL BE SET TO THE SAME LEVEL AS THE GULLY.
 8. FRAMES TO BE SET TO LEVELS BEFORE LAYING OF SURFACE COURSE. GULLY BATTING AND FRAME TO BE SET TO LEVELS BEFORE LAYING OF SURFACE COURSE. GULLY BATTING AND FRAME TO BE SET TO LEVELS BEFORE LAYING OF SURFACE COURSE.

- GENERAL NOTES:**
1. ALL DIMENSIONS IN MILLIMETERS UNLESS NOTED AND NOT TO BE SCALED FROM DRAWINGS.
 2. ALL DIMENSIONS TO BE TO FACE UNLESS NOTED OTHERWISE.
 3. ALL MATERIALS AND WORKMANSHIP TO BE IN ACCORDANCE WITH RELEVANT CODES INCLUDING BRITISH STANDARDS AND BUILDING REGULATIONS.

<p>PROPOSED WAREHOUSE, JOE MCBAIN AVE MORSEBY PARKS, WHITEHAVEN, CA28 8EA</p>	
<p>HIGHWAY WORKS SHEET 3</p>	
<p>AS NOTED</p>	<p>EG9 BUILDING CONTROL</p>
<p>A1</p>	<p>C. AMERS</p>
<p>BUILD</p>	<p>AUGUST 2023</p>
<p>23-164-DWG062</p>	<p>AUGUST 2023</p>