

Area Key

- WC's to be refurbished (18m² / 194 sq. ft)
- Office areas to be refurbished (215m² / 2314 sq. ft)
- Proposed Infill Extension (canteen, lockers, temperature controlled room, warehouse toilets and office) (182m² / 1959sq. ft)
- Area to be returned to warehouse space (95m² / 1020 sq. ft)

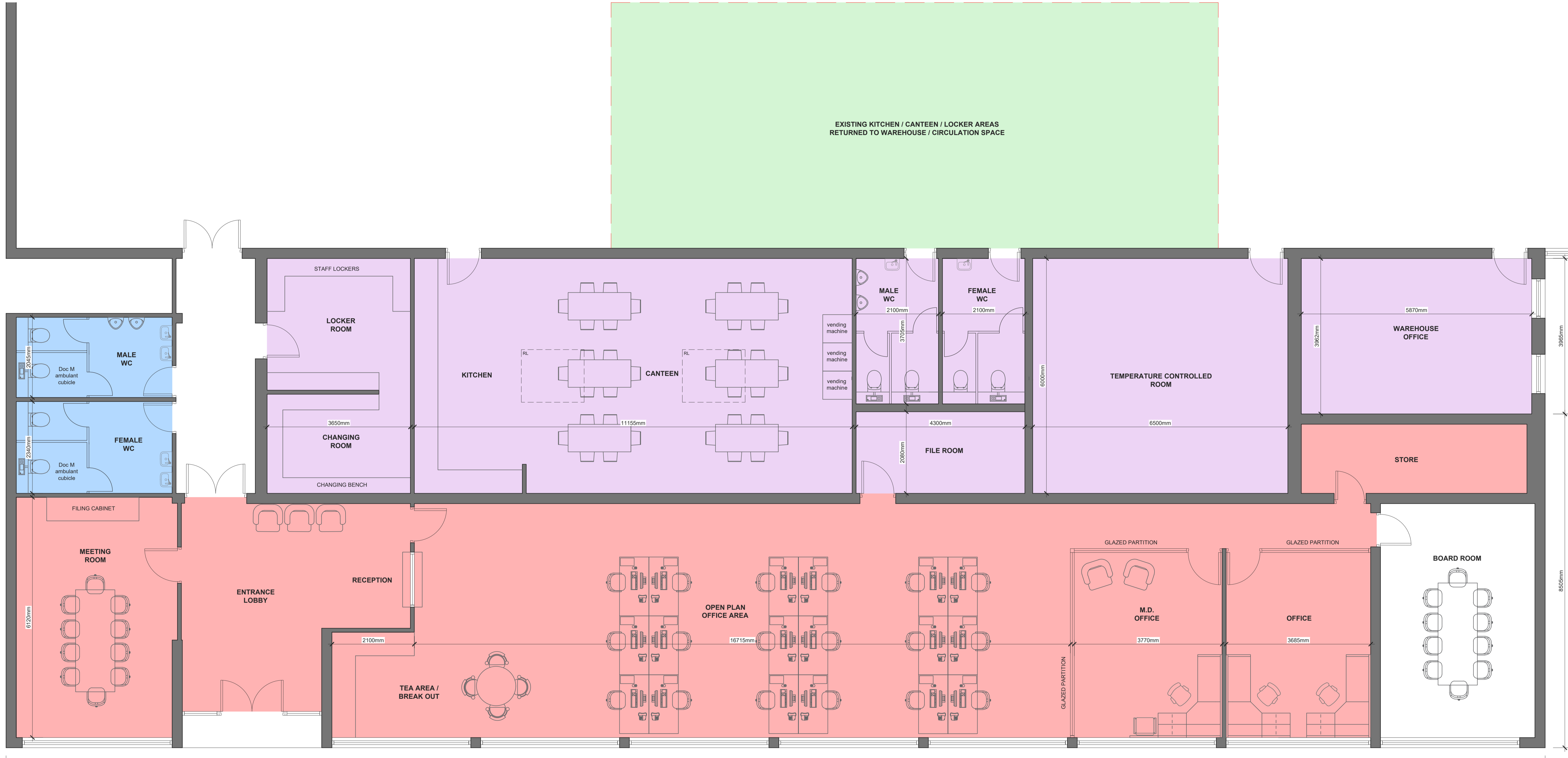

PROPOSED PART GROUND FLOOR PLAN
Scale 1:50