

516000

515950

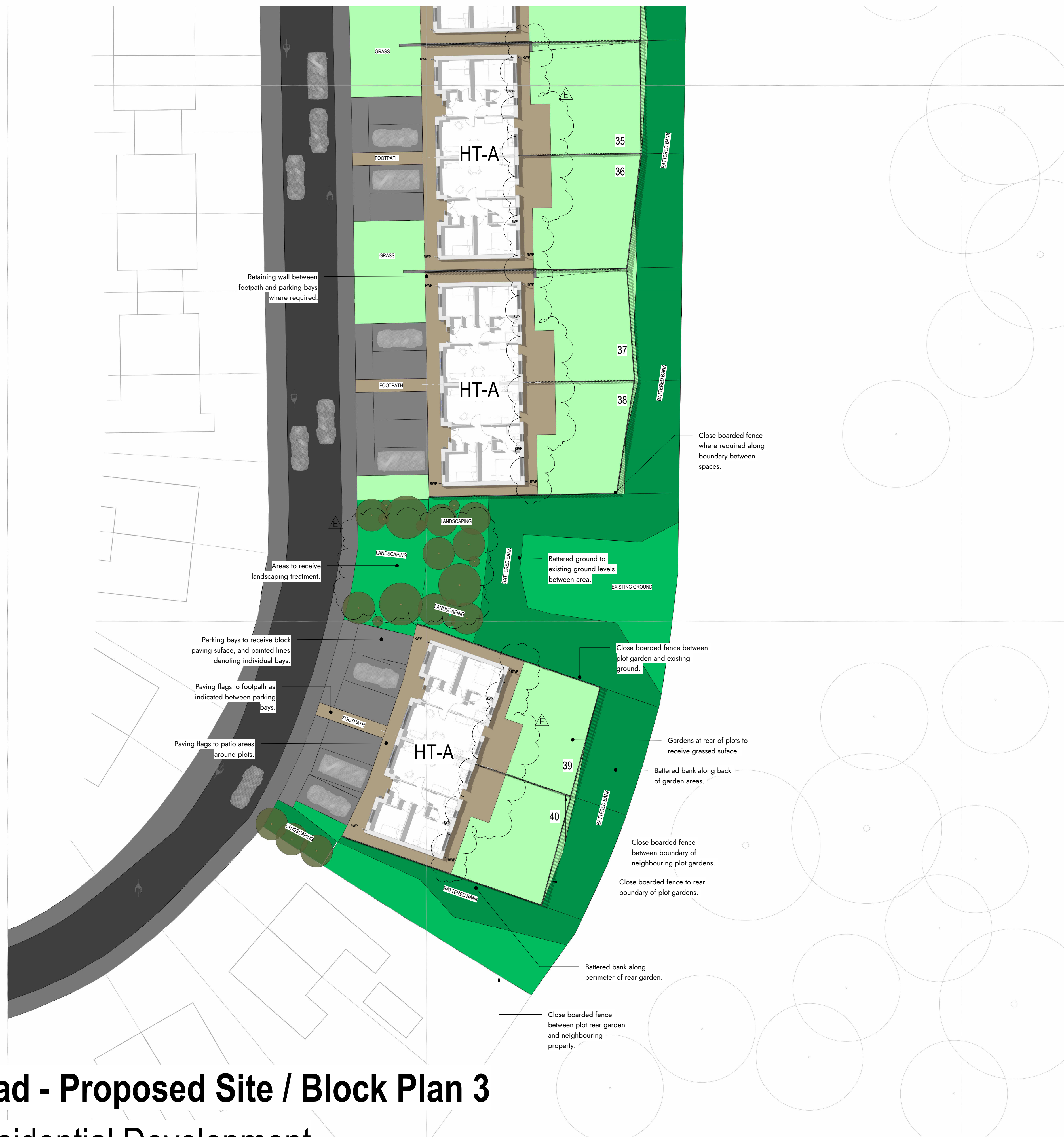

This drawing is to be read in conjunction with all related drawings. All dimensions must be checked and verified on site before commencing any work or producing shop drawings. The originator should be notified immediately of any discrepancy. This drawing is copyright and remains the property of Architects Plus.

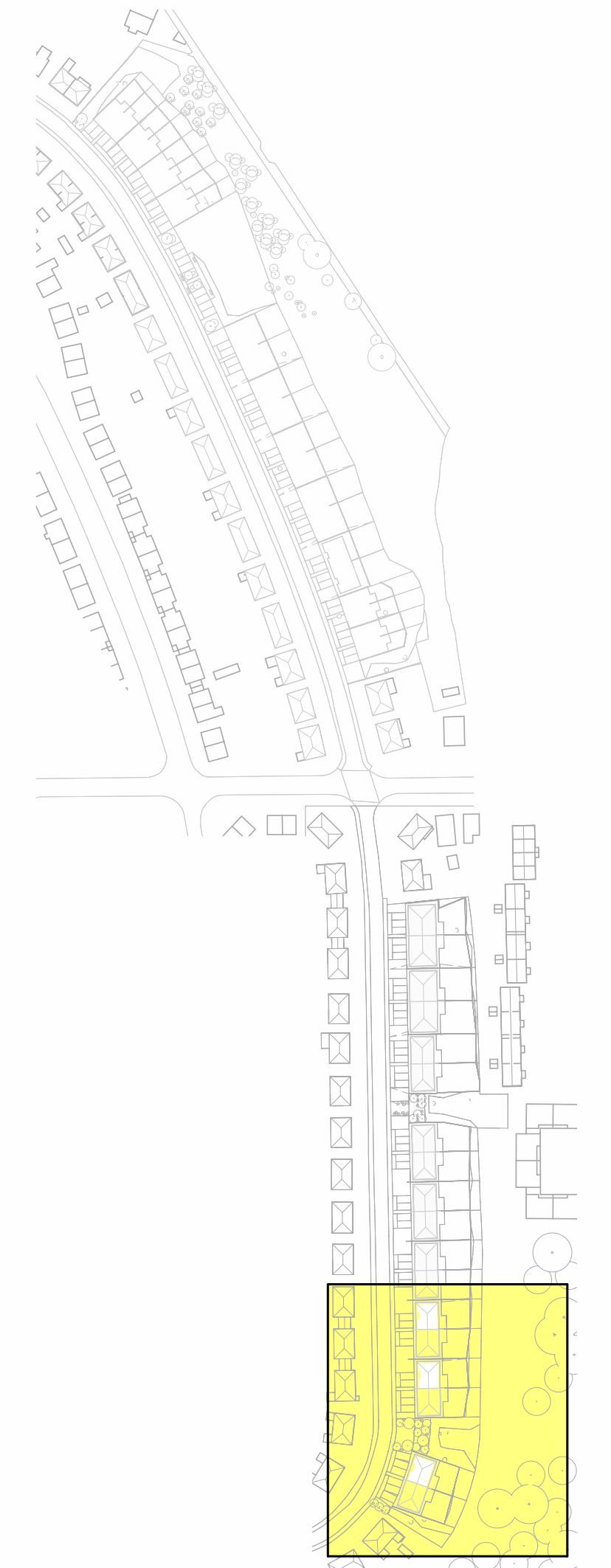

### Reference

revision	description	date	drawn	approved
E	Amendments following recent discussions including extent of surface materials amended.	27/09/2023	AB	BG
D	Amendments following recent levels assessment.	26/06/2023	AB	BD
C	Amendments following comments from Structural Engineer.	06/02/2023	AB	BG
B	Amendments following value engineering discussions.	24/11/2022	AB	BG
A	Value engineering amendments including reduced and omitted hardstanding / footpaths, and omissions of external steps.	20/09/2022	AB	BG

RIBA stage	Status
5 - Construction	PL - Planning

# ARCHITECTS PLUS

Project  
Woodhouse - Residential Development

Client name  
Thomas Armstrong

Drawing  
Windermere Road - Proposed Site / Block Plan 3

Drawn by  
AB

Date  
23/06/2022

Plot date / time  
27/09/2023 16:41:50

Scale: @ A1  
As indicated

22016-PL-016E

E

# Windermere Road - Proposed Site / Block Plan 3

## Woodhouse - Residential Development

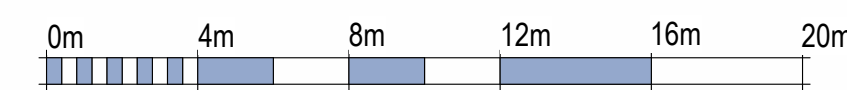

VISUAL SCALE 1:200 @ A1