

┌



Exit visibility looking west from a central location on the access and 2400mm back from highway edge, fence height to be reduced to max. 1.00m above ground level.



Exit visibility looking east from a central location on the access and 2400mm back from highway edge, fence height to be reduced to max. 1.00m above ground level.

© COPYRIGHT MANNING ELLIOTT PARTNERSHIP 2020.
THIS DRAWING IS THE PROPERTY OF MANNING ELLIOTT PARTNERSHIP.
IT MUST NOT BE COPIED OR REPRODUCED OR DIVULGED
TO ANYONE WITHOUT PERMISSION.
DO NOT SCALE OFF THIS DRAWING. ANY DISCREPANCIES TO BE
REPORTED TO MANNING ELLIOTT PARTNERSHIP.

REVISIONS:
A. 2024-05-15 First issue to planning authority.
B. 2024-08-28 Revised note regarding fence height.

Farthest visible point
on highway.

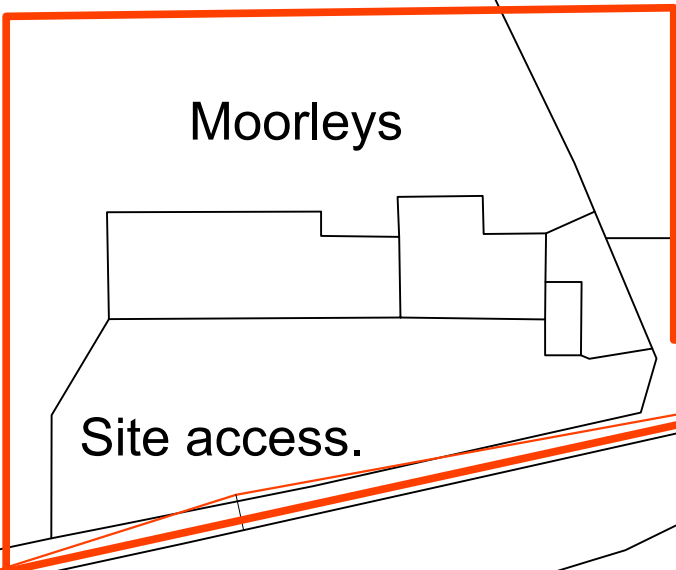

Farthest visible point
on highway.

Location plan Scale 1:500

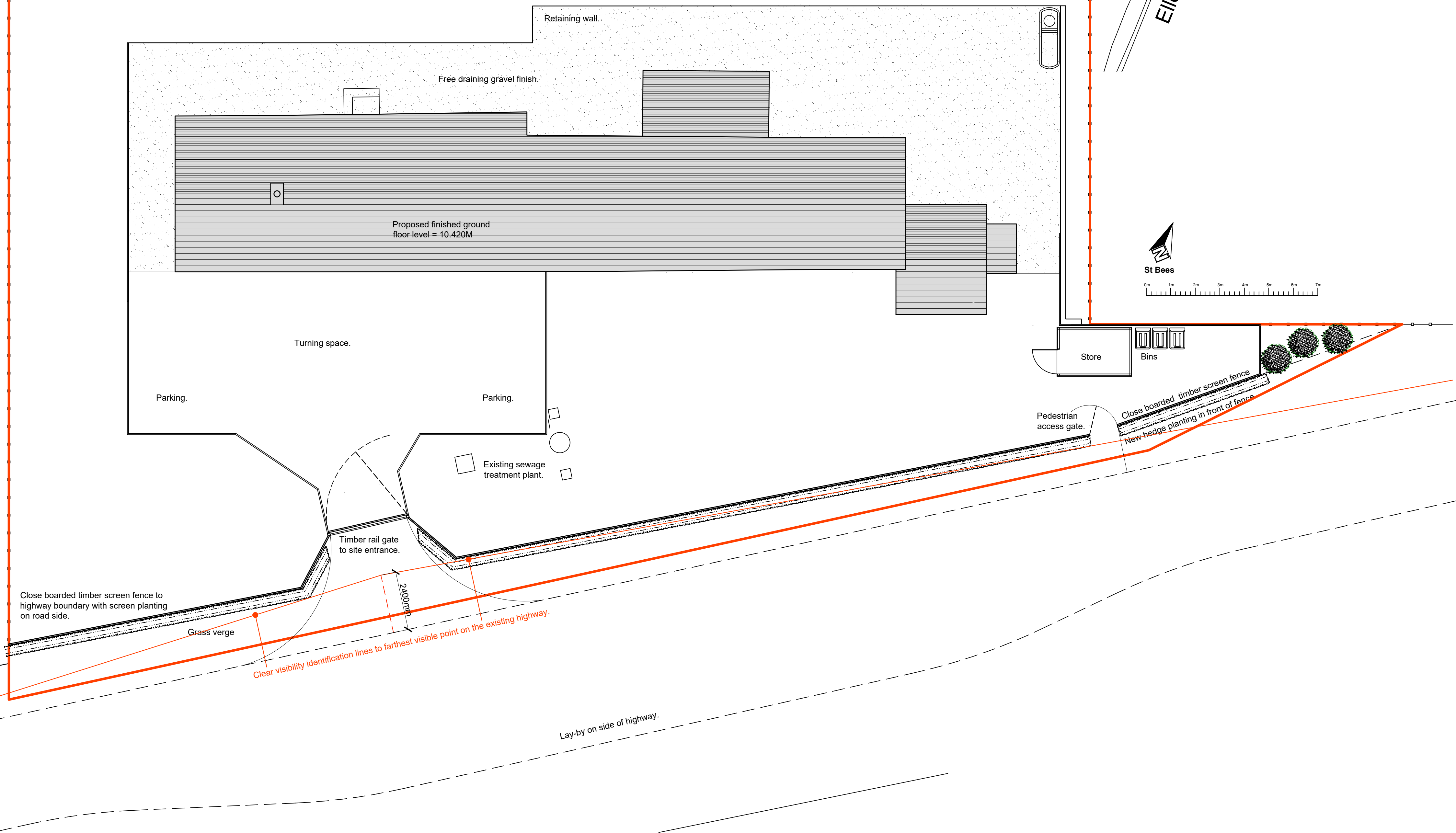

MANNINGELLIOTT
PARTNERSHIP

Chartered Architects &
Designers

Manelli House, Suite 1
Cowper Road, Penrith
Cumbria CA11 9BN
t: 01768 868 800
e: post@manning-elliott.co.uk
w: manning-elliott.co.uk

project title:
MOORLEYS, Egremont, CA22 2UA
Proposed oil tank installation with
garden and bike store shed and
screen hedge and fence.

drawing title:
Existing vehicular access visibility
splay indicative site plan.

issue stage:
Planning application

date: April 2024 GLS drawn: scale @ A1/A3:
1:100

drawing number: 2102-PL-221 revision: B

└