

Ground
1 : 100

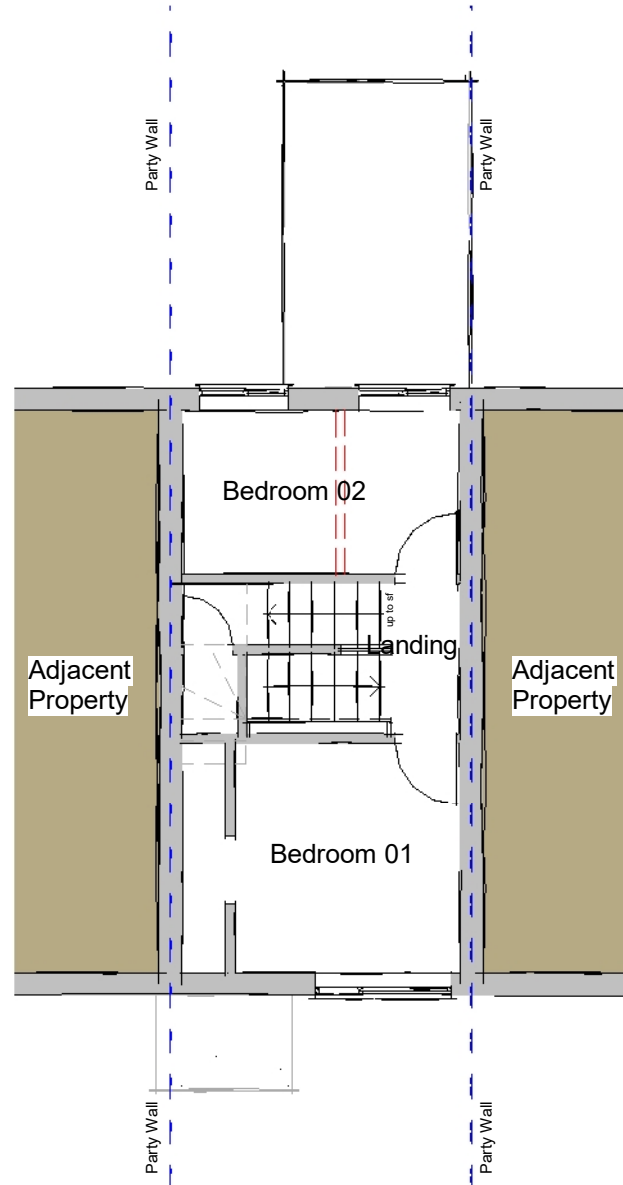

First
1 : 100



Second
1 : 100

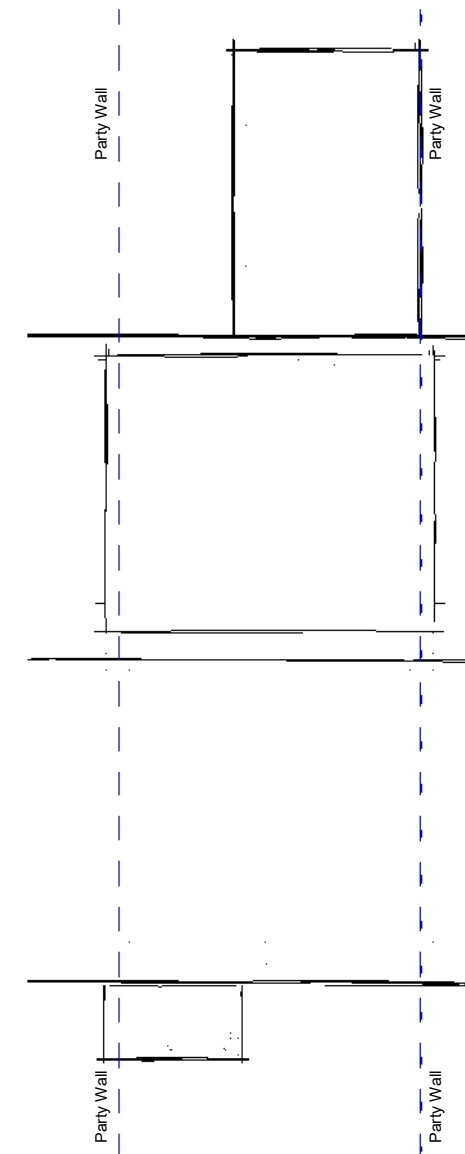

Roof
1 : 100

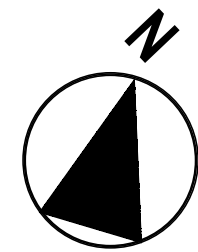

FOX-AD

NOTES:

DRAWING MAYBE SCALED FOR PLANNING PURPOSES ONLY

© FOX ARCHITECTURAL DESIGN LTD

A 2023-09-27 Loft conversion & dormer projection added

Client:
JIM HODGSON

Project:
23 MOUNTBATTEN WAY - MILLOM

Title:
PLANS AS PROPOSED

Scale:
1 : 100 of A3

Date:
AUGUST 2021

Status:
PLANNING

Drawing Reference:
21-41-P-04

Revision:
A

Scale 1 : 100

