

Ground
1 : 100

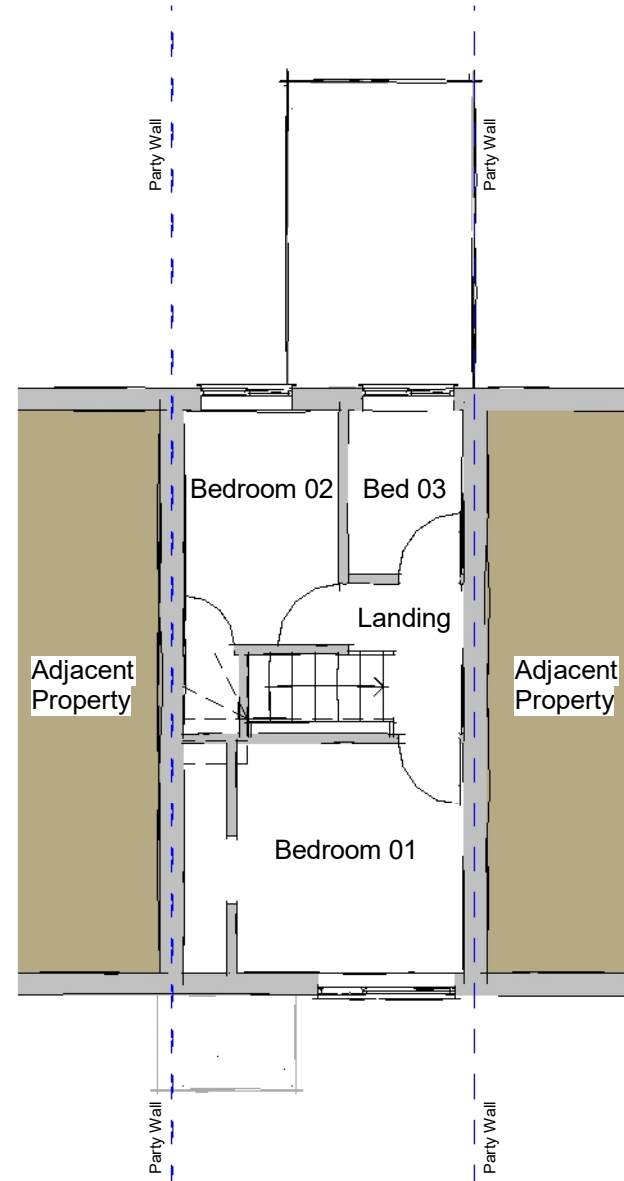

First
1 : 100

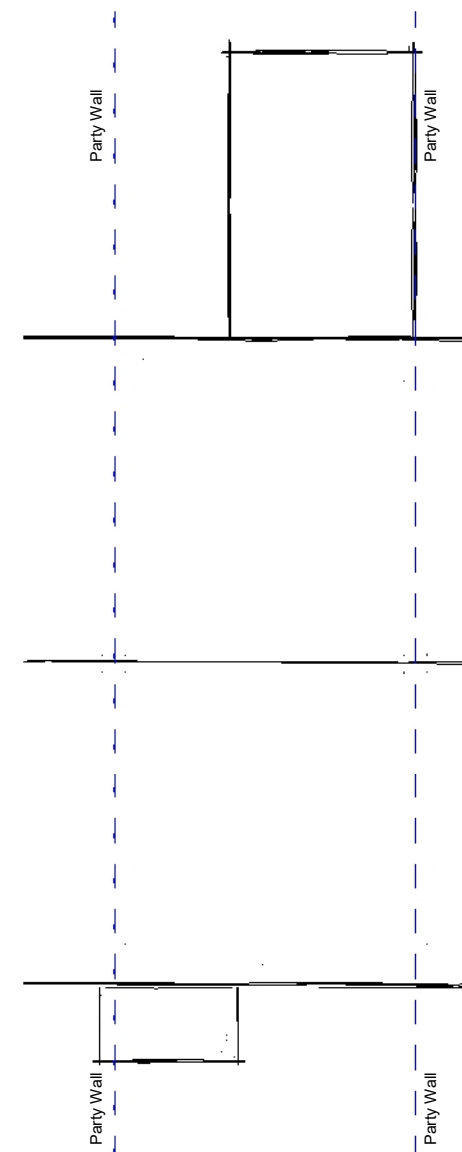

Roof
1 : 100

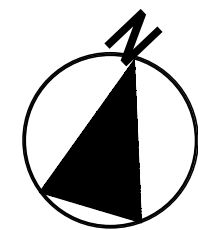

FOX-AD

NOTES:
DRAWING MAYBE SCALED FOR PLANNING PURPOSES ONLY
© FOX ARCHITECTURAL DESIGN LTD

Client:
JIM HODGSON
Project:
23 MOUNTBATTEN WAY - MILLOM
Title:
PLANS AS PROPOSED
Scale:
1 : 100 at A3
Date:
AUGUST 2021
Status:
PLANNING
Drawing Reference:
21-41-P-04

Scale 1 : 100

