

Ground
1 : 100

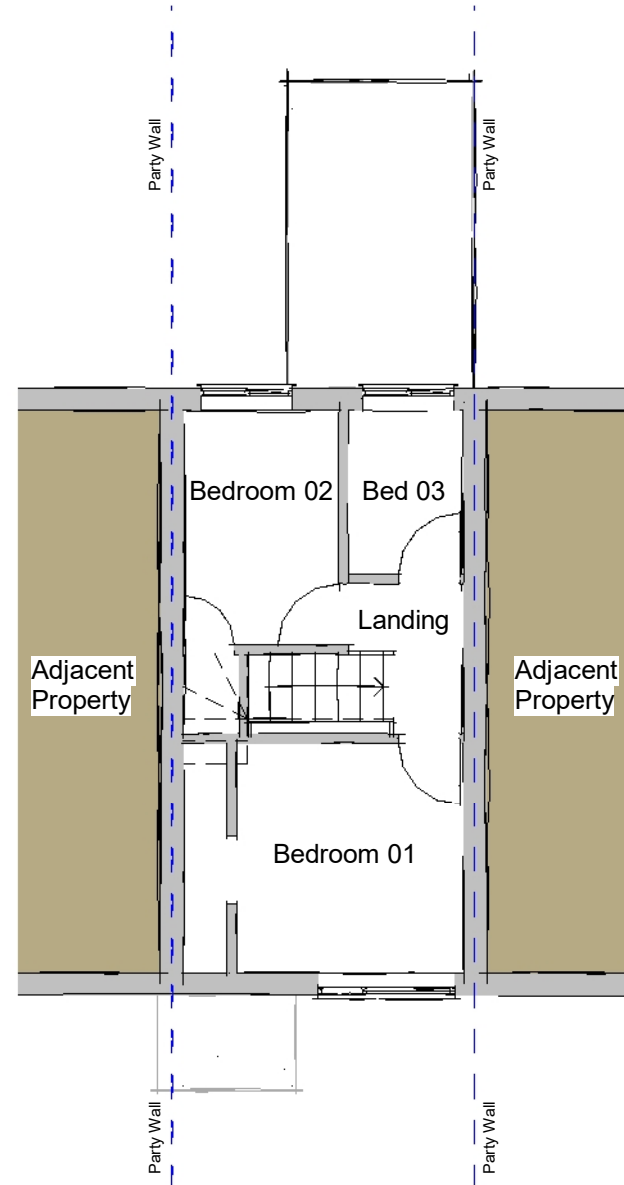

First
1 : 100

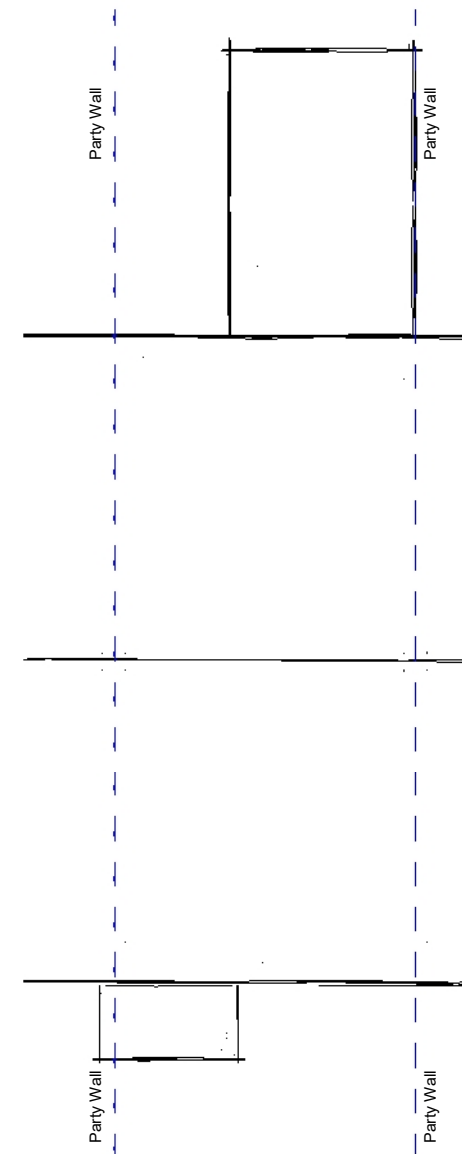

Roof
1 : 100

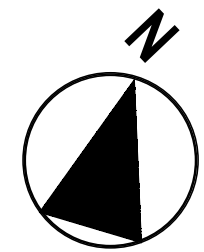

FOX-AD

NOTES:

DRAWING MAYBE SCALED FOR PLANNING PURPOSES ONLY

© FOX ARCHITECTURAL DESIGN LTD

| | |
|--------------------|-----------------------------|
| Client: | JIM HODGSON |
| Project: | 23 MOUNTBATTEN WAY - MILLOM |
| Title: | PLANS AS EXISTING |
| Scale: | 1 : 100 of A3 |
| Date: | AUGUST 2021 |
| Status: | PLANNING |
| Drawing Reference: | 21-41-P-02 |
| Revision: | |

Scale 1 : 100

