

**Ground**  
1 : 100

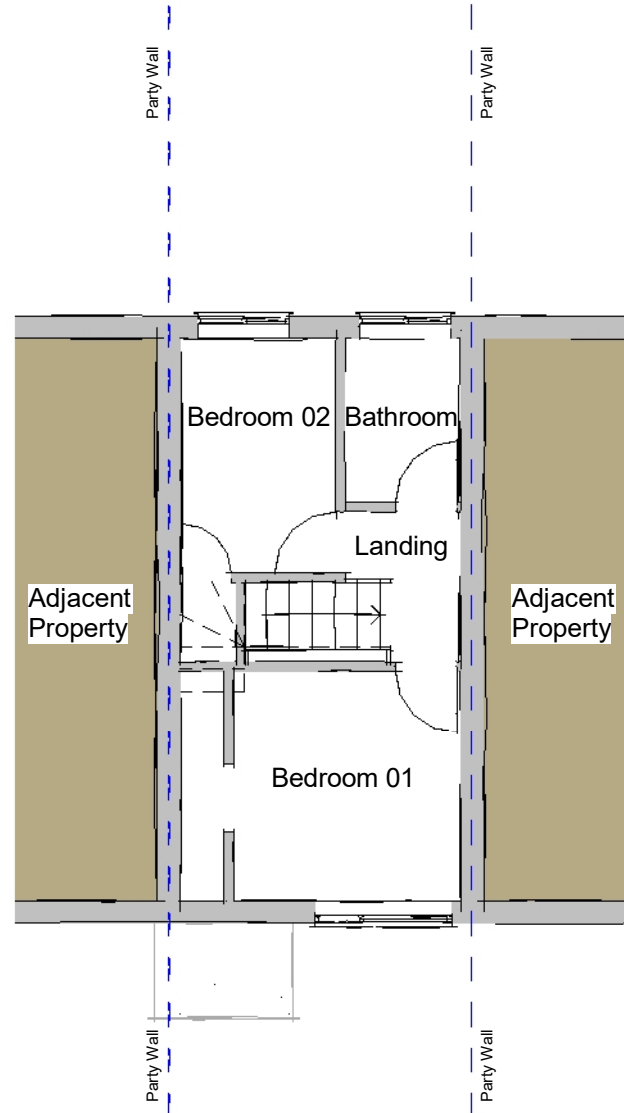

**First**  
1 : 100

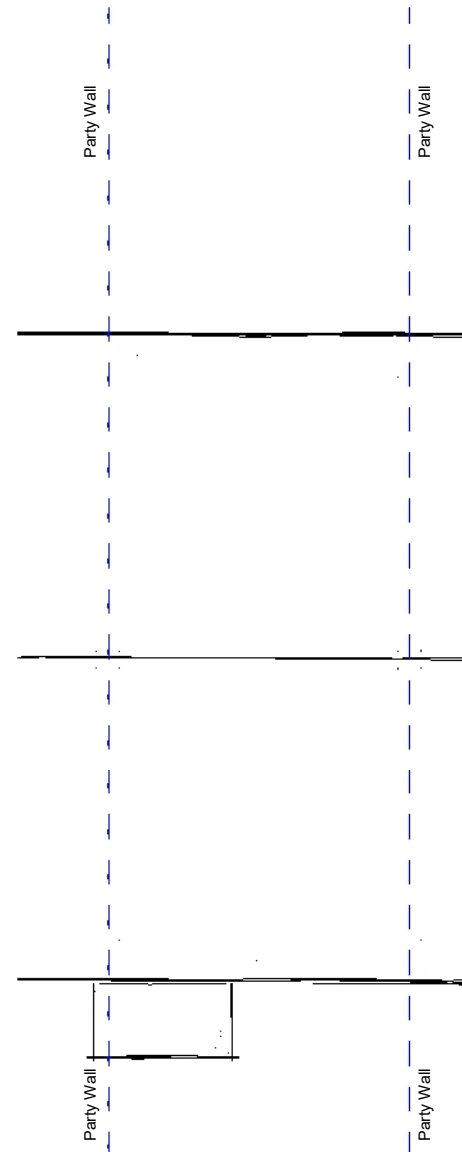

**Roof**  
1 : 100

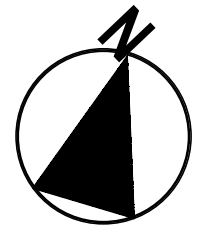

**FOX-AD**

NOTES:  
DRAWING MAYBE SCALED FOR PLANNING PURPOSES ONLY

© FOX ARCHITECTURAL DESIGN LTD

|                    |                             |
|--------------------|-----------------------------|
| Client:            | JIM HODGSON                 |
| Project:           | 23 MOUNTBATTEN WAY - MILLOM |
| Title:             | PLANS AS EXISTING           |
| Scale:             | 1 : 100 at A3               |
| Date:              | AUGUST 2021                 |
| Status:            | PLANNING                    |
| Drawing Reference: | 21-41-P-02                  |
| Revision:          |                             |

Scale 1 : 100

