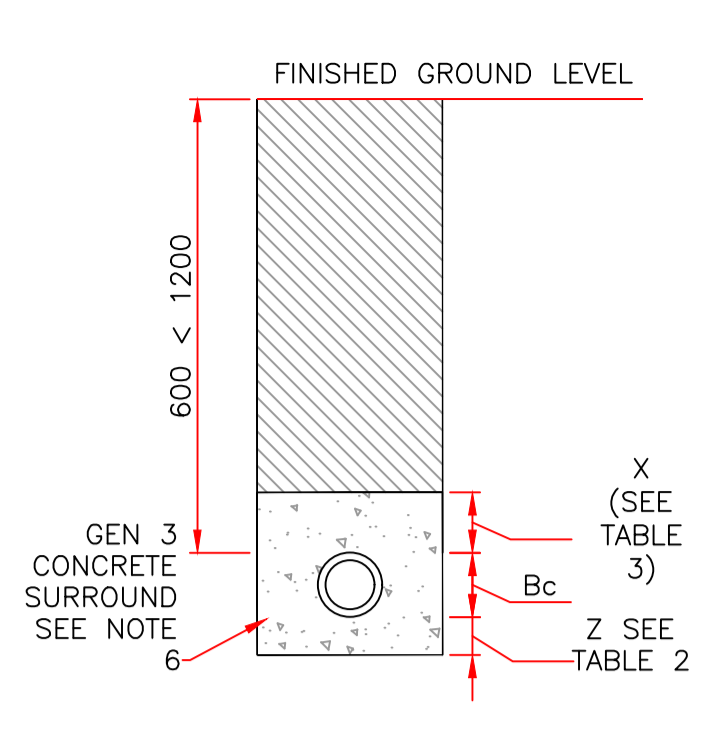

**TABLE 1**  
MINIMUM EFFECTIVE EMBEDMENT DIMENSIONS FOR FLEXIBLE AND SEMI RIGID PIPES

NOMINAL INT PIPE DIA	DIMENSION Y1 (EVEN TRENCH BOTTOM)	DIMENSION Y2 (ROCK OR UNEVEN TRENCH BOTTOM*)	MINIMUM EFFECTIVE TRENCH WIDTH Bd (SEE NOTE 5)
<400	100	200	Bc +300
400-700	150	250	Bc +450
725-900	200	300	Bc +600
925-1200	250	350	Bc +800

\*NOTE  
THE MINIMUM DEPTH OF PROCESSED GRANULAR MATERIAL UNDER PIPE SOCKETS SHALL BE 50mm FOR EVEN TRENCH BOTTOM AND 150mm FOR UNEVEN TRENCH BOTTOM

- NOTE**
- DRAINAGE TO BE 150 CONCRETE ENCASED WHERE COVER IS LESS THAN 1200mm.
  - THE PIPE EMBEDMENTS INDICATE MIN TRENCH DIMENSIONS WHICH SHOULD BE ASSUMED FOR INITIAL DESIGN, THE MIN TRENCH WIDTHS SHOWN WILL USUALLY BE SUFFICIENT TO ALLOW ADEQUATE COMPACTION OF THE EMBEDMENT MATERIAL. ALL PIPE WORK TO BE DESIGNED TO BS EN 1295-1.
  - GEN3 CONCRETE SHALL BE USED IN NON AGGRESSIVE GROUND ELSEWHERE THE CEMENT TYPE & MIX DESIGN SHOULD BE SELECTED TO SUIT SULPHATE CONTENT & PH OF THE GROUND & GROUND WATER GROUND COVER TO ALL PLANT TO BE STRICTLY IN ACCORDANCE WITH THE MANUFACTURERS SPECIFICATIONS



**TABLE 2 - EMBEDMENT DIMENSIONS FOR RIGID PIPES**

NOMINAL INT PIPE DIA	DIMENSION Y1 (EVEN TRENCH BOTTOM (MIN))	DIMENSION Y2 (ROCK OR UNEVEN TRENCH BOTTOM (MIN))	PROCESSED GRANULAR MATERIAL	DIMENSION Z (MIN)	MAX PERMITTED TRENCH WIDTH
150	100	200	10mm single sized or 14mm to 5mm graded	100	750
225	100	200		100	825
300	100	200		100	925
375	100	200	14mm single sized or 14mm to 5mm graded	100	1050
450	150	200		150	1150
525	150	250		150	1200
600	150	250	20mm single sized or 20mm to 5mm graded	150	1350
675	150	250		150	1450
750	225	300		225	1500

**TABLE 3 - THICKNESS OF COMPRESSIBLE FILL (L)**

nominal internal pipe dia	DIM "x"mm	compressible filler Lmm
< 400	160mm	18mm
400 - 700	200mm	36mm
725 - 1200	300mm	36mm
> 1200	300mm	54mm

**TYPE 1 EMBEDMENT CLASS S1 TO S5**  
SECTION UNDER ROADWAY/HARDSTANDING COVER GREATER THAN 1200mm  
FLEXIBLE AND SEMI RIGID PIPE EMBEDMENTS

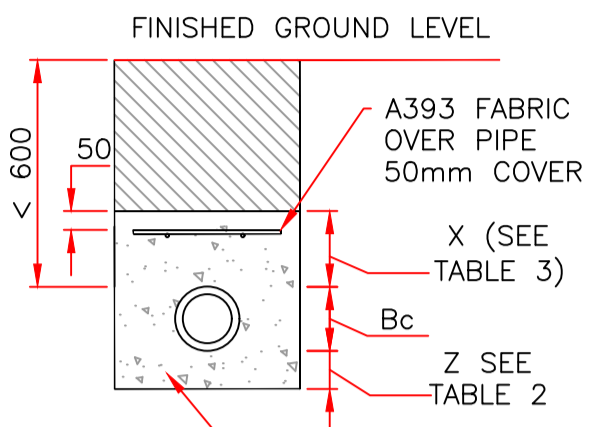

**SECTION UNDER ROADWAY/HARDSTANDING COVER 600 TO 1200mm**

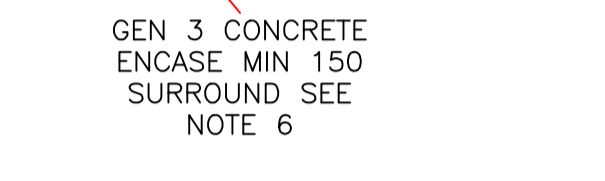

**VENT BOX/ACCESS COVERS TO MANUFACTURERS DETAIL**

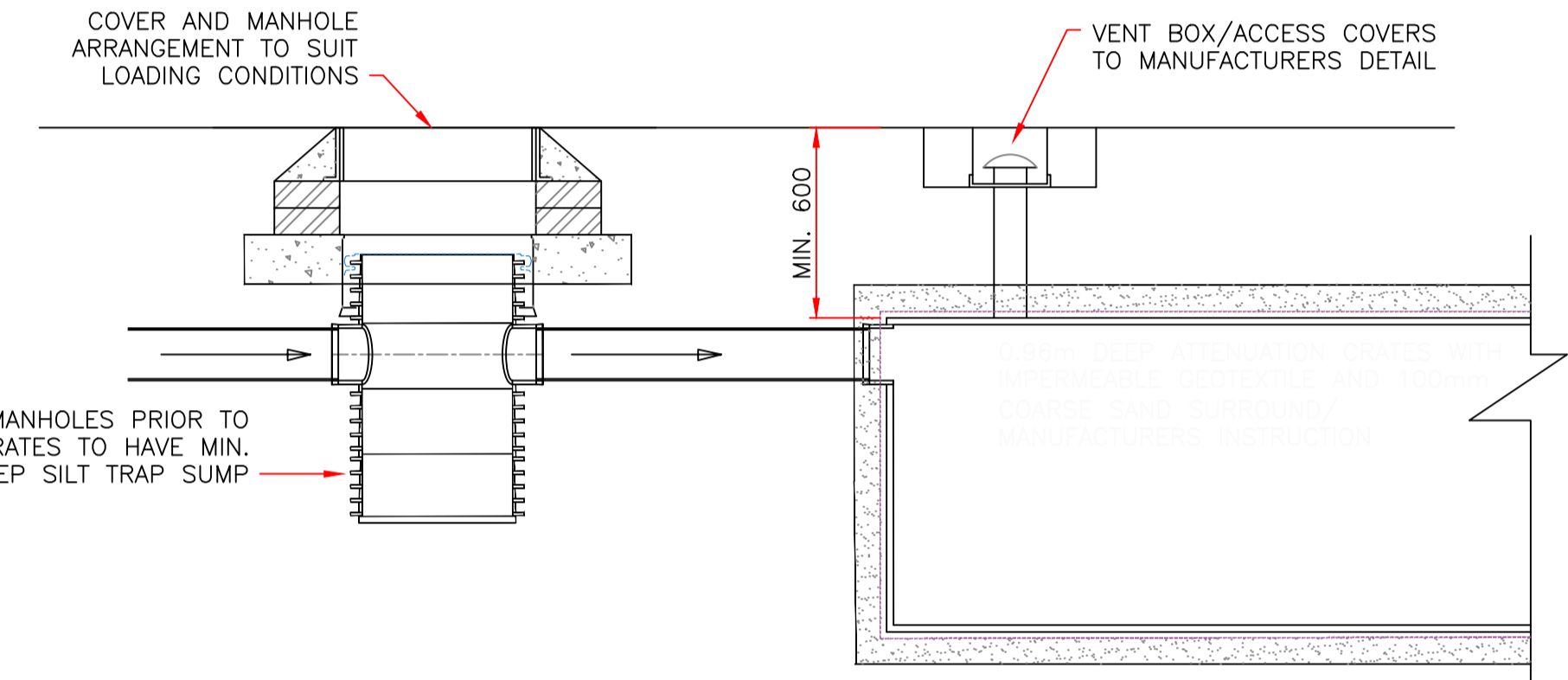

**TYPICAL SECTION THROUGH STORAGE TANKS 1:20**

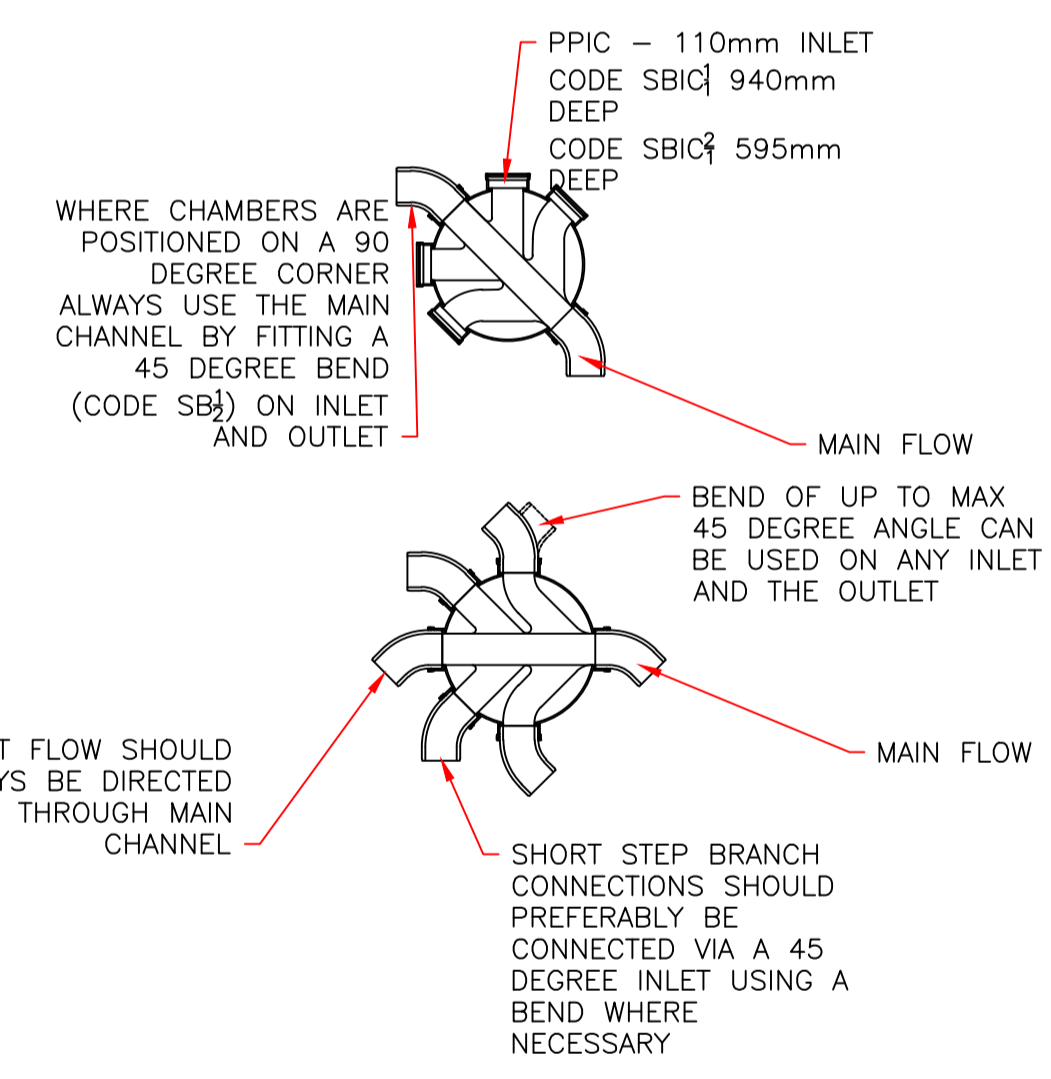

**GENERAL PLASTIC INSPECTION CHAMBER (NTS)**

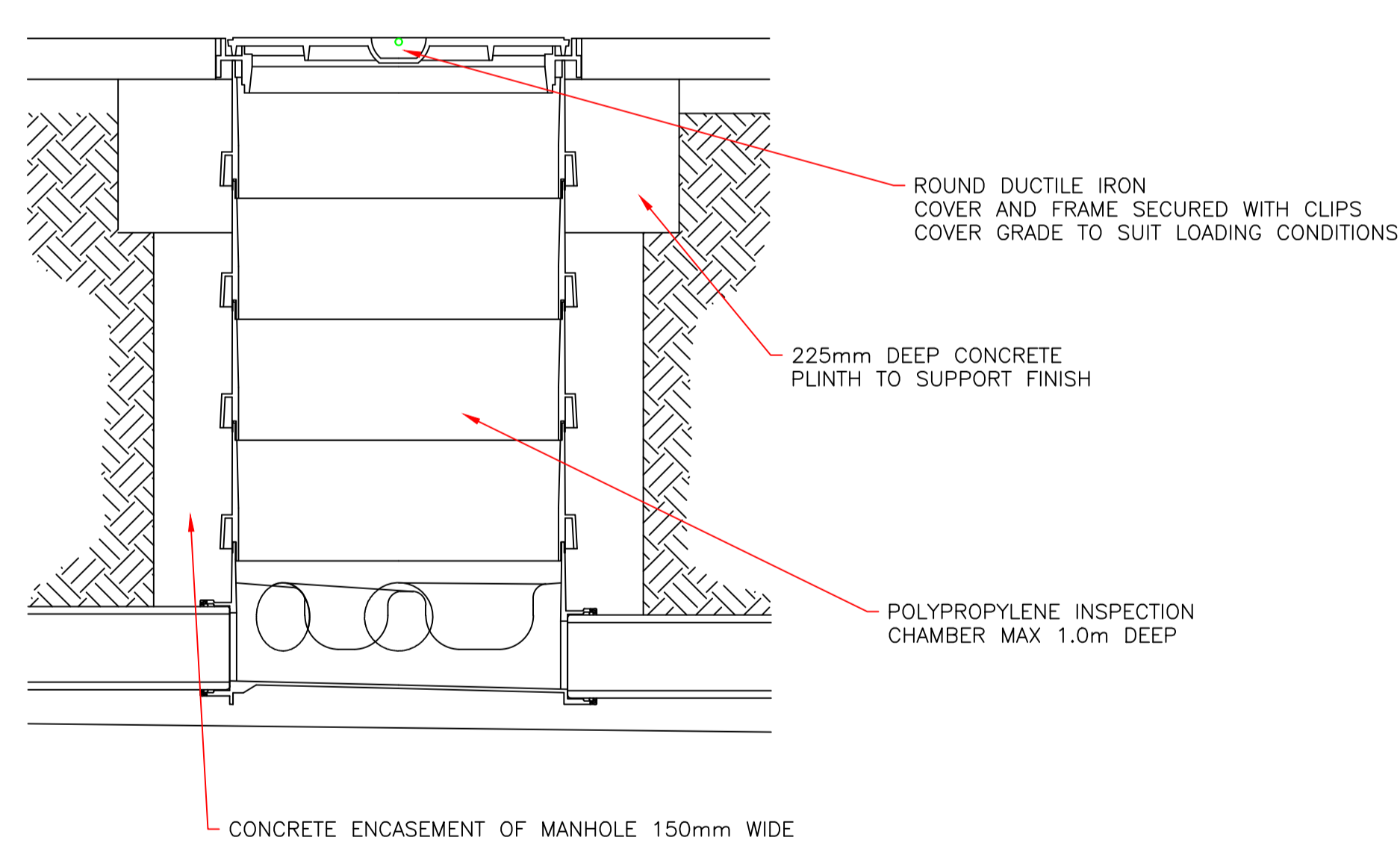

**TYPE D PPIC MANHOLE WITH STANDARD ROUND COVER (NTS)**

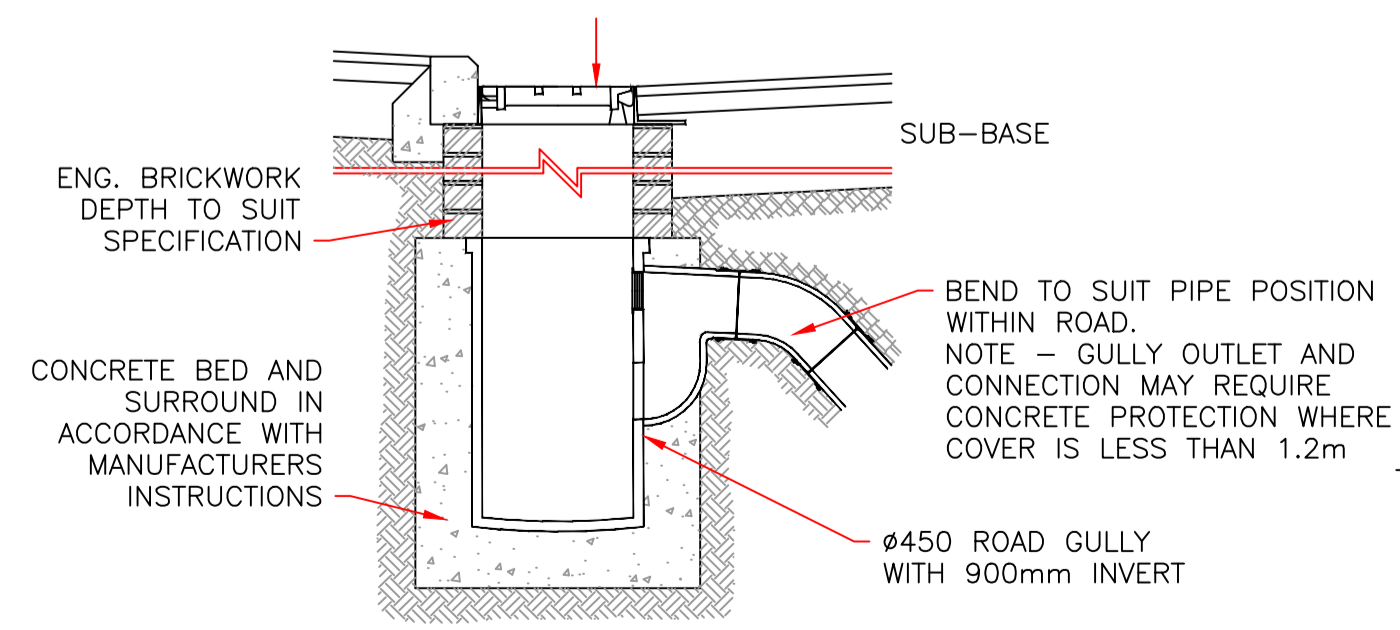

**TYPICAL GULLY DETAIL 1:20**

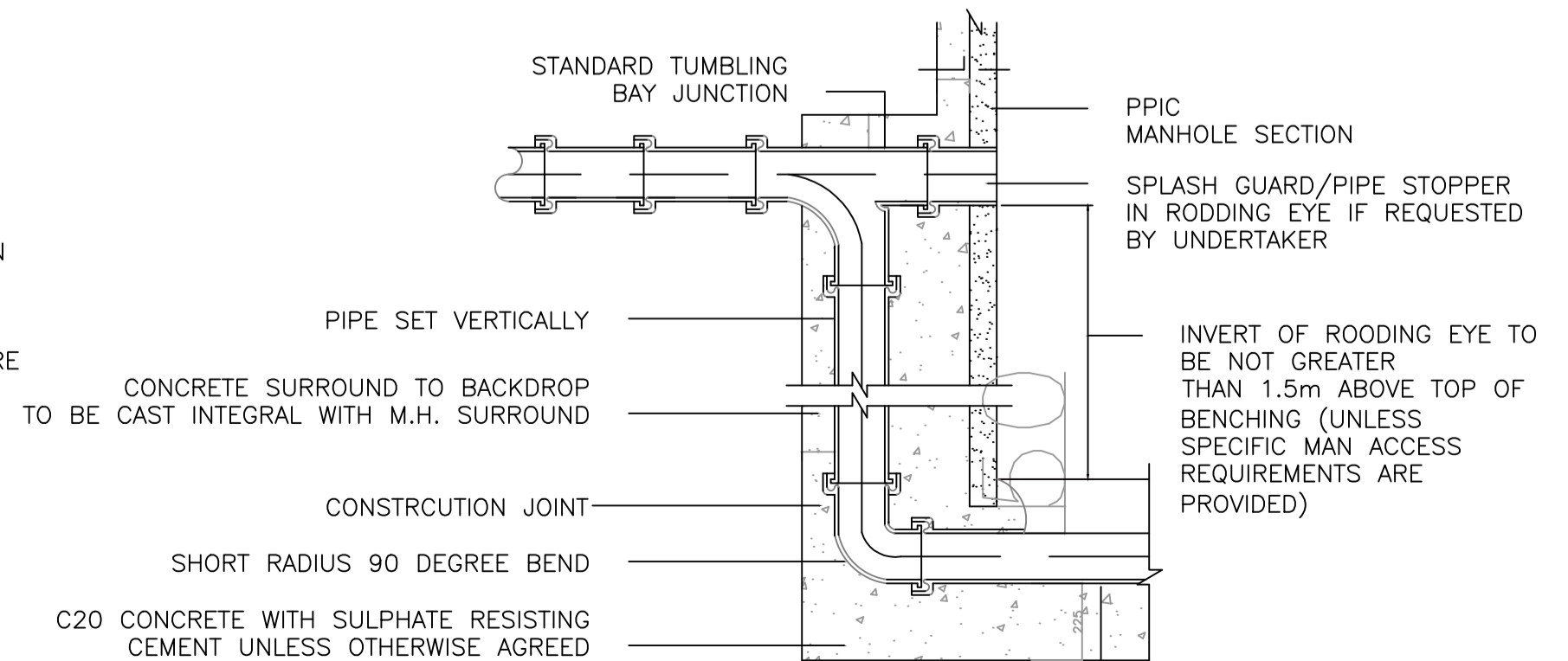

**TYPICAL SECTION THROUGH BACKDROP MANHOLE 1:20**

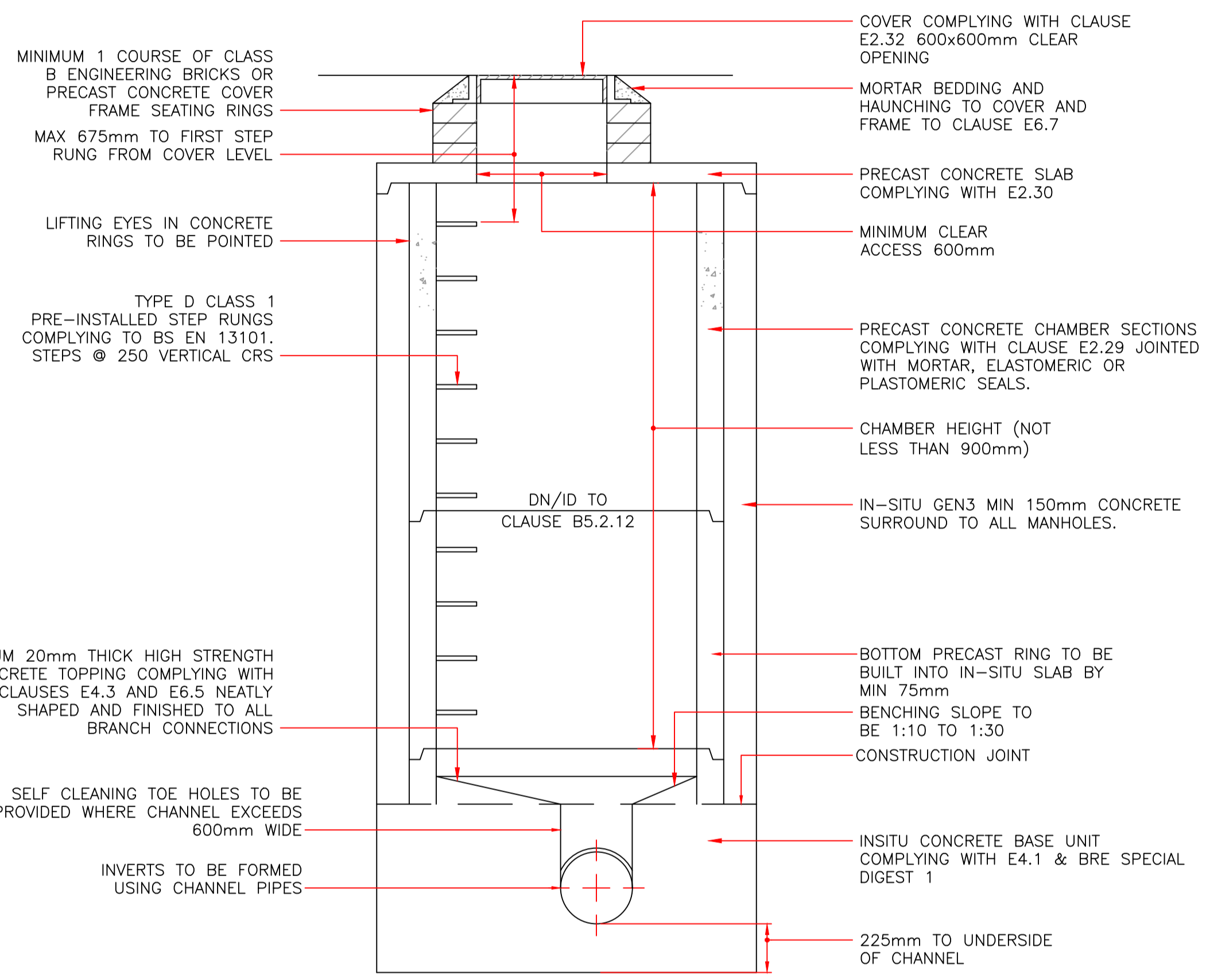

**TYPICAL MANHOLE DETAIL - TYPE B**  
DEPTH TO PIPE SOFFIT 1.5m TO 3.0m

**TYPE D CLASS 1 PRE-INSTALLED STEP RUNGS COMPLYING TO BS EN 13101. STEPS @ 250 VERTICAL CRS**  
MIN 450mm FROM EDGE OF STEPPING (SEE CLAUSE B5.2.29)

**PLANNING**  
**WATERWAY DRAINAGE ENGINEERING**

CLIENT  
SUNSHINE PROPERTIES LTD

TITLE  
LAND NORTH OF STATION ROAD, DRIGG  
CONSTRUCTION DETAILS 1 OF 3

DRAWN PA DATE MAR 25 SCALE 1:200 @AI  
DRAWING NO. 2025-026-003