

Refer to St. Engineers details/ sketches for full steelwork / pad/ foundation details.

See specification notes 'External Walls'

Velux MK08 (GPU 0060) Top hung rooflight with white polyurethane internal finish. Standard EDW/EBW/EKW flashing kit to be installed to manufacturers instructions.

New cavity wall construction to be toothed and bonded into existing masonry wall or with use of crocodile clip system.
Type B Vertical Cavity tray to be inserted at all abutments

1 hour intumescent paint coating to all steel work within ceiling void (continuous 30min fire ceiling).

New water feed to fridge/ freezer.

New electrical feed to wine cooler within island unit. Kitchen layout subject to client specification.

Proposed Floor Area	14.7 sqm
(25% of area above)	3.68 sqm
Existing Glazing Removed	3.4 sqm
25% + Glazing Removed	7.08 sqm
Proposed Glazing	10 sqm

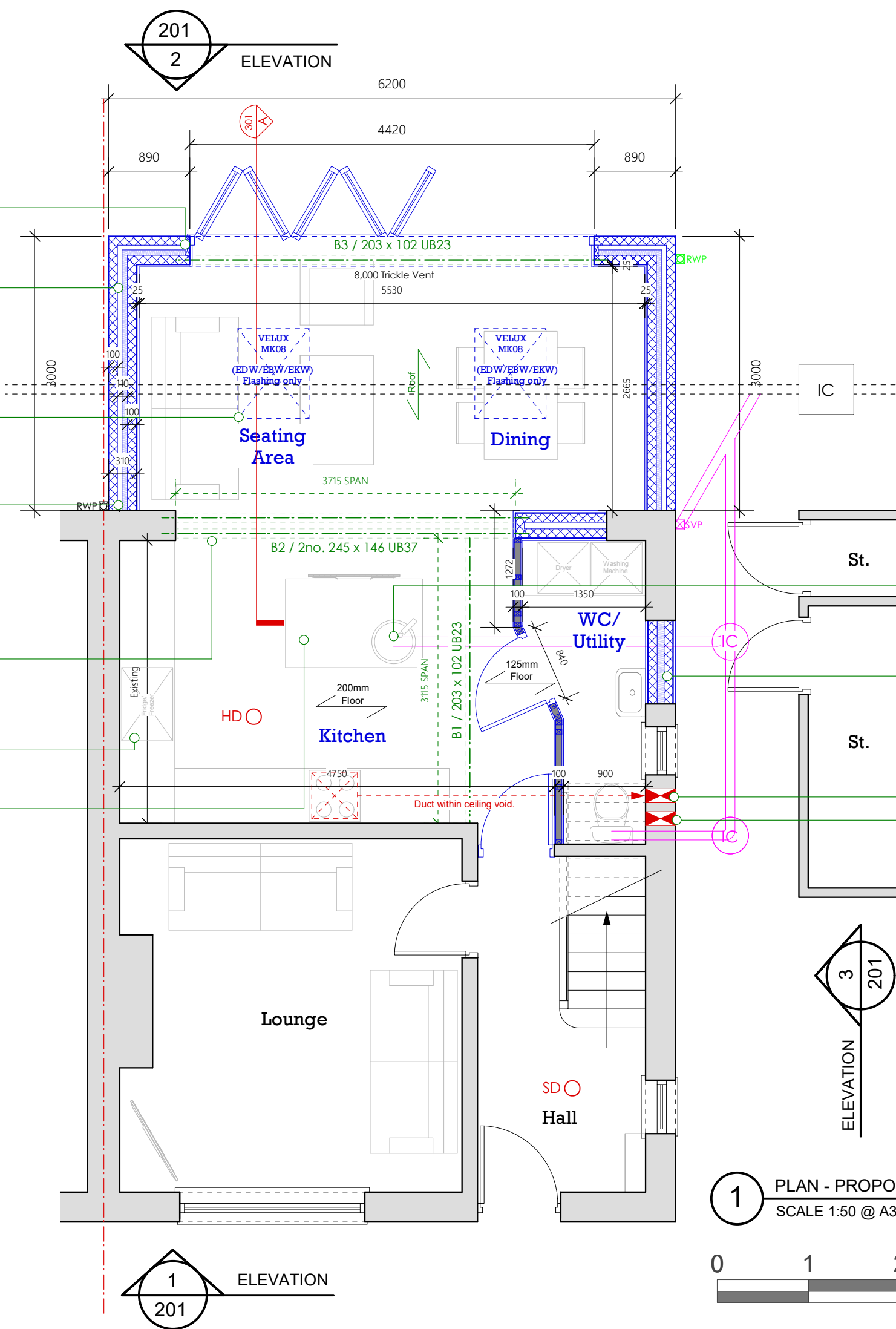

Please Note:
For Structural design, refer to Structural Engineers details.
Electrical layout subject to agreement with Client on site.
Kitchen subject to specialist sub-contractor design. All services to be coordinated to suit.

All invert levels to be determined on site. Foul & Surface water drainage passing through the building to be encased in 200mm of concrete in line with United Utilities Shedule A.
Existing SVP to be removed and new SVP relocated to side elevation.
Surface water drainage connection amended to suit extension position.

New foul waste connection below existing slab to island.
Existing door opening to be blocked up & insulated.
Inline fan from cooker hood to provide 30 l/s extract. Ducting within floor void to avoid clash with steel beam.
30 l/s extract fan from Utility.

Please Note:
Drawings subject to relevant statutory approvals.
All dimensions to be checked on site. Do not scale from this drawing. Work to figured dimensions only.
C This drawing is copyright of MC Architecture + Design and may not be reproduced in any way without their specific permission.

Material Key (Plan):

- Internal Studwork.
- Internal Studwork with 60mm mineral wool to cavity.
- Blockwork.
- Facing Brick.
- Existing Walls
- Thermabate proprietary vertical insulated dpc
- SVP- Soil and Vent Pipe
- AAV- Air Admittance Valve
- BIG- Back Inlet Gully
- HD Heat detector linked to mains with battery back-up.
- SD Smoke detector linked to mains with battery back-up.
- CM Carbon Monoxide Detector
- Wet Radiator
- Wet Heated Towel Rail
- Mechanical extract
- Boiler Flue
- Elec Socket [Number denotes Single/Double / HL = High Level / UW = Under worktop]
- Cooker Control unit with 2-pole switch
- Light Switch - (Number denotes gang / D = Dimmer)
- New low energy downlighter + hood
- New moisture resistant downlighter + hood
- Fused Spur
- 32 Amp Cooker Switch
- Pendant Light Fitting
- PIR Fitting
- Wall Mounted/Bulkhead Light Fitting
- IP65 Dustproof Florescent Light Fitting 800mm long.
- External Water Tap
- External Electric Socket [Number denotes gang]
- Mirror Light Feed
- Alarm Panel / Alarm Key Pad
- Thermostat
- Sky TV / BT Phone Connection Points / Alarm PIR Sensor
- Electric Dist. Board
- Under Floor Heating Manifold
- Mains wired door bell
- Shaver socket

MCA
MC Architecture + Design

☐ Preliminary ☐ Tender
☒ For Approval ☐ Construction

Client >
Ms Mather

Project >
18 Dent Road, Mirehouse, Whitehaven, Cumbria, CA28 8HG.

Drawing Title >
Proposed Ground Floor Setting Out Plan.

Scale >
1:50 @ A3

Date >
Aug 2020

Drawing No. >
1920-010-101

Rev >
B

1 PLAN - PROPOSED GROUND FLOOR SETTING OUT
SCALE 1:50 @ A3

